



AI Conference Speakerphone

User Manual

Product introduction

AIMIC-M6 Pro is an intelligent conference microphone speaker launched by AISPEECH. It's specially designed for small collaboration rooms, small meeting rooms, open spaces, and remote office scenarios. This product integrates audio collection, amplification capabilities. It adopts a 6-unit omnidirectional microphone array and proprietary audio algorithms to achieve functions such as omnidirectional pickup within 4 meter radius, directional pickup, AI noise reduction, echo cancellation and two-way communication. It solves common pain points in meetings, such as unclear remote communication and difficult meeting summary preparation. The directional pickup function of this product provides users with exclusive pickup zones, effectively blocking all sound interference from other angles, and improving remote communication efficiency.

Applicable scenarios: small collaboration rooms, small meeting rooms, open spaces, and remote office.

Product introduction

Accessories List



Speakerphone

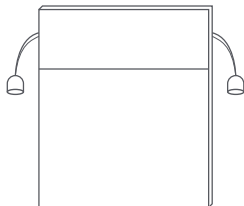

Storage Bag



User Manual



Bluetooth dongle

Product introduction

Buttons and indicator lights instructions

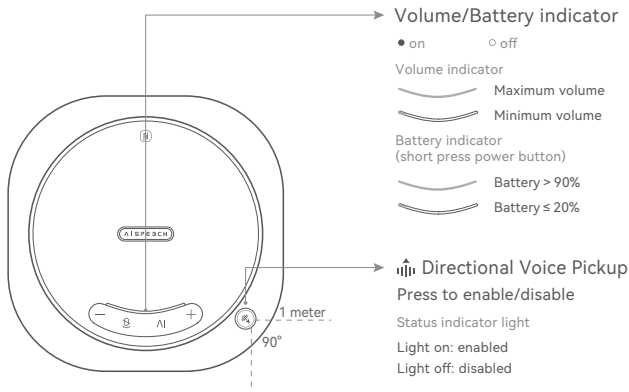

Product introduction

Buttons and indicator lights instructions

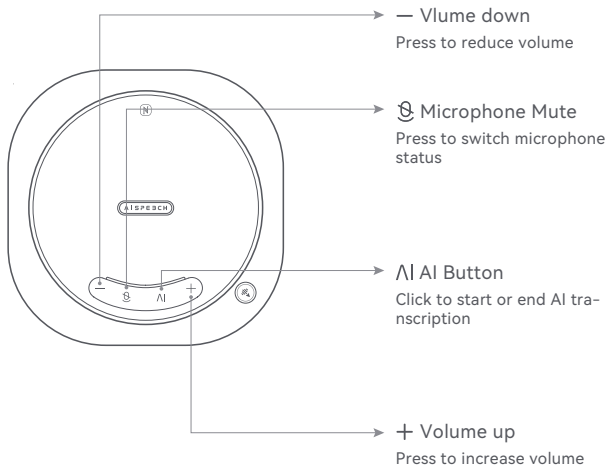

Tip: AI transcription function needs to be used with the Mile Memo software while the device is connected to the computer via USB.

Product introduction

Buttons and indicator lights instructions

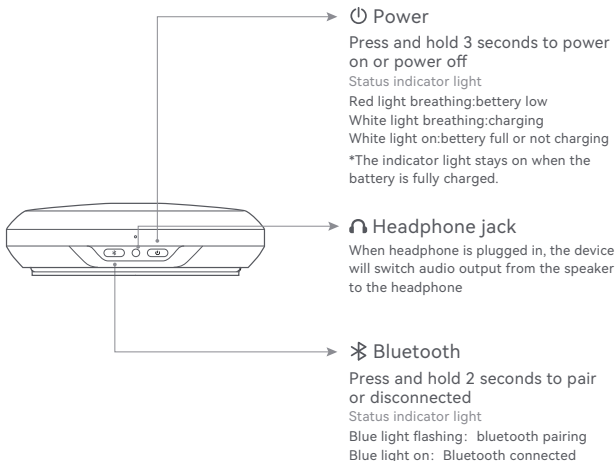

Instruction for use

Ligth color instructions

Status	Light color
Power on	Partial green light on
Power off	Light off
Muted	Red light on
Start/End AI	Partial green light flashing
Upgrading	Green light breathing

1.Device connection

The device's initial Bluetooth name is“AIMIC-M6 Pro****”(the last four figures of S/N)”

* Bluetooth connection

1) Mobile phone connection

After powering on device and activating Bluetooth, then turn on the Bluetooth function on your mobile phone and search for Bluetooth device named "AIMIC-M6 Pro****" for pairing and connection. Or you can enable the NFC function on your phone and tap the NFC logo

Instruction for use

area on the device to connect. The Bluetooth indicator light staying on indicates a successful connection.

2) Computer connection

After powering on device and activating Bluetooth, then open the Bluetooth settings page on your computer system. Select this device to pair and connect. The device's Bluetooth indicator light staying on indicates a successful connection.

3) Bluetooth Dongle connection

Plug in the Bluetooth dongle into the PC, conference host, or conference display. After powering on the device activating Bluetooth function, then open the Bluetooth settings page on the computer system. Select this device for pairing. The Bluetooth indicator light staying on indicates a successful connection.

* USB connection

Connect the device to computer via type-C USB data cable and you will hear a prompt tone when connected. Choose “AIMIC-M6 Pro” as input /output audio device in system setting or in the online meeting software.

Tip: This device does not support direct connection to the phone using an OTG data cable.

Instruction for use

2. Directional Pickup

- 1) Press the "Directional Pickup" button to enable this function and status light will turn to green. Point the directional pickup button towards the speaker, and it will suppress all sounds outside the directional pickup fan-shaped area, prioritizing the voice within the area. The directional pickup area has an angle of $\pm 45^\circ$ with the button as the center and 1 meter radius.
- 2) Press the "Directional Pickup" button to disable this function. The light will turn off, indicating function is deactivated.

3. Charging Instructions

* Charging

- 1) When connected to computer via USB cable, the device enters charging mode regardless of whether it is powered on or off.
- 2) If consumers use a power adapter for power supply, please purchase one which has obtained corresponding certification.

* Battery Level Check

While the device is powered on, press the power button shortly to check the current battery level.

- 1) Battery $< 20\%$, the power button indicator light breath in red.
- 2) Battery $\geq 20\%$, the power button indicator light remain in white.

Note: Output power of the power supply adapter should be less than 15W. It is recommended to charge the device one hour before using it for the first time to ensure sufficient battery power.

Basic parameter

Product name	AI Conference Speakerphone
Product model	AIMIC-M6 Pro
Product dimensions	125mm*125mm*35.5mm
Bluetooth	Bluetooth V5.1
Voice pickup distance	4 meters
Microphone	6 omnidirectional microphones
Speaker	5W*2
Battery capacity	5000mAh
Interface	Headphone jack
Charging input	5V  2A

RF exposure statement

This equipment complies with the FCC radiation exposure limits set forth for an uncontrolled environment. This transmitter must not be co-located or operating in conjunction with any other antenna or transmitter.

FCC Warning

This device complies with Part 15 of the FCC Rules. Operation is subject to the following two conditions:

(1) This device may not cause harmful interference, and (2) this device must accept any interference received, including interference that may cause undesired operation.

Note: This equipment has been tested and found to comply with the limits for a Class B digital device, pursuant to part 15 of the FCC Rules. These limits are designed to provide reasonable protection against harmful interference in a residential installation. This equipment generates, uses and can radiate radio frequency energy and, if not installed and used in accordance with the instructions, may cause harmful interference to radio communications. However, there is no guarantee that interference will not occur in a particular installation. If this equipment does cause harmful interference to radio or television reception, which can be determined by turning the equipment off and on, the user is encouraged to try to correct the interference by one or more of the following measures:

- Reorient or relocate the receiving antenna.
- Increase the separation between the equipment and receiver.
- Connect the equipment into an outlet on a circuit different from that to which the receiver is connected.
- Consult the dealer or an experienced radio/TV technician for help.

NOTE 2: Any changes or modifications to this unit not expressly approved by the party responsible for compliance could void the user's authority to operate the equipment.

Brand Owner: AISpeech Technology Co., LTD.

Email: aimic_support@aispeech.com