

# Wireless Barcode Scanner



Instruction Manual Rev.1.0

## ① Checking the Package

Barcode Scanner x1 Instruction manual x1

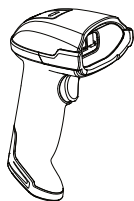

Data cable x 1 Flexible Fixed Arm Holder

Note: Different models different data lines

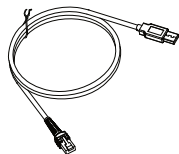

(Options)

Wireless Receiver  
(standard with two options)

Note: Different scanners are equipped with different receivers as standard

USB Receiver



Base Receiver

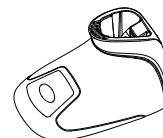

Power supply kit  
(Standard on some models)

AC adaptor

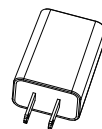

Power cable

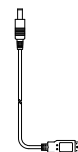

## ② Part Names and Functions

Barcode Scanner

Power status LED

Operation status LED

Buzzer

Reading window:  
Emits LED light and aimer

Trigger button:  
Use this button to read a code

Charging contacts  
Place in base receiver for charging

Type-C interface  
For data transfer and charging

Base receiver

Note: Long bar shaped power indicator without paging button

Charging contacts

Power indicator  
(Page Button)

Communication cable port

Base address barcode

(Bottom)

Power supply port

## ③ Read Barcode

Move the reading window to the barcode and press the trigger button. The LED light and aimer indicating the reading position are emitted, and the barcode is read.

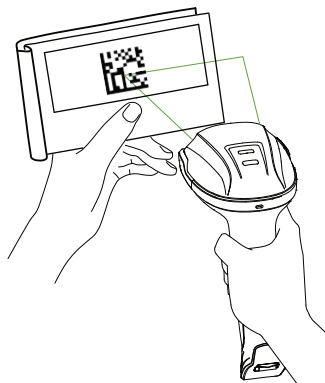

Operation status LED flashes once and beeps once when reading barcode.

The barcode data is sent to the connected PC or other device.

## ④ Pairing

Pairing with USB receiver

Note: Pairing is completed before delivery

1 Use the scanner to scan the 2D barcode on the surface of the USB receiver

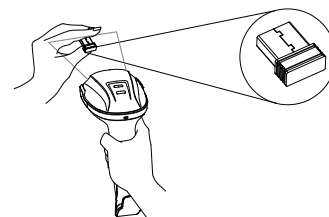

2 Plug the USB receiver into the USB port

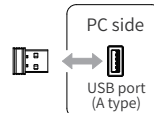

Pairing with bluetooth device  
(Available for Bluetooth scanners only)

1 Scan the barcode below if connected with bluetooth device



Bluetooth HID Keyboard Connection Mode

Pairing with base receiver

Note: Pairing is completed before delivery

1 Use the communication cable to plug the base receiver into the terminal device's port or connect with power AC adapter as power on status

(USB port is shown here)

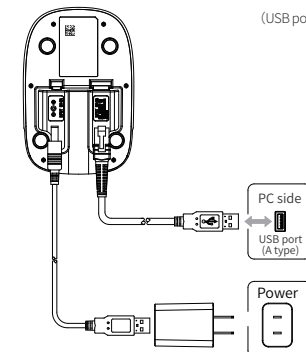

2 Scan the barcode label on the bottom of the base receiver

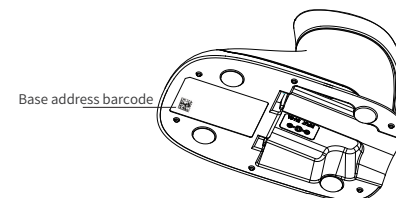

Paging function

When you press the page button, the scanner being paired sounds (3 short and 1 long tone), and the green LED blinks.

## 5 Wired connection for use

### Data Cable Connection method

- 1 Scan the barcode below once



Enable wired connection output

- 2 Connect the scanner to the PC via USB Type-C cable

(Note: USB Type-C cable is option not standard for scanner with base receiver)

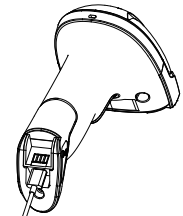

Disable wired connection output

## 8 User Indications

### Power status LED

Indication	LED Indicator
Power over 30%	Green LED always on
Power below 30%	Red LED always on
Charging	Yellow LED always on

### Operation status LED

Indication	LED Indicator
No operation	None
Successful communication	Flashes once
Failed communication	Fast flashing thrice

### Beeper

Indication	Beeper Sequence
Bar code decoded	Beeps once
Data transfer failure	Razz or Error Tone
Unconnected status	1 beep per press the trigger
Paged status	3 short beeps 1 long beep
Power on	Continuous beep
Power off	Beeps once
Successful function change	2 Beeps
Failed function change	Razz or Error Tone

## 6 Batch mode

Range its receiver , or when performing The data is transmitted to the receiver once the records are manually transmitted.

### Enter Batch Mode

Scan the barcode below once when enter batch mode



### Upload Batch Data

Scan the barcode below once to transmit all the stored data to the host system.After the data is uploaded,it will return to real-time transmission



### Total Output Barcodes

Out put the total number of barcodes scanned when in Batch Mode, scan the barcode below once



### Clear all codes

If you want to clear the scanner' s buffer of all data accumulated in Batch Mode, scan the barcode below once



## 9 Cleaning Procedure

The scanning window needs to be cleaned regularly to ensure optimal performance during scanning operations.Follow the procedures described in this manual to keep your scanner in good operating condition.

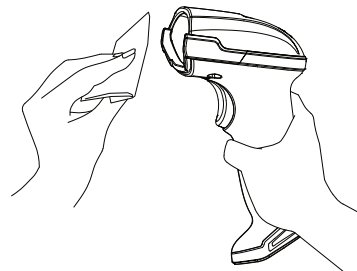

### Caution

- Be sure to turn off power and unplug the device from electrical outlet before cleaning.
- DO NOT spray or pour cleaner directly onto the unit.
- It is recommended to use a dust-free cloths to clean the window.

## 7 Charging instructions

### Wired charging method

Use a Type-C cable to connect to a PC's USB port or a power adapter with DC5V output.

(The power status LED shows yellow for charging status)

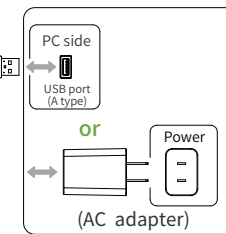
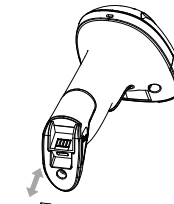

Use a power adapter for faster charging

### Base charging method

- 1 Use a communication cable to connect to a PC's USB port or a power adapter with DC5V output.  
(The power status LED shows green for power-on status)
- 2 Place the scanner normally on the base  
(The power status LED shows yellow for charging status)

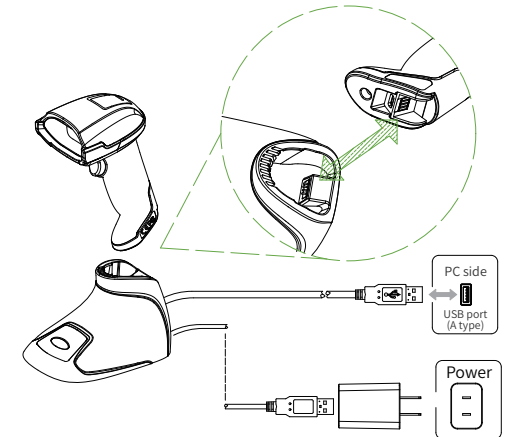

## 10 Troubleshooting

If a problem occurs during operation of the Scanner, check the following first.

If the problem persists, contact your nearest sales office.

### No response when scanner button is triggered

#### Scanner battery is low

Please charge the scanner

### LED is on, but bar code does not decode

#### Scanner not programmed for correct bar code type

Ensure scanner is programmed to read the type of barcode. Refer to the PRG for more information.

#### Bar code label is unreadable

Check the label to ensure it is not defaced. Try scanning another bar code type.

#### Distance between imager and bar code is incorrect

Move scanner closer to or further from the bar code.

### Barcode data can not be output properly

#### Scanner not programmed for the correct host type

Check that the following settings suit your PC.

- Country keyboard
- Type of USB keyboard

#### Scanner is not connected

Please refer to the pairing method in the manual for connection

#### Scanner to receiver communication out of valid range

1. Real-time data transmission should be used under the effective communication distance
2. Refer to the use of "batch mode" to achieve data management

#### Scanner is in batch mode

Scan the "clear all codes" setting code under "batch processing"

## FCC Warning

This device complies with part 15 of the FCC Rules. Operation is subject to the following two conditions: (1) This device may not cause harmful interference, and (2) this device must accept any interference received, including interference that may cause undesired operation.

Any Changes or modifications not expressly approved by the party responsible for compliance could void the user's authority to operate the equipment.

**Note:** This equipment has been tested and found to comply with the limits for a Class B digital device, pursuant to part 15 of the FCC Rules. These limits are designed to provide reasonable protection against harmful interference in a residential installation. This equipment generates uses and can radiate radio frequency energy and, if not installed and used in accordance with the instructions, may cause harmful interference to radio communications. However, there is no guarantee that interference will not occur in a particular installation. If this equipment does cause harmful interference to radio or television reception, which can be determined by turning the equipment off and on, the user is encouraged to try to correct the interference by one or more of the following measures:

- Reorient or relocate the receiving antenna.
- Increase the separation between the equipment and receiver.
- Connect the equipment into an outlet on a circuit different from that to which the receiver is connected.
- Consult the dealer or an experienced radio/TV technician for help.

The device has been evaluated to meet general RF exposure requirement. The device can be used in portable exposure condition without restriction.