

2.4G Wireless Ergonomic Keyboard  
User Manual

Packing List

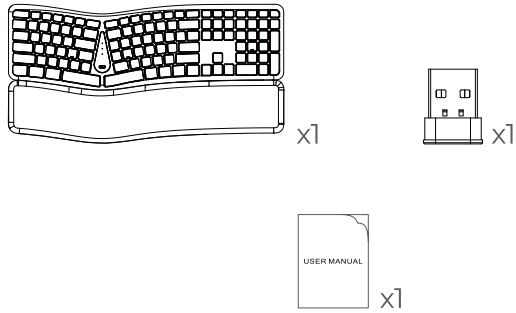

- 1.Keyboard x1
- 2.USB Receiver x1
- 3.User Manual x1

2.4G Wireless Connection

1 Turn on the power switch.

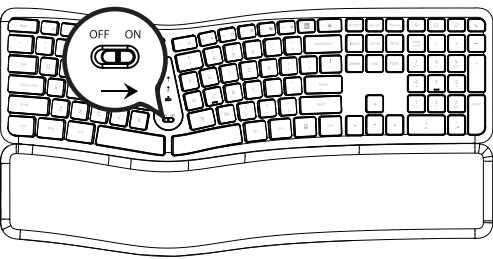

2 Take out the USB receiver.

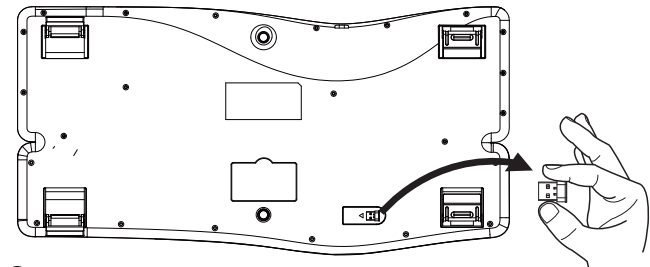

3 Insert the receiver into computer USB Port.

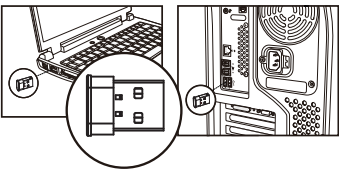

Overview

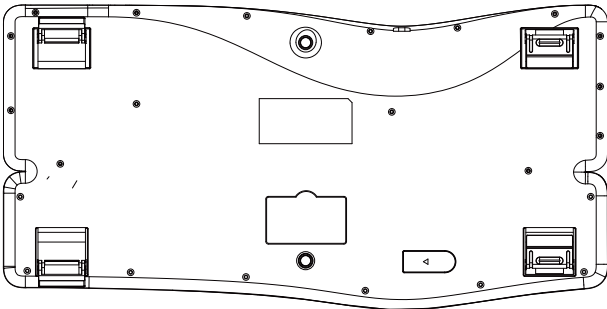
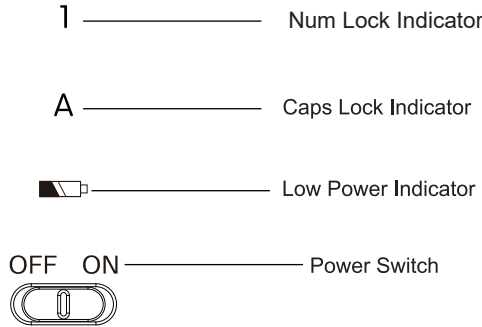

Operation Guides

1. Insert two 1.5V AA battery into the keyboard according to the positive and negative sign. And turn on the power switch.
2. Plug the receiver into the USB port of your computer.
3. When the computer installs driver automatically, they start to serve.

Functions of Combination Keys

- |                       |                     |
|-----------------------|---------------------|
| FN+F1= audio on FN    | FN+F7=play / pause  |
| +F2= volume down FN   | FN+F8= stop         |
| +F3= volume up FN     | FN+F9=homepage      |
| +F4=mute              | FN+F10= email       |
| FN+F5= previous track | FN+F11= my computer |
| FN+F6= next track     | FN+F12=favorites    |

Considerations

1. Use 1.5V AA battery only. To prevent from damage to internal elements, avoid using excessive-voltage batteries. If the product will be unused for a long time, take out the battery to prevent from corrosion.
2. The product adopts the 2.4GHz wireless transmission with a 10-meter transmission distance. The distance may be shortened for big obstructions and low battery.
3. For the first use, the product may fail to work (connection error etc.) for it has been unused for a long time. Try pairing again.

Solution to Connection Failures

1. Take out the battery from the keyboard and receiver from the computer.
2. Reinstall battery into the keyboard. And plug the receiver into the USB port of the computer.
3. Turn on the power switch of the keyboard, which should be within 20cm away from the receiver. Press and hold "ESC" and "K" keys together to pair again.

Note:

If the above solution doesn't help, repeat the above procedures to pair again. If it still can't work, contact our service team to work for you.

FCC Warning

This device complies with Part 15 of the FCC Rules. Operation is subject to the following two conditions:

(1) This device may not cause harmful interference, and (2) this device must accept any interference received, including interference that may cause undesired operation.

NOTE 1: This equipment has been tested and found to comply with the limits for a Class B digital device, pursuant to part 15 of the FCC Rules. These limits are designed to provide reasonable protection against harmful interference in a residential installation. This equipment generates, uses and can radiate radio

frequency energy and, if not installed and used in accordance with the instructions, may cause harmful interference to radio communications. However, there is no guarantee that interference will not occur in a particular installation. If this equipment does cause harmful interference to radio or television reception, which can be determined by turning the equipment off and on, the user is encouraged to try to correct the interference by one or more of the following measures:-

- Reorient or relocate the receiving antenna.- Reorient or relocate the receiving antenna.
- Increase the separation between the equipment and receiver.
- Connect the equipment into an outlet on a circuit different from that to which the receiver is connected.
- Consult the dealer or an experienced radio/TV technician for help.

NOTE 2: Any changes or modifications to this unit not expressly approved by the party responsible for compliance could void the user's authority to operate the equipment.

The device has been evaluated to meet general RF exposure requirement. The device can be used in portable exposure condition without restriction.