

RR MECHATRONICS – RPI – ECO 21

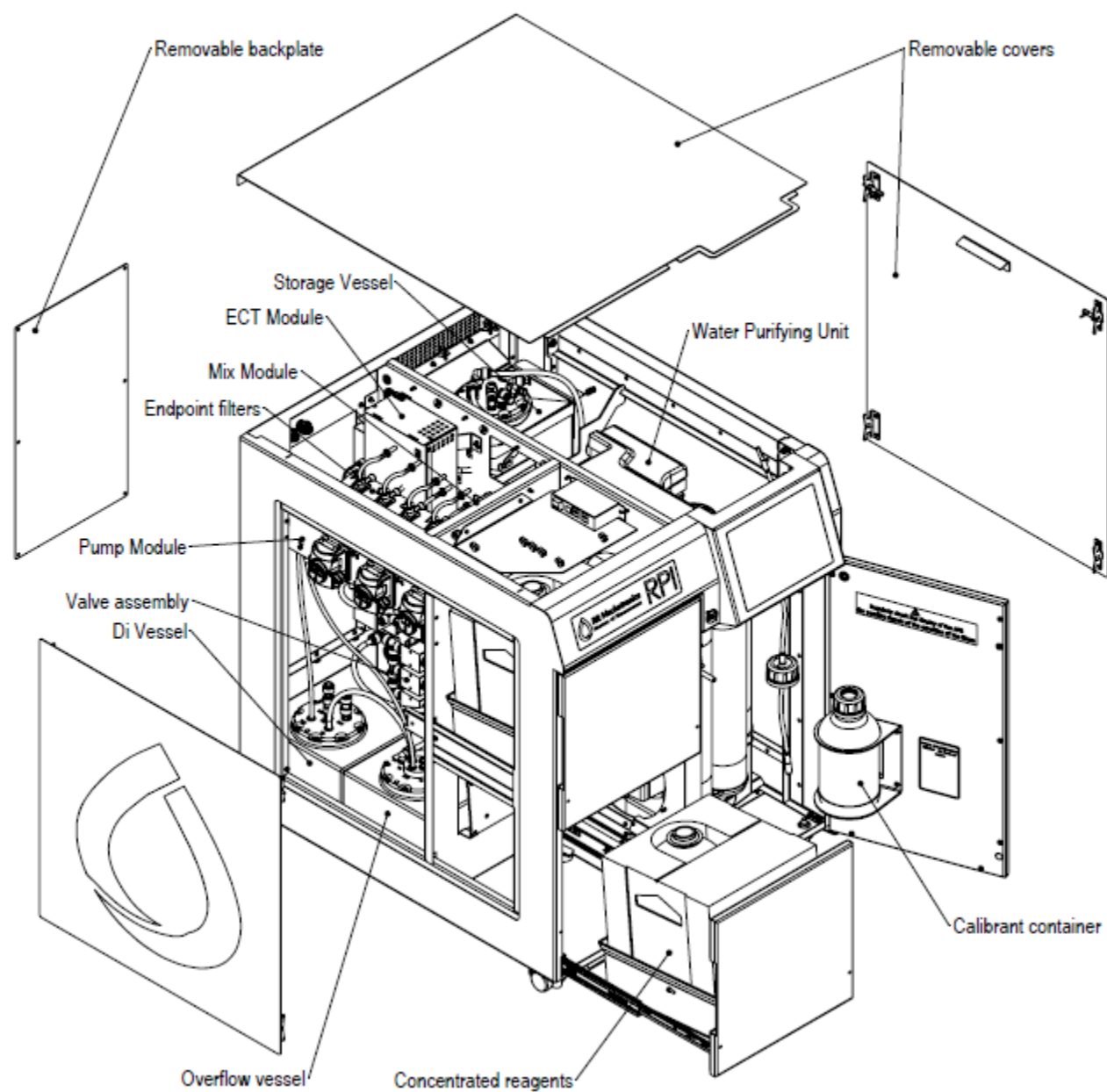

RR MECHATRONICS – RPI – ECO 21

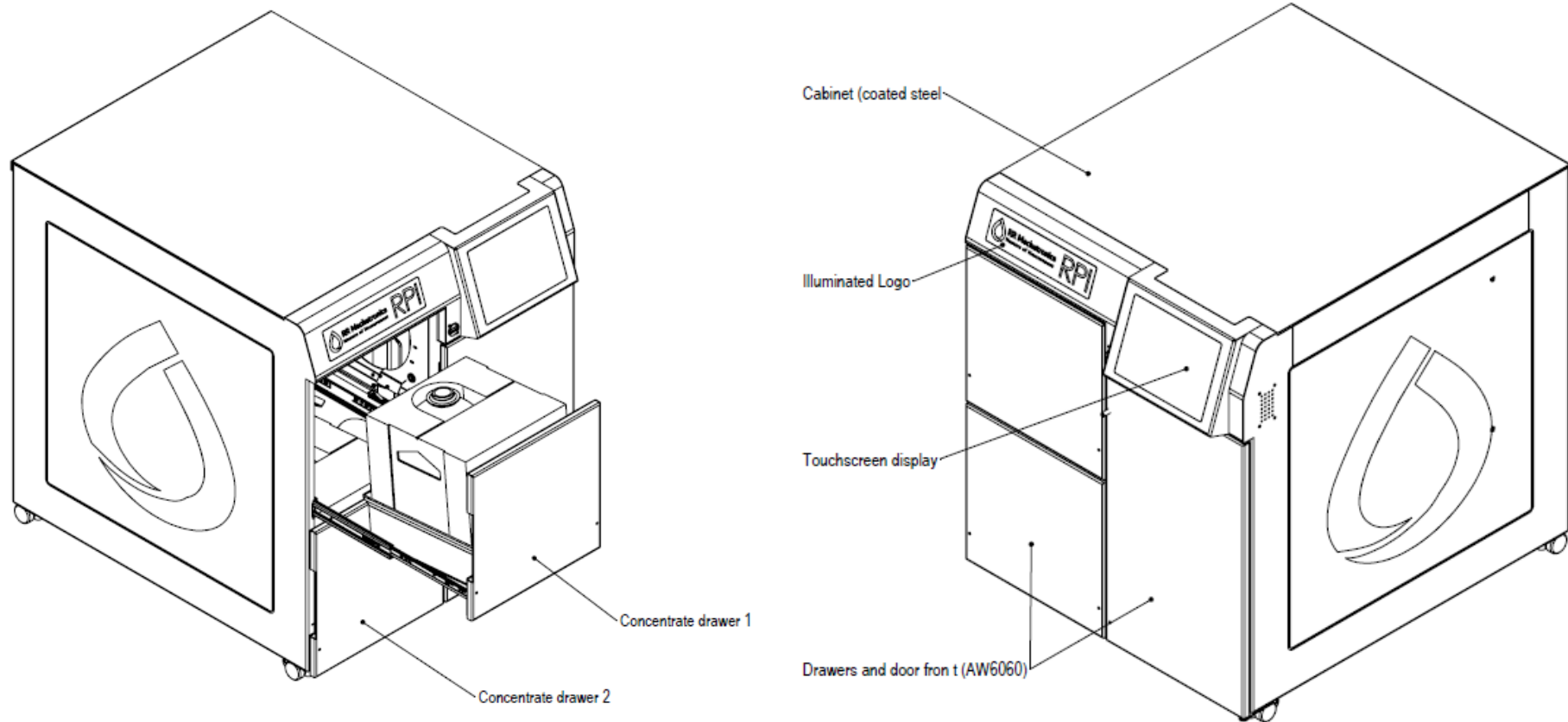

RR MECHATRONICS – RPI – ECO 21

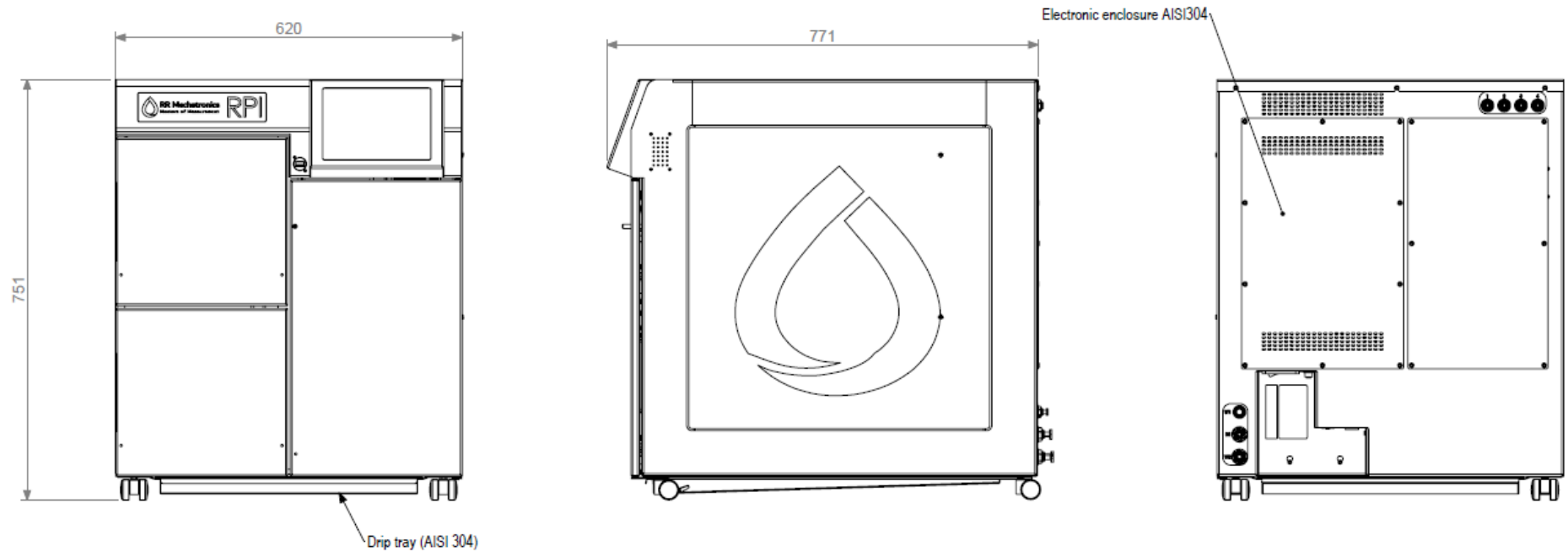

RR MECHATRONICS – RPI – ECO 21

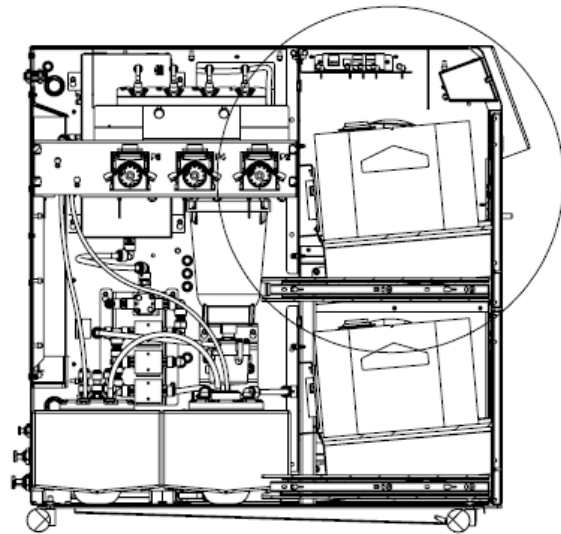

SECTION A-A

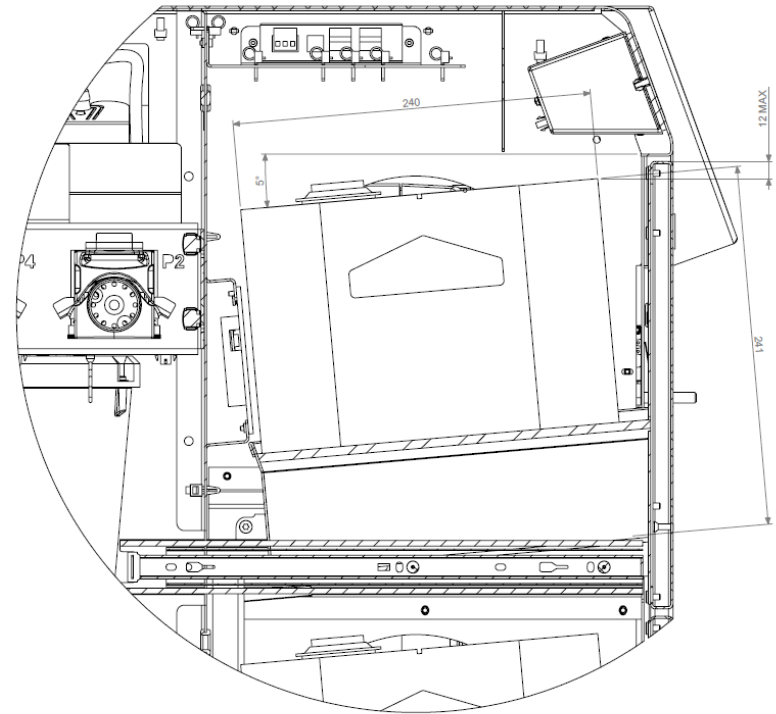
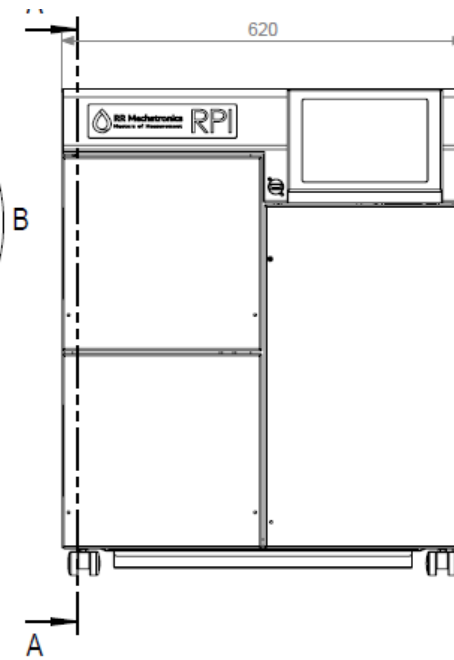

DETAIL B

RR MECHATRONICS – RPI – ECO 21



The image consists of two side-by-side photographs of a white industrial machine. The left photograph shows the exterior of the machine, which has a logo that reads "RR Mechatronics Masters of Measurement RPI". A green circle highlights the bottom corner of the machine where it sits on a wooden pallet. The right photograph shows the interior of the machine with its door open. A green circle highlights a component inside, which appears to be a sensor or camera module mounted on a bracket.



RR MECHATRONICS – RPI – ECO 21

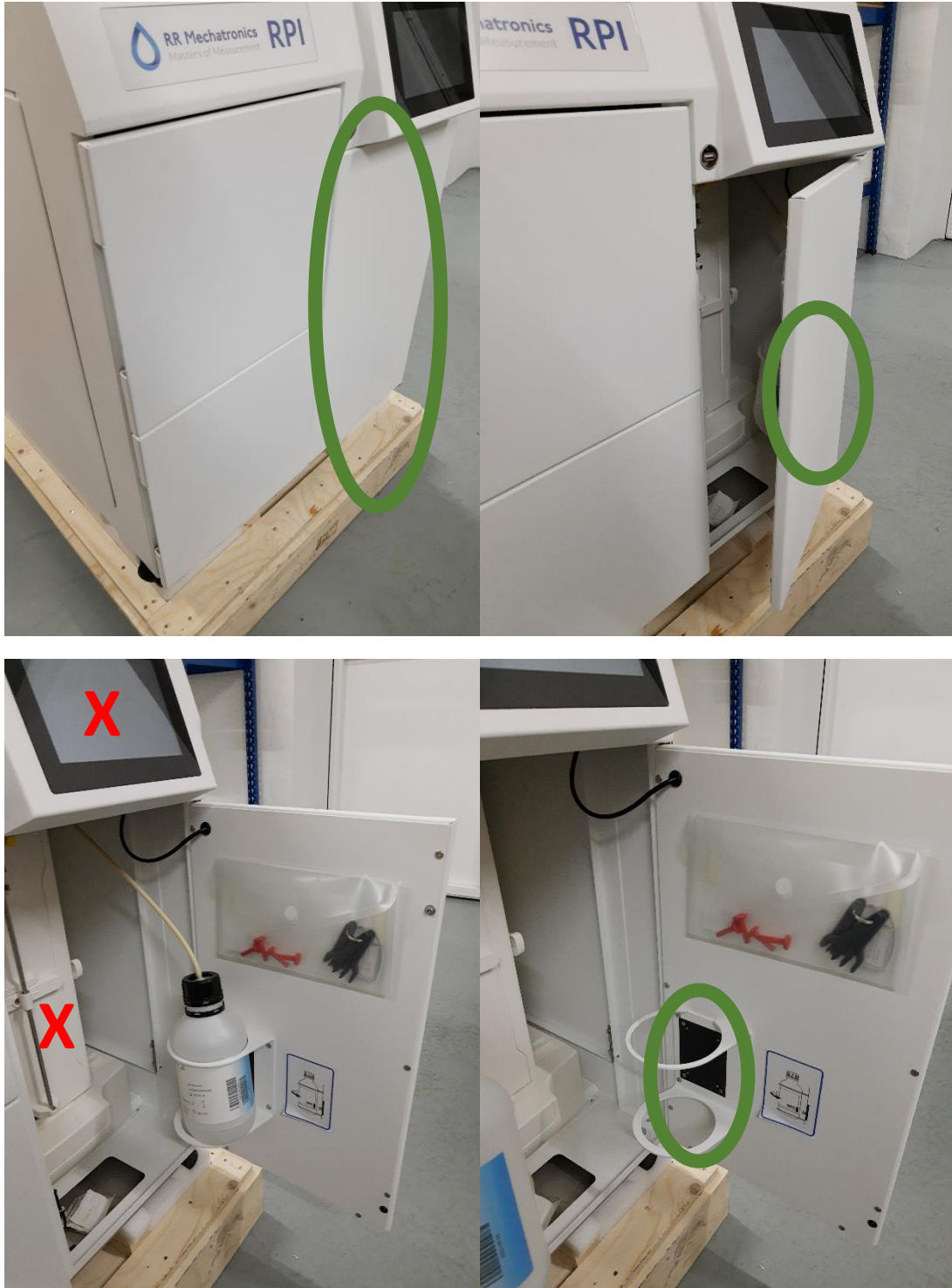

X = Not RF equipment

RR MECHATRONICS – RPI – ECO 21



RR MECHATRONICS – RPI – ECO 21



X = Not RF equipment

Top view:

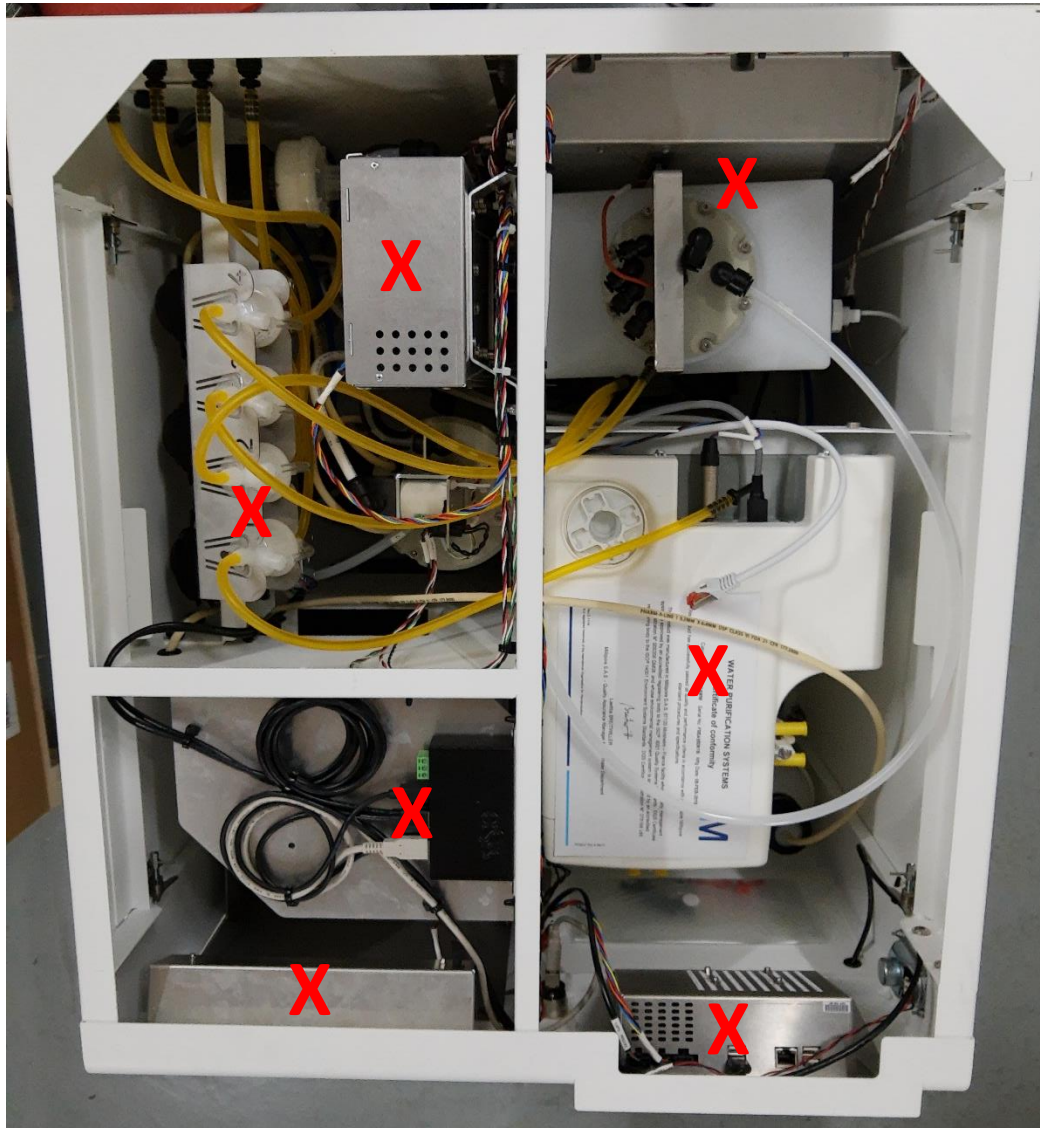

X = Not RF equipment

RR MECHATRONICS – RPI – ECO 21

Rear view:

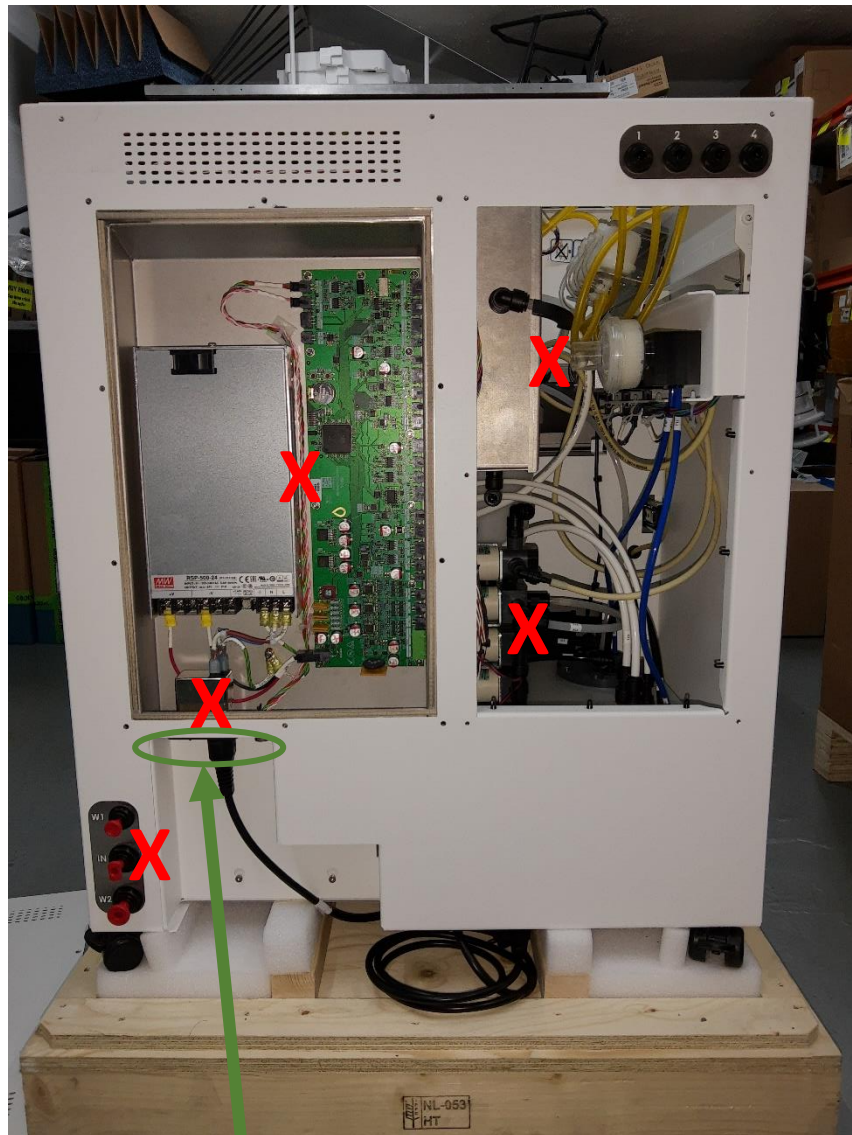

X = Not RF equipment



X = Not RF equipment

RR MECHATRONICS – RPI – ECO 21

Front and rear view of RF board:

