

产品说明

产品名称：AM INFINITY MOUSE  
产品型号：AM30  
电池容量：340mAh  
输入参数：5V=225mA  
接口类型：Type-C  
产品尺寸：118.0\*64.4\*40.2mm  
系统支持：Windows10、macOS 14.6 及以上操作系统（部分机型可能存在兼容性问题）



安装

鼠标出厂时内置了一个可充电的电池，在使用鼠标之前，请先取出电池并移除表面的绝缘保护膜，再装回电池。

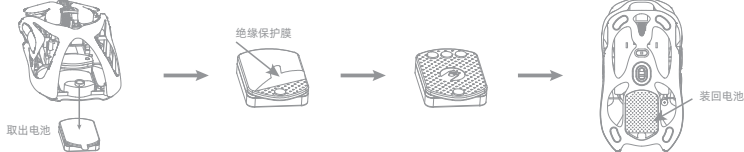

AM INFINITY 8K 接收器出厂时内置了一个可充电的电池，在使用 AM INFINITY 8K 接收器之前，请先取出电池并移除表面的绝缘保护膜，再装回电池。

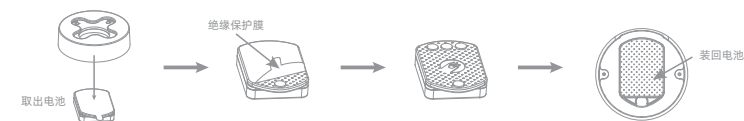

鼠标操作说明

1.鼠标连接

有线连接

使用随附的 8K 伞绳线将鼠标与计算机相连接，即可在有线模式下使用这款鼠标。

2.4G连接

1. 取出 AM INFINITY 8K 接收器，利用随附的 8K 伞绳线把 AM INFINITY 8K 接收器与计算机连接。

2. 将鼠标拨杆拨至右边，此时鼠标指示灯绿灯亮起，即可 2.4G 连接鼠标。

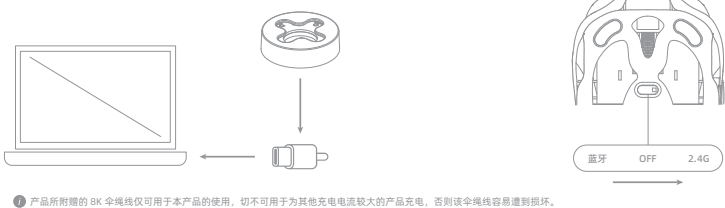

❶ 产品所附赠的 8K 伞绳线仅可用于本产品的使用，切不可用于为其他充电电流较大的产品充电，否则该伞绳线容易遭到损坏。

蓝牙连接

1. 将鼠标拨杆拨至左边，此时鼠标指示灯蓝色亮起代表处于蓝牙模式。首次配对时，指示灯蓝色快闪，鼠标进入配对模式；再次配对时，同时长按左键、中键和右键，直至鼠标指示灯蓝色快闪，此时鼠标进入配对状态。  
2. 在设备设置中开启蓝牙，从搜索到的设备中选择“AM INFINITY BT MOUSE”，然后按照界面提示完成配对。配对成功后，鼠标指示灯会熄灭。

2. DPI 设置

DPI 可以通过 AM Master 设置个性化数值和灯效颜色。（DPI可设置范围：50~30000）  
出厂默认1600，有 8 档：400、800、1200、1600、3200、6400、10000、30000

3. 鼠标回报率

鼠标回报率出厂默认 8KHz可以通过 AM Master 设置以下范围：125Hz、250Hz、500Hz、1KHz、2KHz、4KHz、8KHz

4. 其他功能

自动休眠模式

不操作鼠标的情况下，30 秒自动休眠，并可以通过 AM Master 设置

接收器灯效

可以通过 AM Master 个性化设置

充电显示

鼠标端：充电中 LED 白灯呼吸，充电完成 LED 白灯常亮，颜色可通过 AM Master 个性化设置

接收器端：

电池电量<20%：红灯呼吸

电池电量≥20%&<90%：橙黄灯呼吸

电池电量≥90%：绿灯呼吸

电池充满电后：DIY 灯效

安全须知

在使用和操作设备前，为确保设备性能最佳，并避免出现危险或非法规情况，请阅读并遵循所有安全信息。

- 设备产生的无线电波可能会影响植入式医疗设备或植入式设备的正常工作，如起搏器、植入耳蜗、助听器等。若您使用了这些医疗设备，请向其制造商咨询使用本设备的限制条件。
- 在使用本设备时，请与植入的医疗设备（如起搏器、植入耳蜗等）保持至少 15 厘米的距离。
- 请在温度 0℃~+35℃ 范围内使用本设备，并在温度 -10℃~+45℃ 范围内存放设备及其配件。当环境温度过高或过低时，可能会引起设备故障。当温度低于 5℃ 时，电池的性能会受到影响。
- 请勿将红外/激光光束指向任何人的眼睛或反射物。
- 请勿在森林、草地、牧场或靠近磁场的地方使用设备，以免引起设备内部电路故障。
- 本设备及其配件可能包含一些小零件，请将设备及其配件放置在儿童接触不到的地方。儿童可能无意间吞下小零件或设备及其配件，或吞下小零件导致窒息或其他危险。
- 请避免设备及其配件受潮或浸湿，否则可能导致火灾或触电危险。
- 请勿在高温或低温或低气压区域存放设备及其配件，否则可能导致设备故障、着火或爆炸。
- 请保持设备及其配件干燥。请勿使用微波炉或吹风机等外部加热设备对其进行干燥处理。
- 请勿使设备及其配件受到强烈的冲击或震动，以免损坏设备及其配件，导致设备故障。
- 请勿将电池暴露在高温或发热设备的周围，如日照、取暖器、微波炉、烤箱或热水器等。电池过热可能引起爆炸。
- 请勿将电池放置在较低气压环境中，可能导致电池爆炸或泄漏可燃液体或气体。
- 请勿把电池扔进火里，否则会导致电池起火和爆炸。
- 请勿跌落、挤压或穿刺电池。避免让电池遭受外部的压力，从而导致电池内部短路和过热。
- 请勿拆解或改装电池，插入异物，或浸入水或其它液体中，以免引起电池漏液、过热、起火或爆炸。
- 请按当地规定处理电池，不可将电池作为生活垃圾处理。若电池处置不当可能会导致电池爆炸。
- 请勿使用腐蚀性化学制品、清洗剂或强洗涤剂清洗设备或其配件。请使用清洁、干燥的软布擦拭设备或其配件。
- 请勿拆解或改装设备及其配件，否则该设备及配件将不在本公司保修范围之内，设备发生故障时请与 Angry Miao 售后联系。
- 请勿将本设备及其附件作为普通的生活垃圾处理。
- 请遵守本设备及其附件处理的本地法令，并支持回收行动。

产品中有有害物质名称及含量

部件名称	有害物质					
	铅 (Pb)	汞 (Hg)	镉 (Cd)	六价铬 (Cr(VI))	多溴联苯 (PBB)	多溴二苯醚 (PBDE)
印刷电路板	X	O	O	O	O	O
金属零件	O	O	O	O	O	O
塑胶零件	O	O	O	O	O	O
橡胶零件	O	O	O	O	O	O
电池	X	O	O	O	O	O
附件	X	O	O	O	O	O

本表依据 SJ/T 11364 的规定编制。

O：表示有害物质在该部件所有材料中的含量均在 GB/T 26572 规定的限量要求以下；

X：表示有害物质至少在该部件的某一均质材料中的含量超过 GB/T 26572 规定的限量要求；

且目前业界没有成熟的替代方案。请妥善处理此类部件或物质，以免对环境 and 人体健康造成影响。

本表格依据 SJ/T 11364 的规定编制。  
O: 表示该有害物质在该部件所有均质材料中的含量均在 GB/T 26572 规定的限量要求以下；  
X: 表示该有害物质至少在该部件的某一均质材料中的含量超出 GB/T 26572 规定的限量要求，且目前业界没有成熟的替代方案。请妥善处理此类部件或物质，以免对环境或人体健康造成影响。



根据中国电子行业标准 SJ/T 11364-2014 和相关的中国政府法规，本产品及其某些内部或外部组件上可能带有环保使用期限标识。取决于组件和组件制造商，产品及其组件上的使用期限标识可能有所不同。组件上的使用期限标识优于产品上任何与之冲突的或不同的环保使用期限标识。

售后服务

关于退换货

- 退换货时请务必开箱验货，如发现物流外包装破损或产品外观明显瑕疵，请立即拒收；如发现缺少零件或配件，请保留开箱的照片或视频，在 24 小时内联系我们。
- 自签收快递之日起 7 日内（包含 7 日）可以申请退货（个人定制产品除外），第 8-15 日内（包含 15 日）仅可以申请换货，或者选择免费维修。
- 对于修理产品，同一（1）件售出的产品，只能进行一（1）次退货或换货，如果没有库存进行更换，只能申请退货服务。
- 以下情况不在退换货范围内：
  - 超过了规定退换货时效；
  - 非产品质量问题的人为损坏；
  - 非经销商或官方授权平台产生的交易，比如二手平台的转售；
  - 产品内部经刮伤、刮痕、色差为正常现象。产品外观瑕疵小于 0.3mm 的点状刮伤、色差、色差、亚克力组件局部存在划痕、加工刀纹以及边缘的轻微刮伤等，均不在售后退换货。
- 因个人原因申请退货退款，运费将不予退还，且用户需承担产品退回的运费。

关于保修

当购买以下产品出现非人为损坏故障时，我们提供相应保修服务。请您提供相应购买凭证并在保修期限内联系我们！保修期限自快速签收之日起保修 2 年。

以下情况不在保修范围内：

- 无保修单据的购买产品；
- 已经超出保修期限；
- 意外原因或人为原因导致产品损坏；
- 未能按照官方授权平台产生的交易，比如二手平台的转售；
- 长时间使用导致的产品变色或表面磨损；
- 退换货、维修中由于运输、装卸导致的产品损坏，包括产品遗失；
- 因不可抗力因素（如雷电、地震、火灾等）造成的产品损坏；
- 未使用说明书要求安装、使用、维护、保管导致产品故障或损坏。

售后服务指引

退换货或送修前，请核对以下内容是否准备齐全：

	主机、配件齐全	包装完整	发票（若有）	发票（若有）
退货	√	√	√	√
换货	√	√	√	√
维修	√	√	√	√

1. 在免费保修期间的产品，在三包有效期内，消费者依照本规定享受修理、更换、退货的权利。如申请维修、更换下来的零件归您所有；对于维修无故障产品，将原样退回。  
2. 因产品不符合保修条件需收取维修费，将向消费者收取维修费，并提供维修报告。

包装清单

鼠标\*1

产品使用手册\*1

AM INFINITY 8K 接收器\*1

电池\*2

USB-A 转接头\*1

USB-C 到 USB-C 数据线\*1

备用替换脚垫\*1



Product Overview

Product Name: AM INFINITY MOUSE  
Model Number: AM30  
Battery: 340mAh  
Input: 5V= 225mA  
USB Port: Type-C  
Dimensions: 118.0\*64.4\*40.2mm  
System Requirements: Windows10, macOS 14.6 and above operating systems (some models may have compatibility issues)

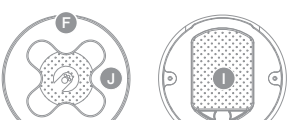

A Left Button  
B Right Button  
C Wheel & Middle Button  
D Forward Button  
E Back Button

F USB-C Port  
G Bluetooth and 2.4GHz Mode Switch  
H Infrared Sensor  
I Battery  
J AM INFINITY 8K Wireless Receiver

Setup Instructions

The AM INFINITY 8K Mouse comes with a built-in rechargeable battery. Please remove the battery, peel off the insulating protective film before use, and reinstall the battery.

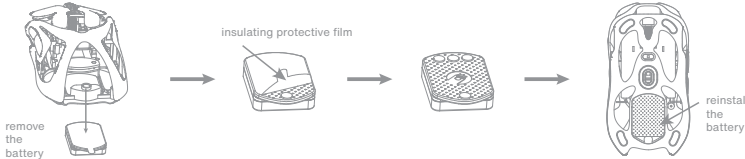

The AM INFINITY 8K Receiver also includes a built-in rechargeable battery. Before using the AM INFINITY 8K Receiver, remove the battery, peel off the surface insulating protective film, and reinstall the battery.

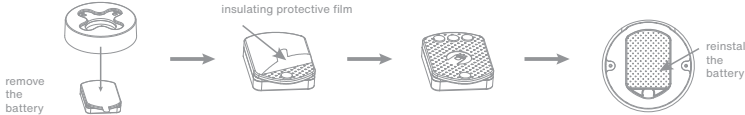

Mouse Operation Instructions

Mouse Connection

Wired Connection

Use the mouse in wired mode by connecting it to your computer with the included 8K paracord braided cable.

2.4GHz Connection

1. Connect the AM INFINITY 8K Receiver to your computer using the included 8K paracord braided cable.

2. Turn the Bluetooth and 2.4GHz mode switch to the right and the mouse indicator will turn green to show that the mouse is connected in 2.4GHz mode.

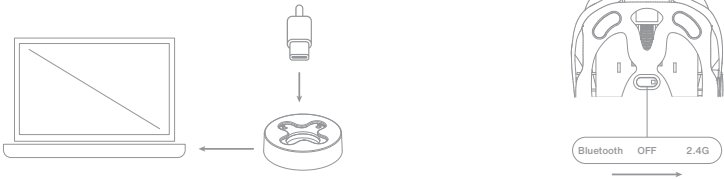

❶ The 8K paracord braided cable is only intended for use with this product and should not be used to charge other products with higher charging currents. Otherwise, the paracord braided cable may be damaged.

Bluetooth Connection

1. Slide the mode switch to the left to activate Bluetooth mode, the mouse indicated will turns blue. When pairing for the first time, the indicator blue light flashes rapidly, indicating the mouse enters pairing mode; when pairing again, simultaneously press and hold the left button, wheel button and right button until the mouse indicator blue light flashes rapidly indicating the mouse is in pairing mode.  
2. Enable Bluetooth in the device settings, select " AM INFINITY BT MOUSE " from the list of available devices, and then follow the on-screen instructions. After successful pairing, the mouse indicator will turn off.

2. DPI Indicator Settings

You can change the DPI can the matching light color effects through the AM Master. (DPI range: 50 to 30,000) The default factory setting is 1600, with 8 levels: 400, 800, 1200, 1600, 3200, 6400, 10000, and 30000.

3. Mouse Polling Rate

The mouse polling rate is set to the default 8kHz at the factory, and can be adjusted via the AM Master within the following options: 125Hz, 250Hz, 500Hz, 1kHz, 2kHz, 4kHz, and 8kHz.

4. Other Features

Auto Sleep Mode

The mouse will enter automatic sleep mode after 30 seconds of inactivity and can be set via AM Master.

Receiver lighting effects

It can be DIY through AM Master.

Charging Indicator

Mouse:The LED white light breathes while charging and stays solid once charging is complete. The color can be DIY through AM Master.

Receiver:

Battery level < 20%: Red LED breathing  
Battery level ≥ 20%&< 90%: Orange-yellow LED breathing  
Battery level ≥ 90%: Green LED breathing  
When fully charged: DIY lighting effects.

Safety Information

Before using and operating the device, to ensure optimal performance and to avoid dangerous or illegal situations, read and follow all safety information.  
- The radio waves generated by the device may interfere with the proper functioning of implanted medical devices or personal medical devices, such as pacemakers, cochlear implants, hearing aids, etc. If you use one of these medical devices, check with its manufacturer for restrictions on the use of this device.  
- Keep a distance of at least 15 centimeters from implanted medical devices (e.g., pacemakers, cochlear implants, etc.) when using this device.  
- Use the device within the temperature range of 0°C ~ +35°C and store the device and its accessories within the temperature range of -10°C ~ +45°C. When the ambient temperature is too high or too low, it may cause the device to malfunction. The performance of the battery is limited when the temperature is below 0°C.  
- Do not direct the infrared/laser beam at anyone's eye or a reflective object.  
- Do not use the device in dusty, damp, dirty or near magnetic fields as this may cause malfunction of the internal circuitry of the device.  
- The device and its accessories may contain small parts, keep the device and its accessories out of the reach of children. Children may inadvertently damage the device and its accessories or swallow small parts resulting in choking or other hazards.  
- Keep the equipment and its accessories away from rain or moisture, as this may result in a fire or electric shock hazard.  
- Do not leave the equipment and its accessories in areas of high or low temperatures, as this may result in equipment malfunction, fire, or explosion.  
- Keep the device and its accessories dry. Do not use external heating devices such as microwave ovens or hair dryers to dry them.  
- Do not subject the device and its accessories to strong shocks or vibrations, which may damage the device and its accessories and cause the device to malfunction.  
- There is a risk of fire or explosion if the battery is replaced with an incorrect type.  
- Do not expose the battery to high temperatures or around heat-generating equipment such as sunlight, heaters, microwaves, ovens, or water heaters. Overheating of the battery may cause an explosion.  
- Do not leave the battery in an extremely low air pressure environment, which may cause the battery to explode or leak flammable liquids or gases.  
- Do not throw the battery into a fire, as this may cause the battery to catch fire and explode.  
- Do not drop, crush or puncture the battery. Avoid subjecting the battery to large external pressures that could result in internal short-circuiting and overheating.  
- Do not disassemble or modify the battery, insert foreign objects, or immerse it in water or other liquids, as this may cause the battery to leak, overheat, catch fire, or explode.  
- Dispose of the battery according to local regulations and do not dispose of the battery as household garbage. Improper disposal of the battery may cause it to explode.  
- Do not use strong chemicals, cleaning agents or strong detergents to clean the device or its accessories. Wipe the device or its accessories with a clean, dry, soft cloth.

- If the battery leaks, do not allow skin or eyes to come into contact with the leaked device, pursuant to Part 15 of the FCC Rules. These limits are designed to provide reasonable protection against harmful interference in a residential installation. This equipment generates, uses and can radiate radio frequency energy and, if not installed and used in accordance with the instructions, may cause harmful interference to radio communications. However, there is no guarantee that interference will not occur in a particular installation. If this equipment does cause harmful interference to radio or television reception, which can be determined by turning the equipment off and on, the user is encouraged to try to correct the interference by one or more of the following measures:  
-- Reorient or relocate the receiving antenna.  
-- Increase the separation between the equipment and receiver.  
-- Connect the equipment into an outlet on a circuit different from that to which the receiver is connected.  
-- Consult the dealer or an experienced radio/TV technician for help.  
The device has been evaluated to meet general RF exposure requirement. The device can be used in portable exposure condition without restriction.

FCC Compliance Statement

This device complies with Part 15 of the FCC rules. Operation is subjected to the following two conditions: (1) this device may not cause harmful interference, and (2) this device must accept any interference received, including interference that may cause undesired operation.  
Changes or modifications not expressly approved by the party responsible for compliance could void your authority to operate the equipment.  
This equipment complies with FCC radiation exposure limits set forth for an uncontrolled environment.

This equipment has been tested and found to comply with the limits for a Class B digital device, pursuant to Part 15 of the FCC Rules. These limits are designed to provide reasonable protection against harmful interference in a residential installation. This equipment generates, uses and can radiate radio frequency energy and, if not installed and used in accordance with the instructions, may cause harmful interference to radio communications. However, there is no guarantee that interference will not occur in a particular installation. If this equipment does cause harmful interference to radio or television reception, which can be determined by turning the equipment off and on, the user is encouraged to try to correct the interference by one or more of the following measures:  
-- Reorient or relocate the receiving antenna.  
-- Increase the separation between the equipment and receiver.  
-- Connect the equipment into an outlet on a circuit different from that to which the receiver is connected.  
-- Consult the dealer or an experienced radio/TV technician for help.  
The device has been evaluated to meet general RF exposure requirement. The device can be used in portable exposure condition without restriction.



Aftersales Service

Return & Refund Policy

The following terms apply to regions outside of mainland China.  
Our policy lasts 72 hours for general items. If the time is due, we can't offer you a refund or exchange.  
There are certain situations in which we can't offer you a refund or exchange:  
- 72 hours have gone by since you received the item.  
- Any item not in its original condition, which is damaged or missing parts for reasons not due to our error.  
- Dislike due to personal preferences.  
- Original product packaging has been removed, affecting resale.  
- Transactions not originating from Angry Miao's official or authorized platforms, such as second-hand market orders.  
- Minor color variations, scratches, and color differences inside the product are considered normal. External appearances may show small dots, discolorations, or air striation/bubbles with diameters less than 0.3mm are not covered under warranty.  
- Individual position of the acrylic components may appear foggy, or have machining marks and minor roughness at the edge, which are considered normal.  
- Discoloration or surface corrosion caused by prolonged use is not covered under the warranty for replacement.  
1. If you need to refund or exchange, please click Contact Us bottom of our website and leave your message. We will contact you within 3 working days.  
2. To be eligible for a return, your item must be unused and in the same condition that you received it. It must also be in the original packaging. Any missing parts will delay the refund or cause partial refunds.  
3. You will be refunded after we receive the returned product and check it. Once your return is received and inspected, we will send you an email to notify you that we have received your returned item. Then your refund will be processed, and a credit will automatically be applied to your credit card or original method of payment, within 7 business days.  
4. If there is insufficient stock of exchanging products, we will inform you about the specific treatment.  
5. Please contact us first if you want a refund or exchange. We will not accept returns or exchanges if you haven't contacted us in advance.  
6. After-sales service: support@angrymiao.com.

Disclaimer

1. For related products purchased through non-official channels, we do not provide corresponding after-sales service and do not bear the transaction risk arising therefrom.  
2. All rights reserved by Angry Miao.

Package Include

-Mouse \*1 -AM INFINITY 8K Receiver\*1  
-Product manual\*1 -Battery\*2  
-USB-A adapter \*1 -USB-C to USB-C cable\*1  
-Alternative Replacement Mouse Feet\*1

