

5

HELIUM

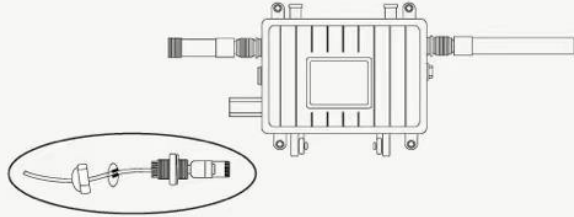

Install the network cable in the black part
Plug the network cable into a 48V POE power supply

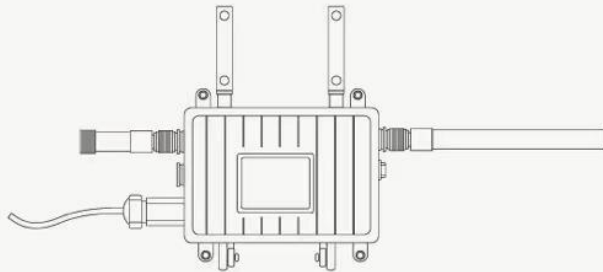

You have completed the installation of P100

HOW TO USE PISCES-P100

- Download [Helium] app in APPStore/Google play
- Open the [Helium] app, connect to Bluetooth within 5 minutes, or scan the QR code on the machine,
- Select Hotspot named PISCES-P100
- Confirm that the power supply and Bluetooth connection are successful
- [Helium] installation is complete, start scanning hotspot

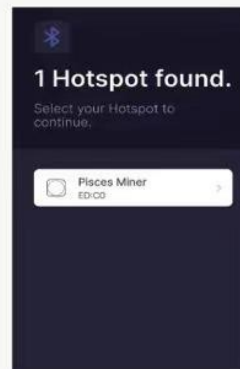

P100 GATEWAY

Installation and instructions

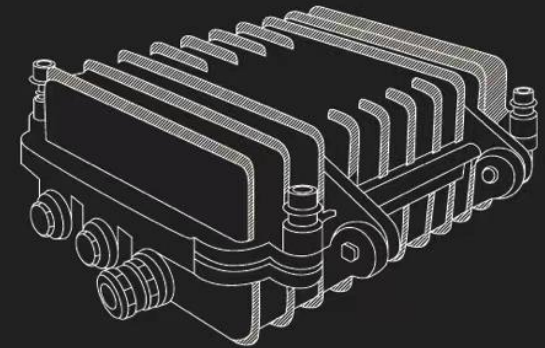

- Bluetooth 5.0,BLE.
- Signal range: up to 10 miles
- ECC608 crypto chip
- Arm64 High computing power CPU
- Support OTA, Dashboard
- Ultra-low power consumption: 5W Support POE
- SX1302.
- Tens of thousands of LoRaWAN end nodes



1

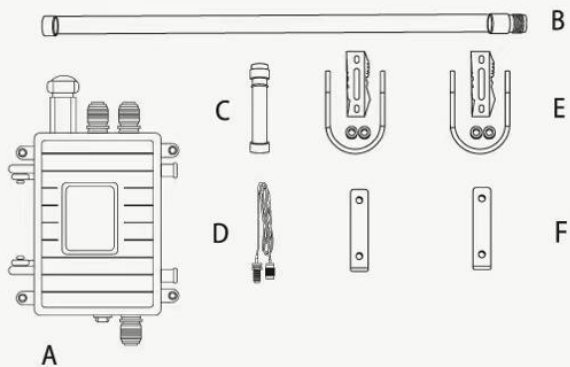

A:Host
B:Lora antenna
C:BLT
D:Lora antenna cable
E&F:Fixed components

Before assembling, please check whether the packing components are complete
if there are any missing, please contact PIECES

2

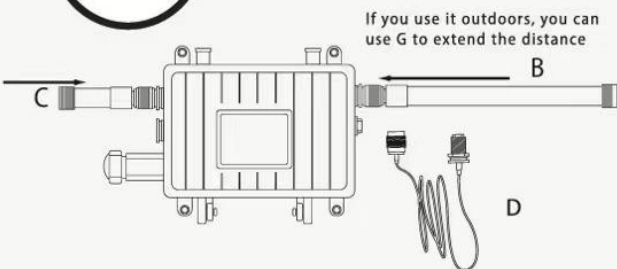

Corresponding to the label assembly accessories:B,C,D

3

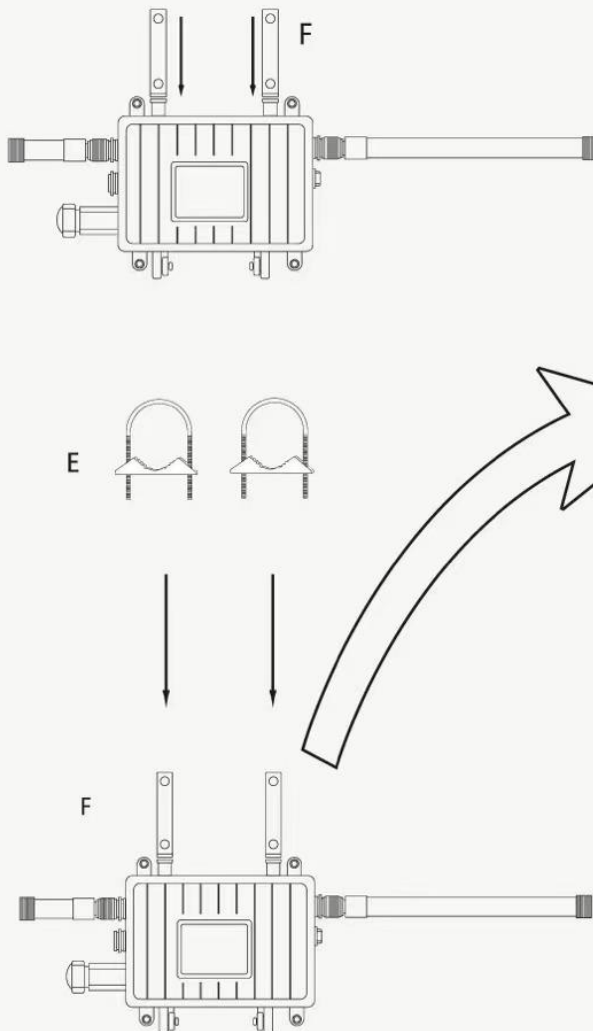

4

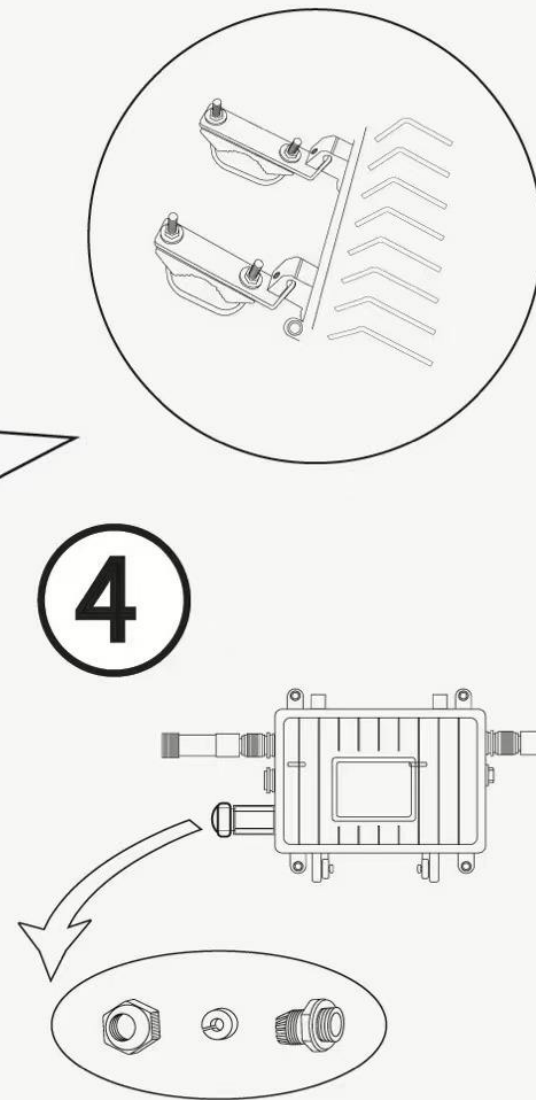

Unscrew the black plastic cap

This device complies with Part 15 of the FCC Rules. Operation is subject to the following two conditions: (1) this device may not cause harmful interference, and (2) this device must accept any interference received, including interference that may cause undesired operation

NOTE: This equipment has been tested and found to comply with the limits for a Class B digital device, pursuant to Part 15 of the FCC Rules. These limits are designed to provide reasonable protection against harmful interference in a residential installation. This equipment generates, uses and can radiate radio frequency energy and, if not installed and used in accordance with the instructions, may cause harmful interference to radio communications. However, there is no guarantee that interference will not occur in a particular installation.

If this equipment does cause harmful interference to radio or television reception, which can be determined by turning the equipment off and on, the user is encouraged to try to correct the interference by one or more of the following measures:

- Reorient or relocate the receiving antenna.
- Increase the separation between the equipment and receiver.
- Connect the equipment into an outlet on a circuit different from that to which the receiver is connected.
- Consult the dealer or an experienced radio/TV technician for help.

Warning: changes or modifications not expressly approved by the party responsible for compliance could void the user's authority to operate the equipment

Radiation Exposure Statement

This equipment complies with FCC radiation exposure limits set forth for an uncontrolled environment. This equipment should be installed and operated with minimum distance 20cm between the radiator and your body.

This transmitter must not be co-located or operating in conjunction with any other antenna or transmitter.