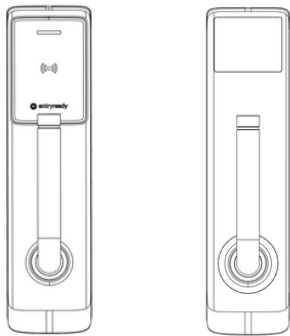

TABLE OF CONTENTS

IMPORTANT SAFEGUARDS	02
INSTALLATION:	
INSIDE THE BOX	04
RECOMMENDED TOOLS	05
USER GUIDE	
HOW TO OPERATE M2 LOCK	10
BATTERY REPLACEMENT	10
CHANGE HANDLE ORIENTATION	10
TROUBLESHOOTING	
EMERGENCY POWER.....	10
RED LED FLASHING	10
LOCAL ENCODER	10
USER ROLES	10
ACCESS POINTS	10
MAINTENANCE.	10
FCC COMPLIANCE STATEMENTS	11
CUSTOMER SERVICE	12

What's in the box



Front Escutcheon Rear Escutcheon



Optional Accessories:

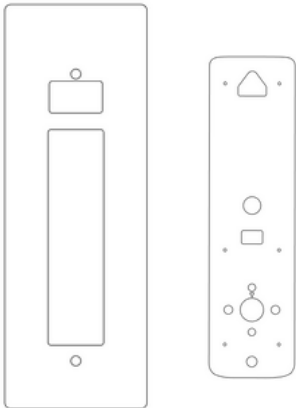

Cover Plate Rubber Gasket

Recommended Tools

Simple Installation:



Drill / Impact Driver



Phillips No. 3



Torx T10
Tamper-resistant
screwdriver



6 AA Alkaline
Batteries

Door Modification

A



Drill Bit
7/8 in (22.23 mm)

B



Drill Bit
1/2 in (12,7 mm)

C



Drill Bit
5/8 in (15.88 mm)

D



Drill Bit
3/8 in (9.53 mm)

E



Drill Bit
1 in (25.4 mm)

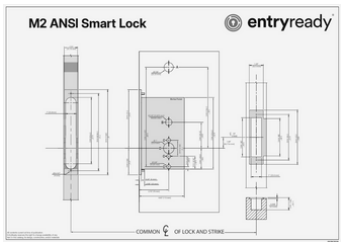

Door Template
* (Provided separately)

1 | Mounting Post Configuration

Attach the mounting post and washer in the appropriate configuration for your door type.

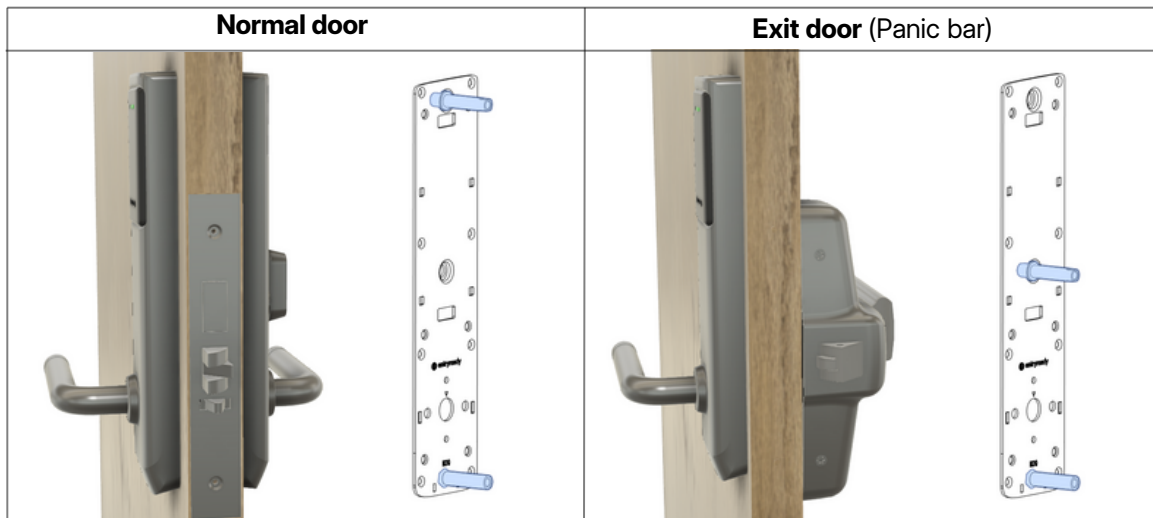
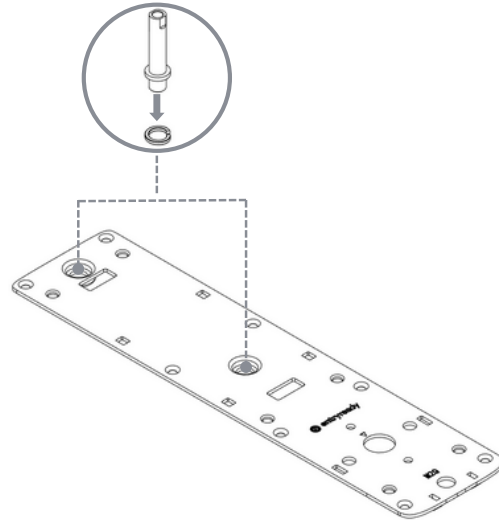
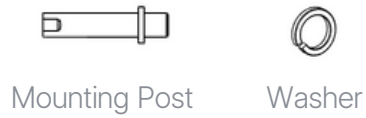

2 | Spindle

Press the spindle pin and install it in the spindle receiver.

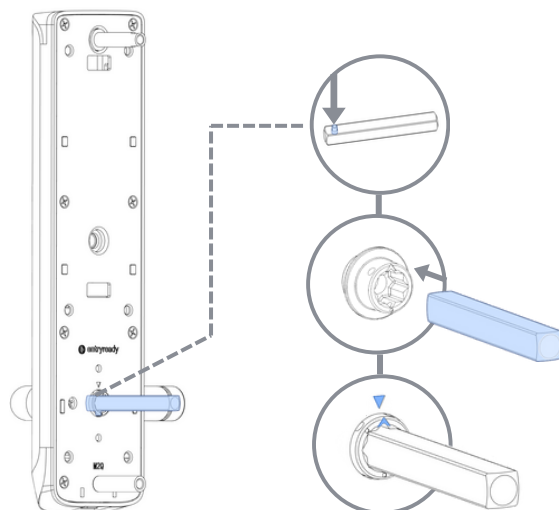
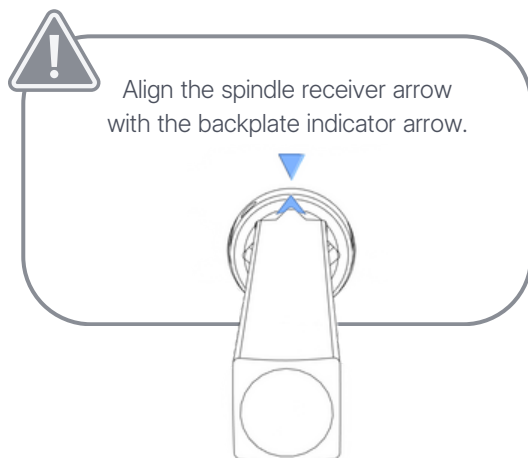

3 | Front Handle Orientation

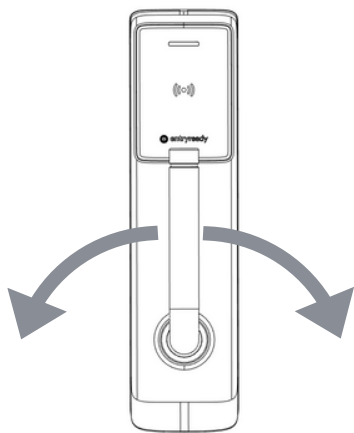

Turn the handle to the desired orientation.

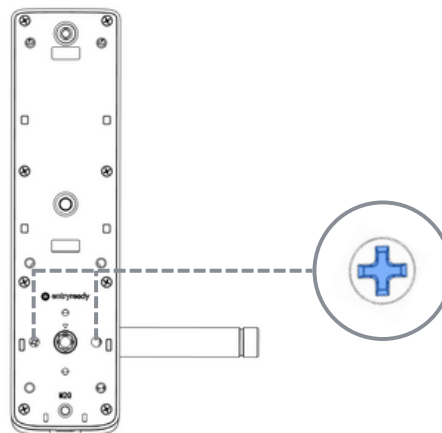

Secure the handle by tightening the screw

4 | Optional Accessories

4.a | Rubber Gasket

Mount the rubber gasket by aligning and inserting the six plugs into the designated holes on the backplate.

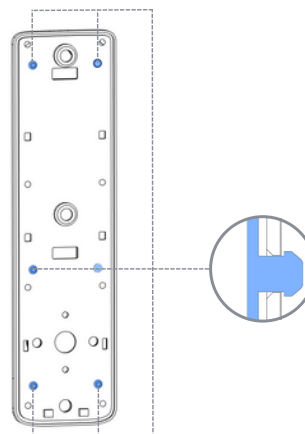

4.b | Cover Plate

Insert the mounting posts into the cover plate.

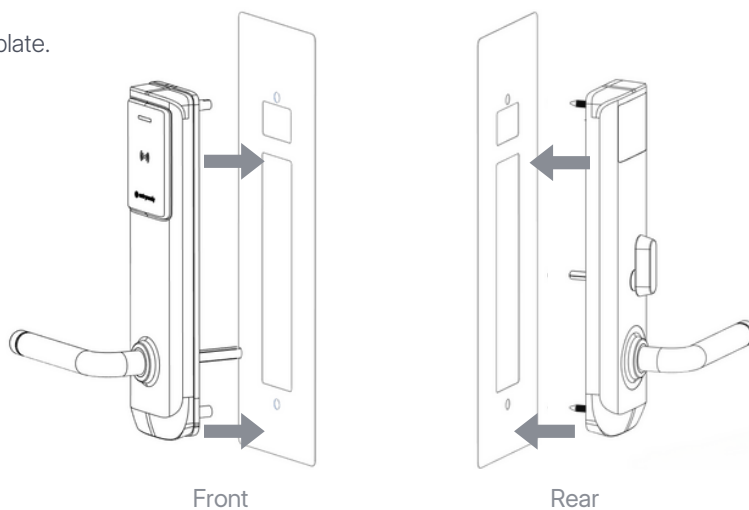

5 | Insert the Front Escutcheon

Insert the front escutcheon into the door through the mortise.

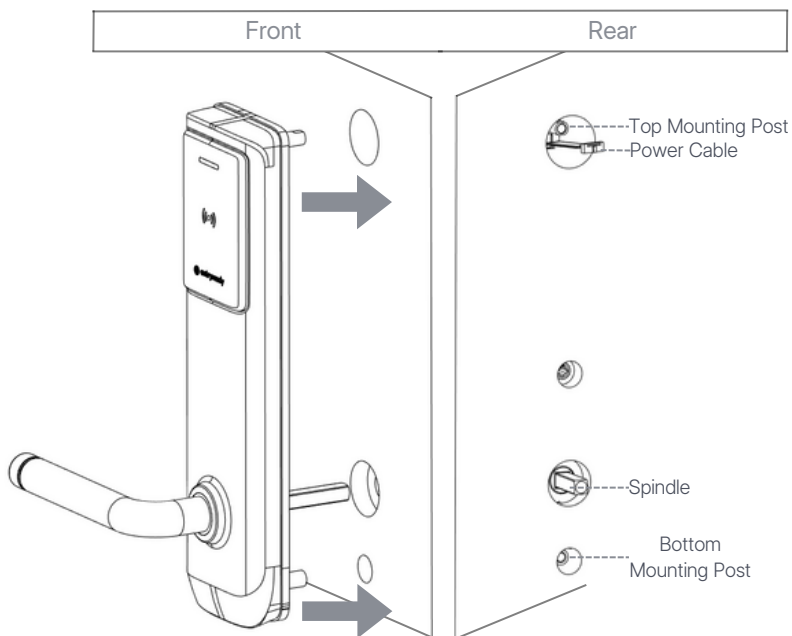
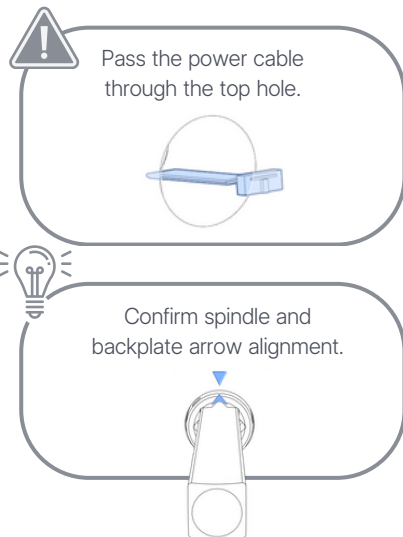

6 | Open the Rear Escutcheon

Turn the security screw at the bottom of the rear escutcheon clockwise and inward.

Open the rear escutcheon.

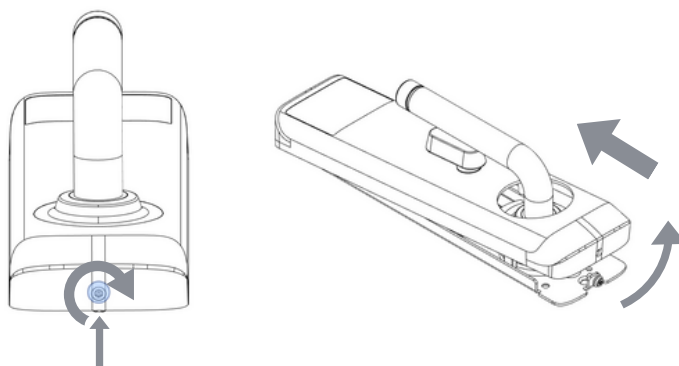

7 | Rear Handle Orientation

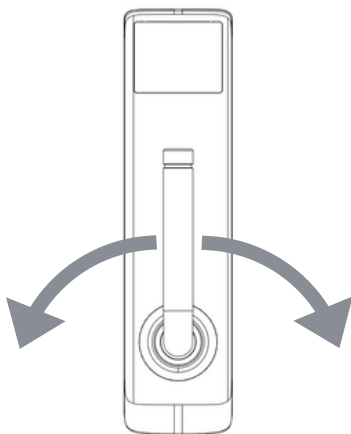

Turn the handle to the desired orientation.

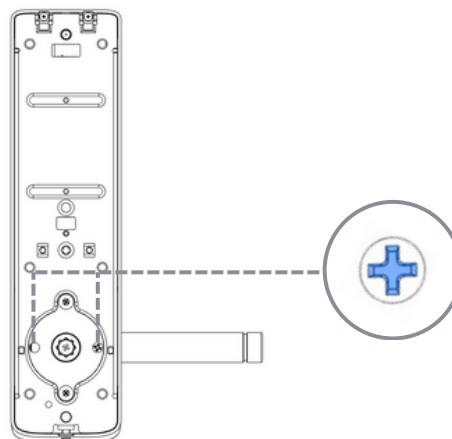

Secure the handle by tightening the screw.

8 | Connect Power Cable

Pass the power cable through the top hole.

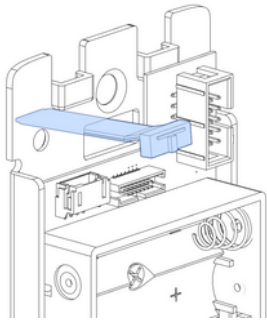

Connect the power cable to the middle connector.

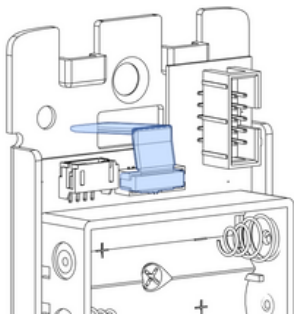

If the cover plate accessory is selected, install it by passing the power cable through it and aligning the mounting posts.

9 | Install Rear Backplate

Align the handle and thumbturn spindles.

Push the backplate against the door until it is flush with it.

Use a Phillips No. 3 bit to tighten each screw until secure.

Note: Don't over-tighten.



Phillips No. 3

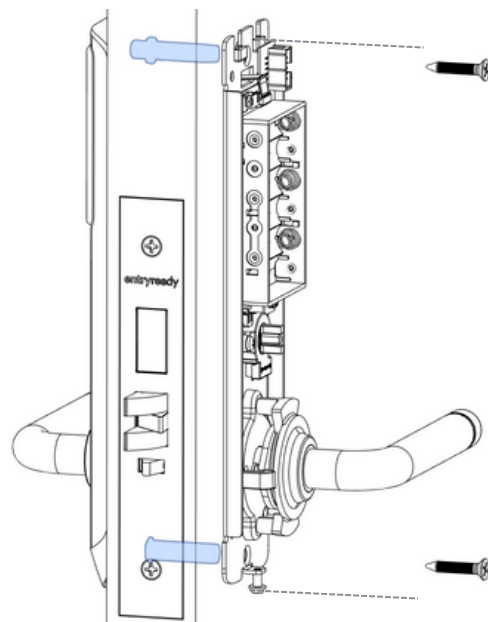
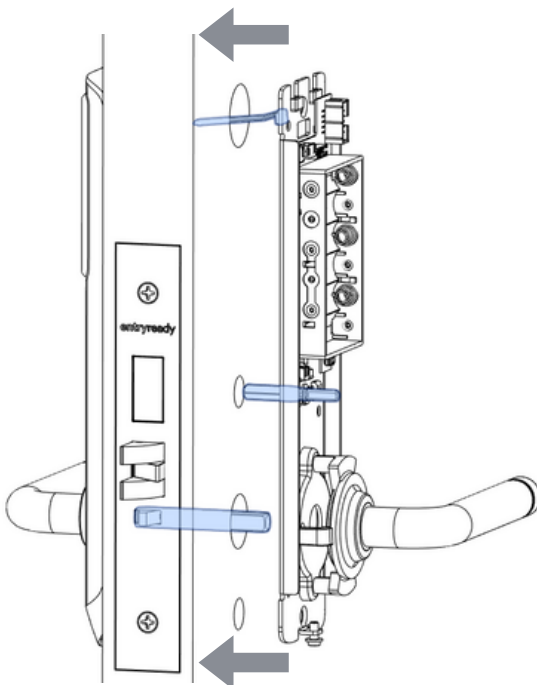

10 | Insert AA Batteries in the Battery Pack

Use 6 AA Alkaline Batteries.

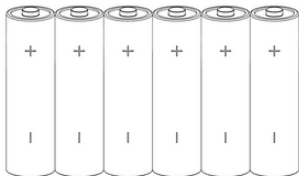

Install the batteries, ensuring the polarity matches the battery pack.

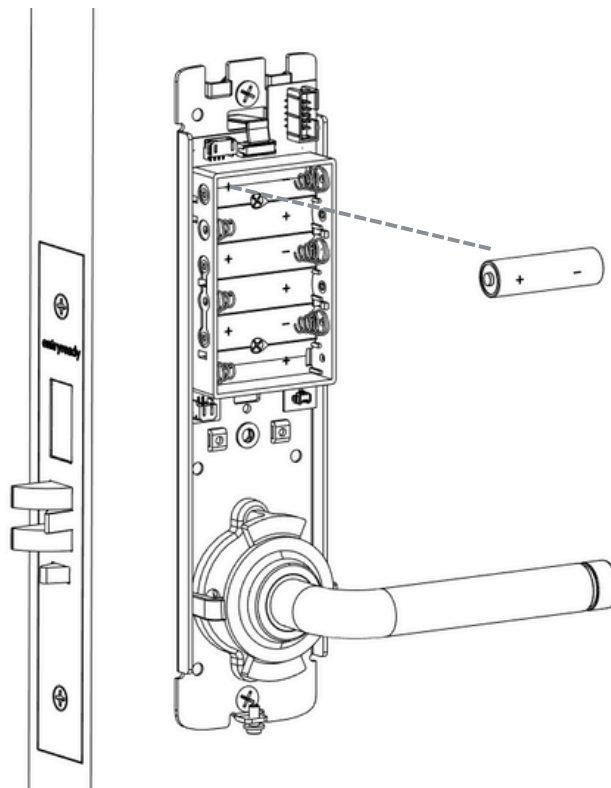

11 | Thumbturn Positioning

The thumbturn should be positioned upward.

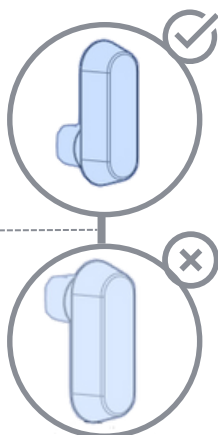
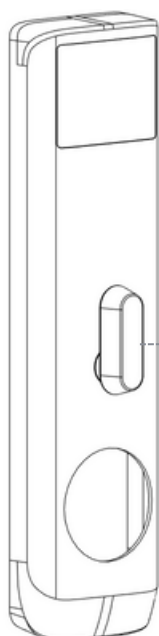

Adjust the thumbturn during the installation until it aligns with the internal mechanism.



12 | Re-Install Rear Escutcheon Cover

Hook the top of the lock.

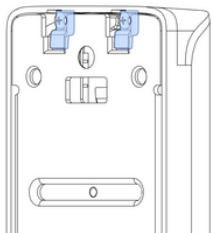

The bottom security screw should be fully inserted to close the rear escutcheon.

Install the rear escutcheon in an angular position.

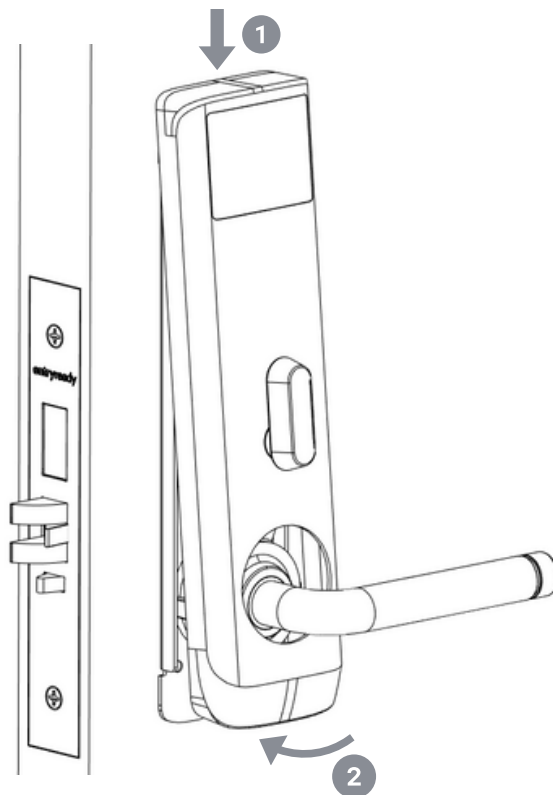

13 | Lock the Rear Escutcheon Cover

Turn the security screw located at the bottom of the rear escutcheon counterclockwise until the escutcheon is securely in place.



Torx T10
Tamper-resistant
screwdriver

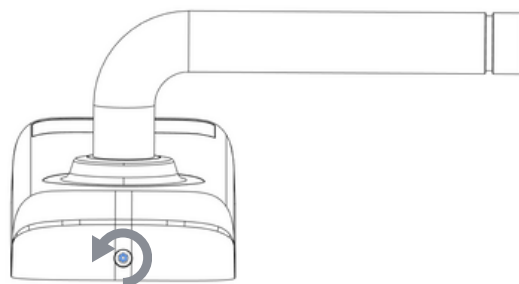
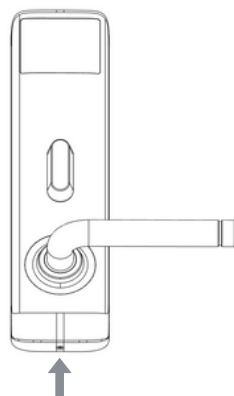

11 | Construction mode

The Construction Card allows you to control the lock by engaging or disengaging it, maintaining the selected state until the card is presented again. When you use the Construction Card, it will activate the LEDs, the clutch, and the buzzer to indicate the current status of the lock.

Engaging the Lock (Flashing GREEN LED)

1. Present the Construction Card to the lock.
2. The LED will begin to **flash GREEN**, indicating that the lock is engaged.
3. In this mode, you can open the door using the handle.

Disengaging the Lock (Flashing RED LED)

1. Present the Construction Card to the lock.
2. The LED will begin to **flash RED**, indicating that the lock is disengaged.
3. In this state, the handle will move freely **without opening the door**.



Each time you present the Construction Card, it toggles the lock between the engaged and disengaged states.

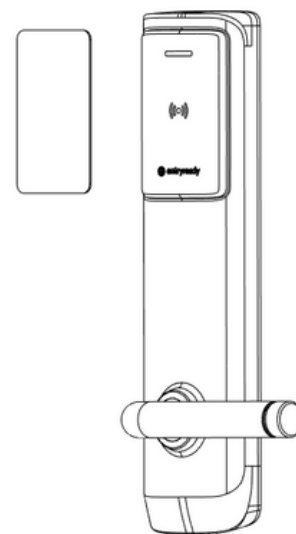

FCC Compliance Statements:

This device complies with Part 15 of the FCC Rules. Operation is subject to the following two conditions:

(1) this device may not cause harmful interference, and (2) this device must accept any interference received, including interference that may cause undesired operation.

Changes or modifications not expressly approved by the party responsible for compliance could void the user's authority to operate the equipment.

Note: This equipment has been tested and found to comply with the limits for a Class B digital device, pursuant to part 15 of the FCC Rules. These limits are designed to provide reasonable protection against harmful interference in a residential installation. This equipment generates, uses, and can radiate radio frequency energy and, if not installed and used in accordance with the instructions, may cause harmful interference to radio communications. However, there is no guarantee that interference will not occur in a particular installation. If this equipment does cause harmful interference to radio or television reception, which can be determined by turning the equipment off and on, the user is encouraged to try to correct the interference by one or more of the following measures:

- Reorient or relocate the receiving antenna.
- Increase the separation between the equipment and receiver.
- Connect the equipment into an outlet on a circuit different from that to which the receiver is connected.
- Consult the dealer or an experienced radio/TV technician for help.

Radiation Exposure Statement

This equipment complies with FCC radiation exposure limits set forth for an uncontrolled environment. This equipment should be installed and operated with minimum distance 20cm between the radiator and your body.

CUSTOMER SERVICE

Your Concerns, Our Commitment: We're Here to Help!

 www.entryready.com/resources/customer-support

 support@entryready.com

 (689) 233-3212