

TRUE WIRELESS EARPHONES

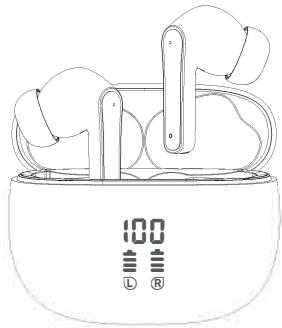

Z10 User Manual

WELCOME

Thank you for choosing Eumspo S2 True Wireless Earphones. Please read below instructions carefully before use. It will help you set up and operate this product properly and enjoy the advanced features.

PACKAGE INCLUDES

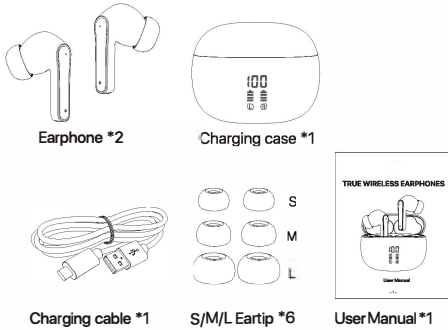

PRODUCT DESCRIPTION

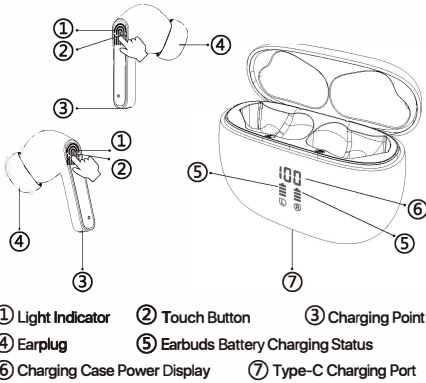

USAGE TIPS

For your best audio and wear experience, please wear the left and right earphone correctly and choose the ear-tips that best suits for your ear.

HOW TO TURN ON/OFF EARPHONES

POWER ON:

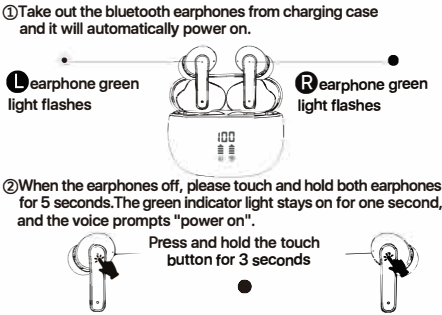

POWER OFF:

1. Please put the bluetooth earphones into the charging case, it will automatically switch off.
2. Please keep the earphones touch button pressed for 5 seconds, until the green indicator flashes once with voice prompt "power off".

HOW TO CONNECT

1. DUAL EAR MODE

1. Take out the earphones from charging case, they will automatically power on, pairing and the indicator light will flash quickly.
2. If pairing successfully, the green indicator light will turn off.
3. Activate your device's bluetooth function, setting- bluetooth-activate.
4. Use your bluetooth item to search "S2", click it and there will a voice prompt "Connected".

2. SINGLE EAR MODE

1. Take out one earphone from the charging case and it will automatically power on.
2. Activate your device's bluetooth function and search for "S2".
3. Click it and there will a voice prompt "Connected".

Wireless earphones Connection

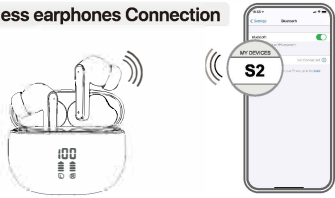

EARPHONES OPERATION

Answer the call / End the call

Click the touch button twice



Reject the call

Press the touch button for 2s



VOLUME+/-

Click the button once to adjust the volume ("Left earphone" for decreasing, "Right earphone" for increasing)



Voice Assistant

Click the touch button three times to activate the Siri voice assistant.



MUSIC

Play/Pause

Click the touch twice to play/pause the music



Previous/Next Song

Press the touch button for 1.5 seconds and release it ("Left earphone" for previous song, "Right earphone" for next song)



HOW TO CHARGE

When the earphones emit a "Battery Low" beep as a low battery alarm, you can conveniently place them into the charging case for automatic recharging. This will ensure that the earphones are charged and ready for use.

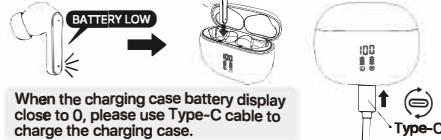

It is recommended to gently wipe the spring needle and copper column with a cotton swab on a regular basis to achieve a cleaning effect. Never use liquids to clean the earbuds.

Note: When the earbuds is not charging, you can use a cotton swab to gently wipe the spring needle and copper post.

TROUBLESHOOTING

1. The earphones can't power on

How to fix it: Charge the earbuds/Keep the earphones touch button pressed for 8 seconds.

2. Only one earphone has sound

How to fix it: 1. Check if it is pairing unsuccessful between L and R earbuds. 2. Put the earphones into the charging case, take out the pairing again.

3. The two earphones have no sound

How to fix it: 1. Check if it is correctly connected with the phone. 2. Check the earphones battery whether was run out of. 3. Increase the volume of the earphones and mobile devices (or music playback applications).

4. The earphones cannot be connected to the smart device

How to fix it: 1. Confirm the status of the bluetooth function. 2. Turn off bluetooth function of your device, delete the historical connection and connect again. 3. Or please try to connect other accessories device.

WARNING

1. Host device is a connection between second device and your mobile phone it is normal status under high power consumption.
2. When not connected to any device, the earphones will power off automatically after 5 minutes.
3. Use only 5V/1A power supply. Connecting the power supply voltage too high may cause serious damage.
4. When the earphones and the charger case are not used for long periods of time, it is recommended to keep them in a dry place and to recharge them at least every 2 months.

PRODUCT FEATURE

Model:	S2
Version:	5.3
Charging Case Battery:	380mAh
Capacity of Earbuds:	40mAh
Headphone Charge Time:	About 1.5Hrs
Music Playing Time:	About 6Hrs
Profiles Supported:	HFP/A2DP/AVRCP
Operating Frequency:	2.40 GHZ-2.48 GHZ
RF Sensitivity:	-94.5 dBm
Working Temperature Range:	-10+50°C
Maximum Transmission Range:	<33 feet (NO obstacle)

Shenzhen Kailige Technology CO., Ltd.
Room 401, Building E, Weihuada Industrial Park, Xinshi Community, Dalang Street, Longhua District, Shenzhen, Guangdong, CN

EC REP C&E Connection E-Commerce (DE) GmbH
Zum Linnegraben 20, 65933, Frankfurt am Main, Germany



MADE IN CHINA

FCC Warning

This device complies with part 15 of the FCC Rules. Operation is subject to the following two conditions: (1) This device may not cause harmful interference, and (2) this device must accept any interference received, including interference that may cause undesired operation.

Any Changes or modifications not expressly approved by the party responsible for compliance could void the user's authority to operate the equipment.

Note: This equipment has been tested and found to comply with the limits for a Class B digital device, pursuant to part 15 of the FCC Rules. These limits are designed to provide reasonable protection against harmful interference in a residential installation. This equipment generates uses and can radiate radio frequency energy and, if not installed and used in accordance with the instructions, may cause harmful interference to radio communications. However, there is no guarantee that interference will not occur in a particular installation. If this equipment does cause harmful interference to radio or television reception, which can be determined by turning the equipment off and on, the user is encouraged to try to correct the interference by one or more of the following measures:

- Reorient or relocate the receiving antenna.
- Increase the separation between the equipment and receiver.
- Connect the equipment into an outlet on a circuit different from that to which the receiver is connected.
- Consult the dealer or an experienced radio/TV technician for help.

The device has been evaluated to meet general RF exposure requirement. The device can be used in portable exposure condition without restriction.