

---

## 2. For Android

Connect same Wi-Fi network>---Open Cast/SmartView...  
on Android phones>---Select **Mudix-xxxx**



---

- **What should I do if the image is up side down?**

Enter "Projection settings">---Press"OK"key when at "Projection mode"

- **What should I do if the remote control is unresponsive?**

Check if there are batteries in remote control;

Check if the batteries are completely drained;

Check if the projector is powered on.

- **Shadow on the screen or smoke from the device?**

Powered off immediately;

It is caused by the poor cooling of the projector;

How to avoid: Please do not block the air outlet of the projector, It would cause poor cooling issue.

- **Why does the projector shut off when using?**

Please do not block the air outlet of the projector, it would cause poor cooling issue. The device will automatically shut off to protect the projector when the temperature is too high.

- **What should I do if there are small spots on the projected screen?**

Dust on the display screen cause small spots. To avoid this issue, do not use the device in dusty or smoky environment.

- **Is 3D effect supported?**

Not supported.

- **Can I display slides with this projector?**

Yes, only when using HD devices.

- **Why does the external storage not working, especially large capacity hard disk?**

The projector can support hard disks up to 1TB.

The 3.5-inch hard disk requires an external power supply to the projector. The 2.5-inch hard disk does not need an external power supply.

- **What type of external drives are supported in USB mode?**

FAT32 and NTFS are supported for U disk and TF card, while exFAT is not supported. If your USB drive is not recognized, you can format it to FAT32 or NTFS on a PC, then re-connect it to the projector.

- 
- Please scan the QR code via phone or visit [https://mudix.afterservice.vip](https://mudix afterservice.vip) to REGISTER and EXTEND warranty.
  - Defective item received or issues with product, please scan the QR code via phone or visit <https://mudix.afterservice.vip> to contact our 7/24 after service team.
  - Any questions, advice or product issues, please send e-mail to [mudix@afterservice.vip](mailto:mudix@afterservice.vip).

**For more information, scan here to contact us**

Get 24/7 Assistance at



Use camera or QR scanner to scan

**Or Visit: <https://mudix.afterservice.vip>**

## PROJECTOR COMPONENTS & FUNCTIONS

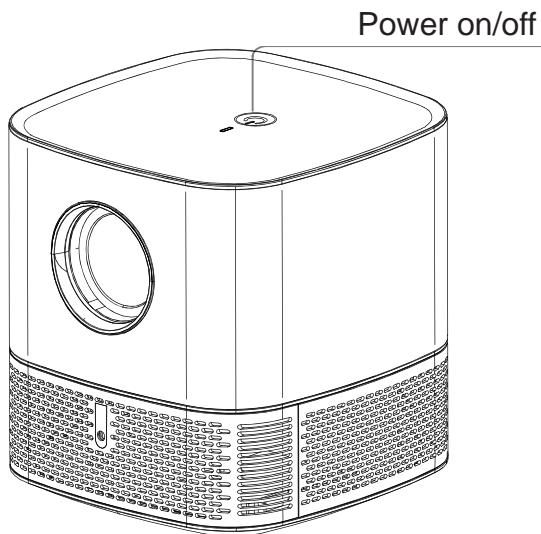

## REMOTE CONTROL BUTTONS

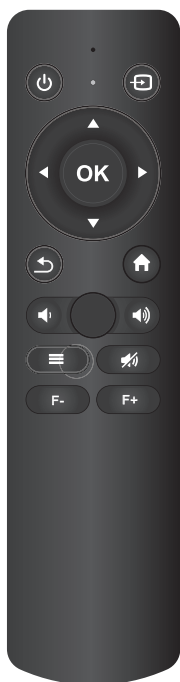

	Power		OK
	HD		Volume -
	Mute		Volume +
	Up		Home
	Down		Return
	Left		Focus-
	Right		Focus+
	Menu		

## EQUIPMENT CONNECTION

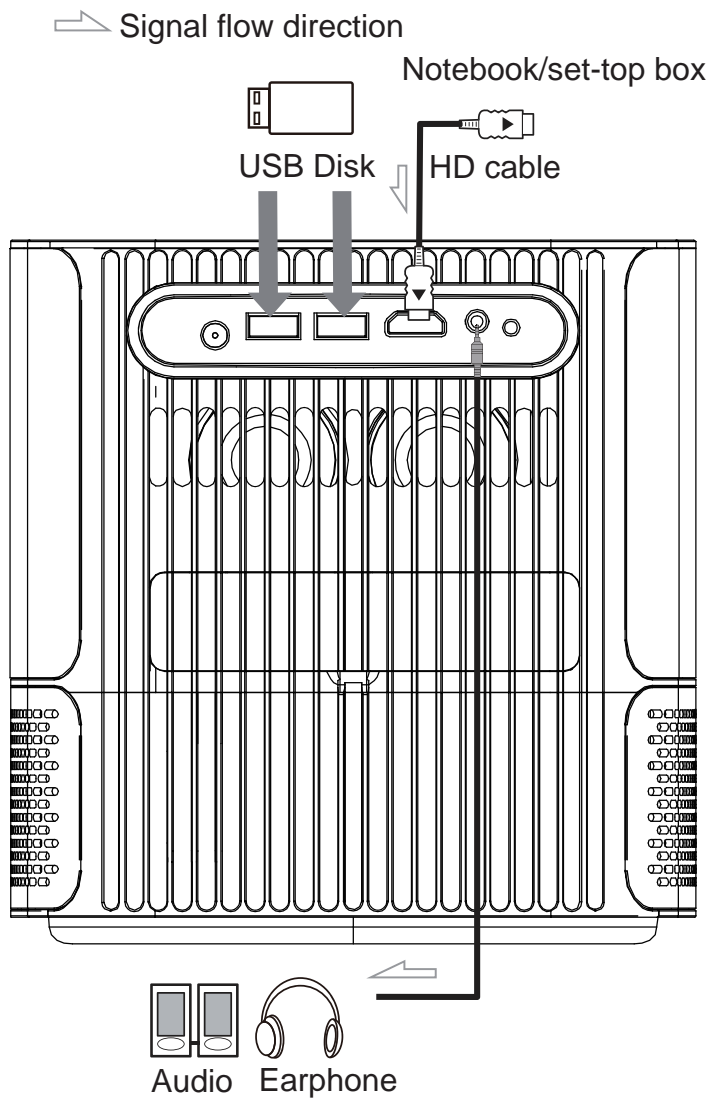

# INSTALLATION & ADJUSTING

## 1 Placement

Place projector on a flat, stable foundation squarely in front of the projection surface. For best results, the projection surface shall be white and flat. The distance between this projector and the projection surface must be a minimum of 1.2 meters (47 inches).

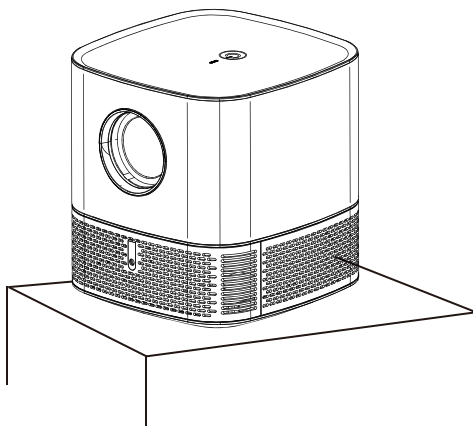

## 2 Adjust The Focus

Using remote control to adjust the focus of image.

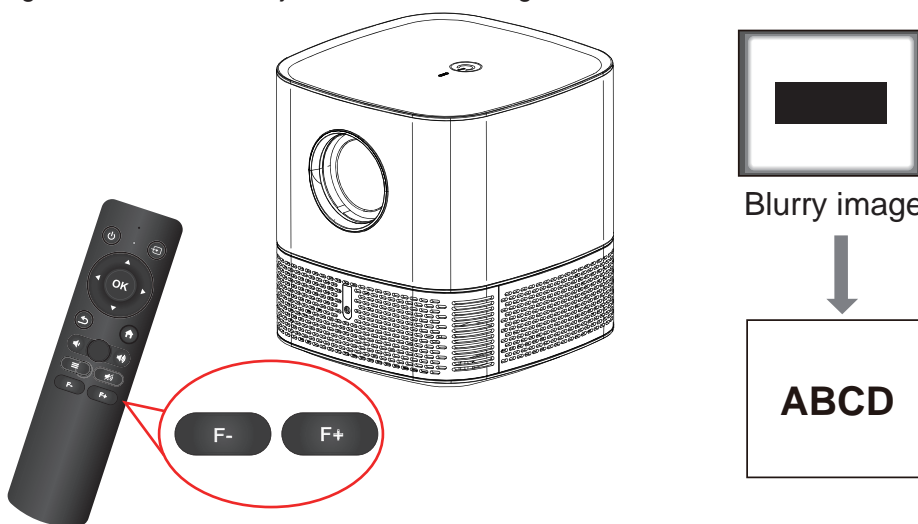

# INSTALLATION & ADJUSTING

## 3 Projection Distance Reference

The distance between this projector and the projection surface determines the approximate size of the image.

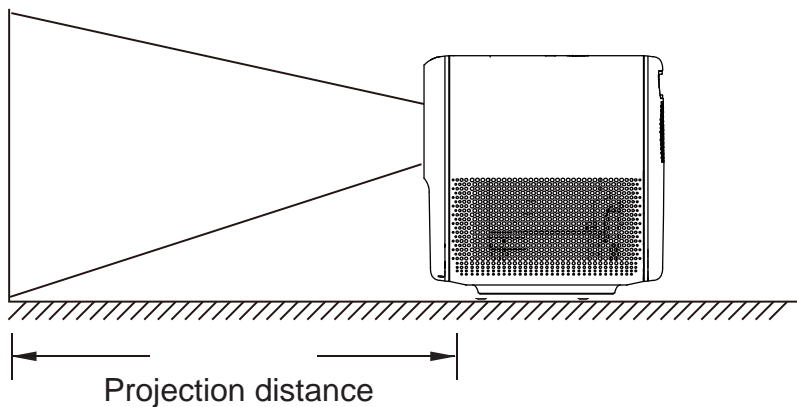

Projection size (inch)	Projection size (H*W) (inch)		Projection distance (inch)
36	(H)18.5	(W)31.49	43.4
56	(H)29.5	(W)52.36	66.9
66	(H)34.25	(W)61.02	78.74
86	(H)41.33	(W)73.22	98.4
96	(H)47.24	(W)83.8	110.2
116	(H)58.66	(W)104.72	133.8
136	(H)68.16	(W)122.04	203.8
156	(H)77.66	(W)139.36	227.4
176	(H)86.16	(W)156.68	301

## INSTALLATION & ADJUSTING

### 4 Power On/Off

#### Power on

1. Connect this projector to an electrical outlet by using the provided power cord and adapter.
2. Remove the lens sticker.
3. Press the **Power** button on the projector to power on. Then turn this projector towards a flat, white projection surface.

#### Power off

Power off the device before removing the power supply from the socket.

Store the projector in a cool dry place.

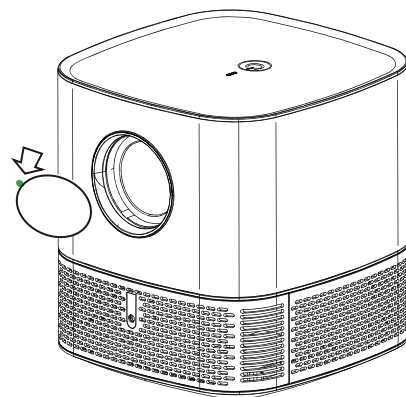



## HOME PAGE

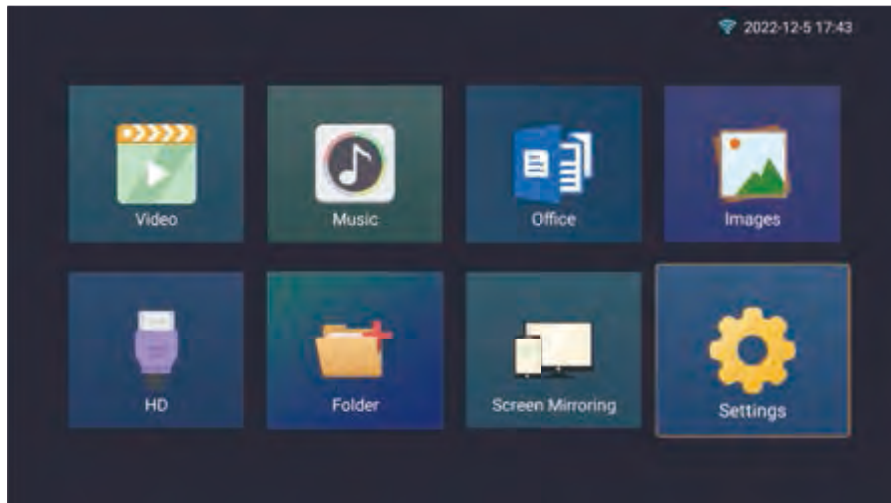

**To play from HD playback devices, select "HD" and press "Enter".**

This projector can be connected to various HD playback devices such as a TV box, TV stick, DVD player, set-top box (STB), gaming console, or other devices. To play from HD playback devices, connect this projector to an HD playback device with an HD cable.

**To play from a USB drive, select "Movie" , "Music" , "Photo" , "Office" and press "Enter".**

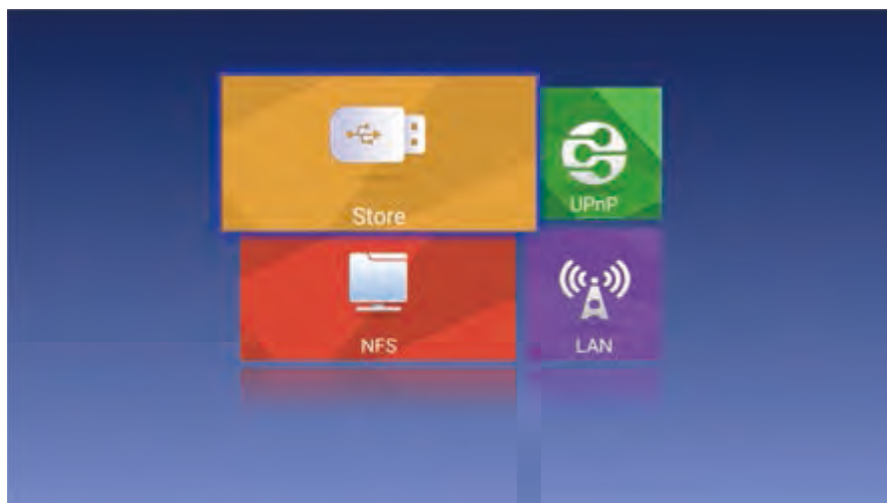

---

To play from a USB drive:

1. Insert a USB drive into the USB socket;
2. Select "Video" ,"Music" ,"Photo" ,"Office"and press "Enter"on the Homepage .
3. Select a file, then press **"Enter"**, this projector will play the video or music, or display the photo you selected.

**After entering "Video", only videos are supported .**

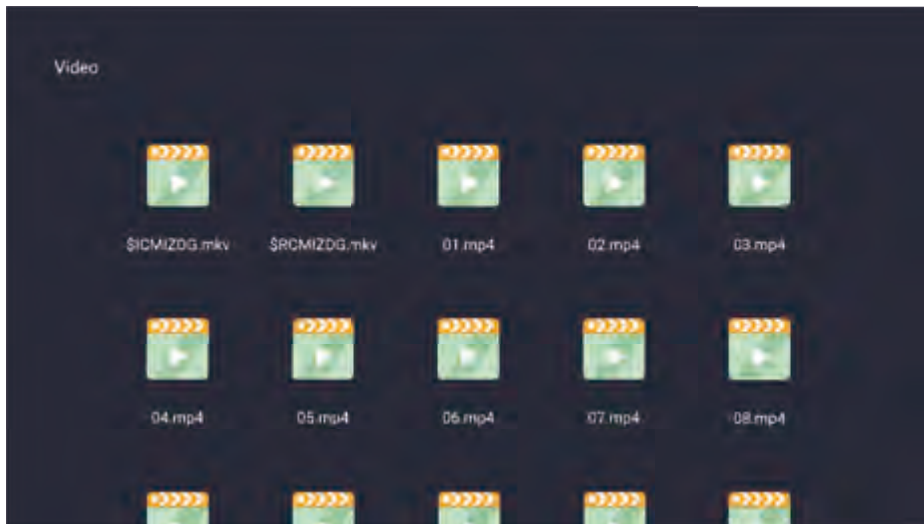

**After entering "Photo", only pictures are supported.**

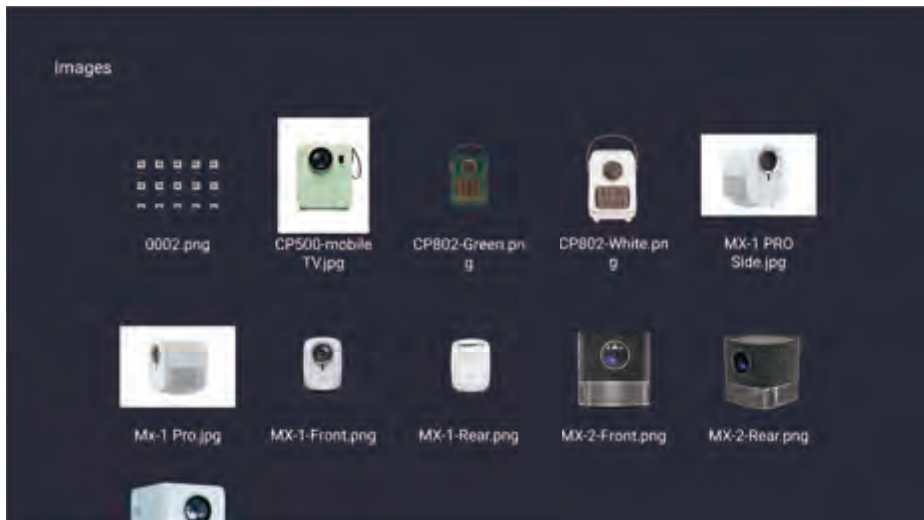





---

After entering "Music", only music is supported.



After entering "Office", only files is supported.

1. "Office">--Select file in USB device .
2. "Office">--Press "  ">--Select Document or Spreadsheet >-- Select a file to modify.
3. "Office">--Press "  ">--Select Document or Spreadsheet >--Press"  " and "  ">-- blank file to modify.



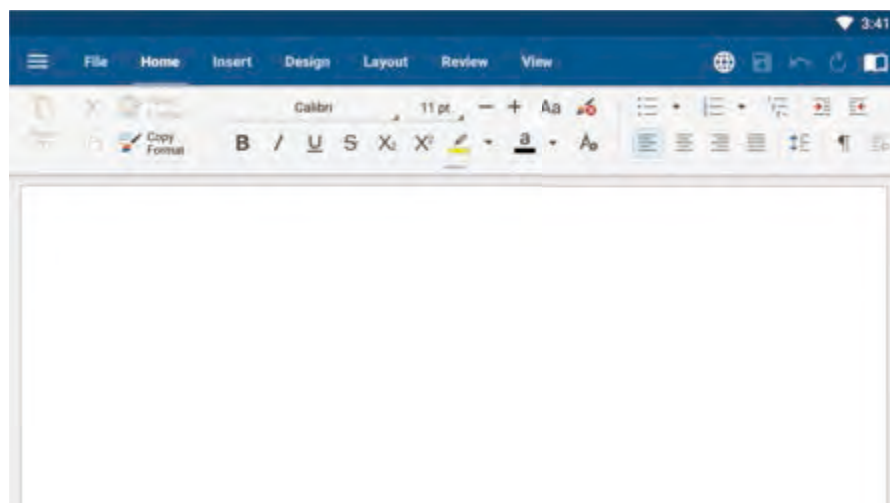

## Wi-Fi CONNECTION

Enter "Setting" ,Wi-Fi press "on" , select your Wi-Fi and input password.

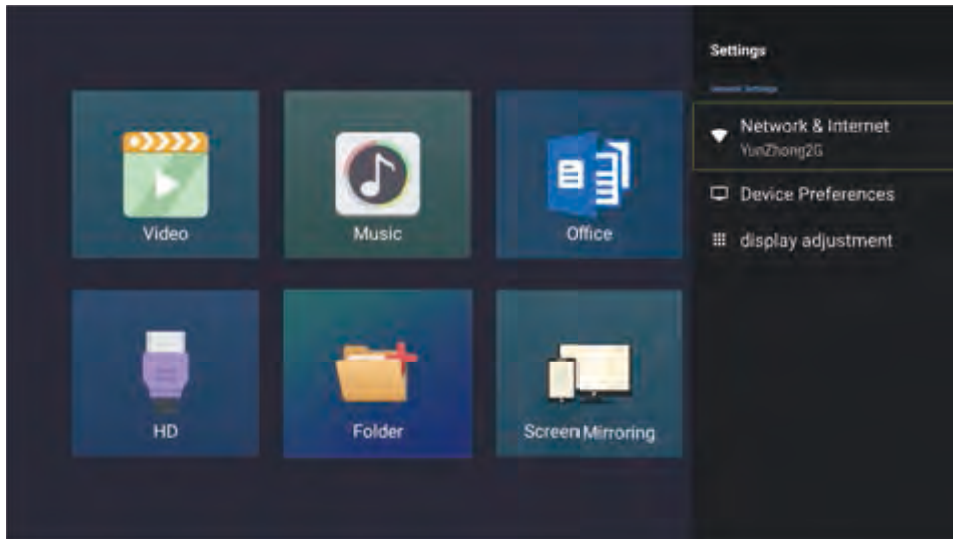

# WIRELESS MIRRORING

## 1 For IOS device ---- mobile phone

- 1) Ensure the mobile phone and the projector are connected to the same network;
- 2) Enter the mobile phone control center ->screen image, and select the device to start projection.



## 2 For IOS device ----MacBook or ipad

- 1) Ensure the device and the projector are connected to the same network;
- 2) Enter the control center ->screen image in the upper right corner of MacBook, and select the device to start projection.



# WIRELESS MIRRORING



---

### 3 For Android device--- Mobil phone

- **Android mobile phone (with Google service pre installed), use the ChromeCast projection.**
  - 1) Ensure the device and the projector are connected to the same network;
  - 2) Search the projection/projection function of the Android mobile phone (different mobile phone manufacturers may have different names for this function), and select corresponding device to start projection.
- **Other type of Mobil phone**
  - 1) Ensure the device and the projector are connected to the same network;
  - 2) Enter the mobile phone control center ->screen mirror, and select the device to start projection.





## 4 For computer device mirror cast

- **Use ChromeCast projection computer equipment, etc.**

- 1) Ensure the device and the projector are connected to the same network;
- 2) Google Chrome browser: click the "More" icon in the upper right corner of Chrome browser, ->enter the "Release" (or projection) function, ->and then select the corresponding device to start projection.

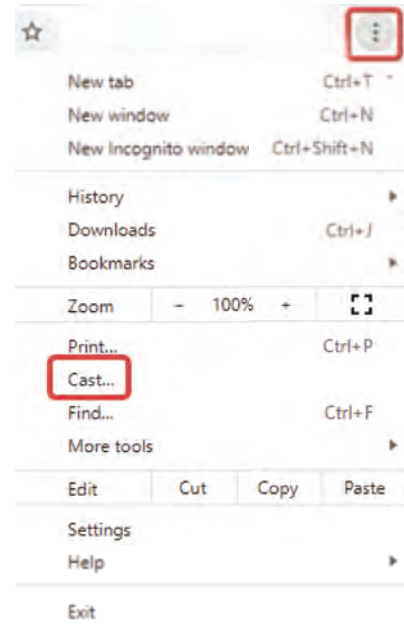

- **Chromebook then use ChromeOS etc.**

- 1) Ensure the device and the projector are connected to the same network;
- 2) Click the system time in the lower right corner, ->enter the "Release" , and select the corresponding device to launch the screen.



---

**Note:**

- For specific operations, please refer to the actual user interface of your device.
- After entering "Screen Mirroring", press the " ↶ " button on the remote control to return to the homepage.

## Projection settings

**Enter "Settings", select "Display Adjustment" to adjust the projection for your needed.**

- **Projection mode-----Front projection, side projection, rear projection etc...**

Enter Projection mode, press "ok" button to change the projection mode, like : Front projection, side projection, rear projection etc...

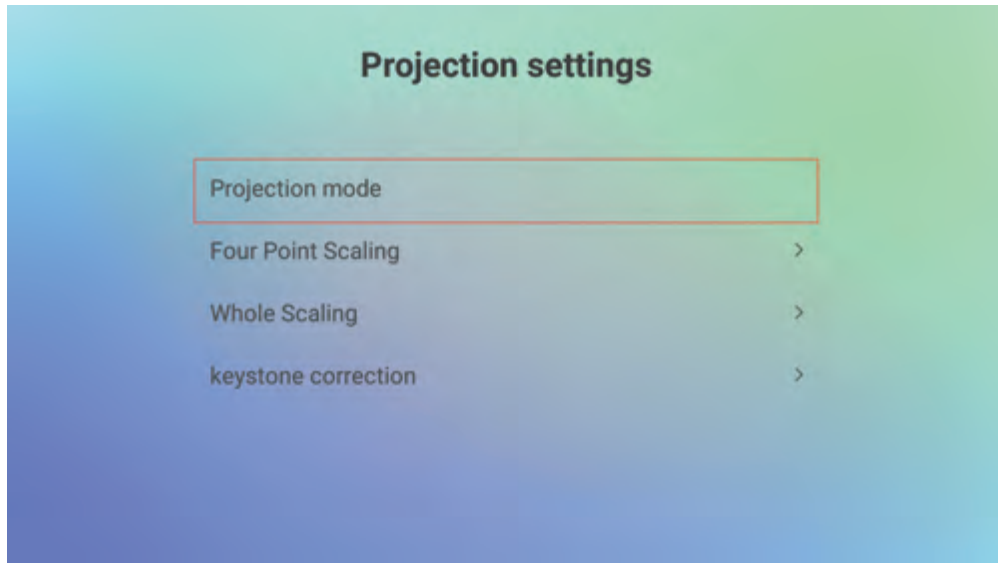

---

- **Four Point Scaling----- point adjustment**

Press "ok" button to select point adjustment . Press "↶" button to backack. Press Menu button to reset.

When the center circle is positivem, the picture proportion would be most appropriate viewing angle.

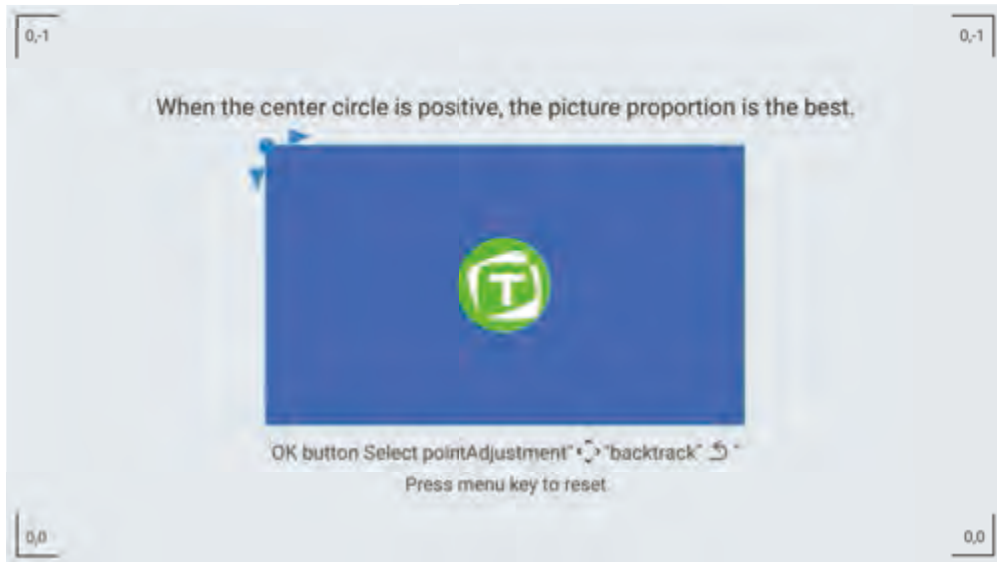

- **Whole Scaling-----zoom the screen**

Press left button or right button to zoom the screen. Press menu button to reset.



---

- **Keystone Correction----screen adjustment**

Press "ok" button select point . Adjust the screen by the direction button until the auxiliary line is rectangular Press "menu" button to reset.



## TO PLAY FROM EXTERNAL DEVICES

- Use a 0.137 inch audio cable (not provided) to connect your headphones or external speakers;
- Connect the other end of the audio cable to the audio out port on this projector;
- You will hear audio from external devices;
- When connected to external speakers, the built-in speaker system is disabled.

---

## CLEANING

- Power off the device and remove it from the power supply before cleaning the surface.
- Use a soft, lint-free cloth. Never use liquid, gaseous, or easily flammable cleansers (like sprays, abrasives, polishes, and alcohol).
- Do not use any liquid cleaning agents to clean the lens as they may damage the protective coating on the lens.
- Wipe the surfaces gently. Be careful that you do not scratch the surfaces.
- Use lens clean paper to clean the lens of this projector.

## REPAIR

- Do not make any repairs for the device yourself.
- Improper maintenance can result in injuries or damage to the device.
- Refer all servicing to qualified service personnel.

## SPECIFICATIONS

**Light source:** LED

**Speaker drivers:** 5W

**Power consumption:** 65W

**Resolution:** 1920\*1080P Native

**Display technology:** 3.97 inch LCD

**Dimensions:** 7.2\*5.3\*7.6 inch

**Weight:** 2.8lb

**Power supply:** AC 110-240V/DC 19V@3.5A

**Remote control batteries:** 2 AAA batteries (not included)

**Accessories:** User Manual, Remote Control, HD Cable, Power Adapter, Power Cord, Tripod Stand.

## FAQ

- **Display available, the audio does not work?**

The audio decoding format is not supported or exceeds the decoding capability range.

- **Audio available, the display does not work?**

The video decoding format is not supported or exceeds the decoding capability range.

- **No signal in the screen?**

The projector does not identify the device which is connected.

- **Why is the image blurry?**

Please use the remote control (F- , F+ ) to adjust.

- **How to connect Wi-Fi?**

Enter "Setting" ,Wi-Fi press "on" , select your Wi-Fi and input password.

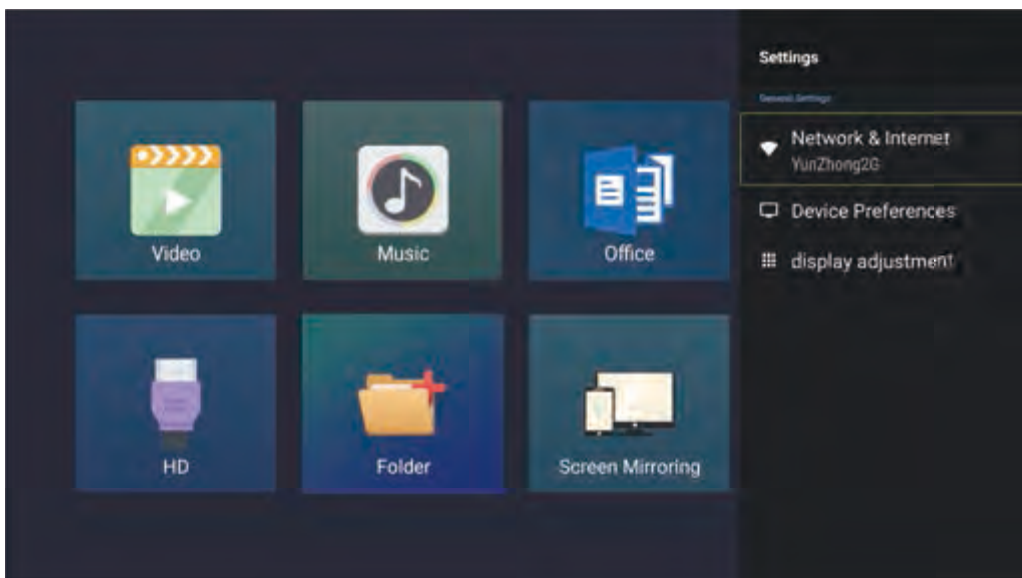

---

● **How can I connect my smart phone? How to use screen mirroring?**

See method below.

**1 . For ios , Mac OS , Google Chrome , Chrome OS**

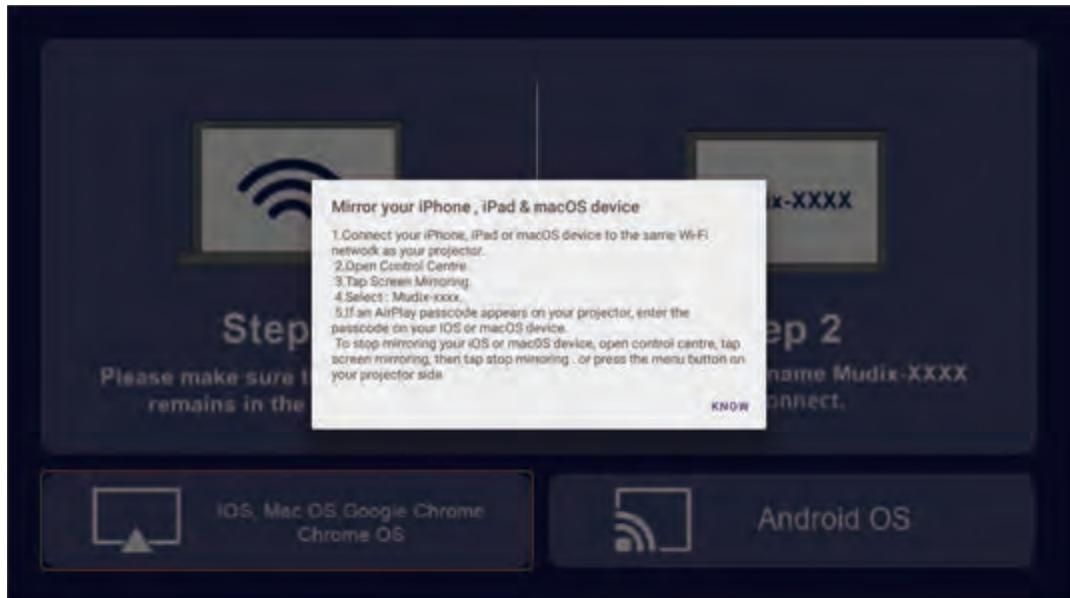
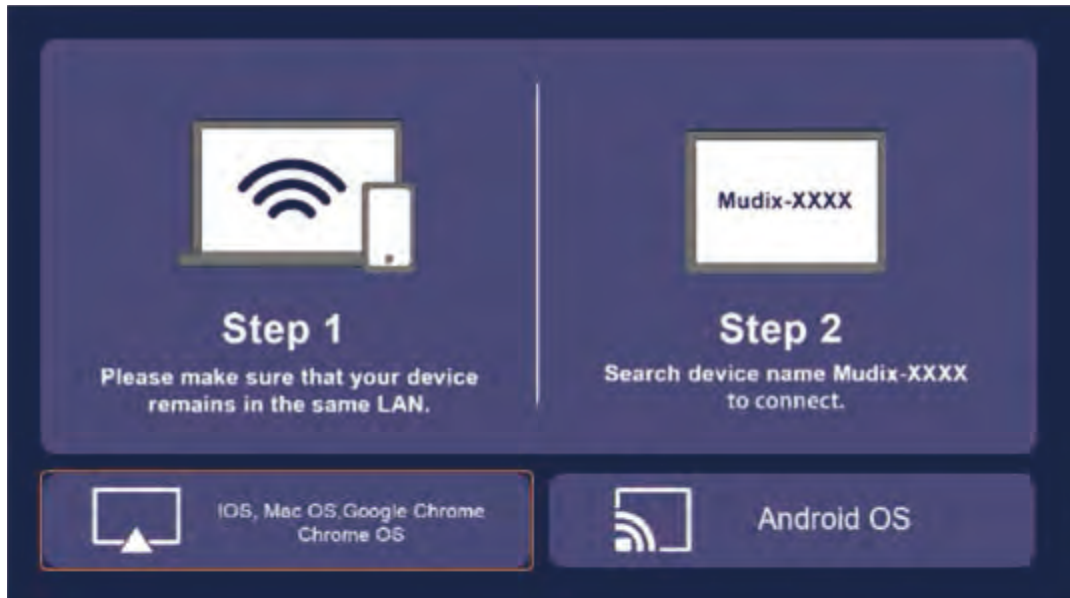

---

## 2. For Android

Connect same Wi-Fi network>---Open Cast/SmartView...  
on Android phones>---Select **Mudix-xxxx**





---

- **What should I do if the image is up side down?**

Enter "Projection settings">---Press"OK"key when at "Projection mode"

- **What should I do if the remote control is unresponsive?**

Check if there are batteries in remote control;

Check if the batteries are completely drained;

Check if the projector is powered on.

- **Shadow on the screen or smoke from the device?**

Powered off immediately;

It is caused by the poor cooling of the projector;

How to avoid: Please do not block the air outlet of the projector, It would cause poor cooling issue.

- **Why does the projector shut off when using?**

Please do not block the air outlet of the projector, it would cause poor cooling issue. The device will automatically shut off to protect the projector when the temperature is too high.

- **What should I do if there are small spots on the projected screen?**

Dust on the display screen cause small spots. To avoid this issue, do not use the device in dusty or smoky environment.

- **Is 3D effect supported?**

Not supported.

- **Can I display slides with this projector?**

Yes, only when using HD devices.

- **Why does the external storage not working, especially large capacity hard disk?**

The projector can support hard disks up to 1TB.

The 3.5-inch hard disk requires an external power supply to the projector. The 2.5-inch hard disk does not need an external power supply.

- **What type of external drives are supported in USB mode?**

FAT32 and NTFS are supported for U disk and TF card, while exFAT is not supported. If your USB drive is not recognized, you can format it to FAT32 or NTFS on a PC, then re-connect it to the projector.

- 
- Please scan the QR code via phone or visit [https://mudix.afterservice.vip](https://mudix afterservice.vip) to REGISTER and EXTEND warranty.
  - Defective item received or issues with product, please scan the QR code via phone or visit <https://mudix.afterservice.vip> to contact our 7/24 after service team.
  - Any questions, advice or product issues, please send e-mail to [mudix@afterservice.vip](mailto:mudix@afterservice.vip).

**For more information, scan here to contact us**

Get 24/7 Assistance at



Use camera or QR scanner to scan

**Or Visit: <https://mudix.afterservice.vip>**

# PROJECTOR COMPONENTS & FUNCTIONS

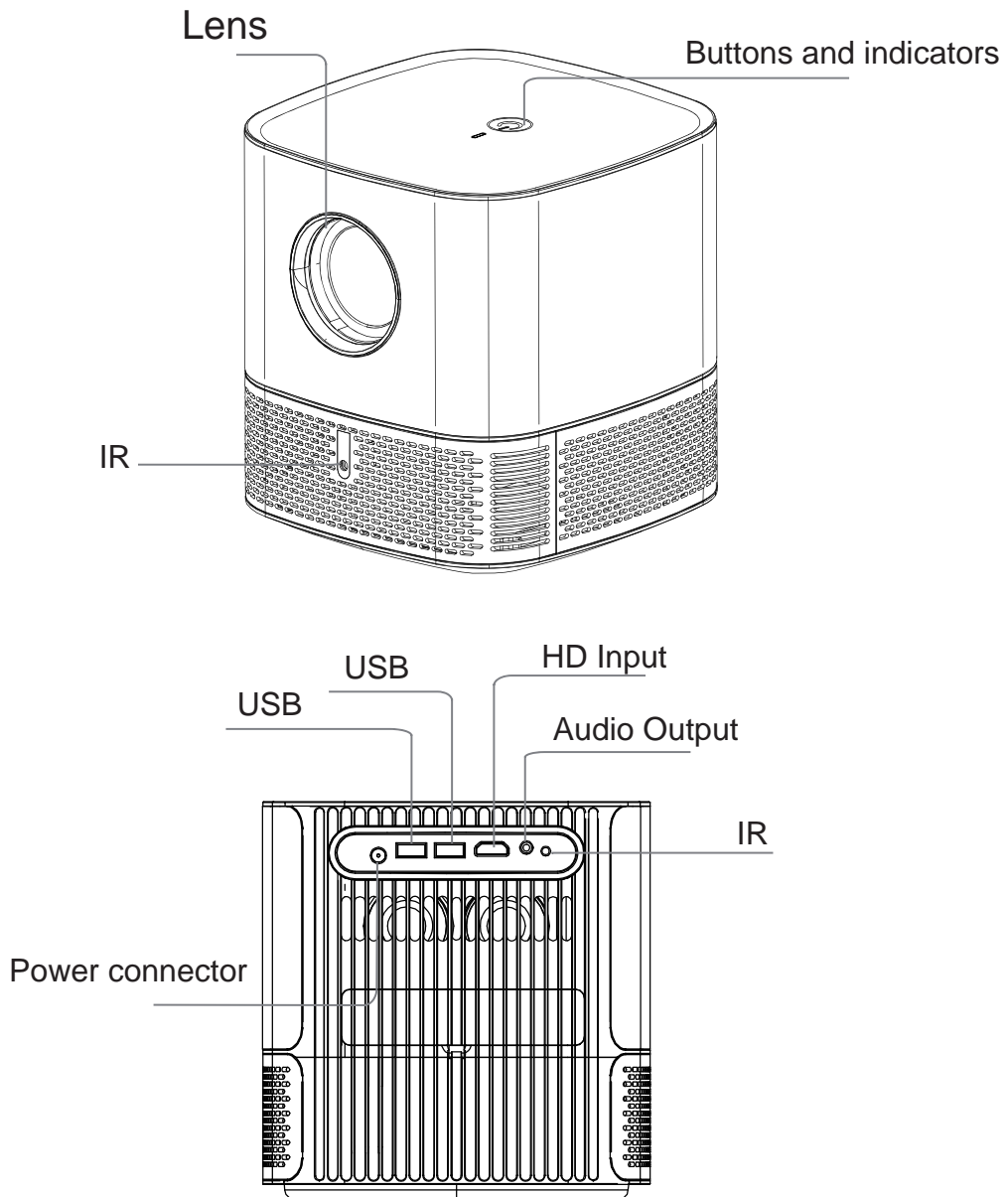

## PROJECTOR COMPONENTS & FUNCTIONS

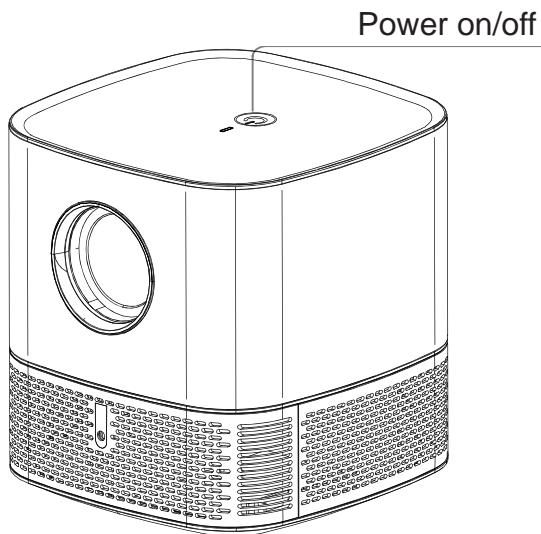

## REMOTE CONTROL BUTTONS

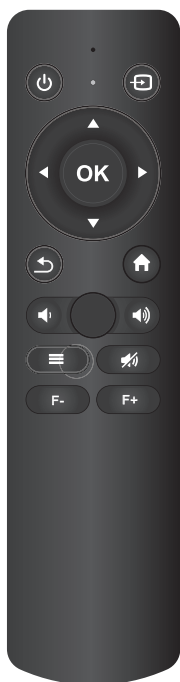

	Power		OK
	HD		Volume -
	Mute		Volume +
	Up		Home
	Down		Return
	Left		Focus-
	Right		Focus+
	Menu		

## EQUIPMENT CONNECTION

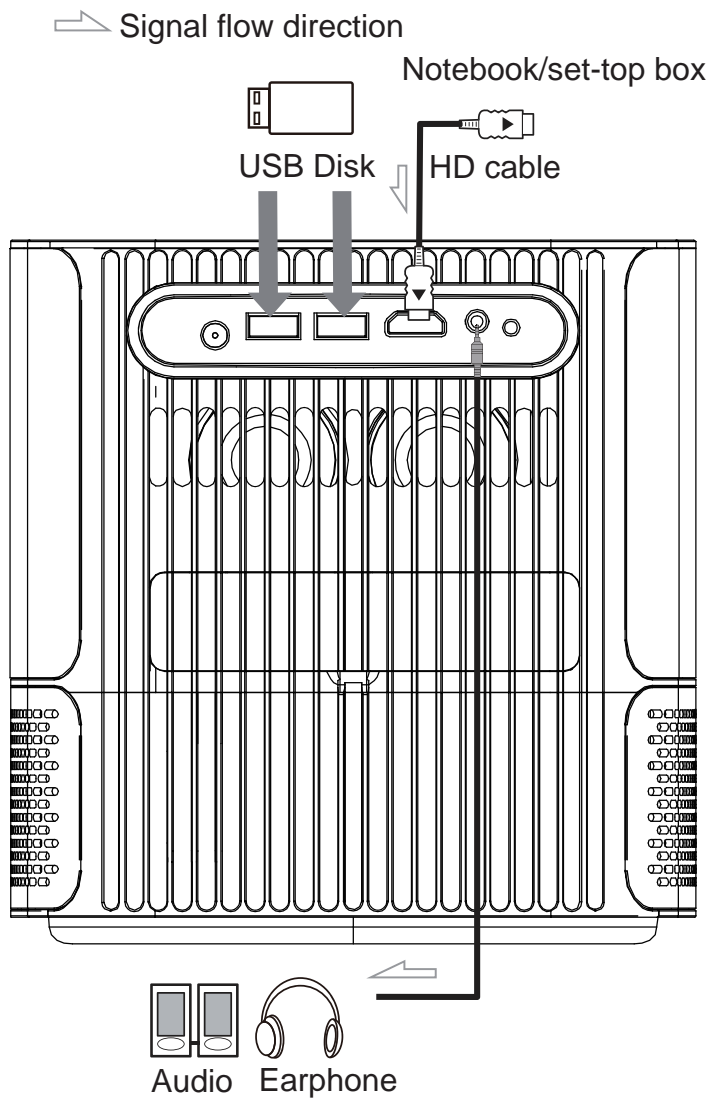

# INSTALLATION & ADJUSTING

## 1 Placement

Place projector on a flat, stable foundation squarely in front of the projection surface. For best results, the projection surface shall be white and flat. The distance between this projector and the projection surface must be a minimum of 1.2 meters (47 inches).

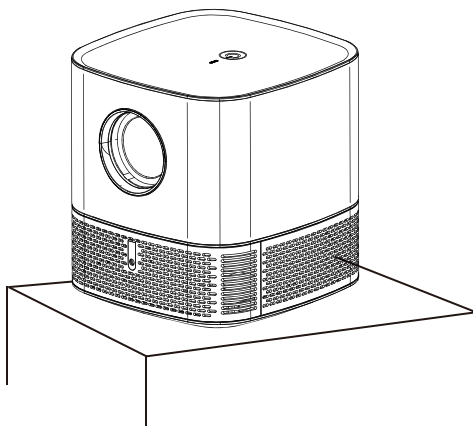

## 2 Adjust The Focus

Using remote control to adjust the focus of image.

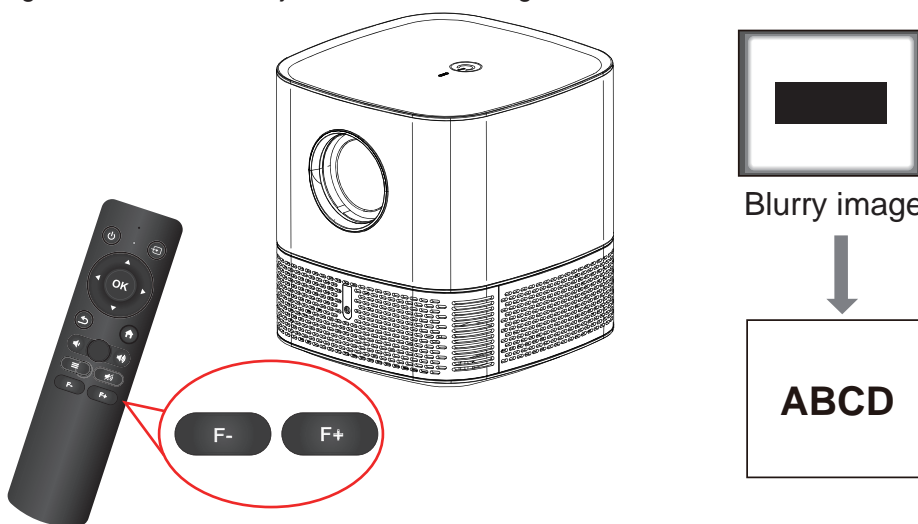

# INSTALLATION & ADJUSTING

## 3 Projection Distance Reference

The distance between this projector and the projection surface determines the approximate size of the image.

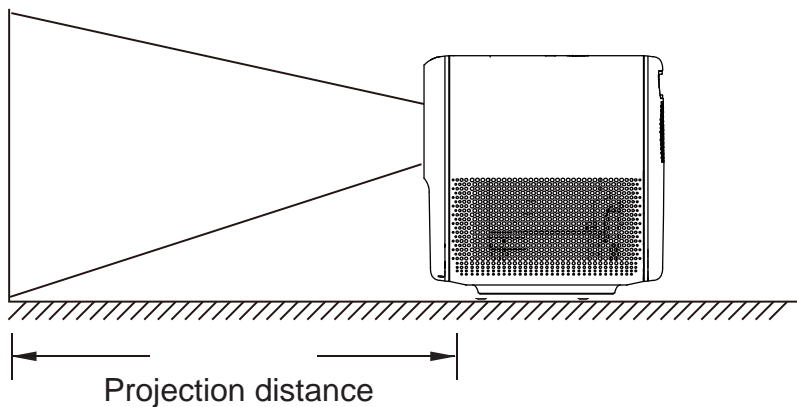

Projection size (inch)	Projection size (H*W) (inch)		Projection distance (inch)
36	(H)18.5	(W)31.49	43.4
56	(H)29.5	(W)52.36	66.9
66	(H)34.25	(W)61.02	78.74
86	(H)41.33	(W)73.22	98.4
96	(H)47.24	(W)83.8	110.2
116	(H)58.66	(W)104.72	133.8
136	(H)68.16	(W)122.04	203.8
156	(H)77.66	(W)139.36	227.4
176	(H)86.16	(W)156.68	301

## INSTALLATION & ADJUSTING

### 4 Power On/Off

#### Power on

1. Connect this projector to an electrical outlet by using the provided power cord and adapter.
2. Remove the lens sticker.
3. Press the **Power** button on the projector to power on. Then turn this projector towards a flat, white projection surface.

#### Power off

Power off the device before removing the power supply from the socket.

Store the projector in a cool dry place.

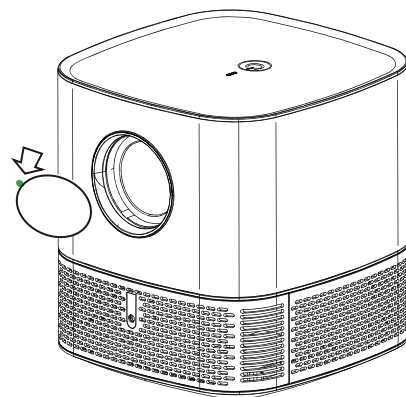



## HOME PAGE

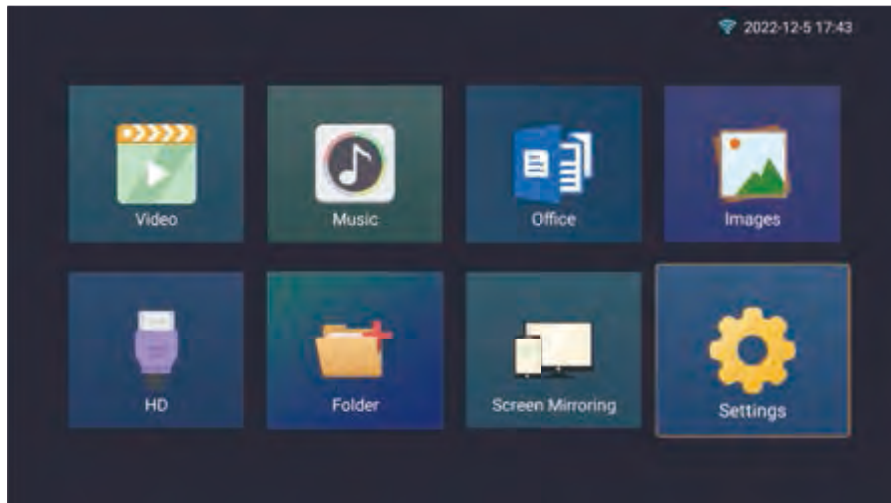

**To play from HD playback devices, select "HD" and press "Enter".**

This projector can be connected to various HD playback devices such as a TV box, TV stick, DVD player, set-top box (STB), gaming console, or other devices. To play from HD playback devices, connect this projector to an HD playback device with an HD cable.

**To play from a USB drive, select "Movie" , "Music" , "Photo" , "Office" and press "Enter".**

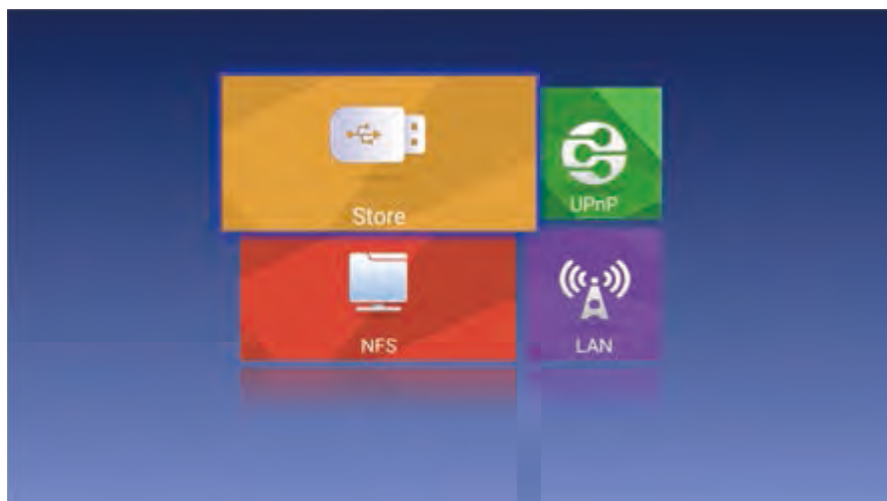

---

To play from a USB drive:

1. Insert a USB drive into the USB socket;
2. Select "Video" ,"Music" ,"Photo" ,"Office"and press "Enter"on the Homepage .
3. Select a file, then press **"Enter"**, this projector will play the video or music, or display the photo you selected.

**After entering "Video", only videos are supported .**

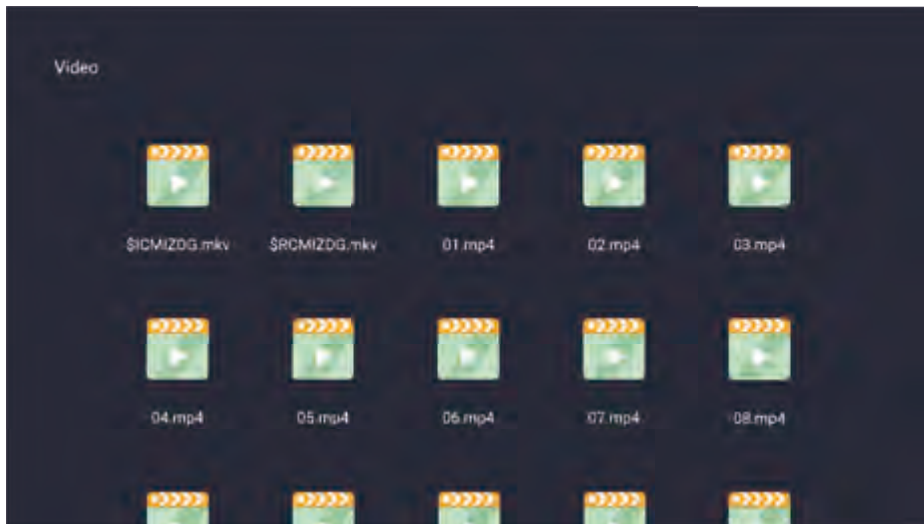

**After entering "Photo", only pictures are supported.**

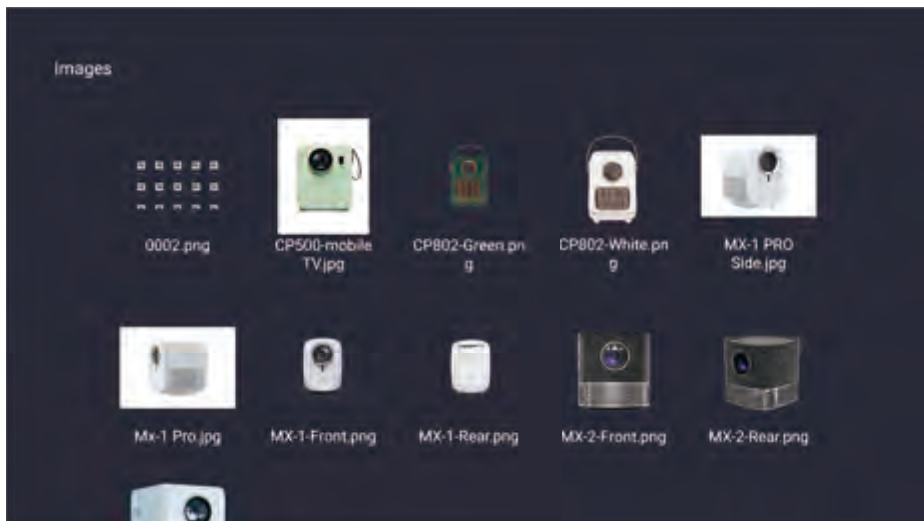





---

After entering "Music", only music is supported.



After entering "Office", only files is supported.

1. "Office">--Select file in USB device .
2. "Office">--Press "  ">--Select Document or Spreadsheet >-- Select a file to modify.
3. "Office">--Press "  ">--Select Document or Spreadsheet >--Press"  " and "  ">-- blank file to modify.



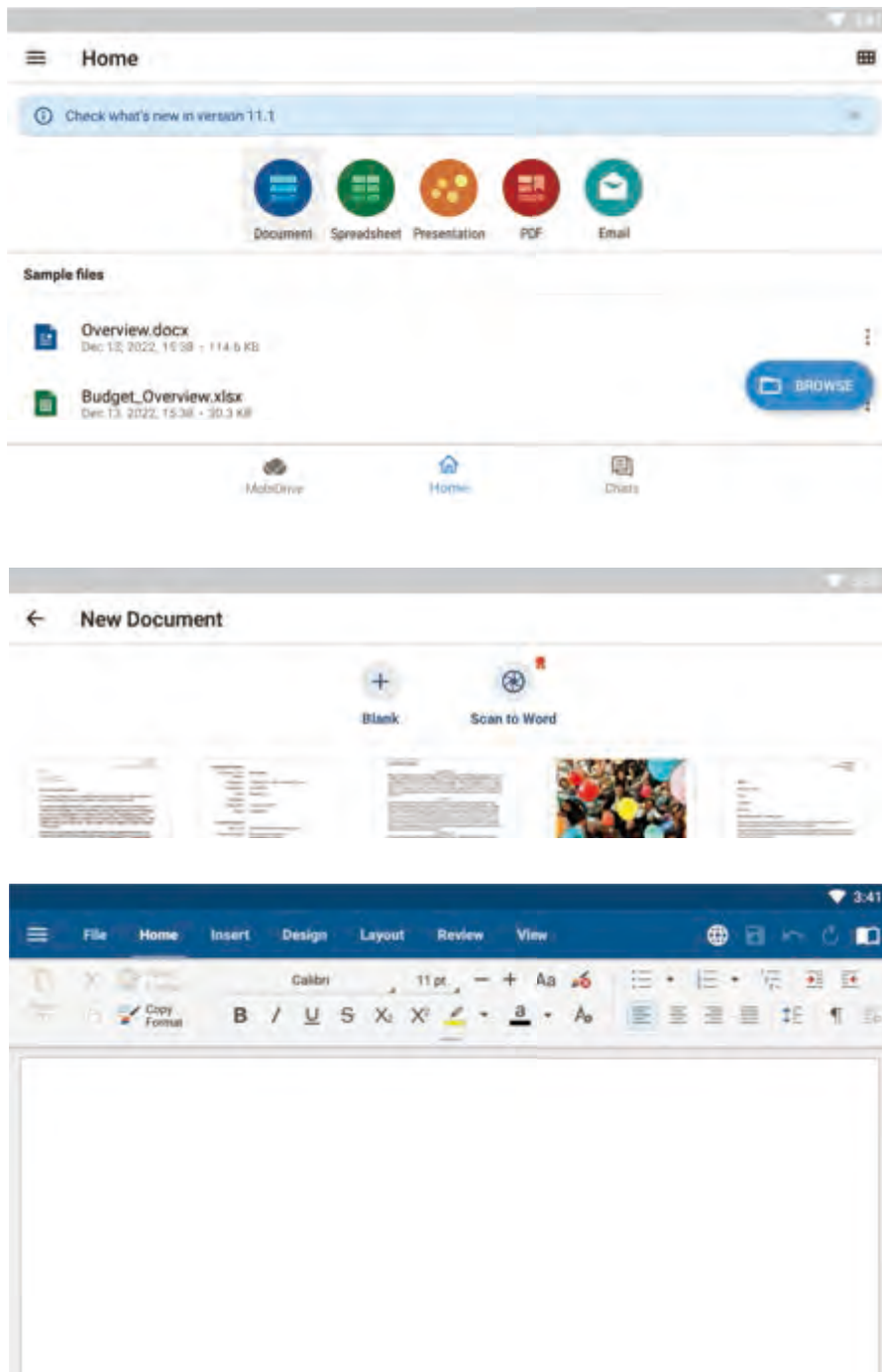

## Wi-Fi CONNECTION

Enter "Setting" ,Wi-Fi press "on" , select your Wi-Fi and input password.

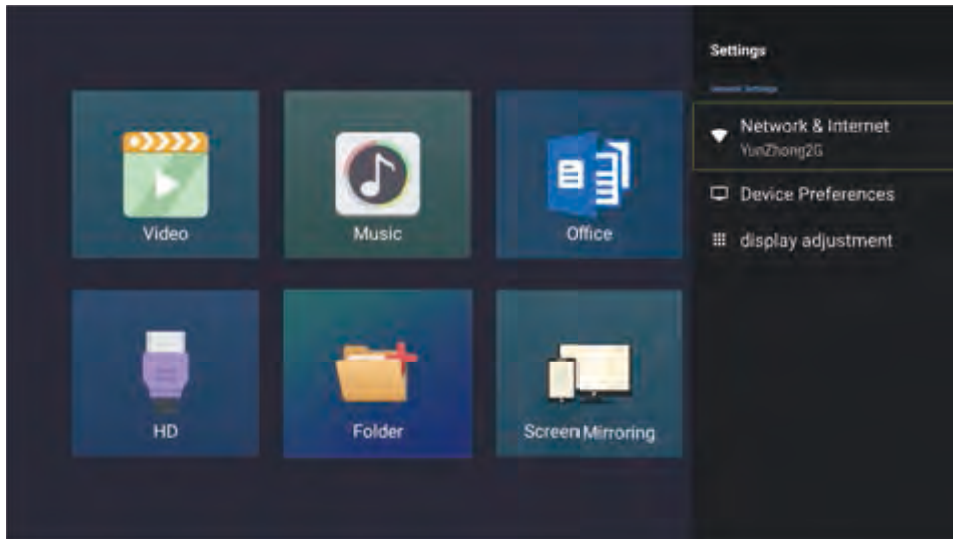

# WIRELESS MIRRORING

## 1 For IOS device ---- mobile phone

- 1) Ensure the mobile phone and the projector are connected to the same network;
- 2) Enter the mobile phone control center ->screen image, and select the device to start projection.



## 2 For IOS device ----MacBook or ipad

- 1) Ensure the device and the projector are connected to the same network;
- 2) Enter the control center ->screen image in the upper right corner of MacBook, and select the device to start projection.



# WIRELESS MIRRORING



---

### 3 For Android device--- Mobil phone

- **Android mobile phone (with Google service pre installed), use the ChromeCast projection.**
  - 1) Ensure the device and the projector are connected to the same network;
  - 2) Search the projection/projection function of the Android mobile phone (different mobile phone manufacturers may have different names for this function), and select corresponding device to start projection.
- **Other type of Mobil phone**
  - 1) Ensure the device and the projector are connected to the same network;
  - 2) Enter the mobile phone control center ->screen mirror, and select the device to start projection.





## 4 For computer device mirror cast

- **Use ChromeCast projection computer equipment, etc.**

- 1) Ensure the device and the projector are connected to the same network;
- 2) Google Chrome browser: click the "More" icon in the upper right corner of Chrome browser, ->enter the "Release" (or projection) function, ->and then select the corresponding device to start projection.

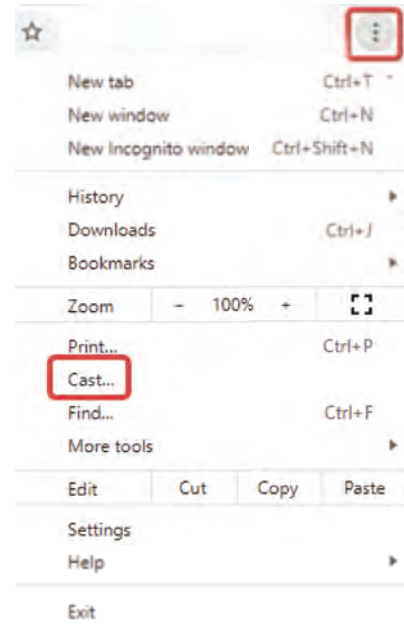

- **Chromebook then use ChromeOS etc.**

- 1) Ensure the device and the projector are connected to the same network;
- 2) Click the system time in the lower right corner, ->enter the "Release" , and select the corresponding device to launch the screen.



---

**Note:**

- For specific operations, please refer to the actual user interface of your device.
- After entering "Screen Mirroring", press the " ↶ " button on the remote control to return to the homepage.

## Projection settings

**Enter "Settings", select "Display Adjustment" to adjust the projection for your needed.**

- **Projection mode-----Front projection, side projection, rear projection etc...**

Enter Projection mode, press "ok" button to change the projection mode, like : Front projection, side projection, rear projection etc...

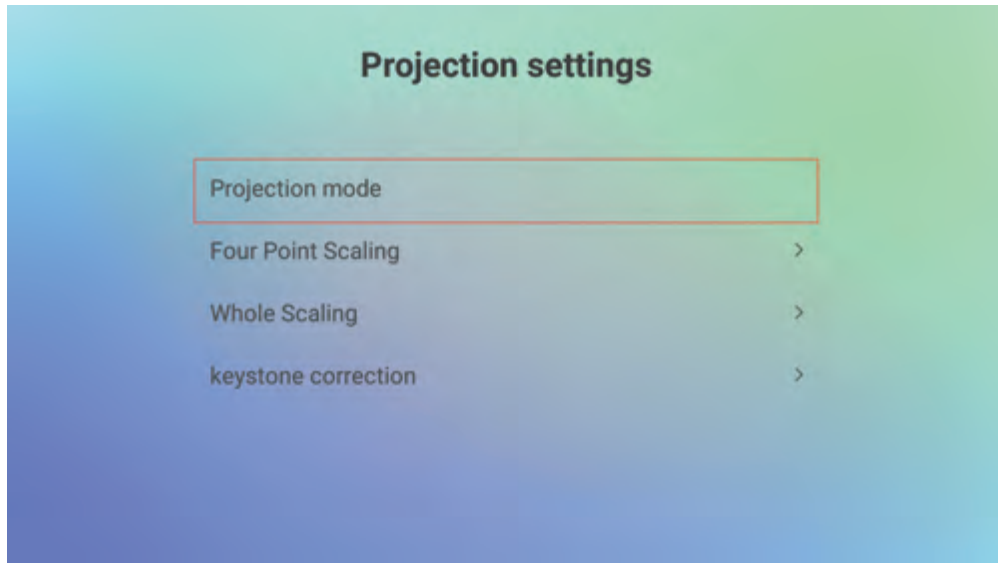

---

- **Four Point Scaling----- point adjustment**

Press "ok" button to select point adjustment . Press "↶" button to backack. Press Menu button to reset.

When the center circle is positivem, the picture proportion would be most appropriate viewing angle.

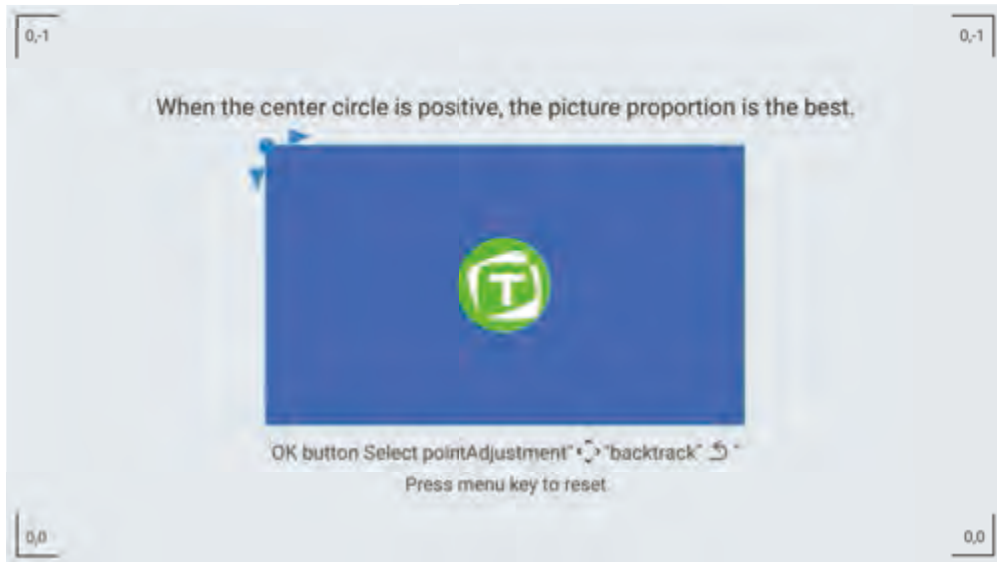

- **Whole Scaling-----zoom the screen**

Press left button or right button to zoom the screen. Press menu button to reset.



---

- **Keystone Correction----screen adjustment**

Press "ok" button select point . Adjust the screen by the direction button until the auxiliary line is rectangular Press "menu" button to reset.



## TO PLAY FROM EXTERNAL DEVICES

- Use a 0.137 inch audio cable (not provided) to connect your headphones or external speakers;
- Connect the other end of the audio cable to the audio out port on this projector;
- You will hear audio from external devices;
- When connected to external speakers, the built-in speaker system is disabled.

---

## CLEANING

- Power off the device and remove it from the power supply before cleaning the surface.
- Use a soft, lint-free cloth. Never use liquid, gaseous, or easily flammable cleansers (like sprays, abrasives, polishes, and alcohol).
- Do not use any liquid cleaning agents to clean the lens as they may damage the protective coating on the lens.
- Wipe the surfaces gently. Be careful that you do not scratch the surfaces.
- Use lens clean paper to clean the lens of this projector.

## REPAIR

- Do not make any repairs for the device yourself.
- Improper maintenance can result in injuries or damage to the device.
- Refer all servicing to qualified service personnel.

## SPECIFICATIONS

**Light source:** LED

**Speaker drivers:** 5W

**Power consumption:** 65W

**Resolution:** 1920\*1080P Native

**Display technology:** 3.97 inch LCD

**Dimensions:** 7.2\*5.3\*7.6 inch

**Weight:** 2.8lb

**Power supply:** AC 110-240V/DC 19V@3.5A

**Remote control batteries:** 2 AAA batteries (not included)

**Accessories:** User Manual, Remote Control, HD Cable, Power Adapter, Power Cord, Tripod Stand.

## FAQ

- **Display available, the audio does not work?**

The audio decoding format is not supported or exceeds the decoding capability range.

- **Audio available, the display does not work?**

The video decoding format is not supported or exceeds the decoding capability range.

- **No signal in the screen?**

The projector does not identify the device which is connected.

- **Why is the image blurry?**

Please use the remote control (F- , F+ ) to adjust.

- **How to connect Wi-Fi?**

Enter "Setting" ,Wi-Fi press "on" , select your Wi-Fi and input password.

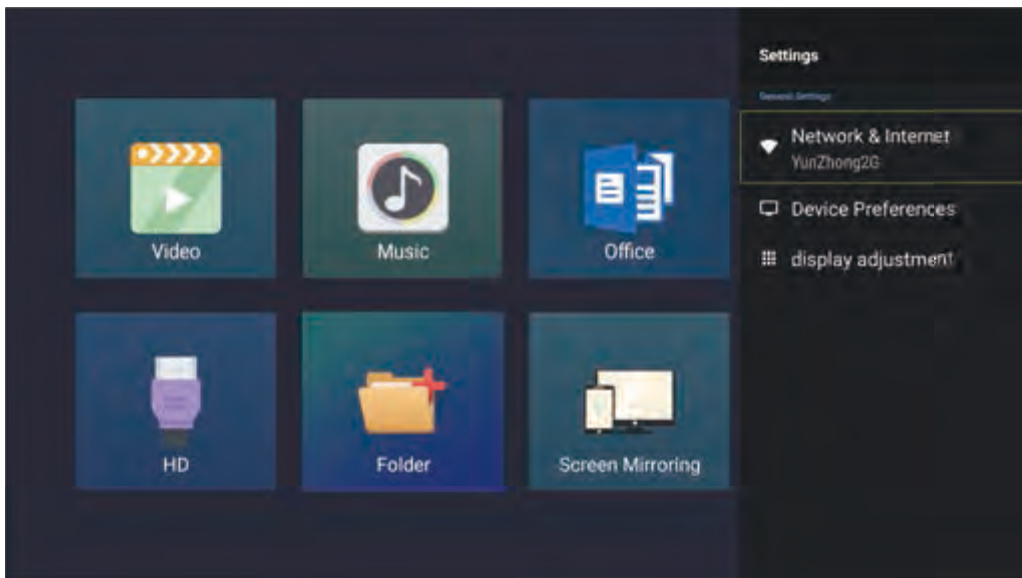

---

● **How can I connect my smart phone? How to use screen mirroring?**

See method below.

**1 . For ios , Mac OS , Google Chrome , Chrome OS**

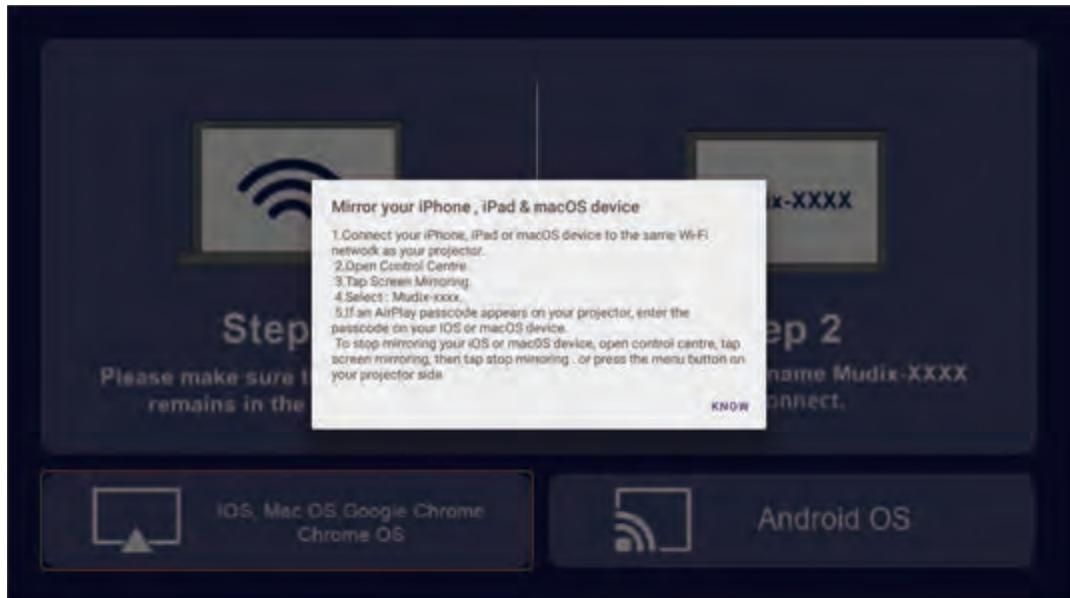
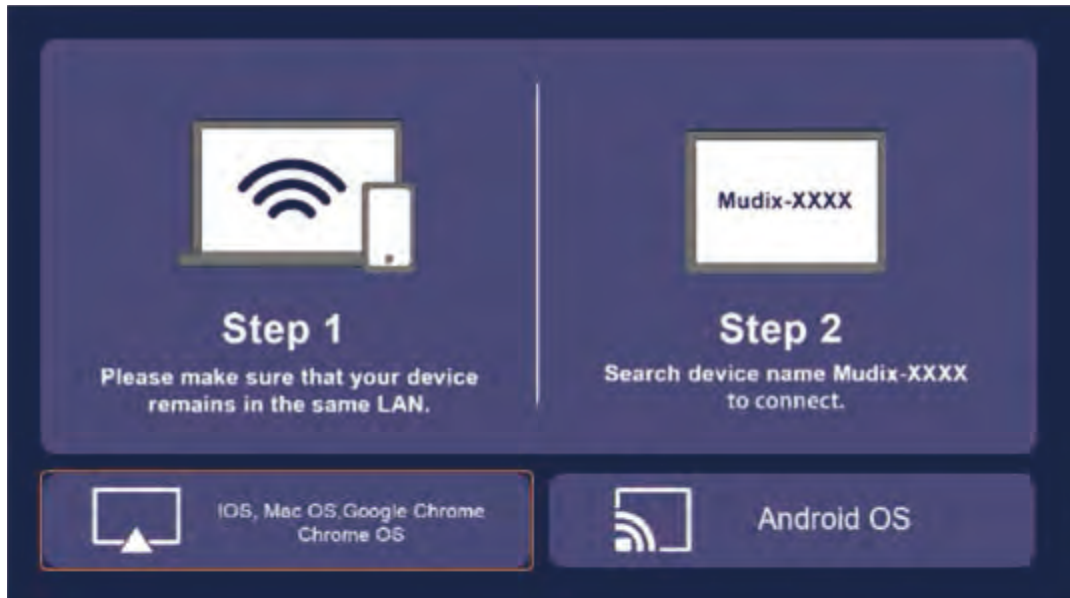

---

## 2. For Android

Connect same Wi-Fi network>---Open Cast/SmartView...  
on Android phones>---Select **Mudix-xxxx**





---

- **What should I do if the image is up side down?**

Enter "Projection settings">---Press"OK"key when at "Projection mode"

- **What should I do if the remote control is unresponsive?**

Check if there are batteries in remote control;

Check if the batteries are completely drained;

Check if the projector is powered on.

- **Shadow on the screen or smoke from the device?**

Powered off immediately;

It is caused by the poor cooling of the projector;

How to avoid: Please do not block the air outlet of the projector, It would cause poor cooling issue.

- **Why does the projector shut off when using?**

Please do not block the air outlet of the projector, it would cause poor cooling issue. The device will automatically shut off to protect the projector when the temperature is too high.

- **What should I do if there are small spots on the projected screen?**

Dust on the display screen cause small spots. To avoid this issue, do not use the device in dusty or smoky environment.

- **Is 3D effect supported?**

Not supported.

- **Can I display slides with this projector?**

Yes, only when using HD devices.

- **Why does the external storage not working, especially large capacity hard disk?**

The projector can support hard disks up to 1TB.

The 3.5-inch hard disk requires an external power supply to the projector. The 2.5-inch hard disk does not need an external power supply.

- **What type of external drives are supported in USB mode?**

FAT32 and NTFS are supported for U disk and TF card, while exFAT is not supported. If your USB drive is not recognized, you can format it to FAT32 or NTFS on a PC, then re-connect it to the projector.

- 
- Please scan the QR code via phone or visit [https://mudix.afterservice.vip](https://mudix afterservice.vip) to REGISTER and EXTEND warranty.
  - Defective item received or issues with product, please scan the QR code via phone or visit <https://mudix.afterservice.vip> to contact our 7/24 after service team.
  - Any questions, advice or product issues, please send e-mail to [mudix@afterservice.vip](mailto:mudix@afterservice.vip).

**For more information, scan here to contact us**

Get 24/7 Assistance at



Use camera or QR scanner to scan

**Or Visit: <https://mudix.afterservice.vip>**

## PROJECTOR COMPONENTS & FUNCTIONS

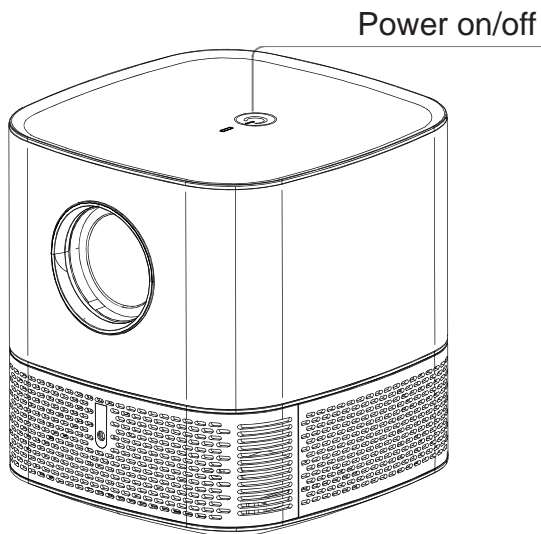

## REMOTE CONTROL BUTTONS

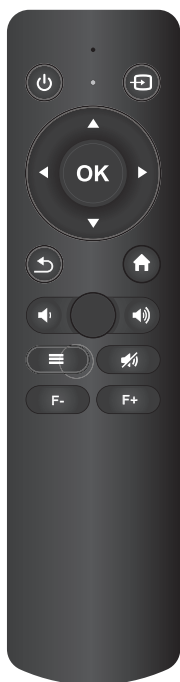

	Power		OK
	HD		Volume -
	Mute		Volume +
	Up		Home
	Down		Return
	Left		Focus-
	Right		Focus+
	Menu		

## EQUIPMENT CONNECTION

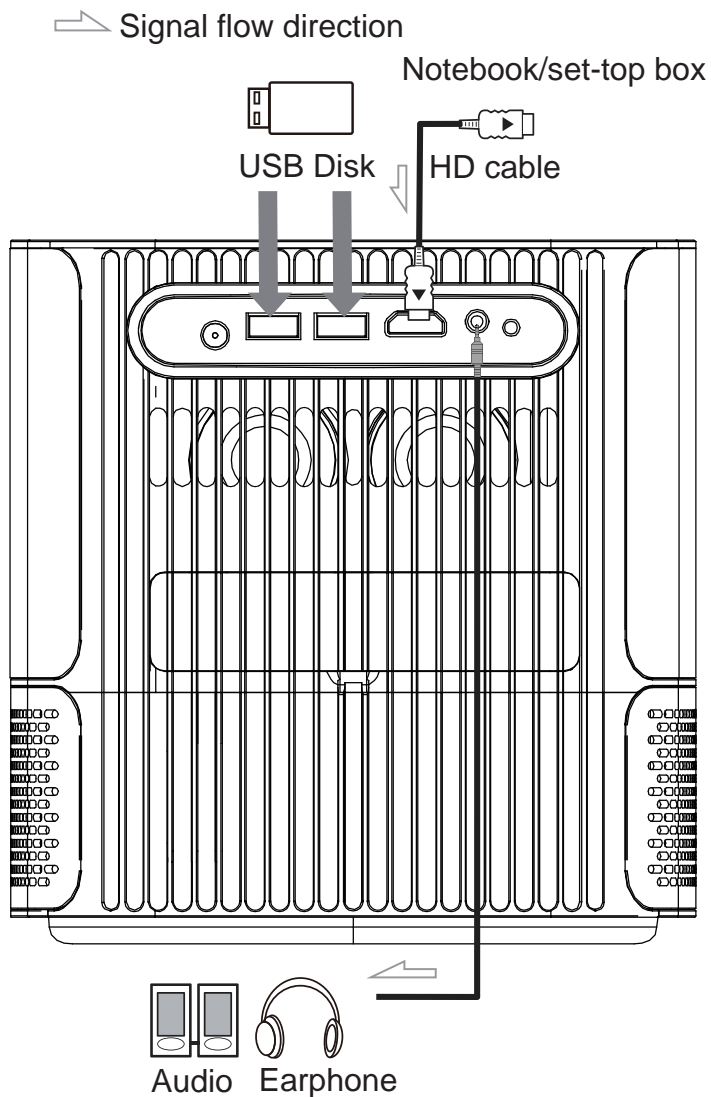

# INSTALLATION & ADJUSTING

## 1 Placement

Place projector on a flat, stable foundation squarely in front of the projection surface. For best results, the projection surface shall be white and flat. The distance between this projector and the projection surface must be a minimum of 1.2 meters (47 inches).

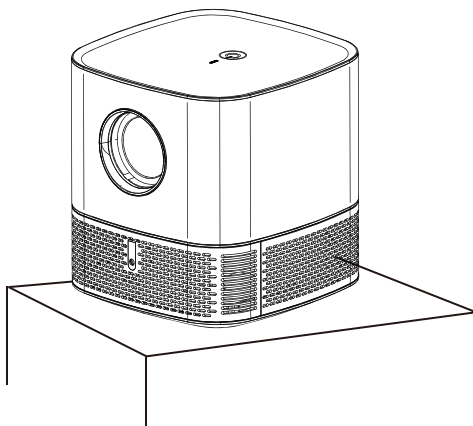

## 2 Adjust The Focus

Using remote control to adjust the focus of image.

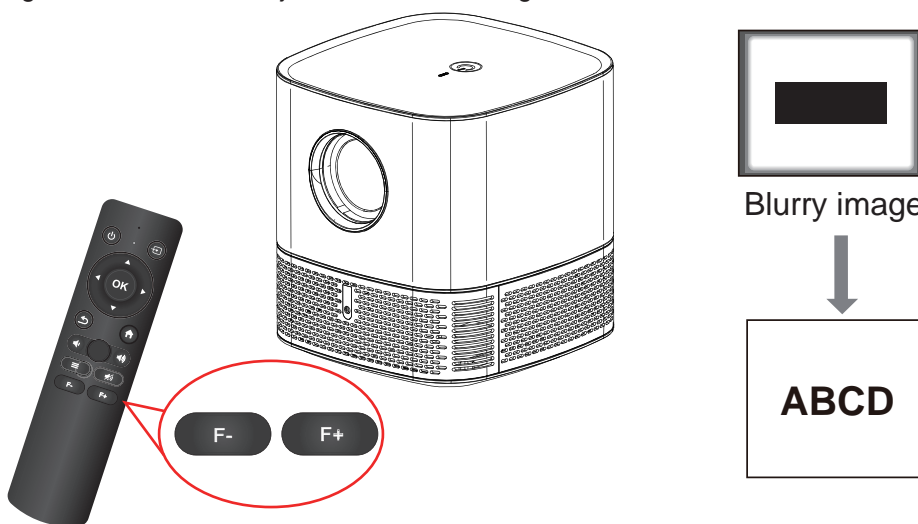

# INSTALLATION & ADJUSTING

## 3 Projection Distance Reference

The distance between this projector and the projection surface determines the approximate size of the image.

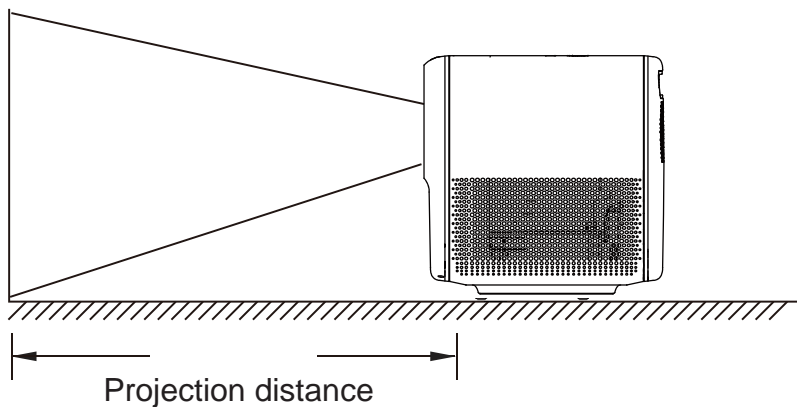

Projection size (inch)	Projection size (H*W) (inch)		Projection distance (inch)
36	(H)18.5	(W)31.49	43.4
56	(H)29.5	(W)52.36	66.9
66	(H)34.25	(W)61.02	78.74
86	(H)41.33	(W)73.22	98.4
96	(H)47.24	(W)83.8	110.2
116	(H)58.66	(W)104.72	133.8
136	(H)68.16	(W)122.04	203.8
156	(H)77.66	(W)139.36	227.4
176	(H)86.16	(W)156.68	301

## INSTALLATION & ADJUSTING

### 4 Power On/Off

#### Power on

1. Connect this projector to an electrical outlet by using the provided power cord and adapter.
2. Remove the lens sticker.
3. Press the **Power** button on the projector to power on. Then turn this projector towards a flat, white projection surface.

#### Power off

Power off the device before removing the power supply from the socket.

Store the projector in a cool dry place.

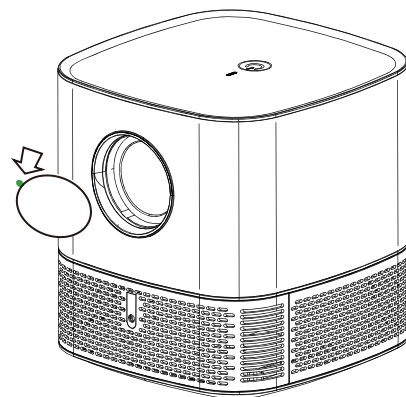

## HOME PAGE

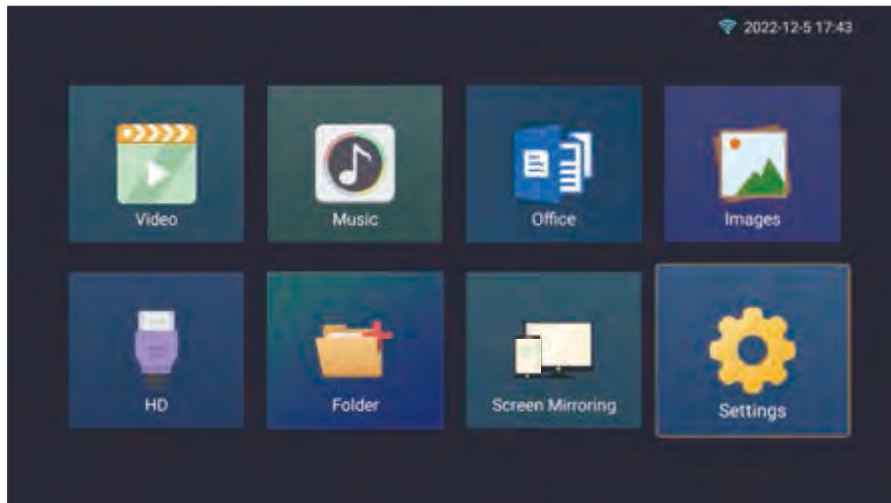

**To play from HD playback devices, select "HD" and press "Enter".**

This projector can be connected to various HD playback devices such as a TV box, TV stick, DVD player, set-top box (STB), gaming console, or other devices. To play from HD playback devices, connect this projector to an HD playback device with an HD cable.

**To play from a USB drive, select "Movie" , "Music" , "Photo" , "Office" and press "Enter".**

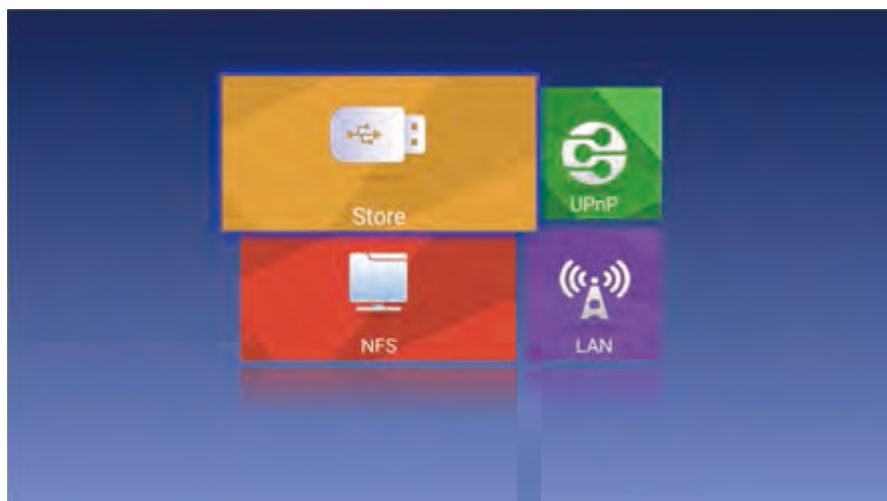



---

To play from a USB drive:

1. Insert a USB drive into the USB socket;
2. Select "Video" ,"Music" ,"Photo" ,"Office"and press "Enter"on the Homepage .
3. Select a file, then press **"Enter"**, this projector will play the video or music, or display the photo you selected.

**After entering "Video", only videos are supported .**

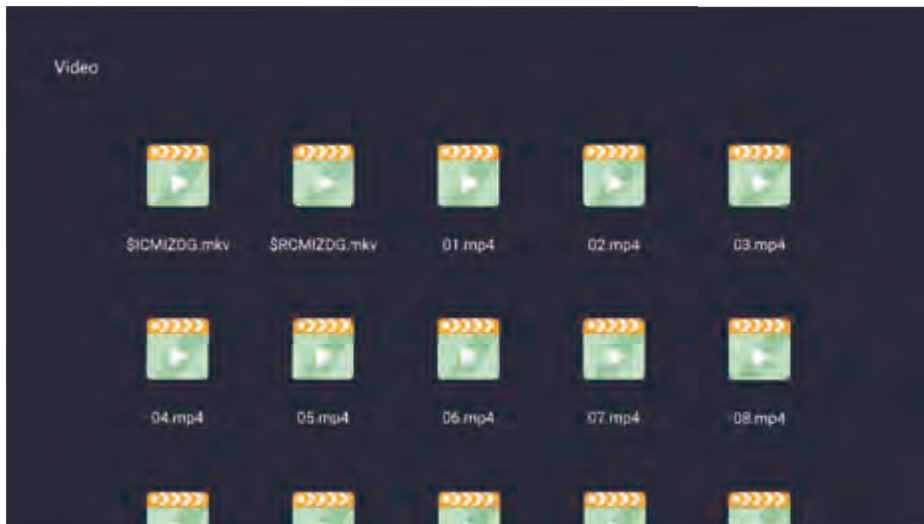

**After entering "Photo", only pictures are supported.**

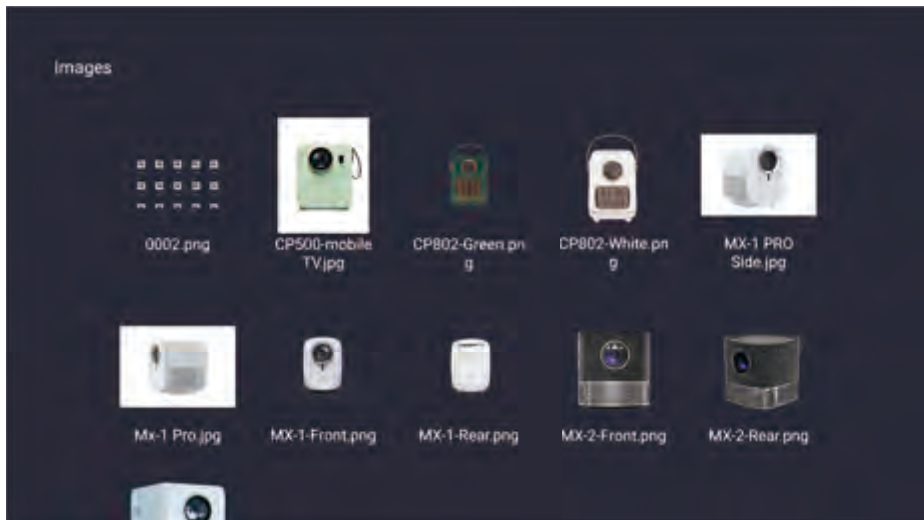





---

After entering "Music", only music is supported.



After entering "Office", only files is supported.

1. "Office">--Select file in USB device .
2. "Office">--Press "  ">--Select Document or Spreadsheet >-- Select a file to modify.
3. "Office">--Press "  ">--Select Document or Spreadsheet >--Press"  " and "  ">-- blank file to modify.



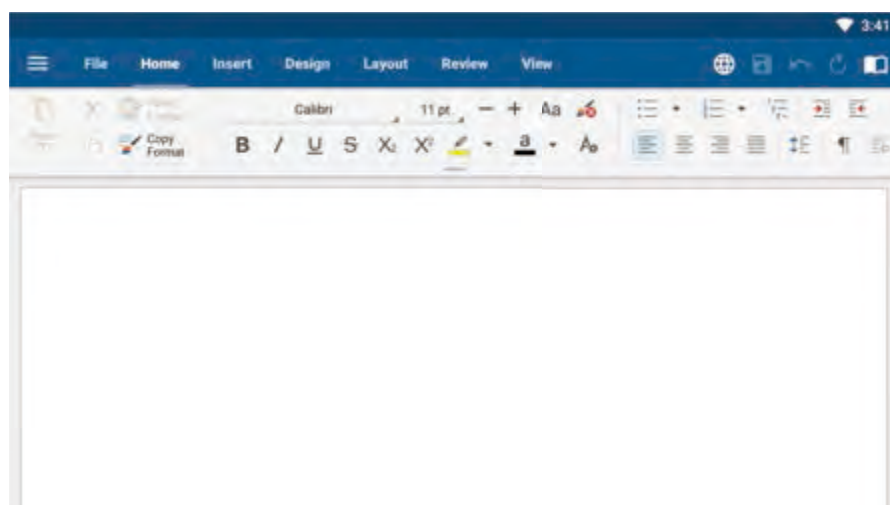
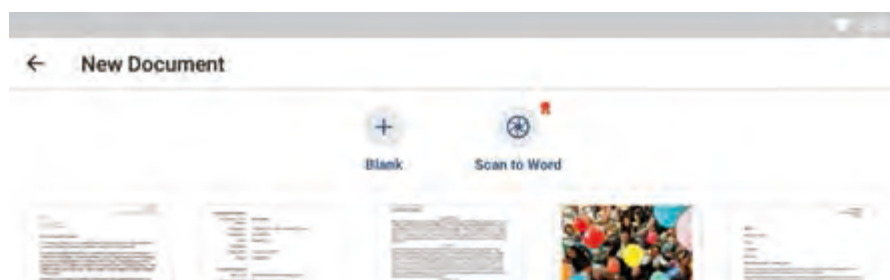

## Wi-Fi CONNECTION

Enter "Setting" ,Wi-Fi press "on" , select your Wi-Fi and input password.

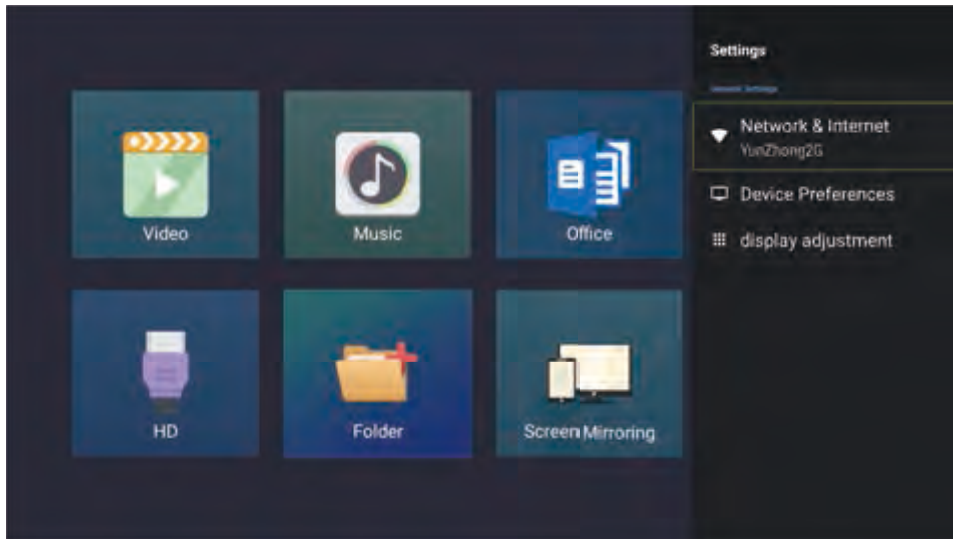

# WIRELESS MIRRORING

## 1 For IOS device ---- mobile phone

- 1) Ensure the mobile phone and the projector are connected to the same network;
- 2) Enter the mobile phone control center ->screen image, and select the device to start projection.



## 2 For IOS device ----MacBook or ipad

- 1) Ensure the device and the projector are connected to the same network;
- 2) Enter the control center ->screen image in the upper right corner of MacBook, and select the device to start projection.



# WIRELESS MIRRORING

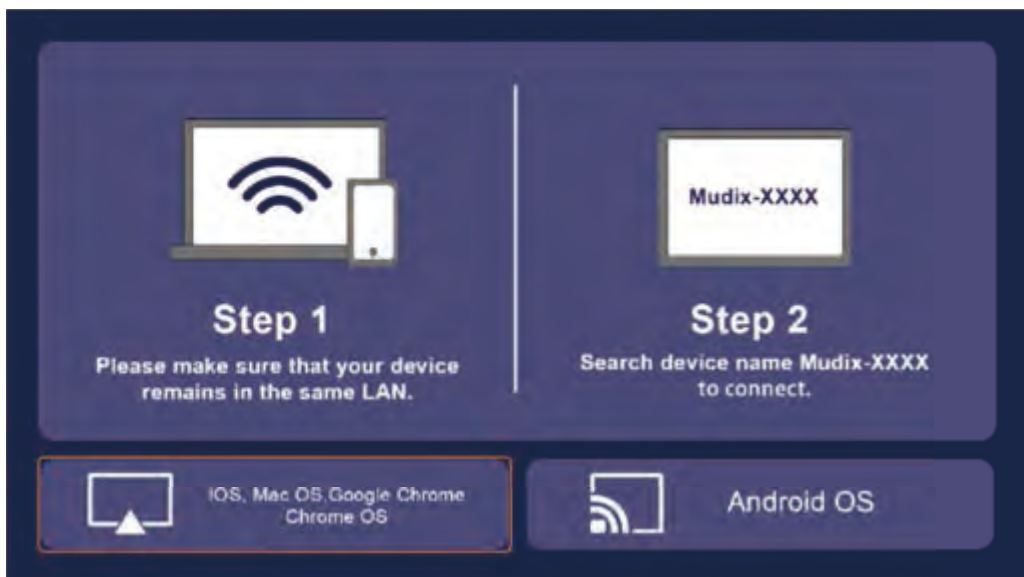

---

### 3 For Android device--- Mobil phone

- **Android mobile phone (with Google service pre installed), use the ChromeCast projection.**
  - 1) Ensure the device and the projector are connected to the same network;
  - 2) Search the projection/projection function of the Android mobile phone (different mobile phone manufacturers may have different names for this function), and select corresponding device to start projection.
- **Other type of Mobil phone**
  - 1) Ensure the device and the projector are connected to the same network;
  - 2) Enter the mobile phone control center ->screen mirror, and select the device to start projection.



## 4 For computer device mirror cast

- **Use ChromeCast projection computer equipment, etc.**

- 1) Ensure the device and the projector are connected to the same network;
- 2) Google Chrome browser: click the "More" icon in the upper right corner of Chrome browser, ->enter the "Release" (or projection) function, ->and then select the corresponding device to start projection.

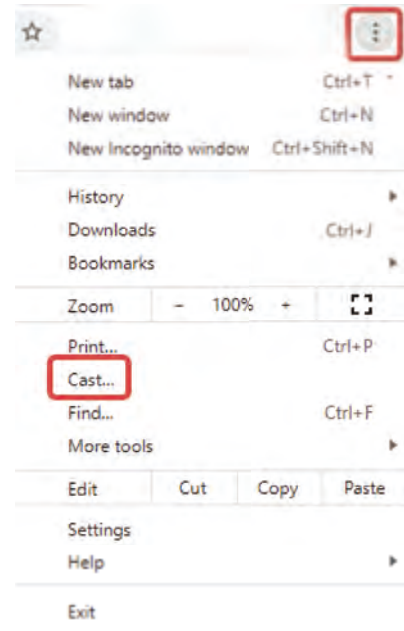

- **Chromebook then use ChromeOS etc.**

- 1) Ensure the device and the projector are connected to the same network;
- 2) Click the system time in the lower right corner, ->enter the "Release" , and select the corresponding device to launch the screen.





---

**Note:**

- For specific operations, please refer to the actual user interface of your device.
- After entering "Screen Mirroring", press the " ↶ " button on the remote control to return to the homepage.

## Projection settings

**Enter "Settings", select "Display Adjustment" to adjust the projection for your needed.**

- **Projection mode-----Front projection, side projection, rear projection etc...**

Enter Projection mode, press "ok" button to change the projection mode, like : Front projection, side projection, rear projection etc...

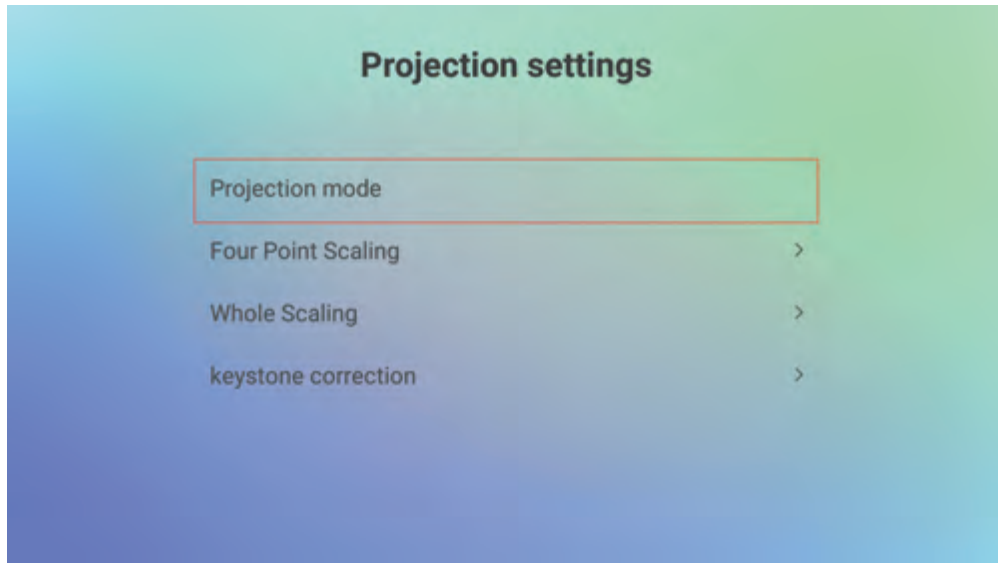

---

- **Four Point Scaling----- point adjustment**

Press "ok" button to select point adjustment . Press "↶" button to backack. Press Menu button to reset.

When the center circle is positivem, the picture proportion would be most appropriate viewing angle.

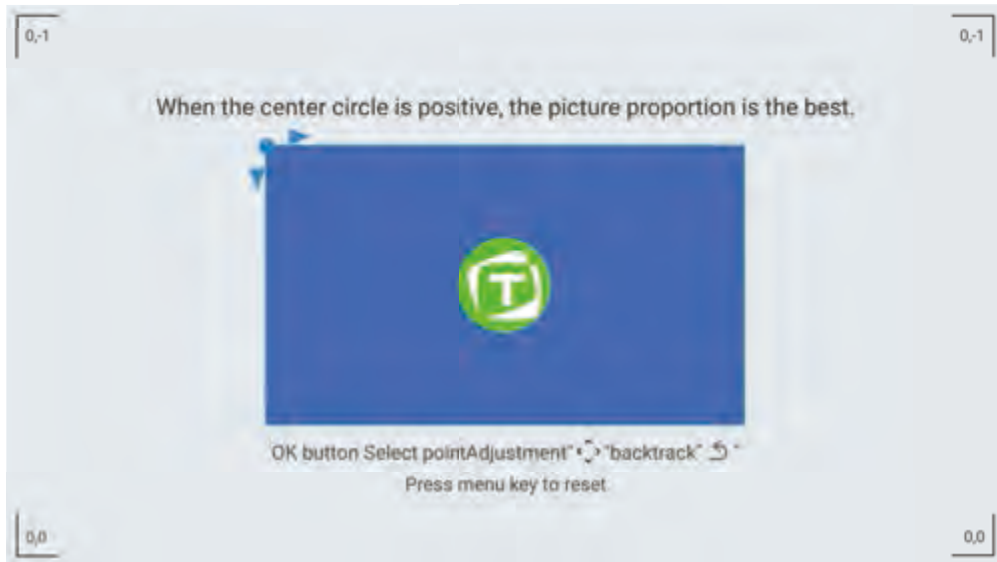

- **Whole Scaling-----zoom the screen**

Press left button or right button to zoom the screen. Press menu button to reset.



---

- **Keystone Correction----screen adjustment**

Press "ok" button select point . Adjust the screen by the direction button until the auxiliary line is rectangular Press "menu" button to reset.



## TO PLAY FROM EXTERNAL DEVICES

- Use a 0.137 inch audio cable (not provided) to connect your headphones or external speakers;
- Connect the other end of the audio cable to the audio out port on this projector;
- You will hear audio from external devices;
- When connected to external speakers, the built-in speaker system is disabled.

---

## CLEANING

- Power off the device and remove it from the power supply before cleaning the surface.
- Use a soft, lint-free cloth. Never use liquid, gaseous, or easily flammable cleansers (like sprays, abrasives, polishes, and alcohol).
- Do not use any liquid cleaning agents to clean the lens as they may damage the protective coating on the lens.
- Wipe the surfaces gently. Be careful that you do not scratch the surfaces.
- Use lens clean paper to clean the lens of this projector.

## REPAIR

- Do not make any repairs for the device yourself.
- Improper maintenance can result in injuries or damage to the device.
- Refer all servicing to qualified service personnel.

## SPECIFICATIONS

**Light source:** LED

**Speaker drivers:** 5W

**Power consumption:** 65W

**Resolution:** 1920\*1080P Native

**Display technology:** 3.97 inch LCD

**Dimensions:** 7.2\*5.3\*7.6 inch

**Weight:** 2.8lb

**Power supply:** AC 110-240V/DC 19V@3.5A

**Remote control batteries:** 2 AAA batteries (not included)

**Accessories:** User Manual, Remote Control, HD Cable, Power Adapter, Power Cord, Tripod Stand.

## FAQ

- **Display available, the audio does not work?**

The audio decoding format is not supported or exceeds the decoding capability range.

- **Audio available, the display does not work?**

The video decoding format is not supported or exceeds the decoding capability range.

- **No signal in the screen?**

The projector does not identify the device which is connected.

- **Why is the image blurry?**

Please use the remote control (F- , F+ ) to adjust.

- **How to connect Wi-Fi?**

Enter "Setting" ,Wi-Fi press "on" , select your Wi-Fi and input password.

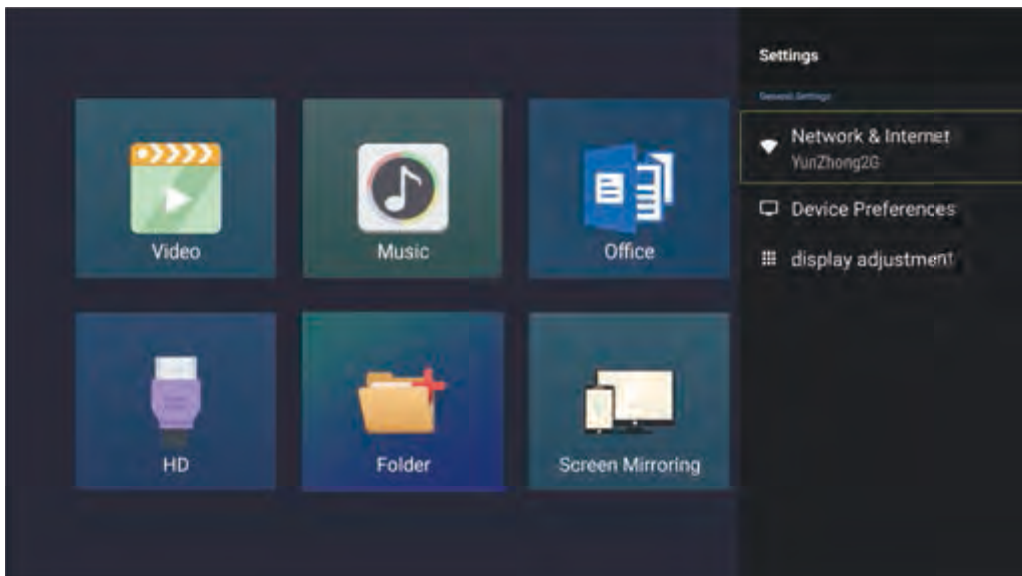

---

● **How can I connect my smart phone? How to use screen mirroring?**

See method below.

**1 . For ios , Mac OS , Google Chrome , Chrome OS**

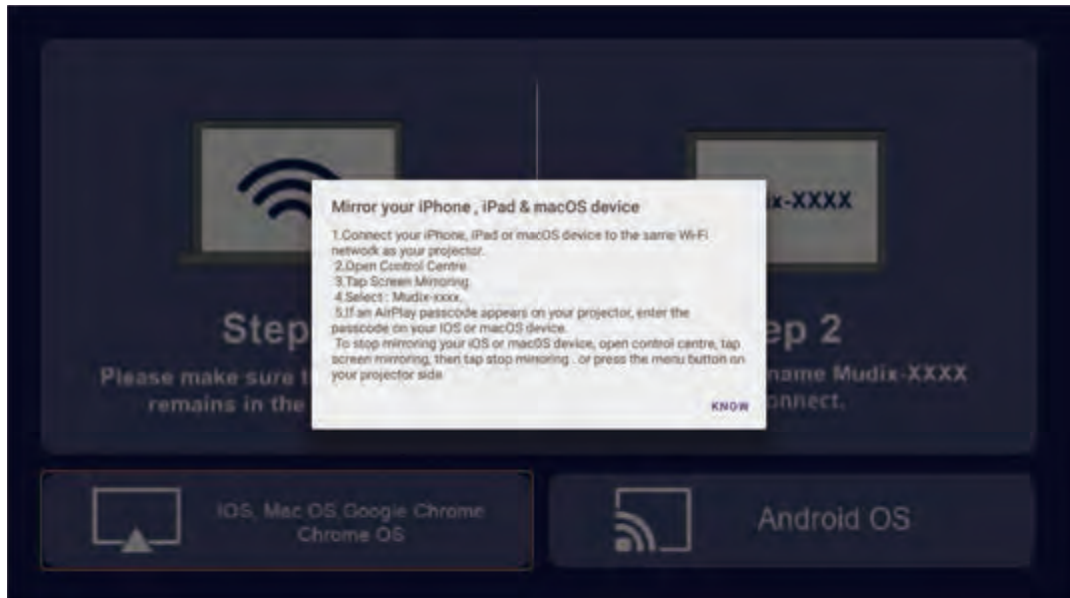
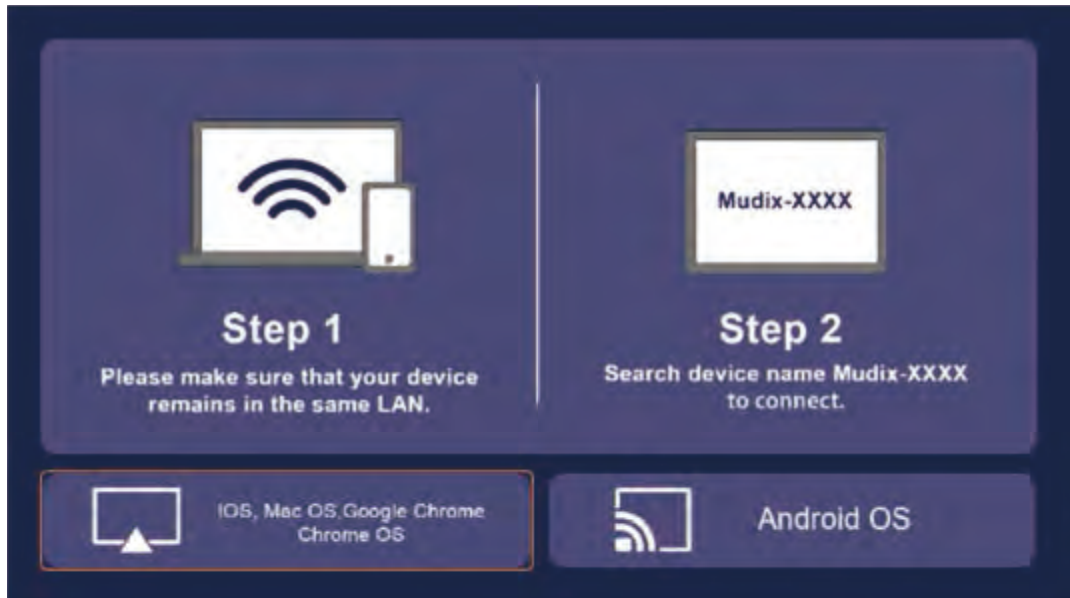

---

## 2. For Android

Connect same Wi-Fi network>---Open Cast/SmartView...  
on Android phones>---Select **Mudix-xxxx**



---

- **What should I do if the image is up side down?**

Enter "Projection settings">---Press"OK"key when at "Projection mode"

- **What should I do if the remote control is unresponsive?**

Check if there are batteries in remote control;

Check if the batteries are completely drained;

Check if the projector is powered on.

- **Shadow on the screen or smoke from the device?**

Powered off immediately;

It is caused by the poor cooling of the projector;

How to avoid: Please do not block the air outlet of the projector, It would cause poor cooling issue.

- **Why does the projector shut off when using?**

Please do not block the air outlet of the projector, it would cause poor cooling issue. The device will automatically shut off to protect the projector when the temperature is too high.

- **What should I do if there are small spots on the projected screen?**

Dust on the display screen cause small spots. To avoid this issue, do not use the device in dusty or smoky environment.

- **Is 3D effect supported?**

Not supported.

- **Can I display slides with this projector?**

Yes, only when using HD devices.

- **Why does the external storage not working, especially large capacity hard disk?**

The projector can support hard disks up to 1TB.

The 3.5-inch hard disk requires an external power supply to the projector. The 2.5-inch hard disk does not need an external power supply.

- **What type of external drives are supported in USB mode?**

FAT32 and NTFS are supported for U disk and TF card, while exFAT is not supported. If your USB drive is not recognized, you can format it to FAT32 or NTFS on a PC, then re-connect it to the projector.



- 
- Please scan the QR code via phone or visit [https://mudix.afterservice.vip](https://mudix afterservice.vip) to REGISTER and EXTEND warranty.
  - Defective item received or issues with product, please scan the QR code via phone or visit <https://mudix.afterservice.vip> to contact our 7/24 after service team.
  - Any questions, advice or product issues, please send e-mail to [mudix@afterservice.vip](mailto:mudix@afterservice.vip).

**For more information, scan here to contact us**

Get 24/7 Assistance at



Use camera or QR scanner to scan

**Or Visit: <https://mudix.afterservice.vip>**

#### FCC Warning

This device complies with part 15 of the FCC rules. Operation is subject to the following two conditions: (1) this device may not cause harmful interference, and (2) this device must accept any interference received, including interference that may cause undesired operation.

Changes or modifications not expressly approved by the party responsible for compliance could void the user's authority to operate the equipment.

NOTE: This equipment has been tested and found to comply with the limits for a Class B digital device, pursuant to part 15 of the FCC Rules. These limits are designed to provide reasonable protection against harmful interference in a residential installation. This equipment generates uses and can radiate radio frequency energy and, if not installed and used in accordance with the instructions, may cause harmful interference to radio communications. However, there is no guarantee that interference will not occur in a particular installation. If this equipment does cause harmful interference to radio or television reception, which can be determined by turning the equipment off and on, the user is encouraged to try to correct the interference by one or more of the following measures:

- Reorient or relocate the receiving antenna.
- Increase the separation between the equipment and receiver.
- Connect the equipment into an outlet on a circuit different from that to which the receiver is connected.
- Consult the dealer or an experienced radio/TV technician for help.

#### Radiation Exposure Statement

This equipment complies with FCC radiation exposure limits set forth for an uncontrolled environment. This equipment should be installed and operated with minimum distance 20cm between the radiator and your body.