

MUDIX 1080P Video Projector

Model: MX-2

Shenzhen Hifun Technology Co.,Ltd

Address: No.12, Longshan Road, Luotian Community, Yanluo Street, Baoan District,
Shenzhen China

CONTENTS

IMPORTANT SAFETY INSTRUCTIONS	02
SAFETY NOTICE	04
PACKAGE CONTENTS	04
PROJECTOR COMPONENTS & FUNCTIONS	05
REMOTE CONTROL BUTTONS	06
EQUIPMENT CONNECTION	07
INSTALLATION & ADJUSTING	08
1. Placement.	08
2. Adjust The Focus.	08
3. Projection Distance Reference.....	09
4. Power On/Off.....	10
HOME PAGE.....	11
Wi-Fi CONNECTION.....	15
WIRELESS MIRRORING.....	16
1. For IOS device --- mobile phone	16
2. For IOS device ---MacBook or ipad	16
3. For Android device--- Mobil phone	18
4. For computer device mirror cast.....	19
PROJECTION SETTINGS.....	20
TO PLAY FROM EXTERNAL DEVICES.....	22
CLEANING.....	23
REPAIR	23
SPECIFICATIONS.....	23
FAQ	24



Before using this product, please read the user manual carefully and keep it for future reference. Scan the QR code for more details.

- Please scan the QR code via phone or visit [https://mudix.afterservice.vip](https://mudix afterservice.vip) to REGISTER and EXTEND warranty.
- Defective item received or issues with product, please scan the QR code via phone or visit <https://mudix.afterservice.vip> to contact our 7/24 after service team.
- Any questions, advice or product issues, please send e-mail to mudix-@afterservice.vip.

Get 24/7 Assistance at



Or visit: <https://mudix.afterservice.vip>

IMPORTANT SAFETY INSTRUCTIONS

- Please read and understand all instructions before using this device.
- Don't change any settings that are not described in this manual.
- Warranty does not apply if personal injury, data loss, or damage occurs as a result of failure to follow instructions.

Warnings

- To reduce the risk of fire or electric shock, do not expose the device to rain or moisture. Objects filled with liquids, such as vases, should not be placed on the device.
- To prevent overheating, do not block or clog the ventilation openings.
- To avoid device damage or fire explosions, the air inlet/outlet/lens should be well ventilated when the projector is working.
- Never place the device in a confined space. Always leave enough space around the device for ventilation.
- Keep minimum (19.68 inch) space around the appliance for optimal ventilation.
- Do not place the device in areas susceptible to excessive dust and dirt or near any appliance generating a strong magnetic field.
- Protect the device against direct sunlight heat, large temperature fluctuations, and moisture.
- When the device runs for a long time and the surface becomes hot, shut it down and unplug the power cord. Resume operation only after the device has cooled.
- Always handle the device with care. Avoid touching the lens.
- Never place heavy or sharp objects on the device or the power cord.
- To avoid electric shock, do not disassemble the projector by yourself.
- Only use attachments or accessories specified by the manufacturer.
- Avoid extreme vibration. It may damage the internal components.

-
- Do not put any hazards into the accessories.
 - Do not use the projector in the following cases or it may pollute optical elements, reduce product life, and the projection image will be dark:
 - Wet, dusty, smoky places.
 - Places where the temperature is above 104°F.
 - A layer of moisture will form inside the device to cause a malfunction in the following cases:
 - If the device is moved from a cold place to a warm place.
 - After a cold room is heated.
 - When the device is placed in a damp room, please seal the device in a plastic bag to avoid moisture.
 - To avoid hearing damage, do not listen for extended periods at high volume. Set the volume at a safe level.
 - Do not allow children to handle the device without supervision.

Power Supply

- Power off the device before removing the power supply from the socket.
- Protect the power cord from being walked on or pinched, particularly at plugs, convenience receptacles, and the point where they exit from this device.
- Unplug this device if there are lightning storms or when unused for a long time.
- Where the mains plug or an appliance coupler is used as the disconnect device, the disconnect device shall remain readily operable. Before you make or change any connections, ensure that all devices are disconnected from the power outlet.
- Never touch the power cable or the power connection with wet hands.

SAFETY NOTICE

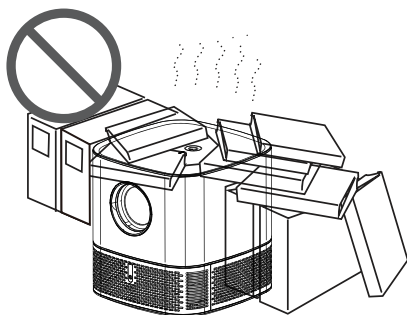

Do not install in unventilated places.

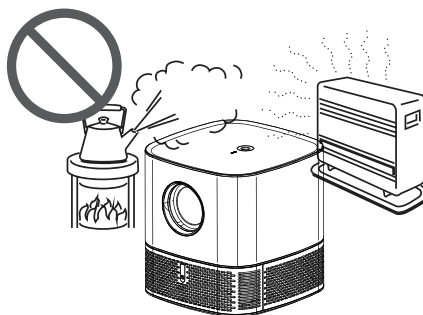

Do not install in high temperature or humid places.

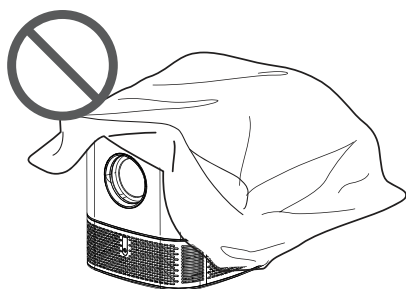

Do not block the ventilation holes (intake or exhaust)

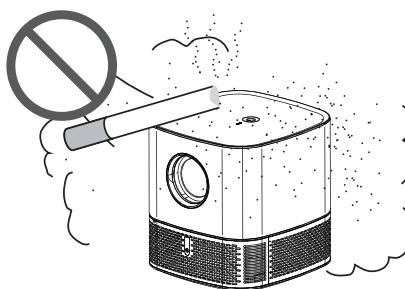

Do not install in dusty or smoky places.

PACKAGE CONTENTS

- Projector
- User Manual
- Remote Control
- Power Adapter

- Power Cord
- HD Cable
- Tripod Stand

PROJECTOR COMPONENTS & FUNCTIONS

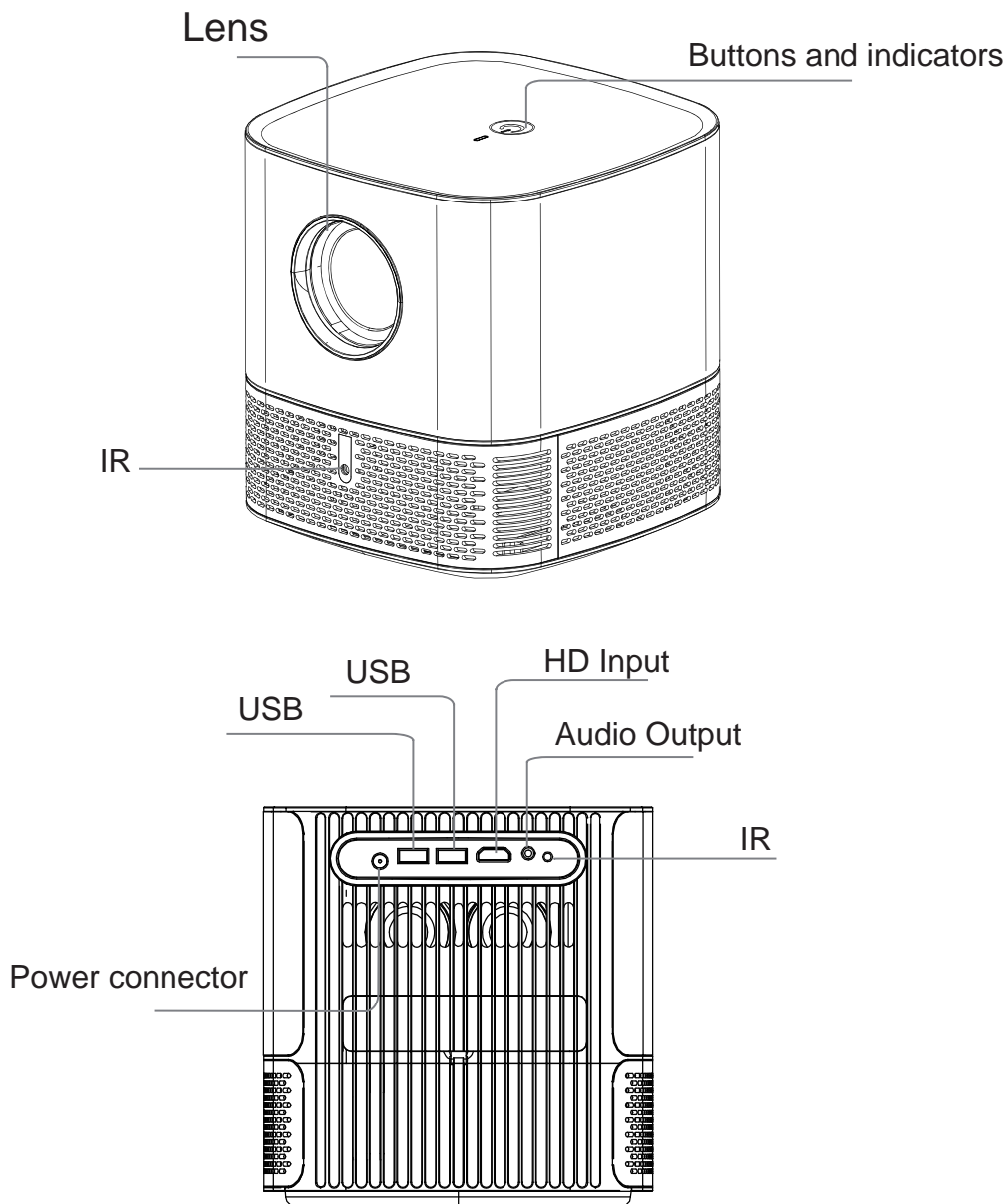

PROJECTOR COMPONENTS & FUNCTIONS

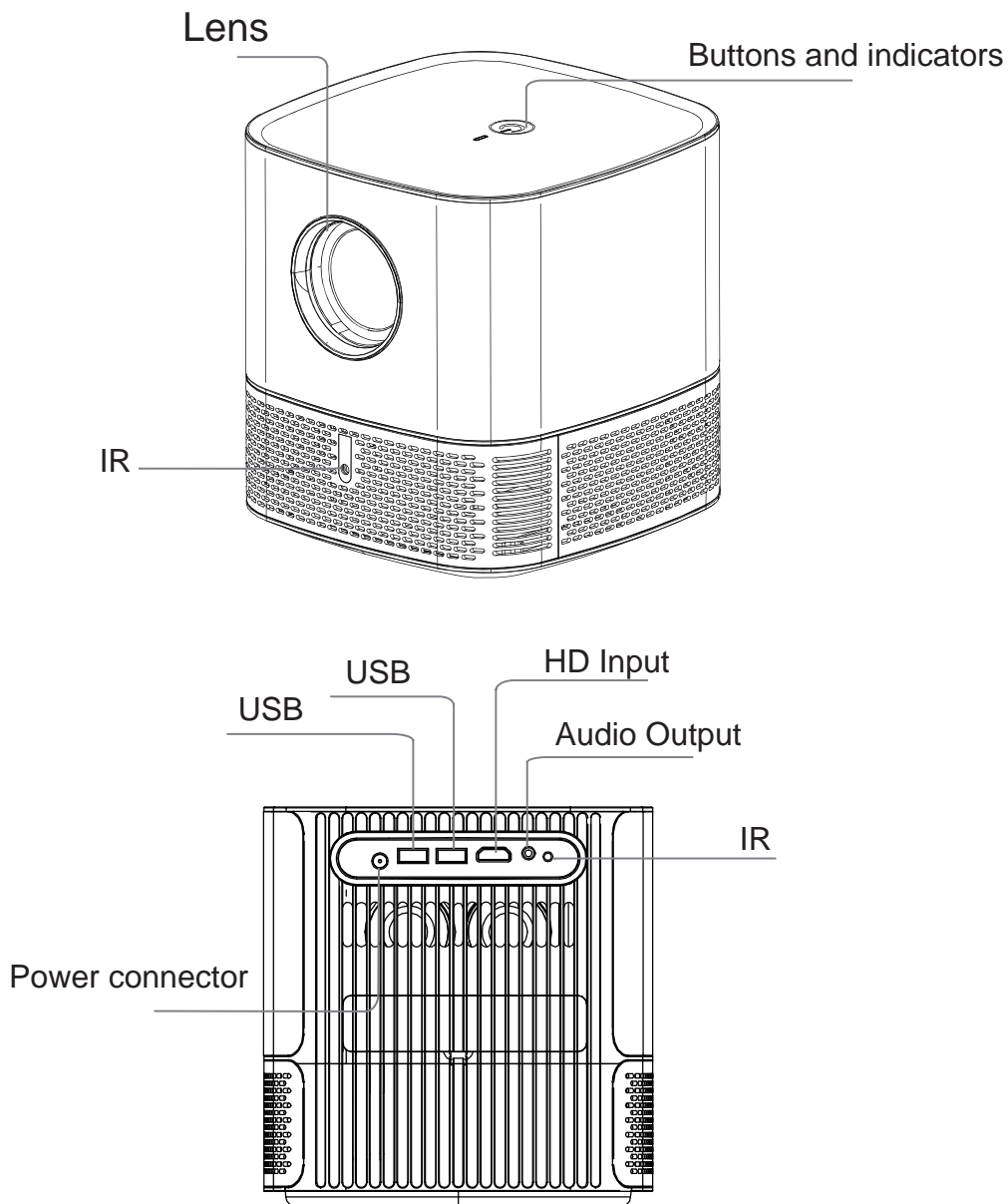

PROJECTOR COMPONENTS & FUNCTIONS

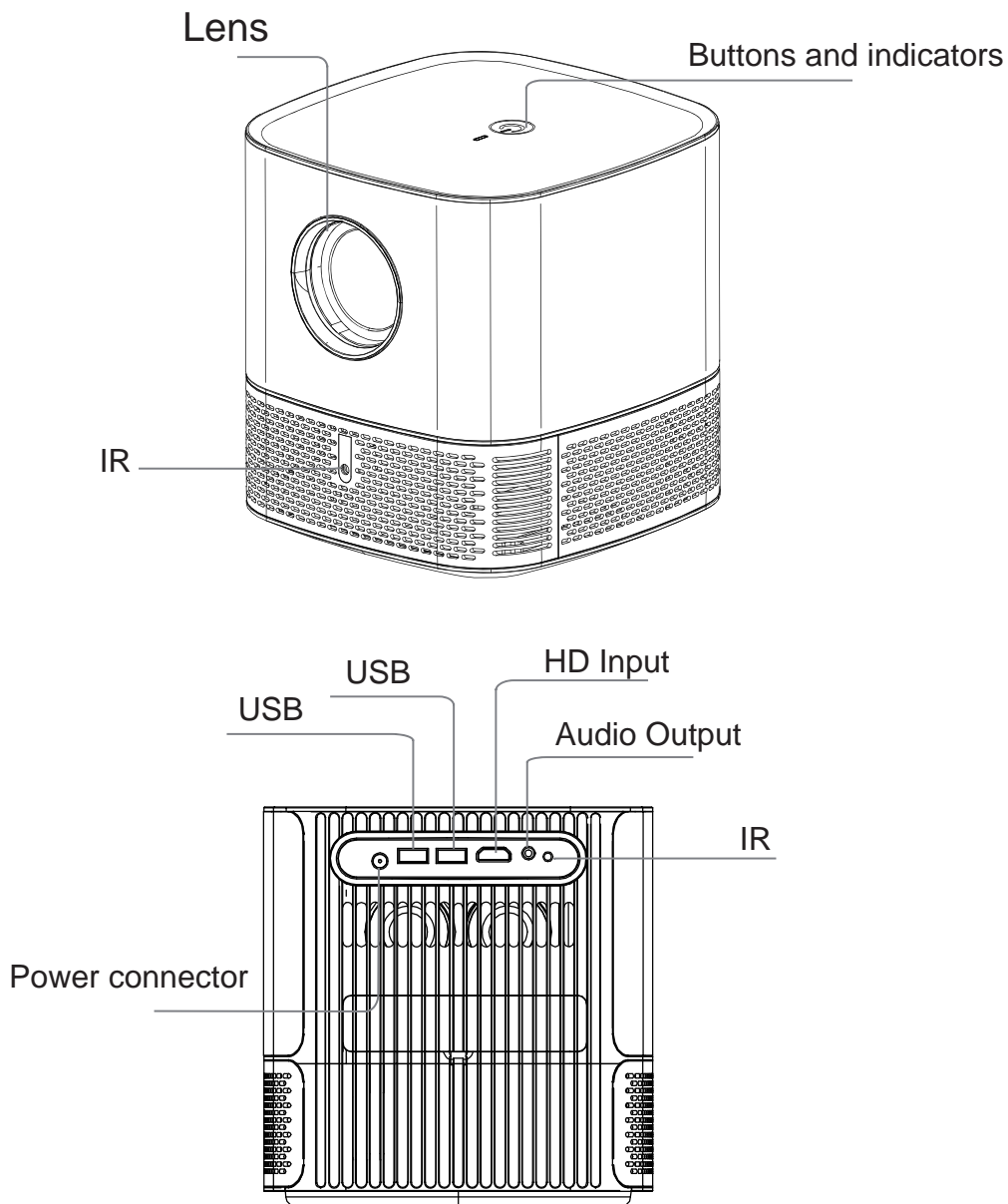

PROJECTOR COMPONENTS & FUNCTIONS

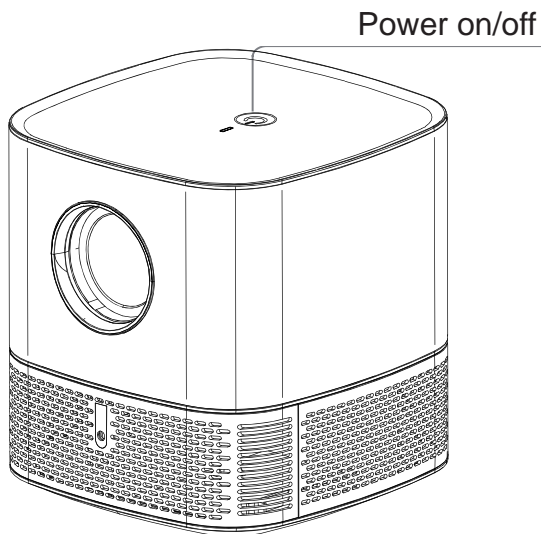

REMOTE CONTROL BUTTONS



	Power		OK
	HD		Volume -
	Mute		Volume +
	Up		Home
	Down		Return
	Left		Focus-
	Right		Focus+
	Menu		

EQUIPMENT CONNECTION

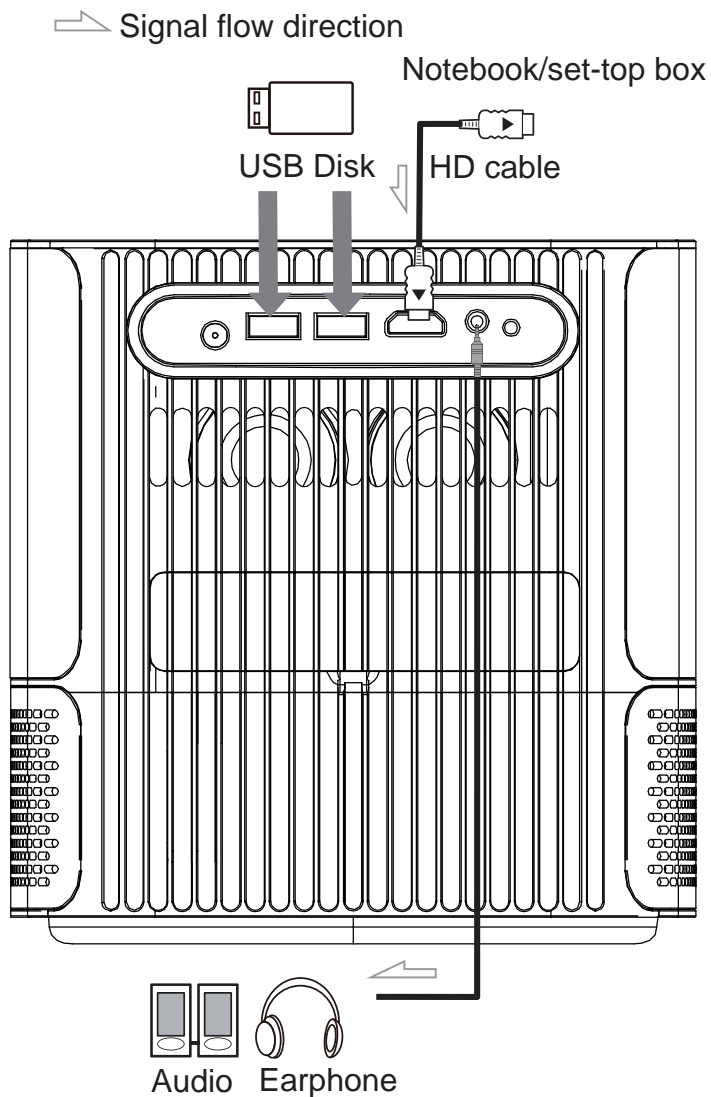

INSTALLATION & ADJUSTING

1 Placement

Place projector on a flat, stable foundation squarely in front of the projection surface. For best results, the projection surface shall be white and flat. The distance between this projector and the projection surface must be a minimum of 1.2 meters (47 inches).

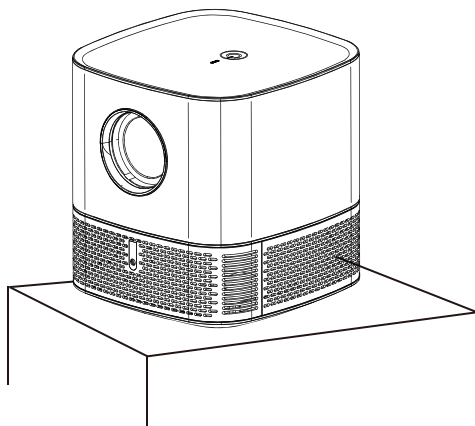

2 Adjust The Focus

Using remote control to adjust the focus of image.

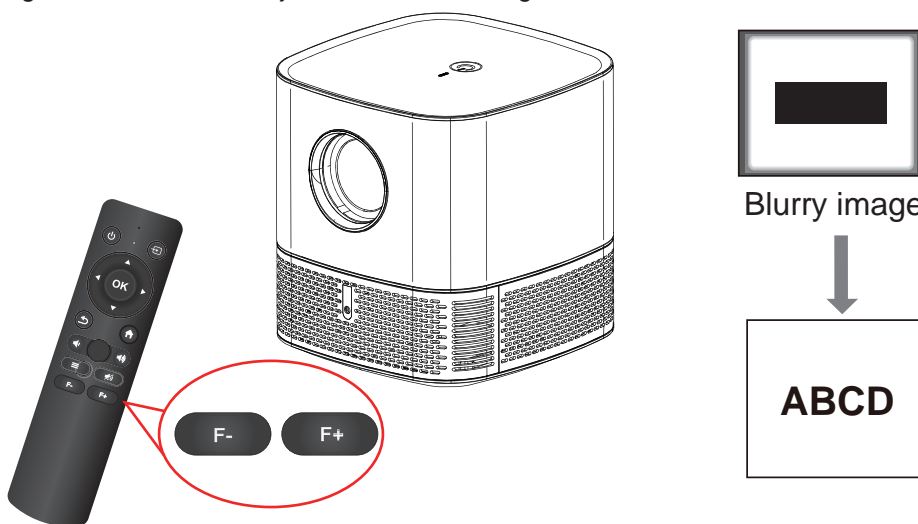

INSTALLATION & ADJUSTING

3 Projection Distance Reference

The distance between this projector and the projection surface determines the approximate size of the image.

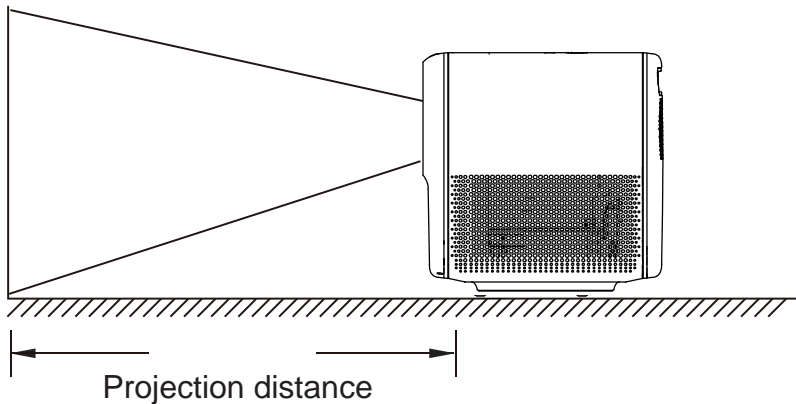

Projection size (inch)	Projection size (H*W) (inch)		Projection distance (inch)
36	(H)18.5	(W)31.49	43.4
56	(H)29.5	(W)52.36	66.9
66	(H)34.25	(W)61.02	78.74
86	(H)41.33	(W)73.22	98.4
96	(H)47.24	(W)83.8	110.2
116	(H)58.66	(W)104.72	133.8
136	(H)68.16	(W)122.04	203.8
156	(H)77.66	(W)139.36	227.4
176	(H)86.16	(W)156.68	301

INSTALLATION & ADJUSTING

4 Power On/Off

Power on

1. Connect this projector to an electrical outlet by using the provided power cord and adapter.
2. Remove the lens sticker.
3. Press the **Power** button on the projector to power on. Then turn this projector towards a flat, white projection surface.

Power off

Power off the device before removing the power supply from the socket.

Store the projector in a cool dry place.

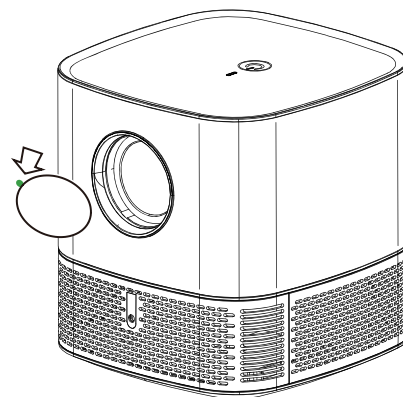

HOME PAGE

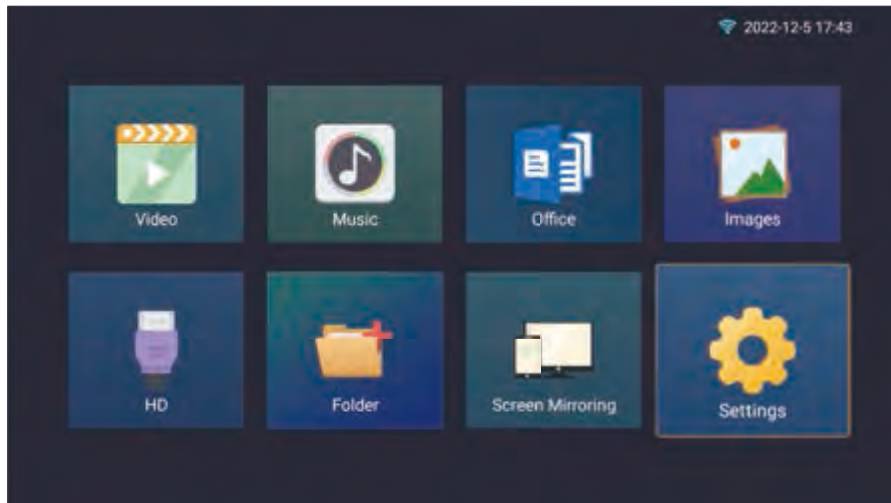

To play from HD playback devices, select "HD" and press "Enter".

This projector can be connected to various HD playback devices such as a TV box, TV stick, DVD player, set-top box (STB), gaming console, or other devices. To play from HD playback devices, connect this projector to an HD playback device with an HD cable.

To play from a USB drive, select "Movie" , "Music" , "Photo" , "Office" and press "Enter".

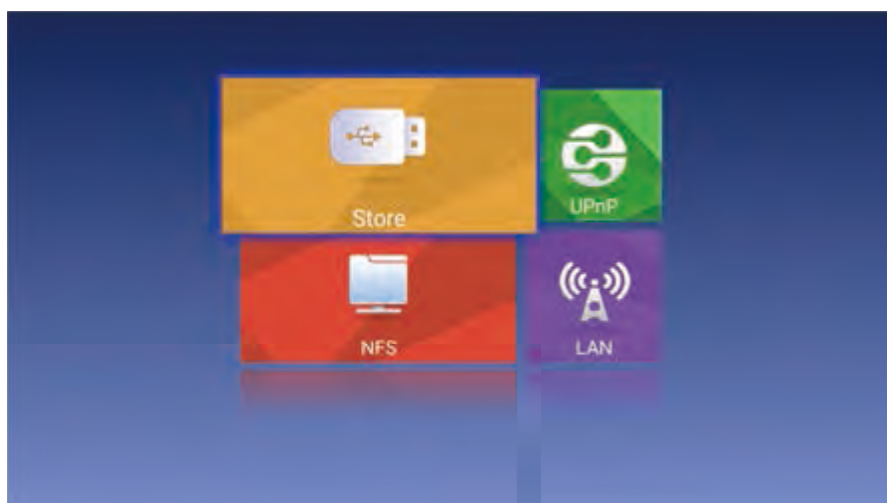

To play from a USB drive:

1. Insert a USB drive into the USB socket;
2. Select "Video" ,"Music" ,"Photo" ,"Office"and press "Enter"on the Homepage .
3. Select a file, then press **"Enter"**, this projector will play the video or music, or display the photo you selected.

After entering "Video", only videos are supported .

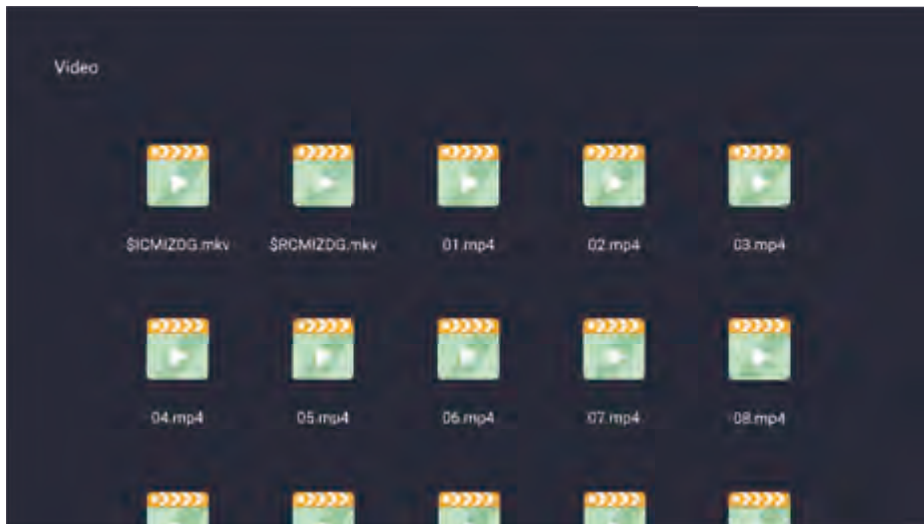



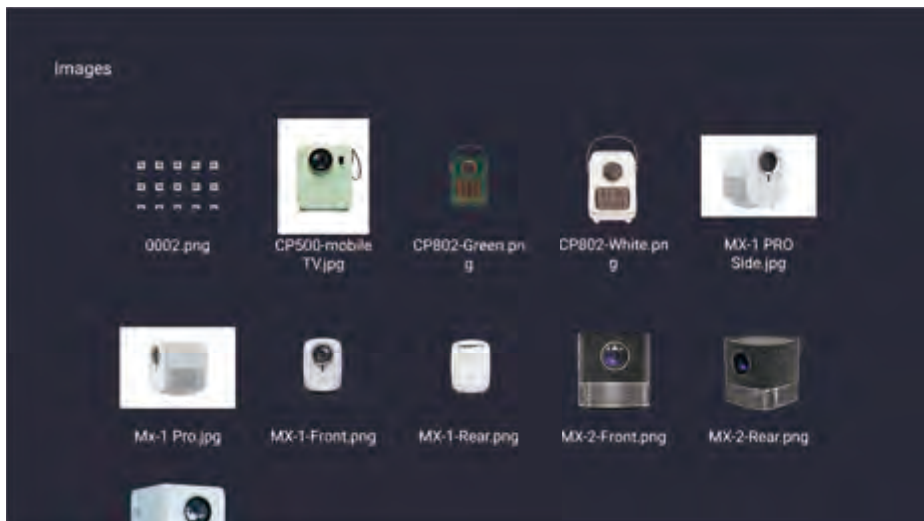

After entering "Photo", only pictures are supported.



After entering "Music", only music is supported.



After entering "Office", only files is supported.

1. "Office">--Select file in USB device .
2. "Office">--Press "  ">--Select Document or Spreadsheet >-- Select a file to modify.
3. "Office">--Press "  ">--Select Document or Spreadsheet >--Press"  " and "  ">-- blank file to modify.



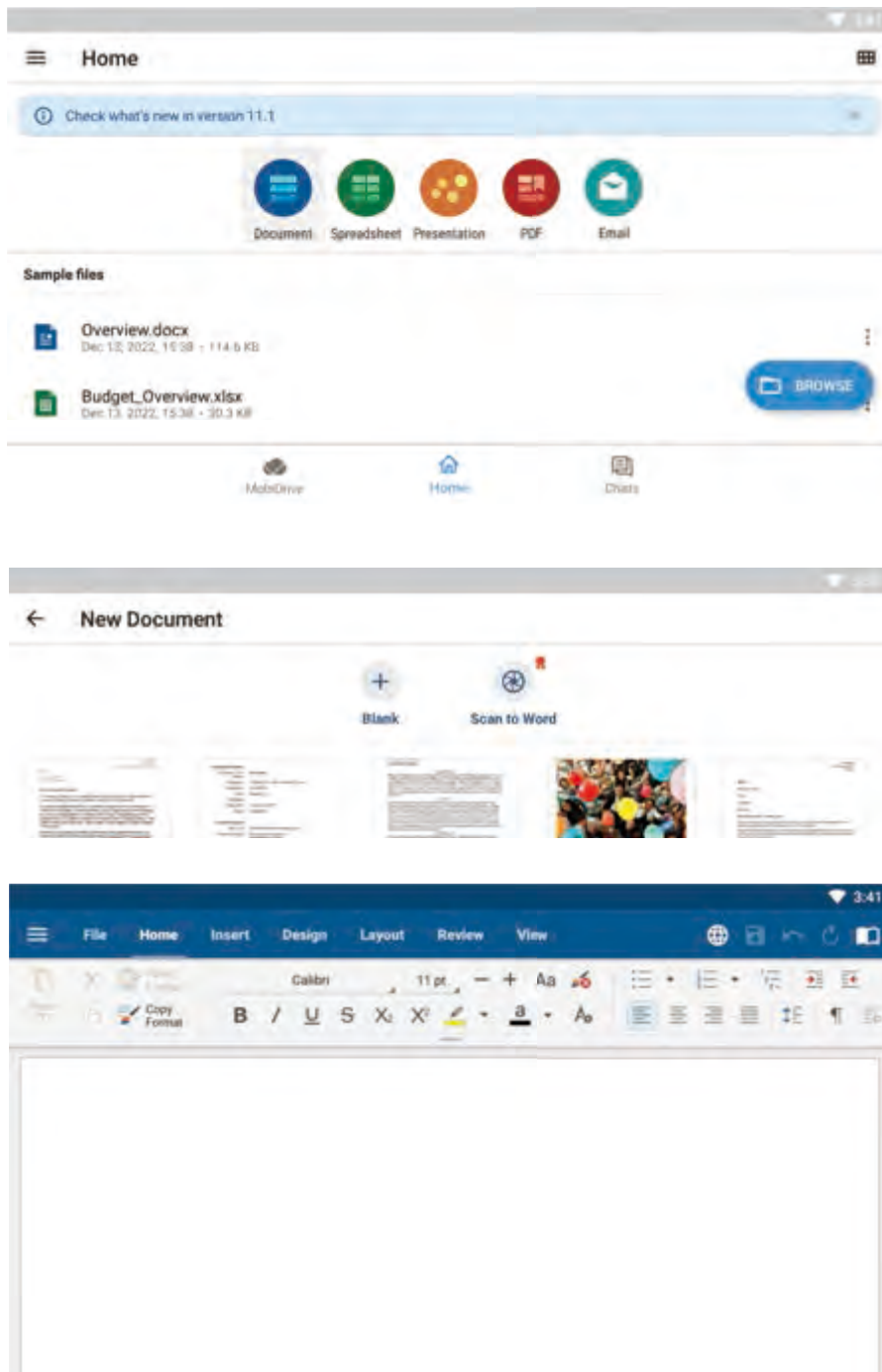

Wi-Fi CONNECTION

Enter "Setting" ,Wi-Fi press "on" , select your Wi-Fi and input password.

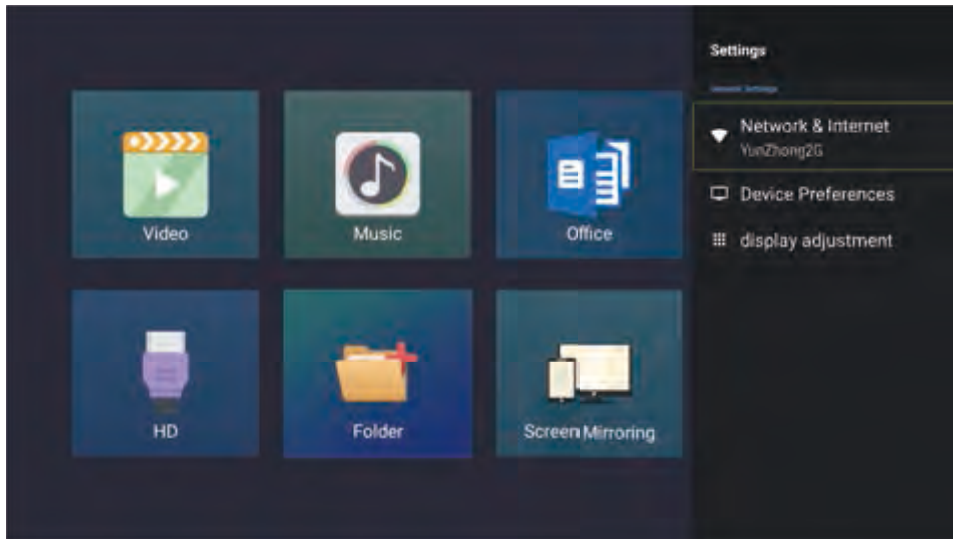

WIRELESS MIRRORING

1 For IOS device ---- mobile phone

- 1) Ensure the mobile phone and the projector are connected to the same network;
- 2) Enter the mobile phone control center ->screen image, and select the device to start projection.



2 For IOS device ----MacBook or ipad

- 1) Ensure the device and the projector are connected to the same network;
- 2) Enter the control center ->screen image in the upper right corner of MacBook, and select the device to start projection.



WIRELESS MIRRORING

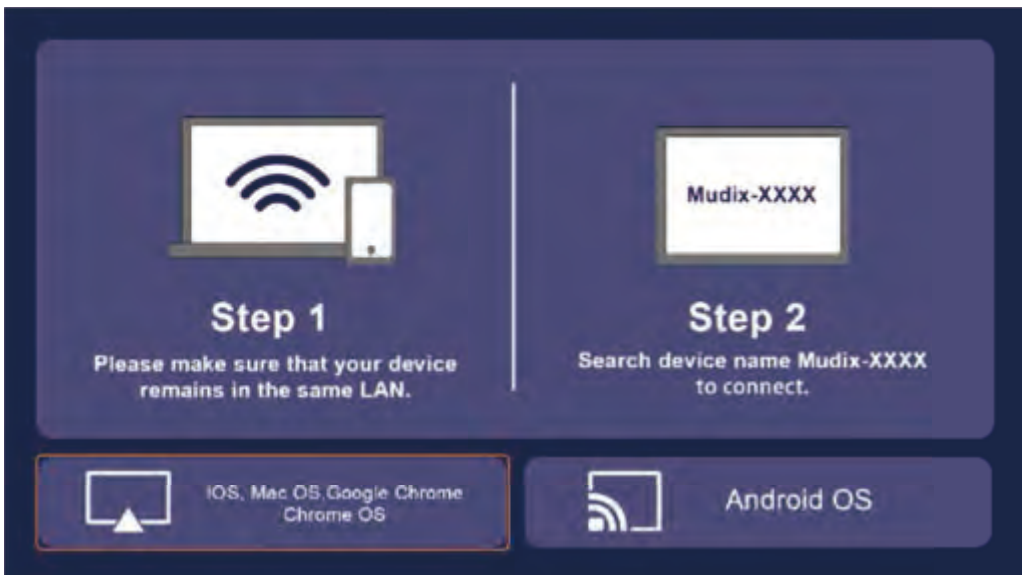

3 For Android device--- Mobil phone

- **Android mobile phone (with Google service pre installed), use the ChromeCast projection.**
 - 1) Ensure the device and the projector are connected to the same network;
 - 2) Search the projection/projection function of the Android mobile phone (different mobile phone manufacturers may have different names for this function), and select corresponding device to start projection.
- **Other type of Mobil phone**
 - 1) Ensure the device and the projector are connected to the same network;
 - 2) Enter the mobile phone control center ->screen mirror, and select the device to start projection.

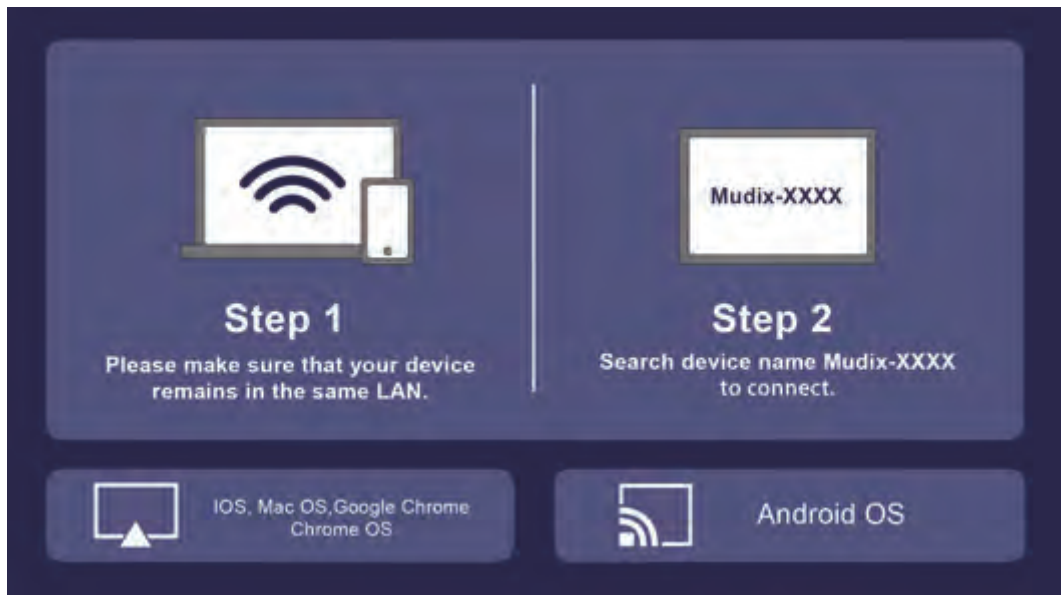

4 For computer device mirror cast

- **Use ChromeCast projection computer equipment, etc.**

- 1) Ensure the device and the projector are connected to the same network;
- 2) Google Chrome browser: click the "More" icon in the upper right corner of Chrome browser, ->enter the "Release" (or projection) function, ->and then select the corresponding device to start projection.

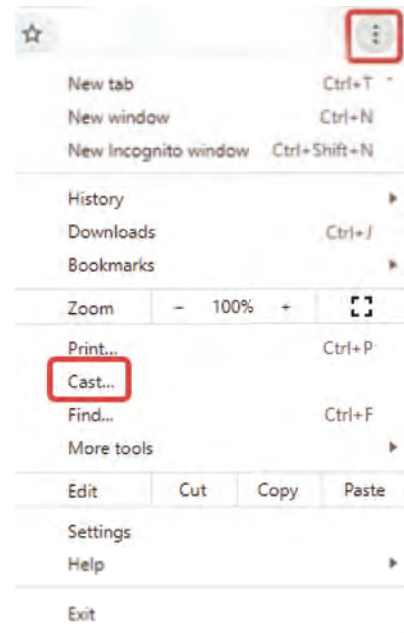

- **Chromebook then use ChromeOS etc.**

- 1) Ensure the device and the projector are connected to the same network;
- 2) Click the system time in the lower right corner, ->enter the "Release" , and select the corresponding device to launch the screen.



Note:

- For specific operations, please refer to the actual user interface of your device.
- After entering "Screen Mirroring", press the " ↶ " button on the remote control to return to the homepage.

Projection settings

Enter "Settings", select "Display Adjustment" to adjust the projection for your needed.

- **Projection mode-----Front projection, side projection, rear projection etc...**

Enter Projection mode, press "ok" button to change the projection mode, like : Front projection, side projection, rear projection etc...

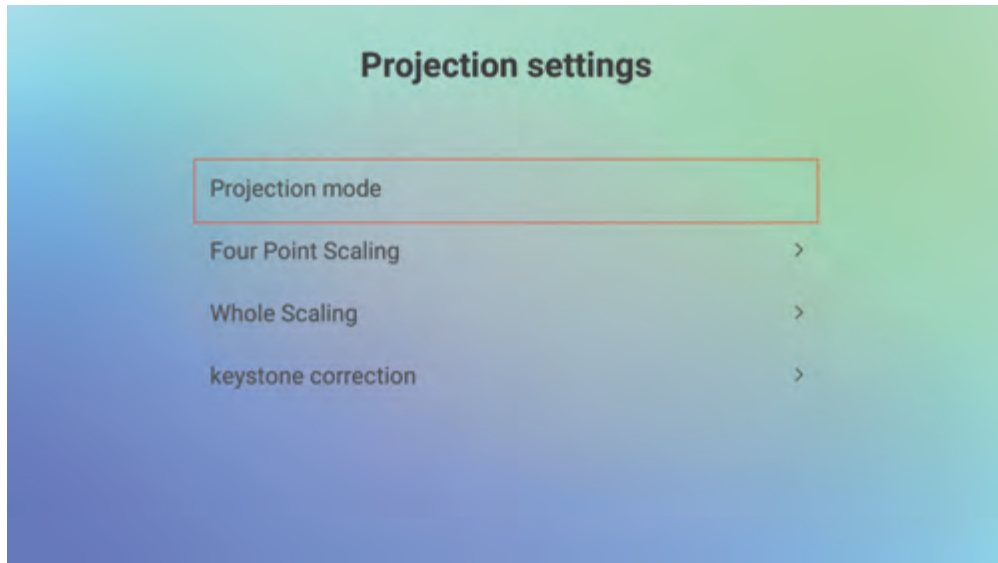

- **Four Point Scaling----- point adjustment**

Press "ok" button to select point adjustment . Press "↶" button to backack. Press Menu button to reset.

When the center circle is positivem, the picture proportion would be most appropriate viewing angle.

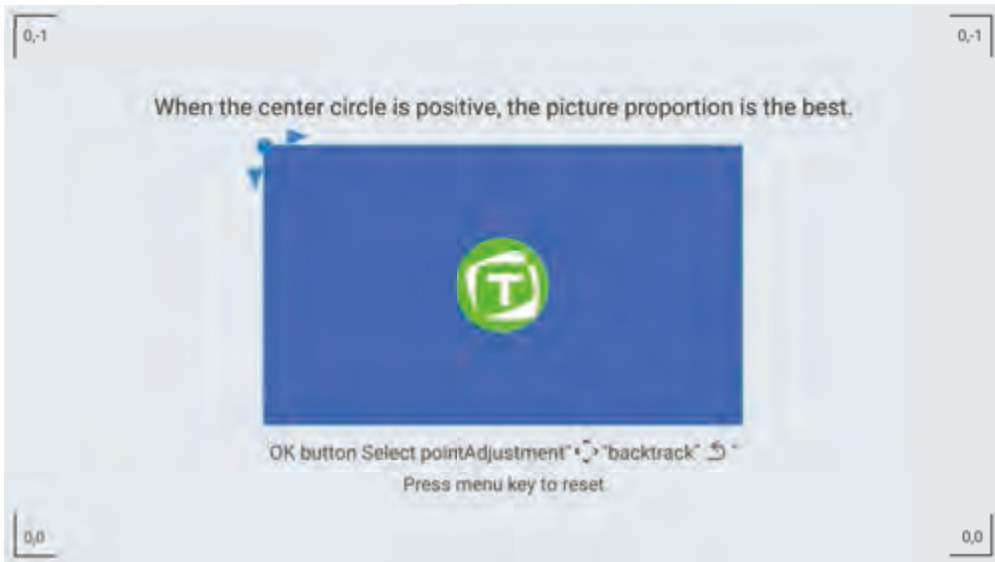

- **Whole Scaling-----zoom the screen**

Press left button or right button to zoom the screen. Press menu button to reset.

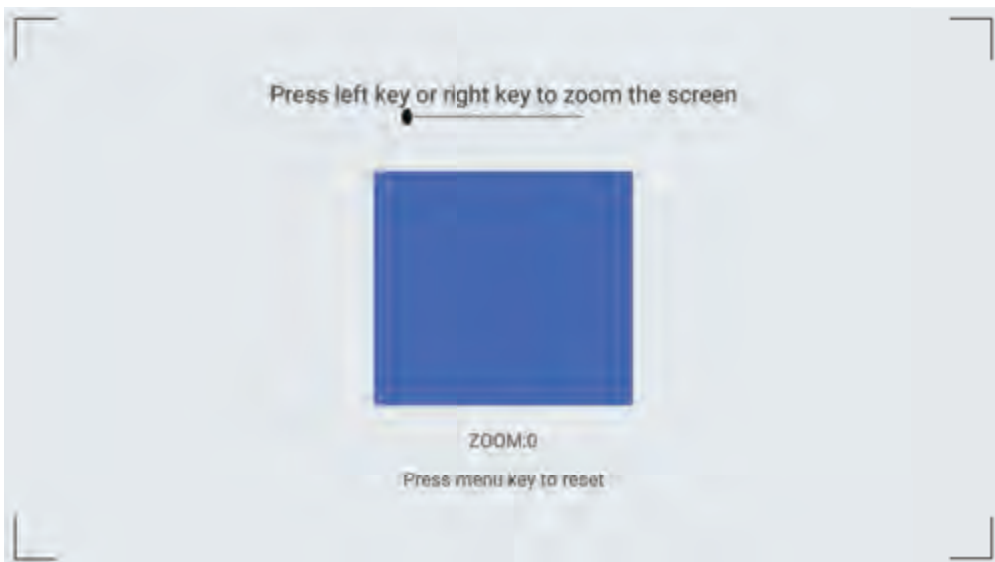

- **Keystone Correction----screen adjustment**

Press "ok" button select point . Adjust the screen by the direction button until the auxiliary line is rectangular Press "menu" button to reset.



TO PLAY FROM EXTERNAL DEVICES

- Use a 0.137 inch audio cable (not provided) to connect your headphones or external speakers;
- Connect the other end of the audio cable to the audio out port on this projector;
- You will hear audio from external devices;
- When connected to external speakers, the built-in speaker system is disabled.

CLEANING

- Power off the device and remove it from the power supply before cleaning the surface.
- Use a soft, lint-free cloth. Never use liquid, gaseous, or easily flammable cleansers (like sprays, abrasives, polishes, and alcohol).
- Do not use any liquid cleaning agents to clean the lens as they may damage the protective coating on the lens.
- Wipe the surfaces gently. Be careful that you do not scratch the surfaces.
- Use lens clean paper to clean the lens of this projector.

REPAIR

- Do not make any repairs for the device yourself.
- Improper maintenance can result in injuries or damage to the device.
- Refer all servicing to qualified service personnel.

SPECIFICATIONS

Light source: LED

Speaker drivers: 5W

Power consumption: 65W

Resolution: 1920*1080P Native

Display technology: 3.97 inch LCD

Dimensions: 7.2*5.3*7.6 inch

Weight: 2.8lb

Power supply: AC 110-240V/DC 19V@3.5A

Remote control batteries: 2 AAA batteries (not included)

Accessories: User Manual, Remote Control, HD Cable, Power Adapter, Power Cord, Tripod Stand.

FAQ

- **Display available, the audio does not work?**

The audio decoding format is not supported or exceeds the decoding capability range.

- **Audio available, the display does not work?**

The video decoding format is not supported or exceeds the decoding capability range.

- **No signal in the screen?**

The projector does not identify the device which is connected.

- **Why is the image blurry?**

Please use the remote control (F- , F+) to adjust.

- **How to connect Wi-Fi?**

Enter "Setting" ,Wi-Fi press "on" , select your Wi-Fi and input password.

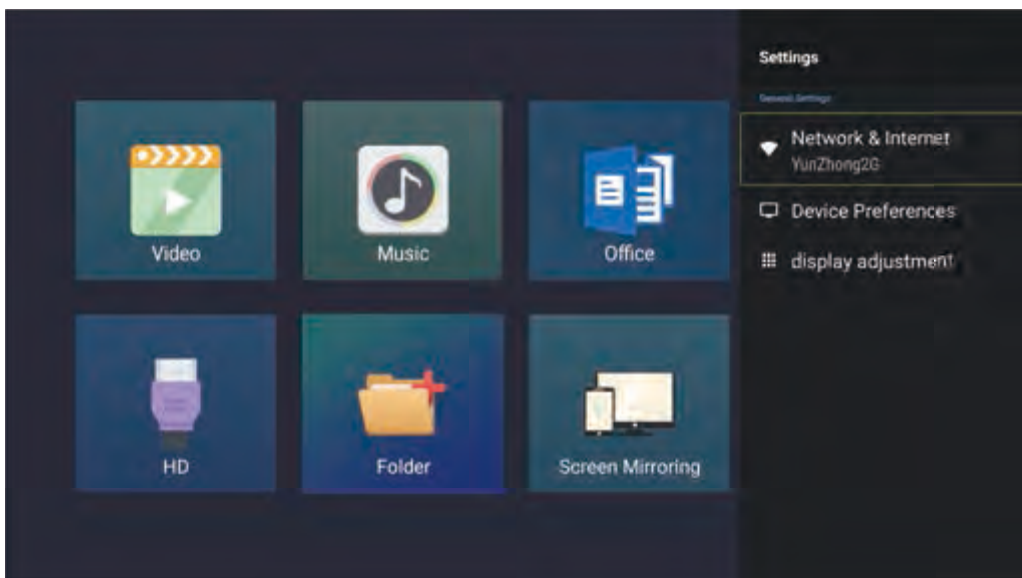

● **How can I connect my smart phone? How to use screen mirroring?**

See method below.

1 . For ios , Mac OS , Google Chrome , Chrome OS

