

USER MANUAL

Bluetooth Speaker

K03

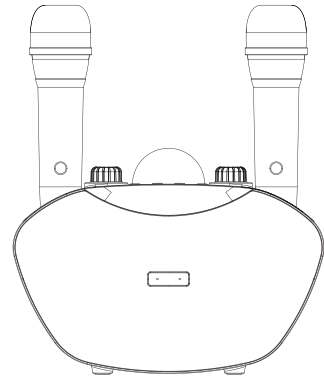

Thank you for choosing K03 Karaoke Entertainment Bluetooth Speaker. Please read and save the user manual.

一. Warning and reminder:

- To reduce the risk of fire or electric shock, do not expose this product to moisture or rain.
- Do not place the product to any open flame.
- Use the supplied charger to charge.
- Do not charge the battery for a long time when not in use.
- After a long period of storage, you may need to charge and discharge the battery several times to get the best performance.
- Do not use the product to hit something.
- Do not close the strong magnetic field, electric field.
- Do not approach the heating device.
- Do not disassemble, repair, or modify by yourself.
- Do not remove Lithium battery from the product by yourself.
- Please sort out properly for waste packaging, battery, old electronic product parts.
- Please charge once a month to extend the battery life, even if you do not use the product.

二. Operating prompt:

1. This machine supports Bluetooth version 5.0 and enters Bluetooth mode after booting. The audio source accessed after automatic recognition is given priority. Switch between different audio sources via the M key.
2. In the Bluetooth playback mode, long press ►|| button to disconnect the Bluetooth connection, and long press ►|| button again to connect to the last connected Bluetooth device.
3. The battery cut-off working voltage is set to 3.4V, When the cut-off working voltage is reached, it will prompt three warning sounds and then shut down. Please charge in time.
4. Support USB disk, TF card lossless music perfect decoding playback, support mp3, wav, ape, flac, acc, wma format tracks.
5. Dual U-segment wireless microphones, dual DSP audio processing.
6. Colorful stage lighting effects.

7. Based on the special debugging method of karaoke speakers, in order to have a better low-frequency experience, it is recommended to place the speakers on the desktop against the wall. The sound effect is best when the speaker duct is 5cm away from the wall.

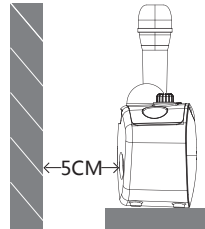

三. Function key introduction and interface function definition:

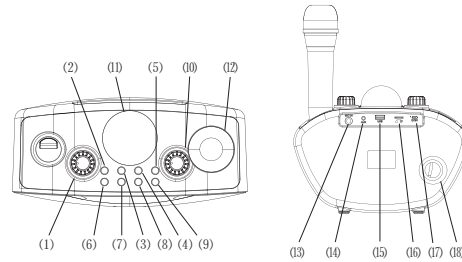

- (1) ECHO: adjust clockwise to increase, counterclockwise to decrease.
- (2) LED: Long press to turn on/off the stage lights/short press Ambient sound-applause and cheers.
- (3) MIC-: Long press to decrease the microphone volume
- (4) MIC+: Long press to increase the microphone volume.the maximum volume has a "didi" prompt.
- (5) Vcal cut: Short press to eliminate the original singing voice, short press again to restore the original singing voice.
- (6) M: Long press to switch between different audio sources/short press to switch between microphone KTV mode and professional mode
- (7) ◀: Short press to select the previous song.
- (8) ▶||: Short press to play/pause; in Bluetooth mode, long press to disconnect from Bluetooth, long press again to connect to the last connected Bluetooth device.
- (9) ▶: Short press to select the next song.
- (10) Power switch/master volume adjustment: turn clockwise to turn on the device until the volume is at the maximum, turn counterclockwise to decrease the volume until it turns off.
- (11) Stage lighting
- (12) Microphone slot
- (13) 6.5mm wired microphone input jack..
- (14) AUX input: 3.5mm stereo signal input interface.
- (15) USB disk input
- (16) TF card input port
- (17) Charging port: micro DC5V charging, please choose a suitable adapter. The red light is on when charging, and the red light is off when fully charged.
A. In the Bluetooth mode, the blue light flashes quickly when not connected, and the blue light becomes steady after the Bluetooth connection;
B. In AUX mode, the blue light flashes slowly; and in USB and TF card mode, the blue light is always on.
- (18) Air duct

四. Bluetooth connection operation method:

1. Turn the potentiometer clockwise to turn on, the voice prompt enters the Bluetooth mode, waiting for connection, at this time the blue light flashes quickly.
2. Turn on the external device with Bluetooth function, turn on the Bluetooth function, search for "K03" for pairing, when you hear the voice prompt and the connection is successful, you can open the music player to play music. The blue light flashes slowly at this time.
3. For devices that have been successfully paired, Bluetooth will automatically connect back after turning it off and on again.

五. Charging:

The Micro port of the charging cable to the Micro jack, and plug the USB port into the DC5V/2A adapter or the USB port of the computer to charge the speaker. The red indicator light is on when charging, and it is off when it is full.

六. specifications:

Output power: 20W*1
Frequency response: 80Hz-20KHz
Signal to noise ratio: -90dBA
Maximum sound pressure level: 92dB
Distortion: ≤5%
Audio input: Bluetooth, AUX, USB, TF card, microphone
Speaker unit: 5.25"woofer*1, 4Ω15W; 1.5" tweeter*1, 4Ω5W
Charging voltage: DC5V/1A
Battery specifications: Speaker: two 18650 lithium batteries in parallel, 4000mAh/ 3.7V
Microphone: single 18650 lithium

battery, 1200mAh/3.7V
Speaker size: L250mm×W116mm×H182mm
Microphone size: Φ36.5*H208mm
Speaker bare metal weight: 1365g

七. Packaging accessories:

Machine: 1 set
Wireless microphone: 2Pcs
Charging data cable: 1pc
Audio cable: 1 pc
Manual: 1 pc

FCC Statement

Changes or modifications not expressly approved by the party responsible for compliance could void the user's authority to operate the equipment. This equipment has been tested and found to comply with the limits for a Class B digital device, pursuant to Part 15 of the FCC Rules. These limits are designed to provide reasonable protection against harmful interference in a residential installation. This equipment generates uses and can radiate radio frequency energy and, if not installed and used in accordance with the instructions, may cause harmful interference to radio communications. However, there is no guarantee that interference will not occur in a particular installation. If this equipment does cause harmful interference to radio or television reception, which can be determined by turning the equipment off and on, the user is encouraged to try to correct the interference by one or more of the following measures:
-- Reorient or relocate the receiving antenna.
-- Increase the separation between the equipment and receiver.
-- Connect the equipment into an outlet on a circuit different from that to which the receiver is connected.
-- Consult the dealer or an experienced radio/TV technician for help
This device complies with part 15 of the FCC rules. Operation is subject to the following two conditions (1) this device may not cause harmful interference, and (2) this device must accept any interference received, including interference that may cause undesired operation.