

Quick Start Guide

Qackage Content



Controller x1



Tracker x1



Loop x1



Band x2



Charge Cable x2

Overview

X1 tracker adopts unique algorithm and electromagnetic wave technology, which can be completely separated from the mobile phone app. The relative direction and distance of the tracked equipment are displayed on the screen of the controller, so as to get rid of the original trouble of viewing the position on the app map, and find the tracked equipment conveniently and quickly with one click



No Phones



No WiFi



No Networks



No Maps



No Apps



No Monthly
Fees

Product View

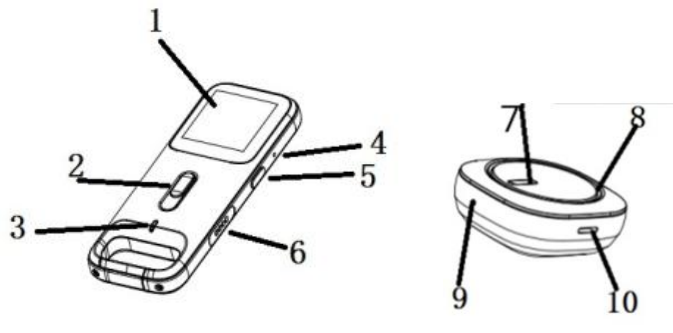

1:LCD

2:Function keys

3:LED

4:Rester

5: On / off key

6:Cherge

7: On / off key

8: LED

9: Rester

10: Speaker

Pre-use Settings



1: Download APP

Scan QR code to download and install Mofinder X1 APP.

You could also download it from Apple App store or

Google play directly by searching Mofinder X1



2: User Registration

Open Mofinder X1 APP click " Register", enter personal email to obtain a verification code. Check your email and enter the verification code you received. Finalize the registration by creating password.

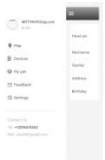

3: Connect devices

①: Open APP tap the menu button on the upper left and tap "+" button.

②: Follow APP Guide to complete binding procedure.

③: Tap "Device " to check connectio



4: Control and view:

1: Through GPS positioning, the controller can view the actual distance and direction of the tracker.

2: Turn on voice or light control through multi-function keys

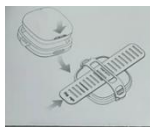

5: Installation

Product Installation Gently press Tracker down to the concave side of loop, Attach band to the loop as shown in the picture and start tracking

Light indication

Indicator	red	green	Blue
charge	Blinking Red Light		
GPS positioning			Blinking Blue Light 1s\1time
GPS positioning succeeded			Blinking Blue Light 5s\1time
Data communication succeeded		Blinking Blue Light	
Battery capacity<10%	Blinking Red Light		
Night light display	Blinking	Blinking	Blinking
Power on	Blinking 1s	Blinking 1s	Blinking 1s
Power off	Blinking 3s		

Contact

Note: Please go to "Help Center" for more advanced functions, you could also scan the following QR code for detailed video guides:

Contact: Tel: +1-201-657-5353

Email: Mofinder@gmail.com

FCC Statement:

This device complies with Part 15 of the FCC rules. Operation is subject to the following two conditions: 1) this device may not cause harmful interference, and 2) this device must accept any interference received, including interference that may cause undesired operation.

This equipment has been tested and found to comply with the limits for a Class B digital device, pursuant to Part 15 of the FCC rules. These limits are designed to provide reasonable protection against harmful interference in a residential installation. This equipment generates, uses and can radiate radio frequency energy and if not installed and used in accordance with the instructions, may cause harmful interference to radio communications. However, there is no guarantee that interference will not occur in a particular installation. If this equipment does cause harmful interference to radio or television reception, which can be determined by turning the equipment off and on, the user is encouraged to try correct the interference by one or more of the following measures:

- Reorient the receiving antenna.
- Increase the separation between the equipment and receiver.
- Connect the equipment into and outlet on a circuit different from that to which the receiver is connected.
- Consult the dealer or an experienced radio/TV technician for help.

Changes or modifications not expressly approved by the party responsible for compliance could void your authority to operate the equipment