

尺寸80*100mm

双面印刷，折页，128g铜版纸

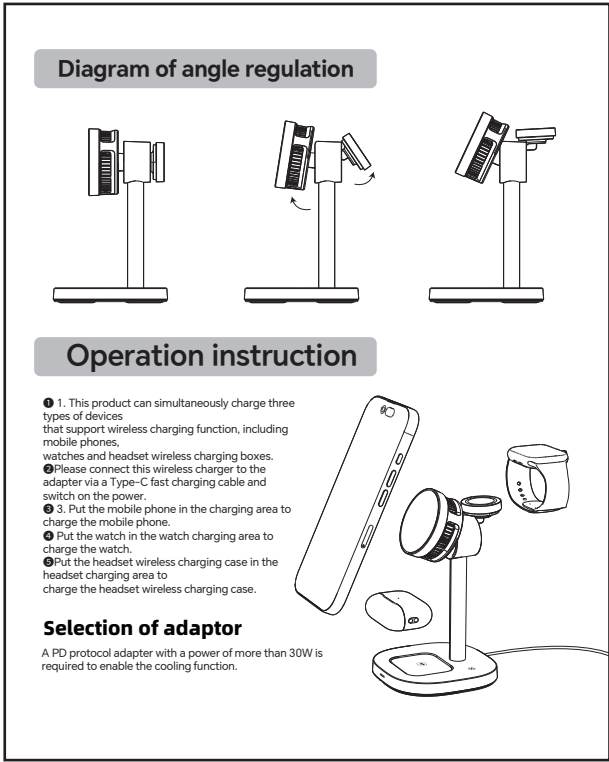
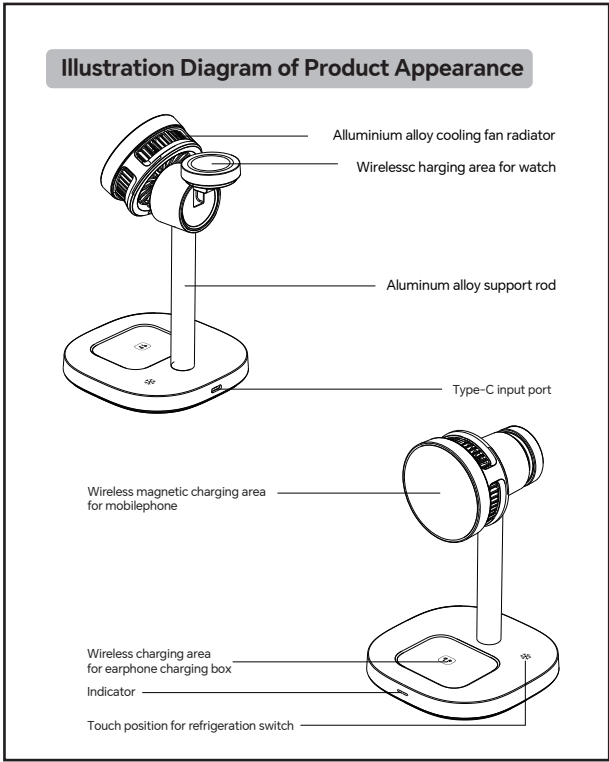
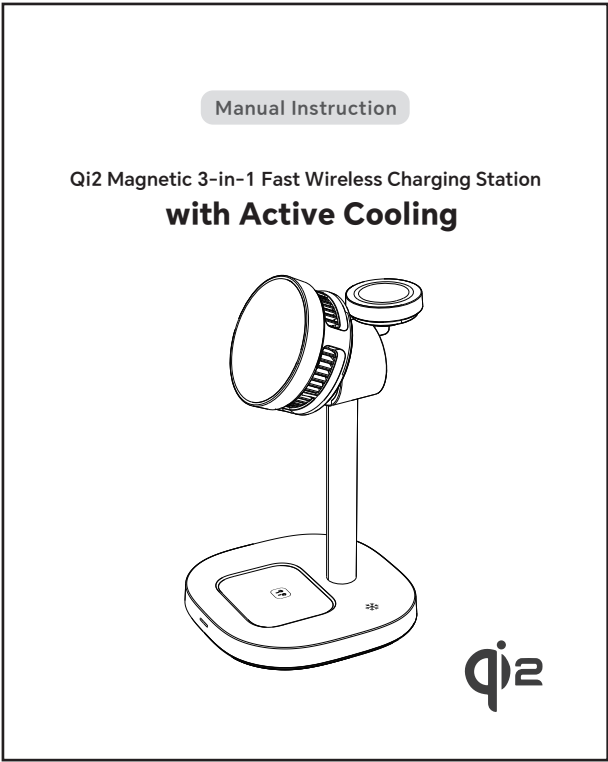

Indicator status

Mode	Indicator
Switch on	Blue light and green light alternatively flashes once, then turns to blue light and lights up for 5 seconds before light off.
Standby	Light off
Charging for earphone charging box	Green light turns on for 3 seconds
Full charge	Indicator light has no changes
FOD protection of mobilephone end	The blue light continues flashing until the abnormal state is removed, and the refrigeration system stops working
FOD protection of earphone end	The green light continues flashing until the abnormal state is removed
Refrigeration in progress	The blue light is constantly on

Explanation of refrigeration functions:

Switch on status: Refrigeration stops after 5 seconds of operation

Standby status: Refrigeration doesn't work

Operation status: Put on your phone and charge it, and the refrigeration system will automatically start working.

Touch switch for refrigeration: Touch the refrigeration switch icon to cycle alternately (turn on/off refrigeration).

Mobilephone is fully charged: Refrigeration automatically stops.

Protection function: If the NTC probe detects a temperature above 50 degrees, it indicates that the TEC (Thermoelectric Cooler) is working abnormally and has stopped working.

⚠ Attention: When the output power of the USB-A adapter or PD adapter is less than 27W, the output power is insufficient and the cooling cannot be switched on. The output power of the mobile phone is 10W.

Introduction of Function for Touch-type Refrigeration Switch

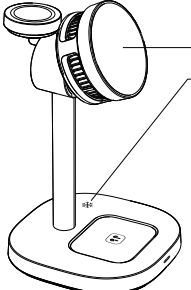

Refrigeration region of mobilephone end

Touch switch: The touch switch (on/off) alternates in a cycle. The blue indicator light remains ON when the refrigeration turns on, and becomes OFF when the refrigeration turns off.

When there is no device on the mobile phone, the refrigeration will automatically turn off, and touch the switch to turn on the refrigeration for 5 seconds before refrigeration stops.

When there is a charging device on the mobile phone: touch the switch to turn on/off the refrigeration and fan. Touch to turn off the refrigeration and continue the fan for 5 seconds before the fan stops. Wireless charger automatically adjusts its power according to the charging needs of each device.

When the mobile device is fully charged, the refrigeration will automatically turn off.

Product parameters

input	output
USB-A: 9V⚡3A, 12V⚡2.25A	mobile phone: 5W/7.5W/10W(max) Charging box of earphone: 5W (max) Watch: 2.5W (max)
USB-C: 9V⚡3A, 12V⚡2.25A	mobile phone: 5W/7.5W/10W(max) Charging box of earphone: 5W (max) Watch: 2.5W (max)
USB-C: 9V⚡4A, 12V⚡3A, 15V⚡2.4A	mobile phone: 5W/7.5W/10W/15W(max) Charging box of earphone: 5W (max) Watch: 2.5W (max)

Name of product
Qi2 Magnetic 3-in-1 Fast Wireless Charging Station with Active Cooling

Product size
100*100*152mm

Conversion efficiency
70%-80%

Effective distance for wireless charging (mobile phone)
≤4mm

Working frequency
Phone: 115-20kHz(5W, 7.5W, 10W); 36kHz(15W)
Earphone: 115-20kHz
Watch: 300-350kHz

Material
ABS+Glass+Aluminium alloy

Cautions

Applicable devices
Please check whether your mobile phone supports wireless charging.
This product supports fast wireless charging and realizes short-distance wireless power transmission through coil induction.

⚠ Warning!

Do not put metal debris or magnetic cards on the charging board, as it may cause the charger to heat up! Foreign objects should be removed when an alarm is triggered!
Slight heating is a normal phenomenon, as the phone battery may generate heat during charging!
Do not place the charger near a fire source or corrosive environment !

Package list:

Wireless charger x1
Charging cable x1
Product Manual x1

CE FCC RoHS



FCC Warning

This device complies with part 15 of the FCC Rules. Operation is subject to the following two conditions:(1) This device may not cause harmful interference, and (2) this device must accept any interference received, including interference that may cause undesired operation.

Any Changes or modifications not expressly approved by the party responsible for compliance could void the user's authority to operate the equipment.

This equipment has been tested and found to comply with the limits for a Class B digital device, pursuant to part 15 of the FCC Rules. These limits are designed to provide reasonable protection against harmful interference in a residential installation. This equipment generates uses and can radiate radio frequency energy and, if not installed and used in accordance with the instructions, may cause harmful interference to radio communications. However, there is no guarantee that interference will not occur in a particular installation. If this equipment does cause harmful interference to radio or television reception, which can be determined by turning the equipment off and on, the user is encouraged to try to correct the interference by one or more of the following measures:

- Reorient or relocate the receiving antenna.
- Increase the separation between the equipment and receiver.
- Connect the equipment into an outlet on a circuit different from that to which the receiver is connected.
- Consult the dealer or an experienced radio/TV technician for help.

FCC RF exposure statement:

The equipment complies with FCC radiation exposure limits set forth for an uncontrolled environment. This equipment should be installed and operated with minimum distance between 20cm the radiator your body.