

## Quick Start Guide 快速操作指南

**FS-MG11-BT-BS&  
FS-R11P-BT-BS**

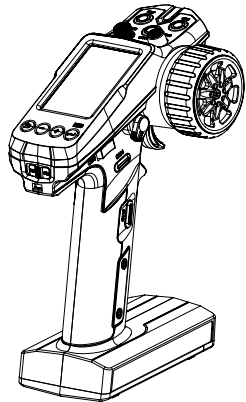

2.4GHz  
2A-BS

# FLYSKY



Http://www.flysky-cn.com  
Copyright © 2024 Flysky Technology Co., Ltd.  
Release date: 2024-01-16

## FLYSKY

Thank you for purchasing the products of Flysky! To find out more about our products, visit our website at [www.flysky-cn.com](http://www.flysky-cn.com). If you encounter any problems during using, please refer to the manual first. If the problem is still not resolved, consult your local dealer directly or contact the customer service staff via Flysky official website.

### Precautions

Read the safety messages listed below before operation!

- Do not use the product at night or during bad weather conditions, like rain or thunderstorms. It can cause erratic operation or loss of control.
- Do not use the product when visibility is limited.
- Do not expose the product to rain or snow. Any exposure to moisture (water or snow) may cause erratic operation or loss of control.
- Interference may cause loss of control. To ensure the safety of you and others, do not operate in the following places:



Near any sites where other radio control activity may occur



Near people or roads



On any pond/lake when passenger boats are present



Near power lines or communication broadcasting antennas

- Do not use this product when you are tired, uncomfortable, or under the influence of alcohol or drugs. Doing so may cause serious injury to yourself or others.
- The 2.4GHz radio band is limited to line of sight. Always keep your model in sight as a large can block the RF signal and lead to loss of control.
- Never grip the transmitter antenna during operation. It significantly degrades signal quality and strength and may cause loss of control.
- Do not touch any part of the model that may generate heat during operation, or immediately after use. The engine, motor or speed control, may be very hot and can cause serious burns.
- Misuse of this product may lead to serious injury or death. To ensure the safety of you and your equipment, read this manual and follow the instructions carefully.
- Make sure the product is properly installed in your model. Failure to do so may result in serious injury.
- Ensure that all servos operate in the correct direction. If not, adjust the direction first.
- Make sure that the model stays within range in order to prevent loss of control.
- The antenna(s) used for this transmitter must be installed to provide a separation distance of at least 20 cm from all persons and must not be co-located or operating in conjunction with any other transmitter. End-users and installers must be provided with antenna installation instructions and transmitter operating conditions for satisfying RF exposure compliance.

### CAUTION!

- RISK OF EXPLOSION IF BATTERY IS REPLACED BY AN INCORRECT TYPE. DISPOSE OF USED BATTERIES ACCORDING TO THE INSTRUCTIONS.**

### Transmitter Overview

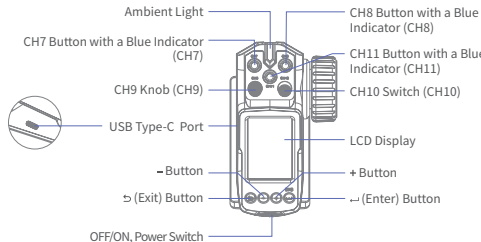
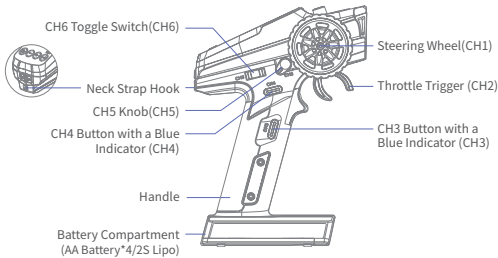

### Basic Operations

#### ► Installing the AA Battery

Follow the steps below to install the AA batteries:

- Open the battery compartment cover as illustrated.
- Insert 4 fully-charged AA batteries into the compartment. Make sure that the batteries are well set according to the polarities marked on the battery compartment.

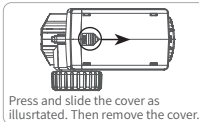

Press and slide the cover as illustrated. Then remove the cover.

- Replace battery compartment cover.

#### ► Installing the LiPo Battery

Follow the steps below to install the LiPo battery:

- Open the battery compartment cover.
- Insert 2S LiPo battery into the compartment.
- Plug the wiring of LiPo battery into the JST Jack.
- Replace battery compartment cover. Be careful not to pinch the cable.

#### ► Powering On

Follow the steps below to turn on the transmitter:

- Check to make sure that the batteries are fully charged and installed correctly.
- Toggle the Power Switch to the ON position. The ambient light will be on for 3 seconds, and then will be off.

#### ► Binding

The transmitter and the receiver have been pre-bound before delivery. If you are going to use another receiver, follow the steps below to rebind. The transmitter supports two-way binding, the steps are as following:

- Turn on the transmitter while holding  $\rightarrow$ , then the transmitter will enter the binding mode. At this time, the LCD display will show "BINDING...". Once in binding mode release the  $\rightarrow$  button.
- Turn on the receiver, and it will wait for 1 second for connection. If without connection, the receiver will enter the binding mode automatically. At this time, the receiver LED will be flashing fast.
- Once the binding is successful, the receiver LED and the Ambient Light of the transmitter will be solid on.
- Verify that the transmitter and the receiver are working properly. If you need to re-bind, repeat the above steps.

Note: Applicable to the FS-MG11-BT-BS transmitter and the FS-R11P-BT-BS receiver; The FS-MG11-BT-BS transmitter complies with the 2A-BS protocol and is only compatible with receivers conforming to this protocol; Different receivers have different binding procedures. For more information, visit FLYSKY official website for manuals and other related information.

#### ► Stick Calibration

Use this function to correct for the mechanical deviation of the throttle trigger, steering wheel and CH5 knob, for example, deviation occurred in the self-centering or maximum minimum travel, the steps are as following:

- Turn and hold the steering wheel clockwise to the max travel point and push the throttle trigger forwards as far as possible, and at the same time turn on the transmitter, then press  $\rightarrow$  to enter calibration mode, the buzzer will sound three times cyclically.
- Steering Wheel Calibration: Turn the steering wheel to the max and min travel point clockwise/counterclockwise respectively, and the buzzer will sound two times cyclically.
- Throttle Trigger Calibration: Push/pull the throttle trigger to forward/backward as far as it will go, and the buzzer will sound once cyclically.

1. Don't overcharge or over discharge the LiPo battery.
2. Read the instruction of the LiPo battery carefully before use.

- CH5 Knob Calibration: Turn the CH5 knob to its max and min travel point clockwise/ counter-clockwise respectively, and the buzzer will give a long beep.
  - Press  $\rightarrow$  to save and exit in case of the calibration is successful, and the buzzer will give a long beep.
- If the calibration fails, pressing the  $\rightarrow$  button is invalid. Repeat the steps above.

#### ► Failsafe

The function is used to protect the model and personnel when the receiver is out-of-control. It can be set at the transmitter side. By default, it is not set, and the PWM interfaces will maintain the last output in case of out-of-control. The setting steps are as following:

- Press  $\rightarrow$  to access the menu, then select F.SAFE using  $\rightarrow$  or  $+$  and press Enter to enter.
- Select a channel you want to set by using  $\rightarrow$  or  $+$  and press  $\rightarrow$  to confirm.
- Put the control corresponding to the channel to be configured with failsafe to the preset position, and meanwhile press  $\rightarrow$  to confirm.
- Press  $\rightarrow$  to exit.

#### ► Powering Off

Follow the steps below to turn off the transmitter:

- Turn off the receiver first.
- Toggle the transmitter's Power Switch to the OFF position to turn off the transmitter.

1. Make sure to power off the receiver before turning off the transmitter. Failure to do so can result out of control. Unreasonable setting of the Failsafe may cause an accident.

### Specifications

Product Model	FS-MG11-BT-BS
Compatible Receivers	FS-R11P-BT-BS, FS-R11D-ESC-BS, FS-R11P-BS
Compatible Models	Car
Number of Channels	11
RF	2.4GHz ISM
Maximum Power	<20dBm (e.i.r.p.) (EU)
2.4G Protocol	2A-BS
Resolution	4096
Input Power	1.5AA*4 or 2S Lipo
Working Current	About 60mA/6V
Low Voltage Alarm	Yes
Antenna	Single Built-in Antenna
Charging Jack	None (The USB Type-C port is only used for power supply.)
Online Update	Yes
Data Output	None
Distance	> 150m(Ground Distance Without Interference)
Temperature Range	-10°C ~ +60°C
Humidity Range	20% ~ 95%
Dimensions	135.7*189.1*82.7mm
Weight	236g
Color	Black
Certifications	CE, FCC ID: 2A2UNMG1100

Digital Proportional Radio Control System

**FS-MG11-BT-BS&  
FS-R11P-BT-BS**

### Certifications

#### FCC Compliance Statement

This device complies with Part 15 of the FCC Rules. Operation is subject to the following two conditions: (1) this device may not cause harmful interference, and (2) this device must accept any interference received, including interference that may cause undesired operation.

Warning: changes or modifications not expressly approved by the party responsible for compliance could void the user's authority to operate the equipment.

This equipment has been tested and found to comply with the limits for a Class B digital device, pursuant to Part 15 of the FCC Rules. These limits are designed to provide reasonable protection against harmful interference in a residential installation. This equipment generates, uses and can radiate radio frequency energy and, if not installed and used in accordance with the instructions, may cause harmful interference to radio communications. However, there is no guarantee that interference will not occur in a particular installation.

If this equipment does cause harmful interference to radio or television reception, which can be determined by turning the equipment off and on, the user is encouraged to try to correct the interference by one or more of the following measures:

- Reorient or relocate the receiving antenna.
- Increase the separation between the equipment and receiver.
- Connect the equipment into an outlet on a circuit different from that to which the receiver is connected.
- Consult the dealer or an experienced radio/TV technician for help.

#### EU DoC Declaration

Hereby, [Flysky Technology Co., Ltd.] declares that the Radio Equipment [ FS-MG11-BT-BS&FS-R11P-BT-BS] is in compliance with RED 2014/53/EU. The full text of the EU DoC is available at the following internet address: [www.flyskytech.com/info\\_detail/10.html](http://www.flyskytech.com/info_detail/10.html)

#### RF Exposure Compliance

The distance between user and products should be no less than 20cm.

#### Environmentally friendly disposal

Old electrical appliances must not be disposed of together with the residual waste, but have to be disposed of separately. The disposal at the communal collecting point via private persons is for free. The owner of old appliances is responsible to bring the appliances to these collecting points or to similar collection points. With this little personal effort, you contribute to recycle valuable raw materials and the treatment of toxic substances.



FCC ID: 2A2UNMG1100

Manufacturer: ShenZhen FLYSKY Technology Co., Ltd.

Address: 16F, Huafeng Building, No. 6006 Shennan Road, Futian District, Shenzhen, Guangdong, China

本说明书中的图片和插图仅供参考，可能与实际产品外观有所不同。产品设计和规格可能会有所更改，恕不另行通知。

Figures and illustrations in this manual are provided for reference only and may differ from actual product appearance. Product design and specifications may be changed without notice.