

Smart Security Kit H500

Instruction Manual

Contents

| | |
|--|-----------|
| 1. Description of Terms | 3 |
| 2. Introduction | 6 |
| 3. Characteristics of Safety Panel | 7 |
| 4. Introduction of Appearance and Panel | 8 |
| 5. Functions Introduction of Security Panel | 10 |
| 5.1. Menu Introduction | 10 |
| 6. Installation and Usage of Accessories | 12 |
| 6.1. Installation Diagram of Infrared Motion Detector | 12 |
| 6.2. The Steps of Remote Control Battery Replacement | 12 |
| 6.2.1. Introduction of Parts | 12 |
| 6.2.2. Battery Replacement | 13 |
| 6.3. Installation Diagram of Door Sensor | 13 |
| 6.4. Installation and Disassembling Diagram of Doorbell | 15 |
| 7. Specifications of The Smart Security Panel and Accessory | 17 |
| 7.1. The Main Specifications of Smart Security Panels | 17 |
| 7.2. The Specifications of Infrared Motion Detector | 17 |
| 7.3. The Specifications of Wireless Remote | 17 |
| 7.4. The Specifications of Door Sensor | 18 |
| 7.5. The Specifications of Doorbell | 18 |
| 8. The Table Abnormal Fault Handling | 19 |
| 9. The Declaration of Hazardous Substances | 21 |
| 10. Warranty Rules | 21 |
| Warranty Card | 22 |

1. Description of Terms

Host: The safety panel is the core of the whole house safety, hereinafter referred to as the host.

Out Arm: The host enters the alarm state after the accessories are triggered when it is in a monitoring state.

Stay Arm: It refers to the mode of arming the host when the user is in the internal protection area of the alarm system. In this protection mode, all peripheral protection areas in the system (such as outdoor perimeter probes and window door sensors) are in a protection state, but internal protection areas in the system (such as indoor infrared probes) would not be auto-arm. The insiders can move automatically in this area without generating an alarm.

Disarm: It is only trigger the emergency key or 24-hour defense zone device to enter the alarm state after withdrawal when the host releasing the monitoring state.

Remote control: The user can control the mode of out arm mode, stay arm, disarm and alarm by remote when the remote when the remote control and the host are paired successfully.

Detector: The user can install detector at the special area after the detector has paired with the host successfully. And the detector will immediately send an alarm to the host for processing when the detector is set off. The common detectors include door sensor, infrared detector, smoke detector, gas detector, etc.

Wireless siren: After finishing pairing, after the host triggers the alarm, it can trigger the wireless alarm, and the alarm volume can be increased to the maximum.

Arm delay: The host must delay for a period of time before entering the outgoing arming state when the user operates it to enter the outgoing arming state. So that the user can evacuate the monitoring area in time.

Alarm delay: It would be delayed for a period of time when the host receives the alarm from the detector. During the alarm delay, the alarm can be revoked using the user password.

Siren time: It refers to The time for the host alarm to sound, after which the alarm would stop sounding.

User Password: Host withdrawal, accessory setting, security setting can only be operated after user password verification. The user password defaults to 1234, and the user can customize the user password.

System password: Device restart and recovery can only be operated after system password verification. The default system password is 9876, and users can customize the system password.

Scramble PIN code: The user can be entered 5-8-digit Scramble PIN code. It can be recognized as correct password only if it contains 4 consecutive correct passwords.

Local alarm: The host horn and wired alarm will be sounded when the host alarms.

Siren alarm: The host sends the wireless code to control the wireless siren to give an alarm when the host alarms.

Siren beep: The host sends a wireless code to control the wireless alarm to sound briefly for prompting when the host state is switched.

Delay beep: The warning voice would be issued to evacuate the protection area as soon as possible to avoid false triggering or cancellation of the alarm when the host is in a delayed protection or delayed alarm state.

Door/Window warning: The host will advice the user that the status of door and window when the user go outside.

Voice tone: There is the corresponding voice prompt when the user operating the host.

Key beep: There would be a corresponding voice prompt to improving the touch experience when operating the keys of the host.

Doorbell volume: The host would sound the doorbell voice prompt when the doorbell defense area is triggered.

Tamper switch: The host will sound an alarm when it is disassembled by external force.

Doorbell: You can click into menu option to choose the Accessories option to enter the password to add doorbell accessories if you need to use the Doorbell. It will note "Ding Dong" anytime while be triggered.

Alarm type: The user sets the corresponding alarm type according to the detector type and usage scenario. This is convenient for the user to manage and distinguish the corresponding device type after triggering the alarm.

The type of alarm is as follow: System alarm, Main-door alarm, Living room alarm, SOS alarm, Bed room alarm, Window alarm, Balcony alarm, Environment Alarm, Fire Alarm, Gas Alarm, carbon monoxide alarm and water leakage alarm.

Zone number: This function is use for making out the zone of detectors. The user can confirm the location of alarm from this when detectors were triggered by someone.

Detector mode: 7 options

- (1) **All Arm is effective:** The trigger detector would give an alarm if someone enters the arming range when the host in the modes of Out Arm or Stay Arm. It is recommended that the outdoor detector sets this mode.
- (2) **Out Arm is effective:** When the host is in the state of protection when at home, the detector in this mode is triggered and would not alarm. It is recommended that the indoor detector set this mode.
- (3) **Effective for 24 hours:** The detector sets in this mode would give an alarm at any time regardless of the state of the host. It is recommended to set this mode for detectors requiring timely

treatment such as gas, emergency key and smoke.

- (4) **Disabled:** Setting the detector in this mode means that it is discontinued and the host would not respond to the alarm request of the detector in this mode.
- (5) **No alarm sound for 24 hours:** This type of accessories would give an alarm when giving an alarm, but it would not make a sound.
- (6) **All Arm is effective (without delay):** The user can ignore the alarm delay setting when this type of accessories conform the alarm conditions.
- (7) **Out Arm is effective (without delay):** The user can ignore the alarm delay setting when this type of accessories conform the alarm conditions.

2. Introduction

Welcome to use the Smart Security kits. Your safety is the direction of our efforts.

The host is embedded with a high-performance and low-power intelligent microprocessor, adopted the 4.3-inch IPS color screen. The user can use The Touch Buttons to control host operation. It has wireless function that can wireless connect the infrared, door sensor, smoke, gas, detector, emergency key, wireless remote and other accessories for matching. After triggering the accessory, the host can display the alarm status and the on-site alarm prompt in real time.

3. Characteristics of Safety Panel

Embedding the ARM9 chip. The main frequency is up to 600MHz. The performance is more powerful and the operation is more faster.

- (1) The 4.3-inch IPS color display screen has a wider visual angle and better visual experience.
- (2) Capacities touch screen is used and the user experience will be more comfortable.
- (3) New Sense UI interactive interface.
- (4) It built-in RTC clock chip. The chip make sure of keeping the time display on product when the power is down in the home.
- (5) It can be connected to a total of 200 remote controls, sensors and detectors. The maximum of six doorbells can be connected.
- (6) It can support 7 defense modes. And it also can set and edit the security attributes of each detector separately.
- (7) It supports to reminder such as power failure of external main power supply, battery shortage, anti-pry alarm, etc.
- (8) It supports the prompt that doors and windows are not closed.
- (9) It supports the alarm pop-up window function.
- (10) It supports up to 100 sets of security records.
- (11) It supports to connect wired siren and wireless siren. And it can enhance alarm volume and achieve better warning effect.
- (12) It supports the Scramble PIN code function.
- (13) It supports multi-language.

4. Introduction of Appearance and Panel

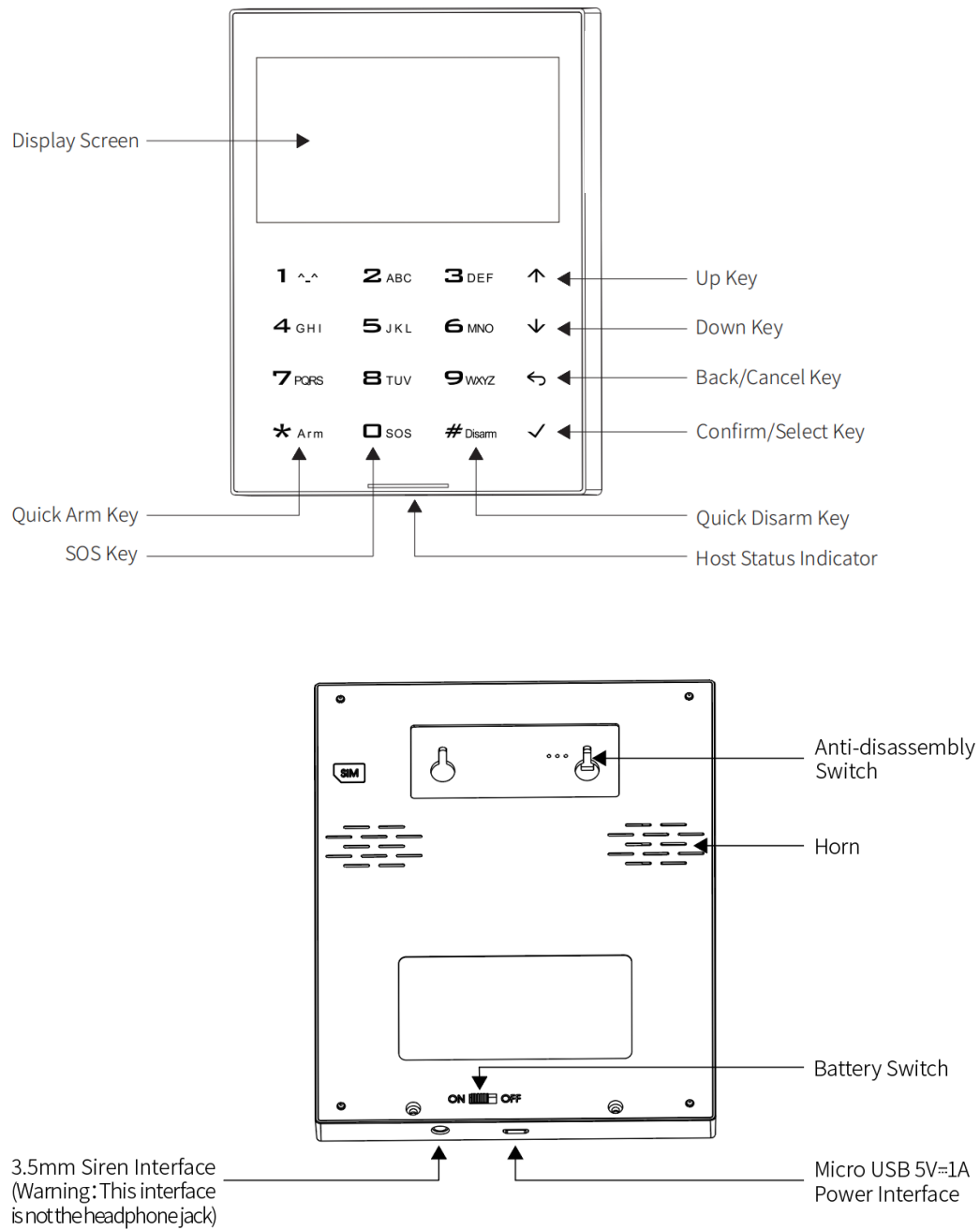

Indicator:

| Color \ Action | Light steady | Color \ Action | Flashing |
|----------------|--------------|---------------------|-------------|
| | | | |
| Red | Alarm mode | Yellow/Green Change | Delay Arm |
| Yellow | Arm mode | Red/Green Change | Delay Alarm |
| Green | Disarm mode | | |

Important

- (1) The host should be installed in the center area of each detector as much as possible to ensure the best wireless communication between the host and the detector.
- (2) As the host and the detector adopt wireless communication, the installation position should be as far away from high-frequency interference household appliances or hard-to-penetrate heavy fire doors as possible.

5. Functions Introduction of Security Panel

5.1. Menu Introduction

| | | | | |
|------|-------------|------------|---------------------|--|
| Menu | Accessories | Detector | | Deleting, view and modify detector alarm type and mode for all detector. |
| | | Remote | | Adding, view and delete all remote controllers. |
| | | Doorbell | | Adding, view and delete all doorbell. |
| | | Siren pair | | Realize wireless alarm number matching function. |
| | safety | Delay | Arm delay(sec) | Set the protection delay value |
| | | | | Unit: seconds; Scope: 0 ~ 180; Default: 40 seconds |
| | | | Alarm delay(sec) | Set alarm delay |
| | | | | Unit: seconds; Scope: 0 ~ 180; Default: 30 seconds |
| | | Siren time | | Set the alarm sounding time |
| | | | | Unit: seconds; Scope: 0 ~ 1800; Default: 180 seconds |
| | | Password | User password edit | Change the user password and forget the password. Please contact the sales channel. |
| | | | | Scope: 0000 ~ 9999; Default: 1234 |
| | | | Sys password edit | Modify the management password. It is not recommended to be the same as the user password. |
| | | | | Scope: 0000 ~ 9999; Default: 9876 |
| | | | Siren alarm | Setting the alarm sound of the siren. |
| | | | | Scope: off or on; Default: Off |
| | | | Local alarm | Setting the alarm sound of the host. |
| | | | | Scope: off or on; Default: On |
| | | | Siren beep | Setting siren beep |
| | | | | Scope: off or on; Default: Off |
| | | | Delay beep | Setting the delay beep. |
| | | | | Scope: off or on; Default: On |
| | | | Door/Window warning | Setting the door/Window warning. Need door sensor accessories support. |
| | | | | Scope: off or on; Default: Off |
| | Settings | Time | Setting time | Set the year, month, day, hour, minute and second of host. |
| | | | | |
| | Audio | Voice tone | | Set whether the voice prompt tone is turned on or not |
| | | | | |

| | | | | |
|-------|--|--|---|--|
| | | | | Scope: off or on; Default: On |
| | | | Key beep | Set whether the key sound effect is turned on or not |
| | | | | Scope: off or on; Default: On |
| | | | Doorbell Vol | Set the prompt volume of the host doorbell |
| | | | | Scope: 0 ~ 10; 0 indicates that the doorbell is muted; Default: 8 |
| | | | System vol | Set the prompt volume of the host system |
| | | | | Scope: 0 ~ 10; 0 indicates that the system prompts mute; Default: 7 |
| | | Display | | Set screen timeout |
| | | | | Unit: seconds; Scope: 0 constant bright, 10 ~ 180; Default: 60 seconds |
| | | Language | There are 8 languages you can choose as follow | 简体中文、English、Deutsche、Русский、Français、Português、Español、Italiano |
| | | Recover | Recover | Realize the function of recovering the factory setting of the host |
| | | | Restart | Realize the function of restarting the host |
| Clean | | The device can enter this mode when it needs to be cleaned, and the button will fail for one minute to prevent false triggering. | | |
| | | Help | The QR code of the User manual : Scan the QR code can check the Chinese Usage. The QR code of the User manual : Scan the QR code can check the English Usage. | |
| | | | About: Display host model version, SN information,. | |

6. Installation and Usage of Accessories

6.1. Installation Diagram of Infrared Motion Detector

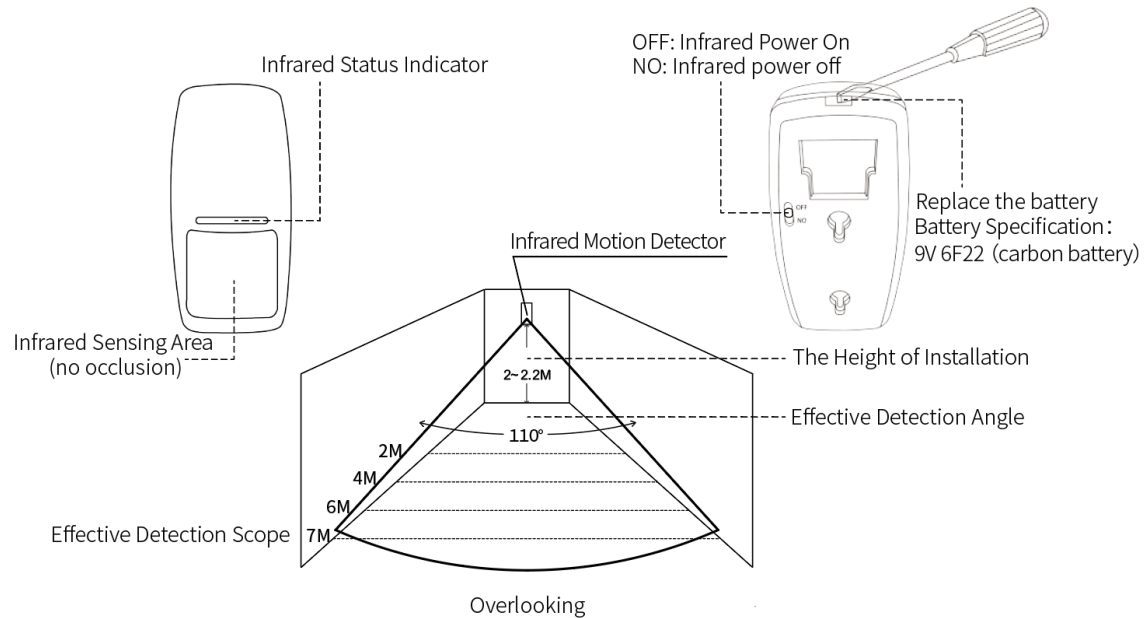

Important:

- (1) The installation height from the ground is 2.0 ~ 2.2 meters. The detection distance is ≤ 7 m and the launching distance is ≤ 150 m (without obstacles). Please ask for TEST distance before installation, because the obstacle has an effect on the distance to sense.
- (2) The infrared detector should be installed at a certain angle with the indoor pedestrian line (the detection effect is the best at 90° with the pedestrian direction).
- (3) It is not suitable to directly face glass doors and windows.
- (4) It is not suitable to face large objects that are easy to swing.
- (5) It should not be directly facing the cold and hot vents or cold and hot sources.
- (6) As far as possible, there are no screens, furniture, large bonsai or other partitions in the detection scope.
- (7) It is not advisable to install multiple detectors in the same detection area to avoid interference caused by simultaneous triggering.

6.2. The Steps of Remote Control Battery Replacement

6.2.1. Introduction of Parts

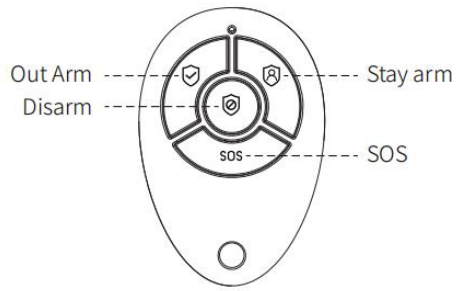

6.2.2. Battery Replacement

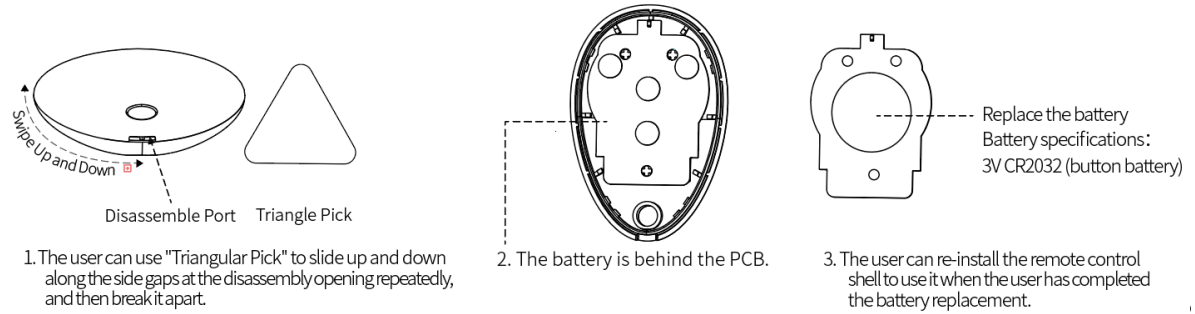

6.3. Installation Diagram of Door Sensor

The door sensor is installed on the movable door or window. First, wipe the corresponding position of the door, take out the wireless door sensor, and stick double-sided adhesive tape on the bottom.

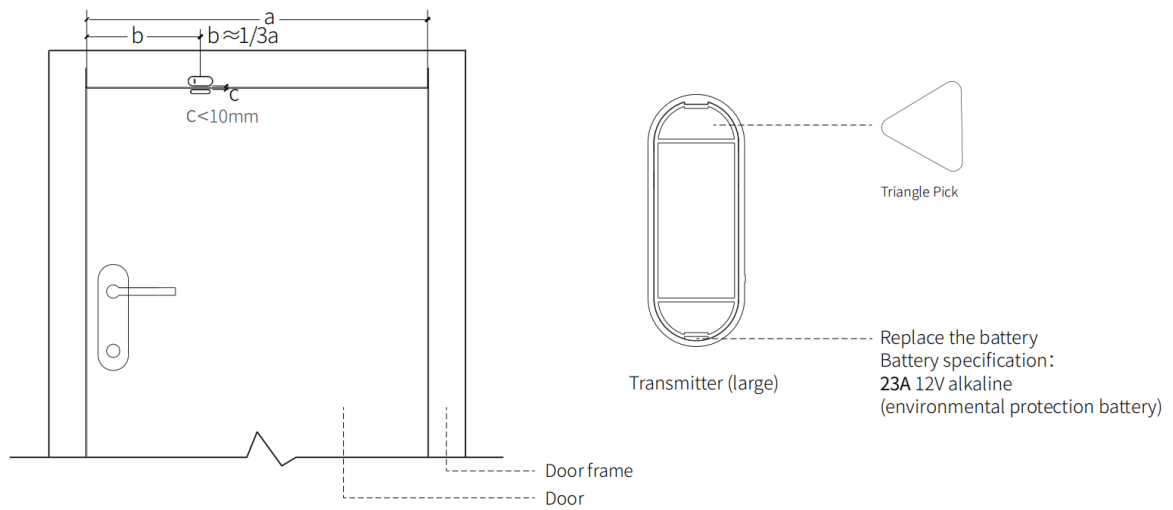

Important

- (1) The emission distance of the door sensor is less than or equal to 100M (no obstacles). Please ask for TEST distance before installation. Because the obstacle has an effect on the distance to sense.
- (2) The door sensor (transmitter (large)) and the door sensor (magnet (small)) shall be installed separately, i.e. the transmitter shall be installed on a fixed door frame and the magnet shall be installed on the movable door.
- (3) The magnet is facing the triangular arrow face of the transmitter, and the distance between them is less than 10mm.
- (4) Open the door after the door sensor is installed. The indicator light light keeps for 2 second when the door is opened, indicating that the installation is complete.
- (5) The door sensor indicator light keeps for 2 second to indicate an alarm. The indicator light keeps on in dicating that the battery is low.
- (6) The distance should be reduced as much as possible if the door sensor is installed on the iron gate.
- (7) It is not advisable to install multiple detectors in the same detection area to avoid interference caused by simultaneous triggering.

6.4. Installation and Disassembling Diagram of Doorbell

Characteristics:

- (1) A variety of simple installation methods: support foam glue and screw fixing.
- (2) No standby power consumption.
- (3) DC12V power supply is adopted, with higher transmission power and longer wireless distance.

Installation step:

1. Firstly, the user need to hold the lower cover with your left hand, fasten the bottom of the upper cover with the bottom of the lower cover with your right hand. Secondly, The user need to press on the top of the lower cover along the top of the upper cover, as shown on the right picture:

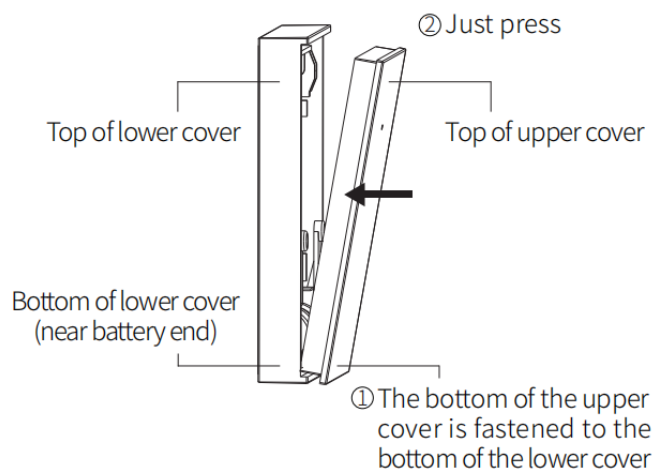

2. Installation is complete

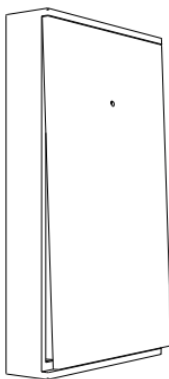

Disassembling Step:

1. Holding the lower cover tightly with your left hand, drag the upper cover outward with your right hand, and then open it upward along the bottom of the upper cover, as shown on the right figure:

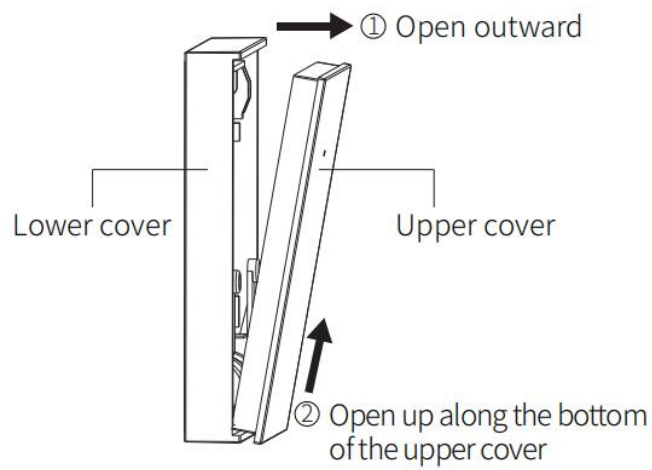

2. Disassembling is complete

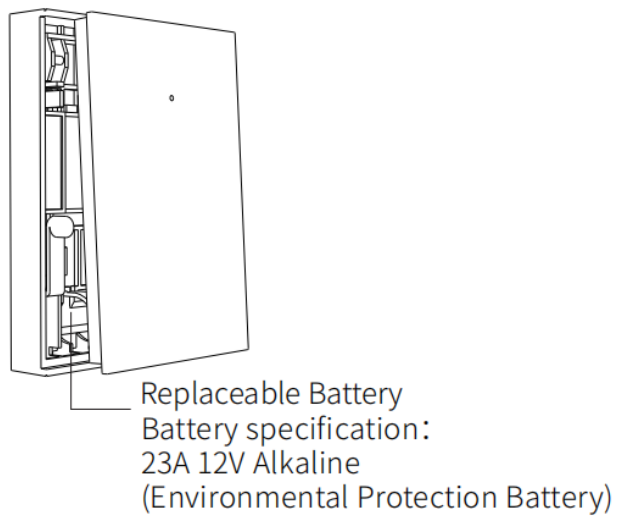

7. Specifications of The Smart Security Panel and Accessory

7.1. The Main Specifications of Smart Security Panels

| | |
|--|--|
| Input power: Input power: 5V 1.0A, Micro USB | Working temperature: -10 ~ 55℃ |
| Battery inside: 3.7 V 1000mAh lithium battery | Relative humidity: < 95% (no condensation) |
| Operating power consumption: < 1.5 W | Product size:150*120*12mm |
| Wireless parameters:433MHz frequency band, eV1527 coding | |

7.2. The Specifications of Infrared Motion Detector

| | |
|---------------------------------------|---|
| Input voltage: 6F22 9V carbon battery | Detection scope: 8M/110 ° |
| Quiescent current:≤40 uA | Wireless parameter: 433MHz, support coding format eV1527 Support frequency band |
| Alarm current:≤45 mA | Operating environment:-10℃ ~ + 50℃ |
| Product size:110*52mm | Relative humidity: < 95% (no condensation) |

7.3. The Specifications of Wireless Remote

| | |
|------------------------------------|---|
| Input voltage: 3V battery (CR2032) | Wireless parameter: 433MHz, support coding format eV1527 Support frequency band |
| Quiescent current: < 1 uA | Operating environment:-10℃ ~ + 50℃ |
| Working current:≤10 mA | Relative humidity: < 95%(no condensation) |
| Product size:60*40mm | |

7.4. The Specifications of Door Sensor

| | |
|---|---|
| Input voltage: 23A 12V | Wireless parameter: 433MHz, support coding format eV1527 Support frequency band |
| Quiescent current: $\leq 2 \mu\text{A}$ | Operating temperature: $-10^{\circ}\text{C} \sim +50^{\circ}\text{C}$ |
| Alarm current: $\leq 20 \text{ mA}$ | Relative humidity: $< 95\%$ (no condensation) |
| Product size: Transmitter (large) 65 * 24 mm magnet (small) 52 * 11.4mm | |

7.5. The Specifications of Doorbell

| | |
|---|---|
| Input voltage: 23A 12V | Wireless parameter: 433MHz, support coding format eV1527 Support frequency band |
| Standby current: Normally 0mA power-off | Operating temperature: $-10^{\circ}\text{C} \sim +50^{\circ}\text{C}$ |
| Operating current: $\leq 40 \text{ mA}$ | Relative humidity: $< 95\%$ (no condensation) |
| Product size: 48 * 76 * 11 mm | |

8. The Table Abnormal Fault Handling

| Failure | The Reason | The Solution |
|--|---|---|
| Wireless Remote malfunction | <ol style="list-style-type: none"> 1. The battery power is insufficient. 2. The shrapnel of the battery compartment. is in poor contact or rusted. 3. The format is not paired with the host. 4. Mismatch with host wireless parameters. | <ol style="list-style-type: none"> 5. 1、Replacing the battery of the same model. 6. 2、Cleaning the rust and dirt of shrapnel. 7. 3、Re-pair with the host. 8. 4、Purchasing accessories of the same type with technical parameters. 9. |
| Door sensor failure | <ol style="list-style-type: none"> 1. The battery power is insufficient. 2. The shrapnel of the battery compartment. is in poor contact or rusted. 3. The code is not paired with the host. 4. Mismatch with host wireless parameters. 5. The door sensor is too far away from the magnet. | <ol style="list-style-type: none"> 1. Replacing the battery of the same model. 2. Cleaning the rust and dirt of shrapnel. 3. Re-pair with the host. 4. Purchasing accessories of the same type with technical parameters. 5. 6. Installing door sensors and magnets close to each other. |
| Infrared Motion Detector failure | <ol style="list-style-type: none"> 1. The battery power is insufficient. 2. The shrapnel of the battery compartment. is in poor contact or rusted. 3. The code is not paired with the host. 4. Mismatching with host wireless parameters. 5. Infrared installation location is unreasonable. | <ol style="list-style-type: none"> 1. Replacing the battery of the same model. 2. Cleaning the rust and dirt of shrapnel. 3. Repairing with the host. 4. Purchasing accessories of the same type with technical parameters 5. Re-commission the equipment and adjust the infrared installation position. |
| Host does not alarm | <ol style="list-style-type: none"> 1. The host is not in the protection state. 2. Improper installation of components and too far away. 3. Accessory codes do not match. | <ol style="list-style-type: none"> 1. Carrying out protection operation on the host. 2. Adjusting the position of the components. 3. Re-code. |
| The host receives remote control, the door sensor, and the infrared distance becomes shorter | <ol style="list-style-type: none"> 1. The main power is disconnected and the standby power is insufficient. 2. There is signal interference from the same type of product around the product. 3. It occurs the trouble when host receiving module. | <ol style="list-style-type: none"> 1. Checking the power supply and restore the power supply. 2. Checking the interference source and dismantle it. 3. Communicating with customer service for repair. |
| Door and window switch failure | <ol style="list-style-type: none"> 1. The door and window switch signals are opposite. | <ol style="list-style-type: none"> 1. Need to trigger the door open signal. 2. Accessories for non-certified equipment. |

| | | |
|--|--|--|
| | <ul style="list-style-type: none"> 2. Door and window switch signals cannot be used. 3. Setting the type of alarm incorrectly. | <ul style="list-style-type: none"> 3. Setting the type of alarm as door alarm and window alarm. |
|--|--|--|

9. The Declaration of Hazardous Substances

| Component Name | Harmful substance | | | | | |
|----------------|-------------------|--------------|--------------|------------------------------|--------------------------------|--------------------------------------|
| | Lead (Pb) | Mercury (Hg) | Cadmium (Cd) | Hexavalent chromium (Cr(VI)) | Polybrominated biphenyls (PBB) | Polybrominated diphenylethers (PBDE) |
| Metal parts | 0 | 0 | 0 | 0 | 0 | 0 |
| Plastic parts | 0 | 0 | 0 | 0 | 0 | 0 |

10. Warranty Rules

- (1) Please contact our after-sales service for any failure caused by the product itself during the warranty period.
- (2) The goods are guaranteed for one year from the date of sale, and the warranty service is only valid under normal use.
- (3) Damage caused by the use environment not meeting the requirements of this product is not covered by the warranty.
- (4) Product damage caused by man-made and force majeure is not covered by the warranty



Warranty Card

Thank you very much for using our products. This card is a product warranty certificate.

Please keep it properly. Thanks again.

Product Name:

Product Serial Number:

Contact:

Mailing Address:

Tel:

Purchase Date:

User Name:

Distributor:

Product Name and Specification:

Zip Code:

Warning

This device complies with Part 15 of the FCC Rules. Operation is subject to the following two conditions: (1) this device may not cause harmful interference, and (2) this device must accept any interference received, including interference that may cause undesired operation

NOTE: This equipment has been tested and found to comply with the limits for a Class B digital device, pursuant to Part 15 of the FCC Rules. These limits are designed to provide reasonable protection against harmful interference in a residential installation. This equipment generates, uses and can radiate radio frequency energy and, if not installed and used in accordance with the instructions, may cause harmful interference to radio communications. However, there is no guarantee that

interference will not occur in a particular installation.

If this equipment does cause harmful interference to radio or television reception, which can be determined by turning the equipment off and on, the user is encouraged to try to correct the interference by one or more of the following measures:

- Reorient or relocate the receiving antenna.
- Increase the separation between the equipment and receiver.
- Connect the equipment into an outlet on a circuit different from that to which the receiver is connected.
- Consult the dealer or an experienced radio/TV technician for help.

Warning: changes or modifications not expressly approved by the party responsible for compliance could void the user's authority to operate the equipment

The device has been evaluated to meet general RF exposure requirements, the device can be used in portable exposure conditions without restriction