

# *SecCube 3 Alarm Kit*

## *User Manual*

# CONTENT

I.	Introduction.....	1
1.1	What's in the Package.....	1
1.2	Home Installation Diagram.....	3
II.	Learn to use the Base Station.....	4
III.	Set up the Alarm Devices.....	5
3.1	Entry Sensor.....	5
3.2	Controller.....	7
3.3	RFID.....	8
3.4	Other Accessories.....	8
IV.	Learn to Use the System.....	9
V.	Troubleshooting.....	10
VI.	Hazardous Substance Declaration.....	10
VII.	Warranty Rules.....	11
VIII.	FCC Declares.....	11

# 1. Introduction

## 1.1 What's in the Package



The central hub of the alarm system. It connects all the devices, so you can stay in control of your home from anywhere.

### Entry Sensor



Alerts you when a door or window is opened.

### Controller



Allows you to remotely control the alarm system to quickly enter Home, Away, Disarm, and SOS modes.



Allows you to quickly arm/disarm the system.

## 1.2 Home Installation Diagram

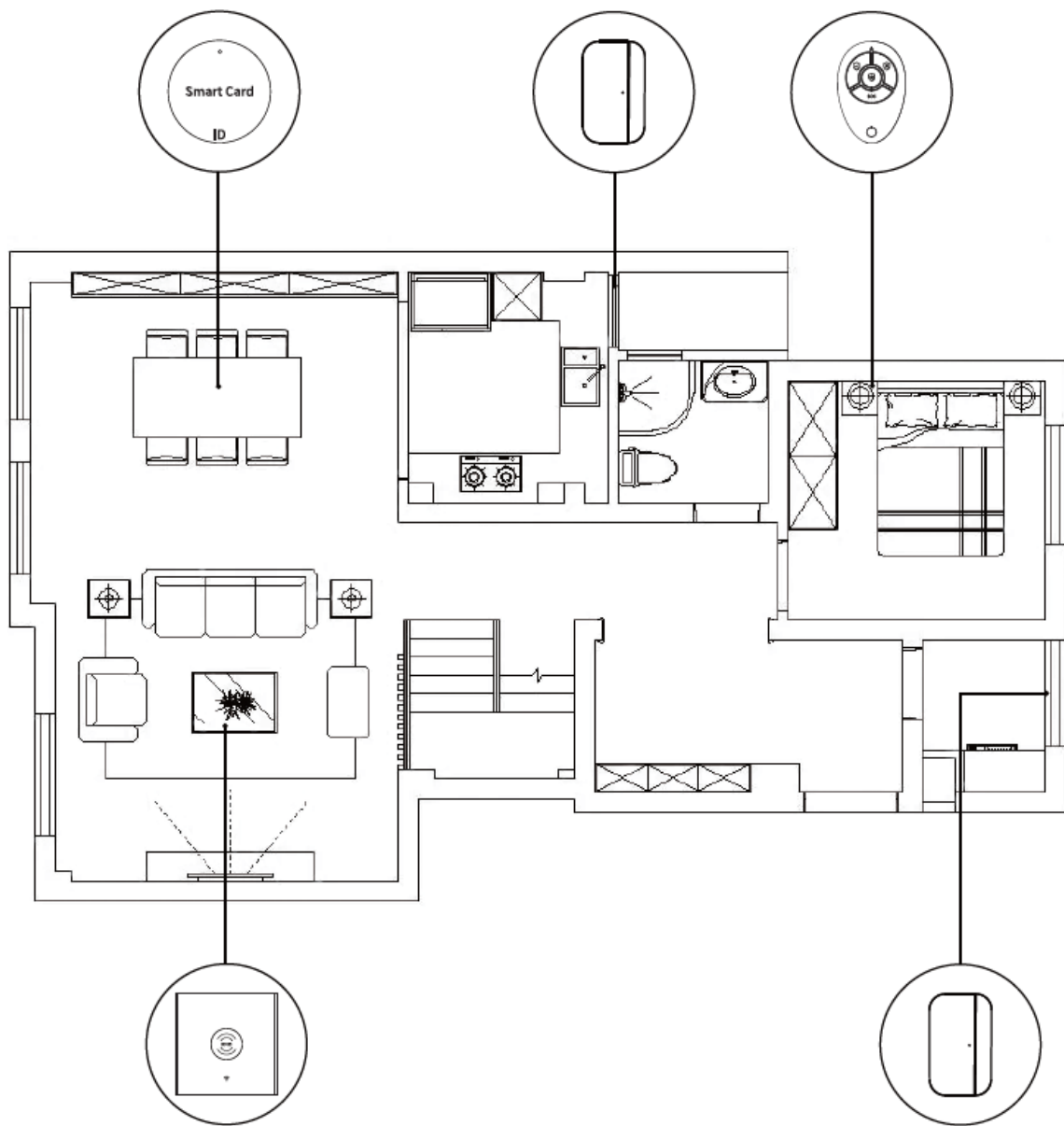

## II. Learn to use the Base Station

*Security button function:*



*Note: When the system enters the Power Saving Mode (Security light off), a short press is required to wake up the device.*

- When the 'Long Press Alarm' is enabled in the settings, and the system is in a non-alarm state, long press 2s to trigger an alarm.
- When the 'Long Press Silence' is enabled in the settings, and the system is alarming,

Color	Panel status	Flashing	Panel status
Red	Alarming	Yellow/Green	Delay Arming
Yellow	Armed	Red/Green	Delay Alarming
Green	Disarmed		

*Red light flashes every 10 seconds: Base station low battery*

*Yellow/Red light flashing: Door/window not closed during delay arming*

*Security light off: Device enters power saving mode*

### III. Set up the Alarm Devices

#### 3.1 Entry Sensor

##### (1) Installation

The entry sensor should be installed on the door or window (see image).

- A. First, clean the area on the door or window and apply double-sided tape to the bottom.
- B. The door sensor transmitter (large) and the door sensor magnet (small) should be installed separately. The **triangle marks** on the transmitter and the magnet should be facing each other, and the distance between the two is less than 0.6".
- C. When the door or window is opened after installation, the indicator light will be on for 2 seconds to indicate that the installation is complete.

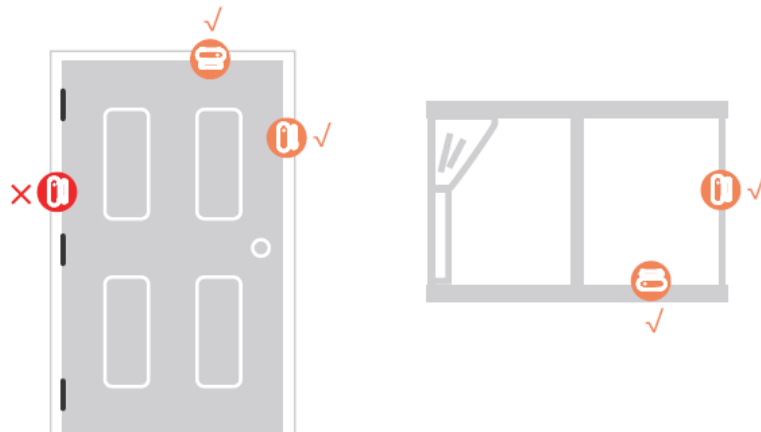

## (2) Appearance Design

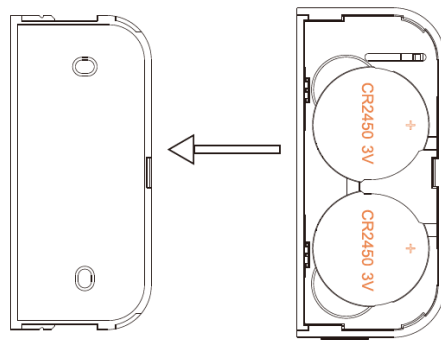
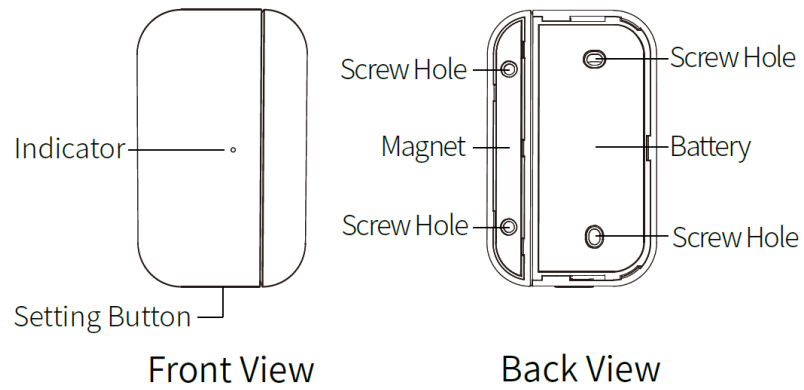

Slide in the direction of the arrow to remove the back cover

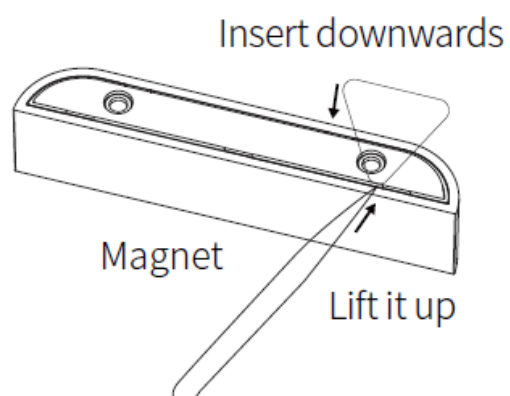



## 3.2 Controller

### (1) Appearance Introduction

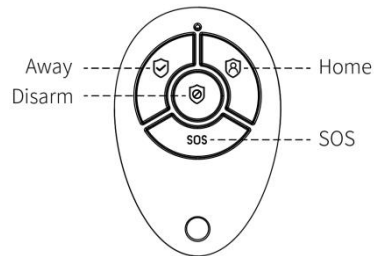

Press 1.5s to trigger

SOS

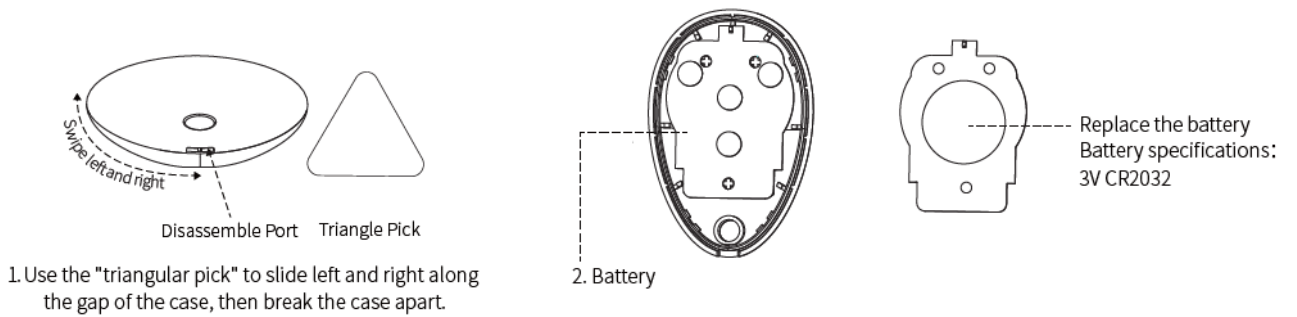

### 3.3 RFID

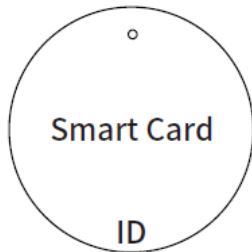

RFID protocol : 125KHz, 4100/4200

Sensing distance:  $\leq 3\text{cm}$

Product size :  $35 \times 35 \times 4\text{mm}$

RFID Card: Up to 10 cards can be added

### 3.4 Other Accessories

**Urgent sensor:** Emergency detectors such as gas detectors, smoke detectors, or SOS buttons, please add them here. Once triggered, the base station will alarm, no matter what state the device is in.

**Secret sensor:** Once triggered, the base station will not alarm,

**General sensor:** Other sensors or detectors, please add them here.

**Note:**

- 1) The security system supports the accessories with 433MHz, ev1527.
- 2) For the Entry sensors from another brand, please add it to "General"
- 3) Support up to 68 Sensors, 6 Controllers, 6 Doorbells, 6 Keypads, 10 RFID Cards.

## IV. Learn to Use the System

### 5.1 Alarm Modes

#### A. Base station Alarm Modes

- a. **Away:** The base station is in a monitoring state, when the accessories are triggered, the base station will alarm.
- b. **Home:** When the user is at home, in this mode, some areas can be monitored and alarms.
- c. **Disarm:** The base station cancels the monitoring state, and only the SOS button or the accessories set to "Always" mode can trigger the alarm.

#### B. Accessories Modes :

- a. **Away/Home :** When the base station is in the "Away" or "Home" state, the panel will alarm after the sensor is triggered. It is recommended that the outdoor sensor can be set to this mode.
- b. **Away :** When the base station is in the "Away" state, the panel will alarm after the sensor is triggered. It is recommended that the outdoor detector can be set to this mode.
- c. **Always :** Regardless of the state of the base station, any time the sensor is triggered, the panel will alarm. It is recommended to set this mode for gas leaks, smoke detectors, etc.
- d. **Disabled :** The base station will not respond to the alarm request of the sensor set in this mode.

#### Note:

You can choose which sensors are armed in Home and Away mode, or both, or always active.

For example, if you want to avoid triggering the alarm when you are at home, you can set the specific sensor in Away mode. Then when you set the panel in "Home" state, the alarm will not be triggered, only in "Away" state, the alarm will be triggered.

## V. Troubleshooting

Q1. The base station is connected to the charger, but it won't charge

A: Please use the original Type-C charging cable and plug. If you need to test whether the charging cable is working, there will be a prompt sound after the connection is successful.

Q2. Does the power switch on the device shut down the system at any time?

A: To ensure safety, the device cannot be turned off in the armed state.

Q3. Why does it still show a low battery after changing the battery of the sensor?

A: Battery status needs to be manually refreshed. After replacing the battery, please click 'Accessory Low Battery Reset' on the settings page to refresh the battery status.

Q8. What if I lose my controller/RFID card?

A: To ensure safety, please delete the lost controller/RFID in the accessories in time, so that the lost remote control/RFID cannot be used.

Any other problems with the device, please contact customer service.

## VI. Hazardous Substance Declaration

Component Name	Harmful substance					
	Lead (Pb)	Mercury (Hg)	Cadmium (Cd)	Hexavalent chromium	Polybrominated biphenyls	Polybrominated diphenyl
Metal parts	0	0	0	0	0	0
Plastic parts	0	0	0	0	0	0

## **VII. Warranty Rules**

- (1) Please contact our after-sales service for any failure caused by the product itself during the warranty period.*
- (2) The goods are guaranteed for one year from the date of sale, and the warranty service is only valid under normal use.*
- (3) Damage caused by the use environment not meeting the requirements of this product is not covered by the warranty.*
- (4) Product damage caused by man-made and force majeure is not covered by the warranty.*

## **VIII. FCC Declares**

*This device complies with Part 15 of the FCC Rules.*

*Operation is subject to the following two conditions: (1) this device may not cause harmful interference, and (2) this device must accept any interference received, including interference that may cause undesired operation.*

*NOTE: This equipment has been tested and found to comply with the limits for a Class B digital device, under Part 15 of the FCC Rules. These limits are designed to provide reasonable protection against harmful interference in a residential installation. This equipment generates, uses, and can radiate radio frequency energy and, if not installed and used by the instructions, may cause harmful interference to radio communications. However, there is no guarantee that interference will not occur in a particular*

installation. If this equipment does cause harmful interference to radio or television reception, which can be determined by turning the equipment off and on, the user is encouraged to try to correct the interference by one or more of the following measures:

- Reorient or relocate the receiving antenna.
- Increase the separation between the equipment and receiver.
- Connect the equipment to an outlet on a circuit different from that to which the receiver is connected.
- Consult the dealer or an experienced radio/TV technician for help.

Warning: changes or modifications not expressly approved by the party responsible for compliance could void the user's authority to operate the equipment.

To maintain compliance with FCC's RF Exposure guidelines, This equipment should be installed and operated with minimum 20cm distance between the radiator and your body: Use only the supplied antenna.

