

NV17W

WIRELESS

Users Manual



German Engineering. Out of the ordinary.

Before attempting to connect or operate this product, please read the instructions completely.

Precautions

- *Pay utmost attention if you install the NV17W into the driver's compartment.
- *Use only in cars with a 12 Volt negative ground.
- *Before wiring, disconnect the cable from the negative battery terminal to avoid short circuits or electrical shocks. Make the correct connections.
- *Do not damage pipe or wiring when drilling holes.
- *Arrange the wiring so it is not crimped or pinched by a sharp metal edge.
- *Do not install the NV17W in locations which might hinder vehicle operations and do not install in locations with any moisture. Use the installation materials provided with the NV17W.
- *Do not use bolts or nuts in the brake, airbags or other safety relevant systems to make ground connections.
- *Attention! This NV17W is developed for motor vehicle use only.
- *WARNING: DO NOT WATCH MOVIES WHILE DRIVING TO AVOID DANGER!

Environmental Reference

Old electronic devices don't belong into the bin.

If you want to dispose this equipment later, remove all cables and send it back to distributor.

You can dispose this device together with your old car, too. You don't have to remove it in this case.

The packing can be recycled. Dispose the packing in a collecting system planned for it.



Information on the disposal of electrical and electronic equipment and batteries (applicable for countries that have adopted a separate collection system)

If you want to dispose of this product, do not dispose it of with normal household waste. There is a separate collection system for used electronic equipment in accordance with the legislation requiring appropriate treatment, recovery and recycling. Contact your local authority for details when looking for a recycling facility in your area. Proper recycling and disposal helps conserve resources and prevent harmful effects on our health and the environment.

OPERATION INSTRUCTION

When turn on NV17W,you will see the following interface,and then you can work on it.

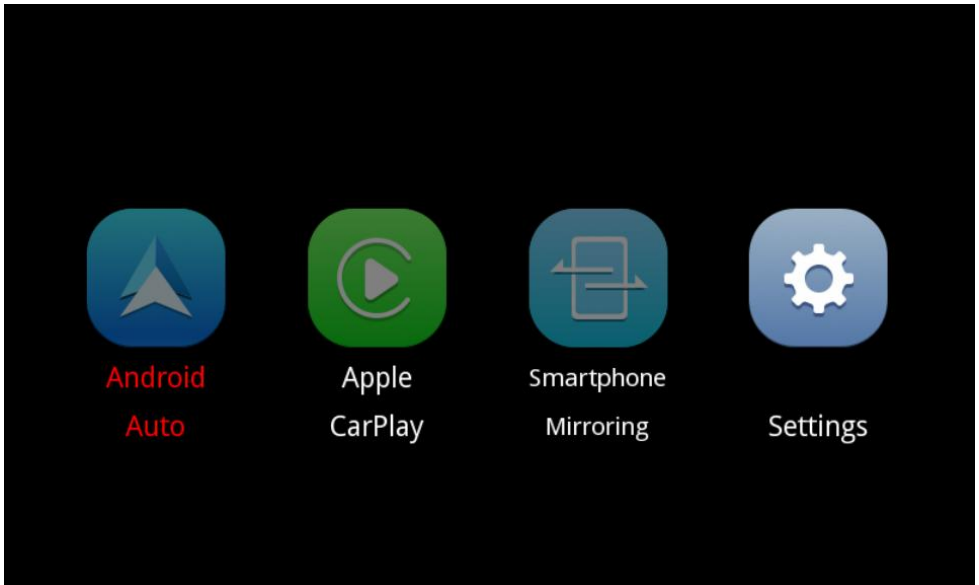

Setup

How to setup wireless Apple Carplay

NOTE! Please disconnect iPhone's bluetooth before using Apple CarPlay.

How to connect your iPhone to Carplay

1) Open your iPhone's Wifi and Bluetooth ,and connect bluetoothand wifi as follow interface:

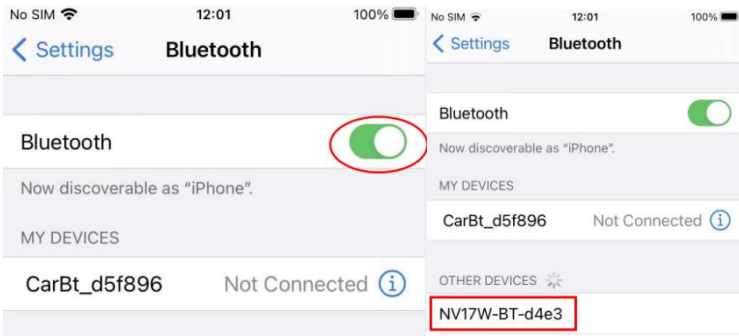

OPERATION INSTRUCTION

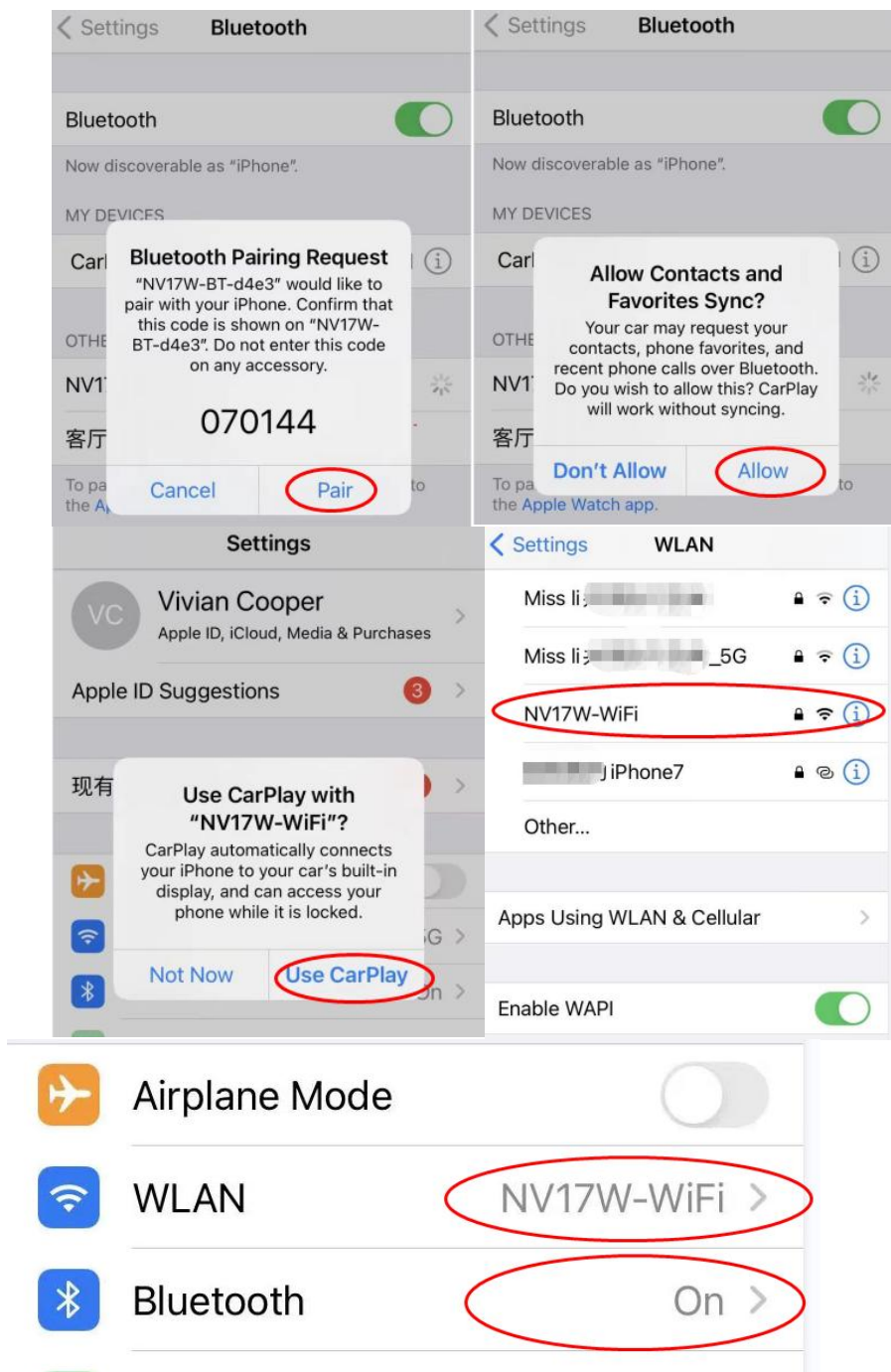

OPERATION INSTRUCTION

When finished, NV17W will go to CarPlay interface automatically as follow interface:

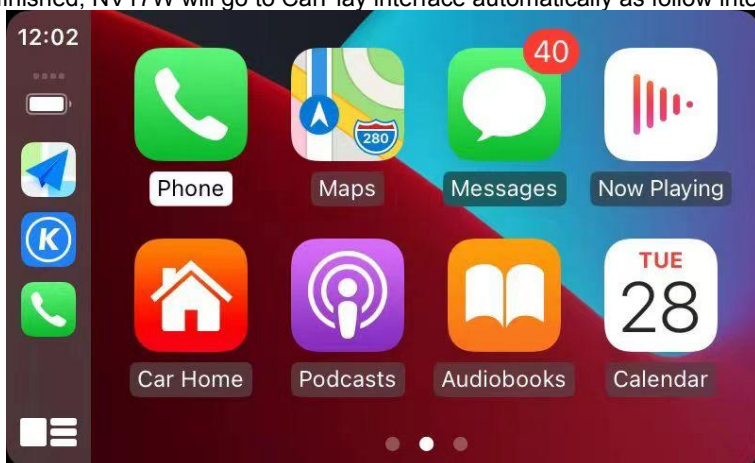

It supports other apps on your iPhone — like your favorite audio, messaging, and voice apps.



It also support the third party Navigation apps,too

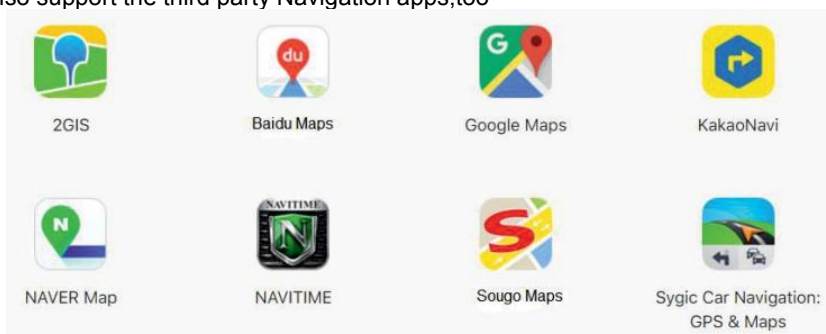

How to disconnect your iPhone from CarPlay

- 1) Click 'Car Home' in the CarPlay interface and exit to the main menu of the system.
- 2) Turn off your wifi button of your iPhone, wireless CarPlay will disconnect, and click again to reconnect.

How to reconnect the CarPlay

- 1) When the bluetooth /Wifi Settings of the mobile end remain unchanged, restart and close the vehicle, and the wireless CarPlay will automatically reconnect.
- 2) If the bluetooth /Wifi Settings on the phone are changed, please delete the device from the device list and reconnect as you did the first time.

How to setup Wireless Android Auto

Remark:Wireless Andriod Auto only support Pixel & Nexus phones(Android 8.0 or above), Samsung phones(Android 9.0 or above).Also the Android Auto app is version 4.7 and up.
NOTE! Please disconnect your Phone's bluetooth before using Andriod Auto.

- 1) Open your Phone's Wifi and Bluetooth ,andgo to your bluetooth&wifi interface ,Click the device that needs to be connected. After the prompt appears on the phone, click PAIR.Wait for 3~5s, the following prompt appears, then click OK, the connection is successful.

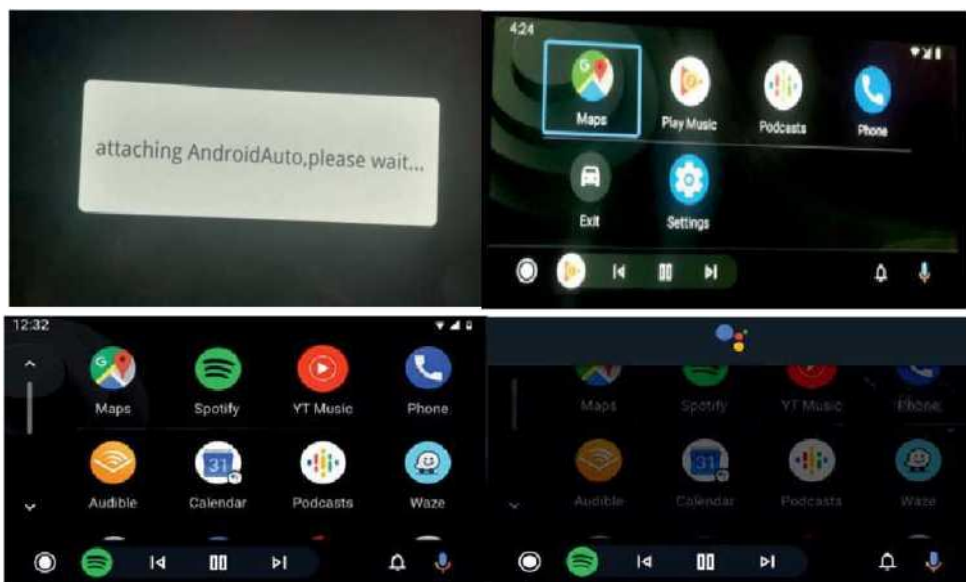

2) Android Auto makes it easy to access your favorite music, media, and messaging apps in the car.

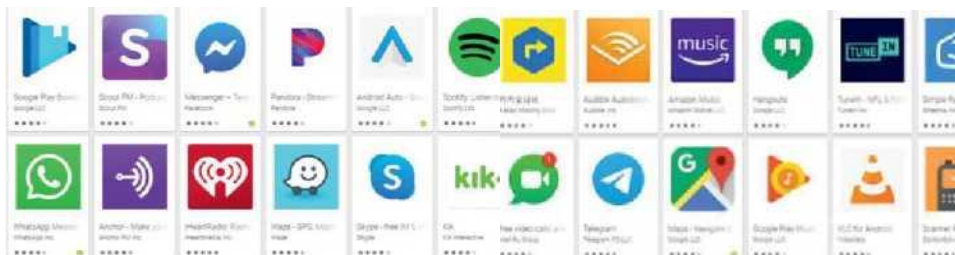

How to setup Smartphone Mirroring

For iPhone,you need to open Airplay and connect the NV17W by wifi ,Enter the Apple device" to find the IOSMirror as follow:



Andriod Phone Mirror instruction

1) Click the “Settings”,option in the main menu and the following prompt appears.

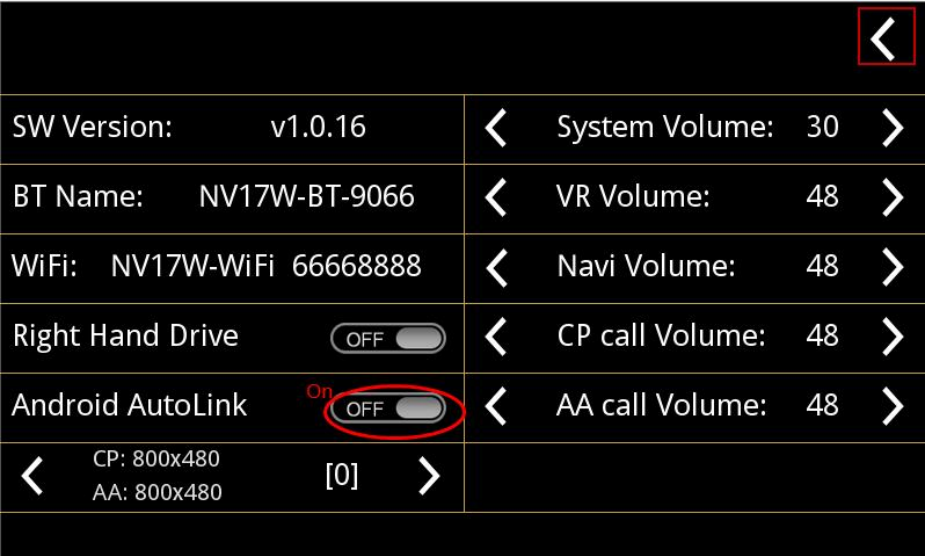

2) Enter the" Android device" interface and select Auto Link, then click the Android APP to scan the QR code to download and install the Auto LinkAPP(download with the third-party browser) as shown in the figure below:



3). After the installation, connect the installed USB cable with the android data cable (original cable) and connect to the phone. Then, according to the prompts on the phone end, click transfer file and allow.

4).After completing the above operation, the mobile phone was successfully projected onto the vehicle screen.

Connect the CarPlay & Android Auto thought USB

- 1) Connect your iPhone to NV17W by original Apple USB cable, you will enter into CarPlay automatically.
- 2) Download android auto on your Android phone; Click the Android auto icon from the main menu; Connect the phone with USB cable and wait for the connection to be successful, as shown in the picture below:

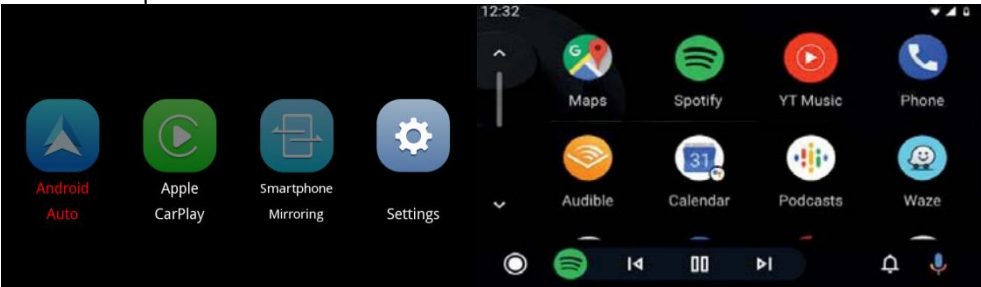

Wiring Diagram



Technical Specifications

Operating voltage	9-28 VDC (typically 12V)
Current consumption	400 mA
Quiescent current	1.4 mA
Transmission frequency	2.4Mhz
Transmission power	>100mW EIRP (sum power)

Remark:**Federal Communications Commission (FCC) Statement**

This device complies with part 15 of the FCC Rules. Operation is subject to the following two

conditions: (1) This device may not cause harmful interference, and (2) this device must accept any interference received, including interference that may cause undesired operation.

Note: This equipment has been tested and found to comply with the limits for a Class B digital device, pursuant to part 15 of the FCC Rules. These limits are designed to provide reasonable protection against harmful interference in a residential installation. This equipment generates, uses and can radiate radio frequency energy and, if not installed and used in accordance with the instructions, may cause harmful interference to radio communications. However, there is no guarantee that interference will not occur in a particular installation. If this equipment does cause harmful interference to radio or television reception, which can be determined by turning the equipment off and on, the user is encouraged to try to correct the interference by one or more of the following measures:

- Reorient or relocate the receiving antenna.
- Increase the separation between the equipment and receiver.
- Connect the equipment into an outlet on a circuit different from that to which the receiver is connected.
- Consult the dealer or an experienced radio/TV technician for help.

Warning: Changes or modifications made to this device not expressly approved by SHENZHEN LEADSIGN AUTOMOTIVE ELECTRONICS CO., LTD may void the FCC authorization to operate this device.

Note: The manufacturer is not responsible for any radio or TV interference caused by unauthorized modifications to this equipment. Such modifications could void the user's authority to operate the equipment.

RF exposure statement:

The transmitter must not be colocated or operated in conjunction with any other antenna or transmitter. This equipment complies with the FCC RF radiation exposure limits set forth for an uncontrolled environment. This equipment should be installed and operated with a Minimum distance of 20cm between the radiator and any part of your body.