

IQ sound<sup>®</sup>

IQ sound<sup>®</sup>

**MICRO HI-FI COMPONET SYSTEM  
IQ-9000BT  
INSTRUCTION MANUAL**



***DEAR CUSTOMER***

In order to obtain the best product performance, please read this instruction manual carefully before use and keep it for future reference.

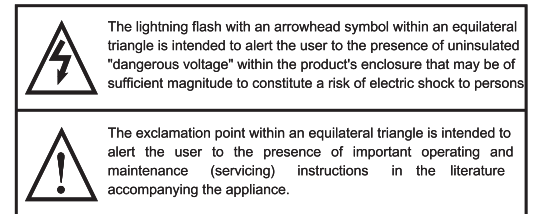
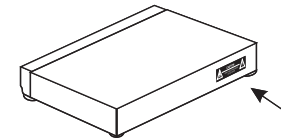

WARNING: DO NOT EXPOSE THIS APPLIANCE TO RAIN OR MOISTURE, DUE TO THE HIGH RISK OF FIRE OR ELECTRIC SHOCK, DO NOT OPEN THE CABINET DANGEROUS HIGH VOLTAGES ARE PRESENT INSIDE THE ENCLOSURE. ONLY QUALIFIED SERVICE PERSONNEL SHOULD ATTEMPT THIS.

CAUTION: This Digital Video Disc Player employs a Laser System. To prevent direct exposure to the laser beam, do not try to open the enclosure. Visible laser radiation when open and interlocks defeated. Use of controls or adjustments or performance of procedures other than those specified herein may result in hazardous radiation exposure.

DO NOT STARE INTO BEAM.

To ensure proper use of this product, please read this owners manual carefully.

Do not put the battery into the remote in conditon of sunshine fire or over hot environment.

## Security Warning



**CAUTION**  
RISK OF ELECTRIC SHOCK  
DO NOT OPEN



**WARNING: TO AVOID THE DANGER OF FIRE OR ELECTRIC SHOCK, DO NOT EXPOSE THIS APPLIANCE TO RAIN OR MOISTURE. NEVER OPEN THE CABINET, AS DANGEROUS HIGH VOLTAGES ARE CONTAINED INSIDE. ONLY A QUALIFIED SERVICE TECHNICIAN SHOULD ATTEMPT OPEN THE CABINET.**

**CAUTION:** This Digital Versatile Disc Player employs a laser system. To prevent direct exposure to the laser beam, do not open the enclosure. Visible laser radiation is present when enclosure is open. **DO NOT STARE INTO BEAM.** Additionally, the use of controls or adjustments or performance of procedures other than those specified herein may result in hazardous radiation exposure. To ensure proper use of this product, please read this owner's manual carefully and retain for future reference. Should the unit require maintenance, contact an authorized service location, or contact the service center.

This equipment generates, uses and can radiate radio frequency energy and, if not installed and used in accordance with the instructions, may cause harmful interference to radio communication. However, this is no guarantee that interference will not occur in a particular installation. If this equipment does cause harmful interference to radio or television reception, which can be determined by turning the equipment off and on, the user is encouraged to try to correct the interference by one of the following measures:

- ◆ Reorient or relocate the receiving antenna
- ◆ Increase the separation between the equipment and receiver
- ◆ Connect the equipment into an outlet on a circuit different from that to which the receiver is connected
- ◆ Consult the dealer or an experienced radio/TV technician for help

### PROTECT YOURSELF!

Record the model and serial numbers for this unit while it is easy to see them. These numbers are located on the back of the unit's cabinet. Retain this information for future reference.

*Retain this information for future reference.*

### CAUTION

**RISK OF ELECTRIC SHOCK DO NOT OPEN**

**CAUTION: TO REDUCE THE RISK OF ELECTRIC SHOCK, DO NOT REMOVE COVER (OR BACK). THERE IS NO USER SERVICEABLE PART INSIDE. REFER SERVICING TO QUALIFIED SERVICE PERSONNEL.**

**WARNING:** Do not dispose of the battery in fire. Or recharge, put in backwards, may explode or leak.

## Basic safety requirements

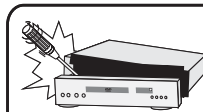

Do not open the cabinet

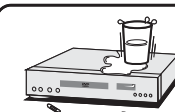

Do not use the apparatus near the water

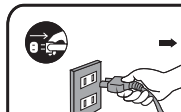

Unplug the apparatus during the lightning storms or when unused for a long period

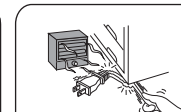

Do not use defect power cable

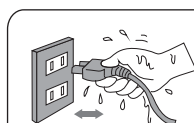

Do not touch the power cable with wet hands

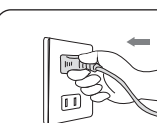

Insert the plug in the socket firmly

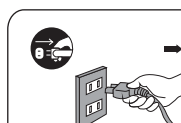

Switch off a player if the contacts of the cable plugwire are not completely in a socket of power point

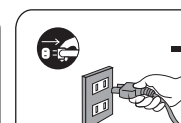

Unplug the apparatus if the device is wet

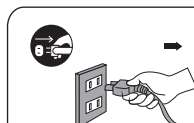

At damage of a player please disconnect it from power line

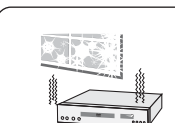

If it is very cold, please turn on the power for 1min. Then turn off the power for 1 min. Then you can turn on and use the unit



Do not expose the unit to the direct sunlight or in abnormal hot place

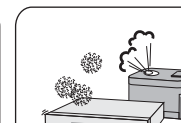

Do not situate this unit in the moisty place

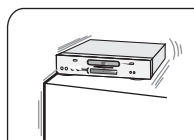

Place the apparatus on a stable place

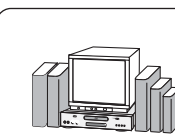

Do not situate the unit under any heavy objects or in unventilated places

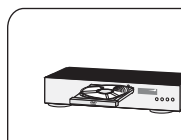

Do not use discs with scratches and deformation

## General Information (2)

### Notes about discs

#### Disc handling precautions

- To keep the disc clean, handle the disc by its edge. Do not touch the surface.
- Do not stick paper or tape on the disc. If there is glue (or a similar substance) on the disc, remove the glue completely before using the disc.
- Do not expose the disc to direct sunlight or sources such as hot air ducts, or leave it in a car parked in direct sunlight as there can be considerable rise in temperature inside the car.
- After playing, store the disc in its case.
- Do not write on the label side with a ball-point pen or other writing utensils.
- Be careful not to drop or bend the disc.

#### Disc cleaning precautions

- Before playing, clean the disc with a cleaning cloth. Wipe the disc from the center out.
- Do not use solvents such as benzine, thinner, commercially available cleaners or anti-static spray intended for vinyl LPs.
- Disc installing precautions  
Do not install more than 1 disc on disc tray.  
Do not place the disc on the tray up-side down.  
Do not try to close the disc tray when the disc is not installed properly.

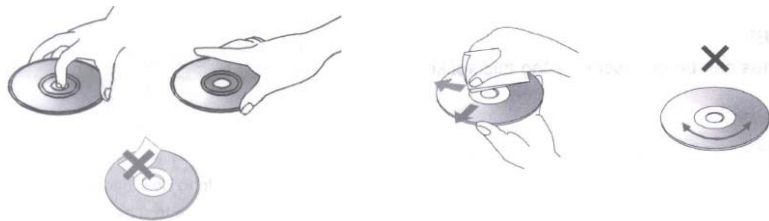

## Front panel

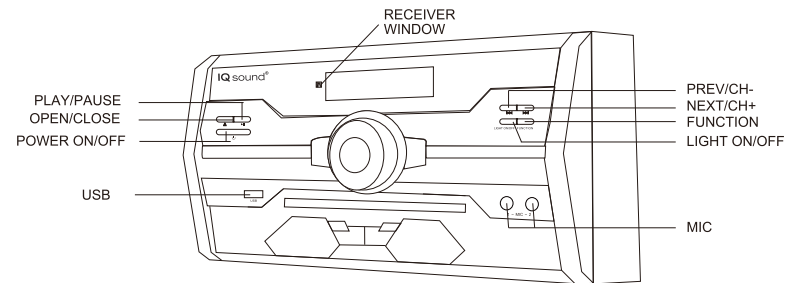

Max. 32GB memory size of USB device can be supported.

Unless stated otherwise, the remote control can operate all the features of the VIDEO Player, always point the remote control directly at the remote sensor on the front of the VIDEO Player, not the TV

### FM Function

1. Press "FUN" and then choose FM mode.
2. Press "SCAN" on remote controller to search FM radio stations automatically.
3. Press "PREV/CH-" "NEXT/CH+" for previous/next FM station

### AUX INPUT Description

The CD support Mp3, MP4, CD etc which lower than 2V make sound bigger by AUX L/R input. Press "FUN" key on the remote control or on the front panel to change into AUX IN mode, and also can press Volume +, - to control the sound.

### Connect via Bluetooth

1. Press FUNCTION button to select BLUETOOTH mode.
2. To pair with smartphone, turn on Bluetooth in your mobile phone and search for devices.
3. Select the device named IQ-9000BT.
4. You can hear a little sound coming from the unit after successfully pairing via Bluetooth.
5. Now you can play music in your mobile phone

## Back Panel

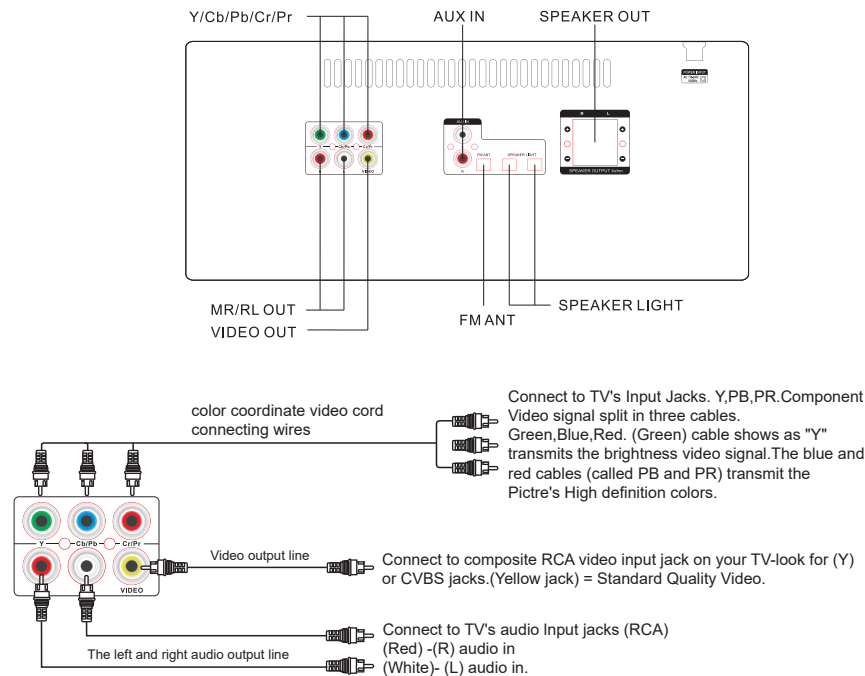

## Connection

## Connecting to Speaker

Connect the supplied speakers with the supplied speaker wires matching the LETTER (L/R) of the jacks and corresponding speaker.

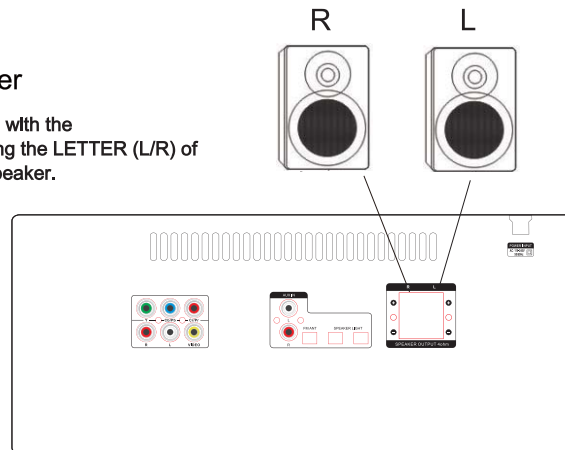

## Examples of poor conditions of the speaker cord

- Stripped speaker cord is touching another speaker terminal.
- Stripped cords are touching each other due to excessive removal of insulation.

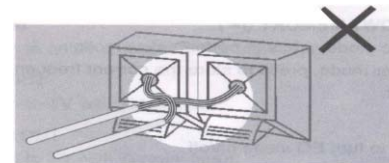
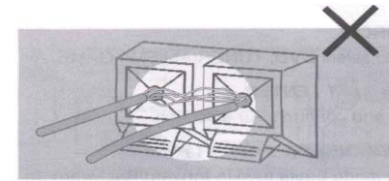

## Connecting FM aerial

Connect the supplied FM aerial to the FM jack  
Move the aerial in various directions until the Clearest signal is received.

## Note:

Keep the aerial as far away as possible from the TV, VCR or any radiation sources to prevent unwanted noise.

