

Air purifier instruction manual

Please read and keep this instruction manual carefully before use

This manual is applicable to: DK01/DK02/DK01B/DK02B
Different models of product configuration and function is different, please prevail in kind

Product overview

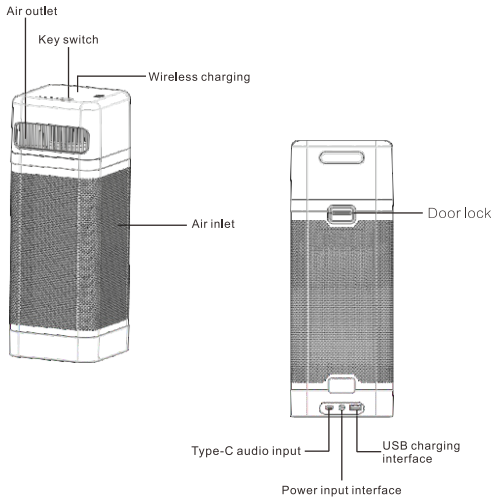

Product overview

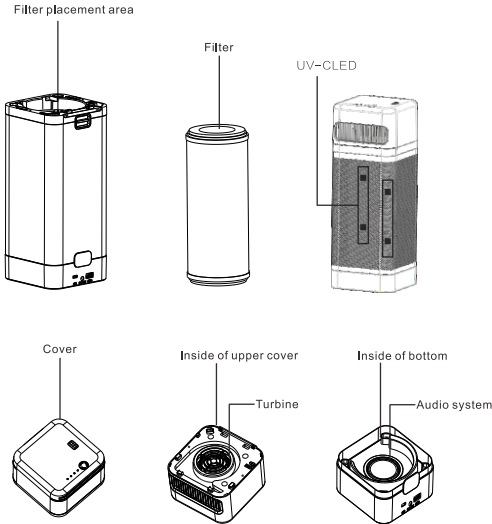

Product overview

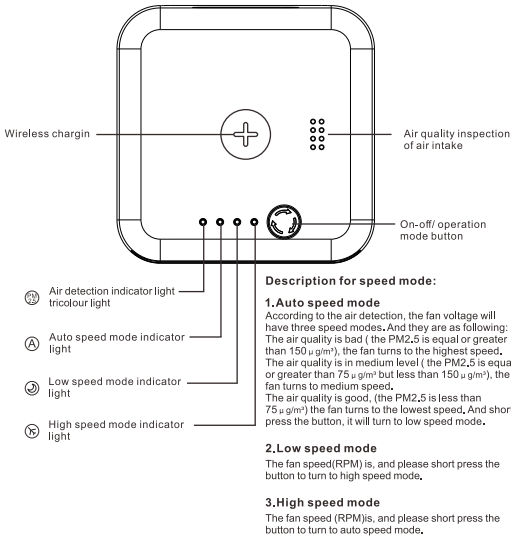

Product installation

1.Detach the cover

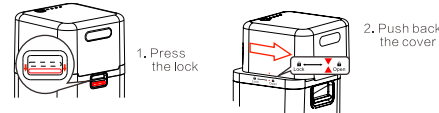

2.Unpack the filter, take out the filter.



3.Put the filter in. Then keep the filter handle outward, which makes taking out the filter and easily next time.

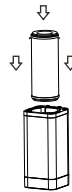

4.Install the cover

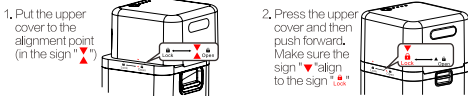

Warm Tips:
The replacement cycle for filter is 6-9 months.

Products use

When power line is inserted into the power, the motor turns into the auto speed mode.
No matter in any mode, long press the on/off button for 2 seconds, it will go into standby mode.
Short press on/off button again, it will go into power on mode.
When in standby mode, the Bluetooth audio, USB charging mode and wireless charging will work normally.

Bluetooth audio system function normally open

When the Bluetooth is connected, it's with voice prompt "connecting"
When the Bluetooth is disconnected, it's with voice prompt "disconnecting"
When it's off, it's with voice prompt "power off"
Bluetooth name "purifier Bluetooth"

Wireless charging function normally open
Power: 10W

USB charging port normally open
5V-2A

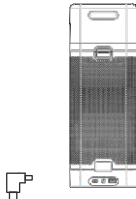

Products use



Power switch/operation mode switch
When the machine is plugged in, it will go into auto speed mode.
Click to switch the mode according to the order of "auto speed mode/low speed mode/ high speed mode". Long press the button for 2 seconds, it will turn into standby mode.

indicator light for operational mode

The air quality (bad/medium/good) will be shown in red/orange/green indicator light. It will real-time display the indoor air quality.	
red light- bad air quality	orange light- medium air quality
green light- good air quality	

Wireless charging

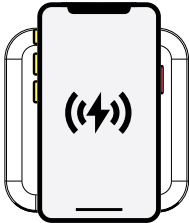

If you need to use the wireless charging function: please place your phone in the middle of the sign for wireless charging.

Bluetooth audio system



If you need to use the Bluetooth speaker function: please make sure Bluetooth enabled of your phone, then select "purifier Bluetooth" to connect. You can hear the sound of "connecting" after successful pairing. After that, you can use the Bluetooth speaker.

Maintenance

For good effect of ventilation and purification, please use a vacuum cleaner to clean the dust on the air outlet and inside part of the machine, or wipe with soft cloth.

In order to get good effects for ventilation and purification, the replacement cycle for filter should be 6-9 months

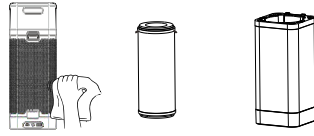

Warning: Changes or modifications to this unit not expressly approved by the party responsible for compliance could void the user's authority to operate the equipment.
This device complies with Part 15 of the FCC Rules. Operation is subject to the following two conditions: (1) this device may not cause harmful interference, and (2) this device must accept any interference received, including interference that may cause undesired operation.
Note: This equipment has been tested and found to comply with the limits for a Class B digital device, pursuant to part 15 of the FCC Rules. These limits are designed to provide reasonable protection against harmful interference in a residential installation. This equipment generates, uses and can radiate radio frequency energy and, if not installed and used in accordance with the instructions, may cause harmful interference to radio communications. However, there is no guarantee that interference will not occur in a particular installation. If this equipment does cause harmful interference to radio or television reception, which can be determined by turning the equipment off and on, the user is encouraged to try to correct the interference by one or more of the following measures:
-- Reorient or relocate the receiving antenna.
-- Increase the separation between the equipment and receiver.
-- Connect the equipment into an outlet on a circuit different from that to which the receiver is connected.
-- Consult the dealer or an experienced radio/TV technician for help.
To maintain compliance with FCC's RF exposure guidelines, the distance must be at least 20cm between the radiator and your body, and fully supported by the operating and installation configurations of the transmitter and its antenna(s).

Product parameters

product name	Air purifier	Item No.	DK01/DK01B DK02/DK02B
filter level	HEPA	Rated voltage	12V
Noise	≤55dB (A)	Rated power	24W
Product net weight		Suitable area	5-15㎡
wireless charging	optional	Bluetooth speakers	optional
Requirements for equipment	Support equipment android 4.4 or iOS 7.0 (or version higher) (iphone 4s or above)		

Product hazardous substances declaration

The name and content of harmful substances in the product						
Name of part	hazardous substances					
	Pb	Hg	Cd	Cr (VI)	PBB	PBDE
External components	O	O	O	O	O	O
spare parts of the machine	X	O	O	O	O	O
Internal components	O	O	O	O	O	O
Accessories for stand	O	O	O	O	O	O

This form is prepared according to the provisions of SJ/T11364

O: means that the content of the hazardous substance in all homogeneous materials of the component is below the limit specified in GB/T26572

X: means that the content of the hazardous substance in at least one homogeneous material exceeds the limit specified in GB/T26572.

Cautions Moving

-When moving, please make sure the machine power off and pull out the power plug
-Also, make sure the machine is stable to avoid excessive vibration or hurting people by machine dropping.

Using

-If the product has the following situations: abnormal noise/odor/high temperature/irregular rotation of fan or other abnormal conditions, please stop using it immediately.
-Please do not put your fingers or other materials into the protective parts, removal parts, air inlet or air outlet.
-Please do not put hair, fabric, etc close to the machine, or it will be involved in or block the air inlet or air outlet
-Please do not sit, lean on or tilt the machine,

Use limits

Do not use the machine in the following situations, otherwise it may cause electric shock, collision and other injuries.
-Please do not use it when the machine cannot be fixed.
-Please make sure the machine stays away from liquids.

Cautions for power cord

Please use the power cord and socket as instructed below, which can avoid fire, shock or damage.
-Please do not over-pinch, bend or twist the power cord, otherwise the core may be exposed or broken.
-When disconnecting the power cord, do not pull the power cord
-Please do not use improper air purifier charger.
-Please do not use our power cord in other equipment.
-Non-professionals are forbidden to open the machine for maintenance.
-If the power cord is damaged, it must be replaced with a dedicated cord or a dedicated component purchased from the manufacturer or maintenance department.
-Please keep the desktop clean and clean foreign material in time to avoid affecting the safety of electricity use.