



Smart Solar Pathlights

User Manual



Download Free APP:

Download on the App Store

GET IT ON Google Play

Can't connect? Need help?

Email: service.2@xmcosy.com

Package Contents

After unpacking, please check the product accessories.

If there are any missing or damaged accessories, please contact us as soon as possible, and our customer service team will solve it in time.

service.2@xmcosy.com

Pack Type	2 Pack	4 Pack	6 Pack
Smart Solar Pathlight	2	4	6
Light Pole	2	4	6
Ground Stake	2	4	6
Lampholder	2	4	6
Screws	6	12	18
USB Charging Cable	1	1	1
Smart Bridge	×	×	1

Safety Information

Thank you for choosing XMcosy Smart Solar Pathlights. Please read the user manual carefully and follow all the safety instructions.

- Do not modify the solar panels and batteries by removing them without permission.
- When the battery expires, it must be recycled or disposed of properly. Please contact your local waste disposal authority for the correct procedure.
- Do not dispose of Lithium batteries in municipal waste streams or by fire as batteries may explode.
- Do not immerse in water.
- Please keep children away from these lights.
- Keep lights away from flammables and fire sources.
- Avoid placing the lights near potentially dangerous sources.

FCC Notice:

This device complies with Part 15 of the FCC Rules. Operation is subject to the two following conditions:

- 1.This device may not cause harmful interference.
- 2.This device must accept any interference received, including interference that may cause undesired operation.

Note: This equipment has been tested and found to comply with the limits for a Class B digital device, pursuant to Part 15 of the FCC Rules. These limits are designed to provide reasonable protection against harmful interference in a residential installation.

CAUTION: Suitable for outdoor/indoor use.

Specifications

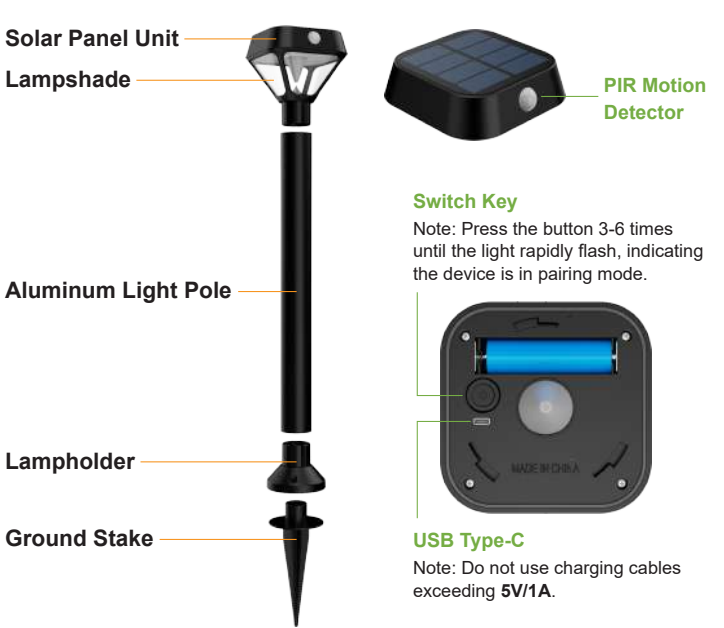

Solar Panel: 5.5V 1.1W 200mAH Monocrystalline Silicon
Battery: 3.7V 9.62W 2600mAH Lithium Rechargeable Battery
Sensor Angle: 150°
Sensor Distance: 32.8ft (Adjustable)
LED Color: RGBCW
Brightness: 150 Lumens
Waterproof Rate: IP65
Working Temperature: -4°F-113°F
Product Size: 4.51 " D X 26.17 " H (including ground stake)

Introduction

This product can be connected to the XMcosy app via Bluetooth or 2.4G WIFI.

To access all the smart features, it is required to work with an XMcosy Smart Bridge to do so. (First, connect the XMcosy Smart Bridge via 2.4G Wi-Fi, then add the light to the smart bridge to use.)

Installation & Setup

1 Download the app, register, and log in.



2 Remove the solar panel by twisting it counterclockwise and lifting it off the lampshade.

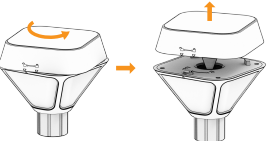

3 Turn on Bluetooth and add the device by clicking the "+" in the top right corner. Devices in pairing mode will appear at the top. Click "Add." (Note: Lights must be added individually, one at a time.)



4 Wait for the connection to complete (100%).



5 Edit the product name, save, and click "Done" in the top right.

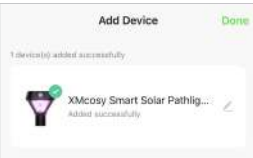

6 Align the center corner first, then match the three corners and rotate clockwise to secure the solar panel.

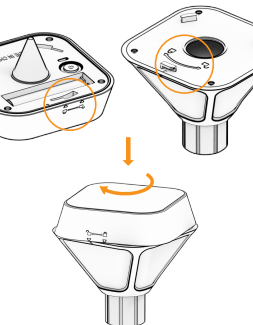

7 Insert the lampshade into the connection tube, then attach the connection tube to the lampholder.

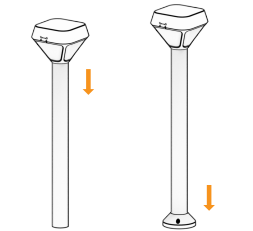

Installation & Setup

- 8 (1) Insert the ground stake into the lampholder and twist clockwise to lock.

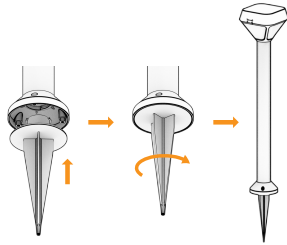

- (2) Alternatively, secure it to the wooden board with screws.

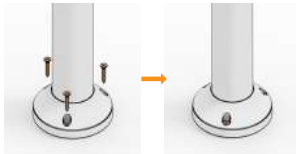

Note: Moisten hard soil with water before inserting the stake to prevent breakag

APP Functions

Sensor Sensitivity

Adjustable: High (26.25-32.8ft)
Medium (16.4ft-26.25ft)
Low (6.56-16.4ft)

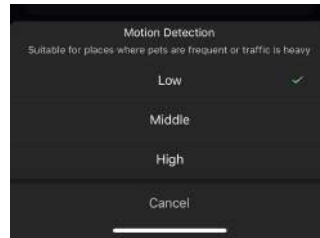

Luminance Detection

Adjustable: Day, Dusk, Evening, Night, Dark (It's recommended to choose Night or Dark.)

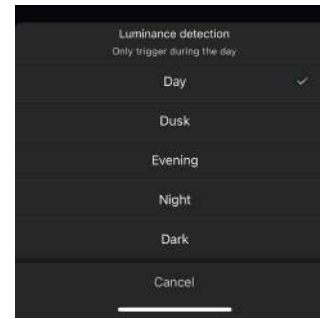

Full Light Duration

Adjustable: 5s to 60 minutes

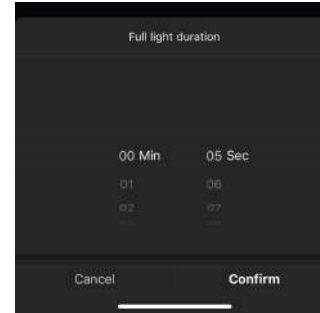

Slight Bright

Slight Bright Mode provides adjustable brightness levels from 1% to 30%. The duration can be customized to 8 hours or set to continuous operation.

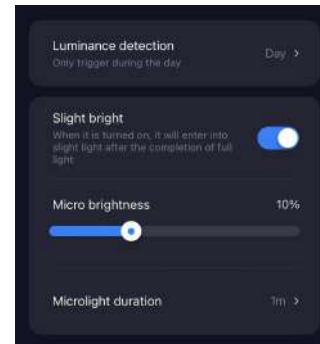

Dimmable Brightness

Adjustable brightness and DIY light.

Create Group

"Create Group" to control multiple sets together or one group control all xmcasy lights

The following features require an XMCOSY+ Smart Bridge to work. (Connect the smart bridge via 2.4G Wi-Fi and add lights to the smart bridge.)

Timer

Use "Timer" to set your lights to turn on or off at your desired times.

Voice Commands

Voice commands Alexa or Google Assistant to turn on/off lights, adjust brightness, etc.

Share Device

"Share Device" to family members to control the same light

For more details on the feature, please scan the code to watch.



Note

- Initial Charge: Fully charge the battery in sunlight or with a power supply before first use for optimal performance.
- Battery Life: After a full charge, in always-on mode, it can provide around 12 hours of usage. In motion-detection mode with full light duration for 30 seconds, it can last approximately 3 days. The duration depends on the environment and mode settings.
- Installation: Place the solar panel in direct sunlight to maximize charging efficiency and lighting duration.
- Maintenance: Keep the solar panel clean. Use a damp cloth to remove dust or dirt; avoid chemicals and abrasive cleaners.
- Temperature Effect: Higher temperatures reduce sensitivity and range.

Troubleshooting

Problems	Solutions
Lamp does not light up	<ol style="list-style-type: none">1. Check that the battery is charged. (Use your hand or a cloth to completely block the solar panel. If the light turns on, it has power.)2. Check rechargeable batteries to make sure they are in contact with the metal plate and have the correct polarity.
Cannot connect to the XMcosy App	<ol style="list-style-type: none">1. Check that Bluetooth is switched on on your smartphone.2. Make sure that the smartphone is close to the indicator light and within 15 meters. If the distance exceeds 15 meters, the light will disconnect but will automatically reconnect when back within the 15-meter range.3. When pairing, check that the indicator light is blinking.4. If the connection error persists, try clearing all applications running in the background and reopening the XMcosy application, or uninstall and reinstall the XMcosy application and repeat the setup.
Sensor not working	<ol style="list-style-type: none">1. Check if the power is sufficient2. The sensor angle (150°) and the sensor distance (within 10 metres) are within the range, if they are exceeded, the sensing will not work.3. Check if the luminance detection is set appropriately. It's recommended to choose night or dark.4. Clean the sensor and ensure it's unobstructed.
Some functions don't work <ul style="list-style-type: none">• Timer• Share Device• Alexa / Google Assistant• Intelligent Linkage• Automation	<p>Bluetooth does not support these features.</p> <p>To access all the smart features, it is required to work with an XMCOSY+ Smart Bridge to do so. (First, connect the XMCOSY+ Smart Bridge via 2.4G Wi-Fi, then add the light to the smart bridge to use.)</p> <p>Note: WIFI connection supports all smart functions, Bluetooth connection supports some functions.</p>

For any product or usage issues, please email

service.2@xmcasy.com
or scan the QR code



Warranty: 1-year with proof of purchase

For more info or news about XMCOSY+, please follow XMCOSY+ social website.



Official Website:

www.xmcasy.com



FCC Warning

This device complies with part 15 of the FCC rules. Operation is subject to the following two conditions: (1) this device may not cause harmful interference, and (2) this device must accept any interference received, including interference that may cause undesired operation.

Changes or modifications not expressly approved by the party responsible for compliance could void the user's authority to operate the equipment.

NOTE: This equipment has been tested and found to comply with the limits for a Class B digital device, pursuant to part 15 of the FCC Rules. These limits are designed to provide reasonable protection against harmful interference in a residential installation. This equipment generates uses and can radiate radio frequency energy and, if not installed and used in accordance with the instructions, may cause harmful interference to radio communications. However, there is no guarantee that interference will not occur in a particular installation. If this equipment does cause harmful interference to radio or television reception, which can be determined by turning the equipment off and on, the user is encouraged to try to correct the interference by one or more of the following measures:

- Reorient or relocate the receiving antenna.
- Increase the separation between the equipment and receiver.
- Connect the equipment into an outlet on a circuit different from that to which the receiver is connected.
- Consult the dealer or an experienced radio/TV technician for help.

Radiation Exposure Statement

This device complies with FCC radiation exposure limits set forth for an uncontrolled environment. This equipment should be installed and operated with minimum distance 20cm between the radiator and your body.