

The example used below is for demonstrative purposes only.

Before Connecting your Coaster (s)

DO NOT:

- Remove the Coaster(s) from packaging, as removing them one-by-one during the Coaster connecting process is the best way to keep track of which Coasters have already been connected.
- Turn the Coaster(s) on, as each Coaster will only search for a Bluetooth-enabled smartphone to connect to for a few minutes after it is turned on. If you have already turned your Coaster(s) on by pressing the power button, turn it/them off by quickly pressing the power button three times. The light will flash red to confirm the power is off.

DO:

- Download the QualSights app from the iOS App store or Google Play Store if you haven't already
- Sign up if you are new to the app or Sign In if you already have an account
- Add a project using the project access code given to you if you haven't already done so or if you don't see a project listed on the My Projects screen
- If you have any questions or need support, please send an email to coaster@qualsights.com

#1: Click 'View Project'

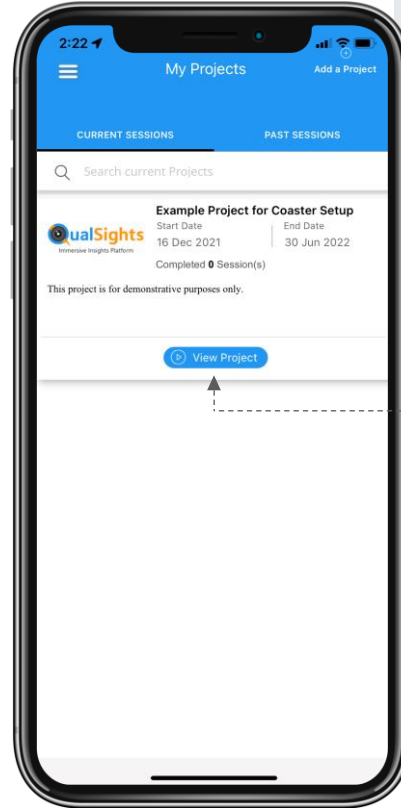

Important: Make sure your Coaster(s) is/are either unopened or not turned on before starting.

To begin setting up a QualSights Coaster, click the 'View Project' button for the associated project.

#2: Click 'Devices'

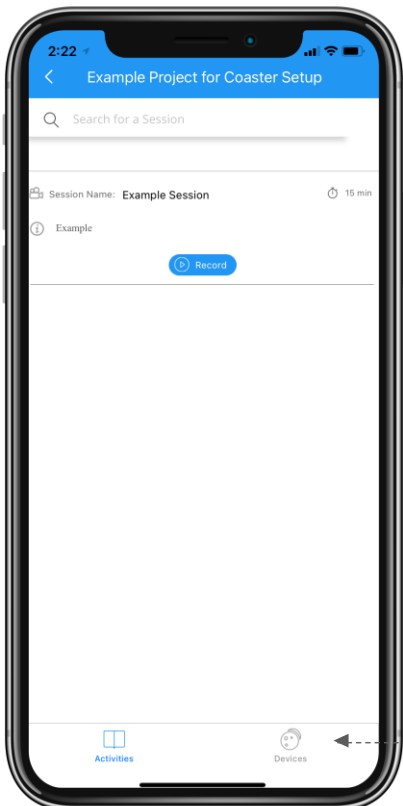

Within the project page, click the 'Devices' button in the bottom right of your screen.

#3: Click 'CONNECT DEVICES'

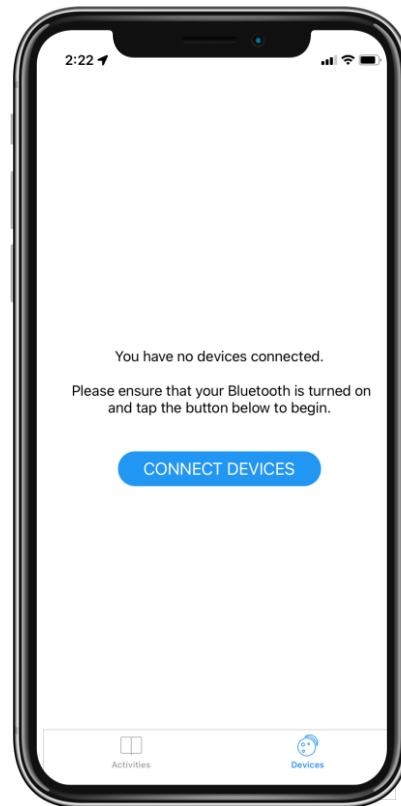

As directed on the next page, ensure your smartphone's Bluetooth is turned on.

Once you've confirmed your smartphone's Bluetooth is on, click 'CONNECT DEVICES' and follow the steps required to set up your coaster as mentioned in the app

The example used below is for demonstrative purposes only.

Safety Information

Intended Use

The QualSights Smart Coaster to be used for the purpose of measuring and analyzing product consumption in-home. They should be used as directed in this manual only and should not be disassembled.

Electrical Ratings

Charge: Input 5.0 Vdc ~ 250mA charge rate

Discharge: 3.7 Vdctyp/4.2Vdcmax ~ 100 mA

Protecting Your Coaster

QualSights Coasters are splash proof as well as heat and cold resistant, but they're not indestructible. Be sure they are kept out of reach of pets and young children, and do not place them where they may be exposed to extreme temperatures. As a rule of thumb, if you wouldn't feel comfortable placing a water-resistant smartphone somewhere, a Coaster likely shouldn't be put there either.

Accessories with the device in the box

Charging cable and plug

Charging FAQs

Can I leave my Coaster(s) plugged in?

No. Coasters should not be left plugged in at all times, as this will affect the accuracy of the gathered weight data.

When should I charge my Coaster(s)?

Coasters should be charged when their battery reaches 10% or less. You should receive a push notification from the QualSights app to indicate that the battery is low, and you can also check the battery status of Coasters by referencing the Devices list in the QualSights app.

How long does it take to charge a Coaster?

From low battery (10% or less), Coasters typically take about 2.5 hours to charge. Once full charge is reached, the Coaster's light will turn solid green to indicate it is ready. Even if you don't see a green light, you can assume a coaster is fully charged after plugging it in for 2.5 hours.

Regulatory Notices

Label Interference Note

This device complies with Part 15 of the FCC Rules and Industry Canada license-exempt RSSs. Operation is subject to the following two conditions: a.) this device may not cause harmful interference, and b.) this device must accept any interference received, including interference that may cause undesired operation.

Le présent appareil est conforme aux CNR d'Industrie Canada applicables aux appareils radio exempts de licence. L'exploitation est autorisée aux deux conditions suivantes:

- (1) l'appareil ne doit pas produire de brouillage, et
- (2) l'appareil doit accepter tout brouillage radioélectrique subi, même si le brouillage est susceptible d'en compromettre le fonctionnement.

Modifications Note

Changes or modifications not expressly approved by the party responsible for compliance could void the user's authority to operate the equipment.

RF Exposure Note

This equipment complies with FCC radiation exposure limits set forth for an uncontrolled environment. This equipment should be installed and operated with minimum distance 20cm between the radiator and your body. This transmitter must not be co-located or operating in conjunction with any other antenna or transmitter

Regulatory Notices

Class B Digital Device

This equipment has been tested and found to comply with the limits for a Class B digital device, pursuant to part 15 of the FCC Rules. These limits are designed to provide reasonable protection against harmful interference in a residential installation. This equipment generates, uses and can radiate radio frequency energy and, if not installed and used in accordance with the instructions, may cause harmful interference to radio communications. However, there is no guarantee that interference will not occur in a particular installation. If this equipment does cause harmful interference to radio or television reception, which can be determined by turning the equipment off and on, the user is encouraged to try to correct the interference by one or more of the following measures:

- Reorient or relocate the receiving antenna. Increase the separation between the equipment and receiver.
- Connect the equipment into an outlet on a circuit different from that to which the receiver is connected.
- Consult the dealer or an experienced radio/TV technician for help.