

Size: 210x102 mm

70 mm

70 mm

70 mm

102 mm



USER MANUAL

Technical Specifications:

Model: WYS-2306BT  
Function: BT / Sensing / Power Bank  
Playtime: 5-8 Hours (Depend on Volume)  
Output Power: 5W x 1  
Input: DC 5V (USB-C)  
Dimensions: 123 x 78 x 71mm  
Charging Time: About 2 hours  
Playback Modes: Bluetooth / Sensing  
Connectivity: Up to 10M

1. Bluetooth Function:

Long Press on  Button on Speaker to Switch into Bluetooth mode. Then Turn on the Bluetooth on your device and select "WYS-2306BT" to pair the two devices.

2. Induction Function:

Long-press the  button until a sound confirms induction mode. Place your device securely on the speaker's holder, centered over the induction area. Play audio via your app—sound transmits wirelessly via induction. Adjust volume using your device or speaker controls.

3. Charging Function:

The speaker has a charging function. Inserting a charging cable can charge your mobile phone and extend its battery life.

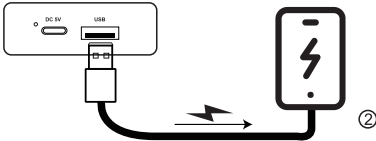

4. Function

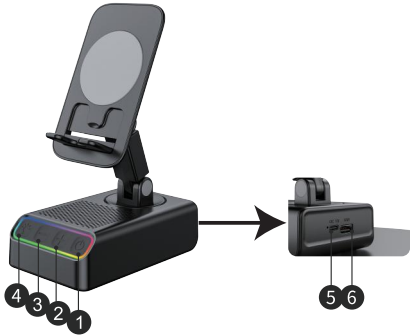

1 Long Press to turn ON / OFF

2 Short press to switch next song.  
Long press to increase volume+"

3 Short press to Switch previous Song.  
Long press to decrease volume"-"

Long Press to Switch between  
4 BT/ FM / Sensing.  
Short press to switch LED lights mode.

5 Power input DC 5V

6 Emergency Charging

5. Small phone holder

The speaker has the function of a mobile phone holder, which can be folded, it can also be adjusted up or down.

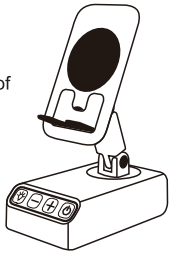

Small phone holder  
With a phone holder, release your hands



Visible 5W power  
Small speakers also have a loud volume



Induction Mode:  
Place your device securely on the speaker's holder, centered over the induction area. Play audio via your app—sound transmits wirelessly via induction. Adjust volume using your device or speaker controls.



Multiple playback modes  
New experiences with faster music

Tips: The phone can only be placed vertically!

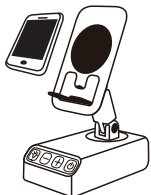

FCC WARNING

This device complies with part 15 of the FCC Rules. Operation is subject to the following two conditions:  
(1) This device may not cause harmful interference, and (2) this device must accept any interference received, including interference that may cause undesired operation.

Note: This equipment has been tested and found to comply with the limits for a Class B digital device, pursuant to part 15 of the FCC Rules. These limits are designed to provide reasonable protection against harmful interference in a residential installation. This equipment generates, uses and can radiate radio frequency energy and, if not installed and used in accordance with the instructions, may cause harmful interference to radio communications. However, there is no guarantee that interference will not occur in a particular installation. If this equipment does cause harmful interference to radio or television reception, which can be determined by turning the equipment off and on, the user is encouraged to try to correct the interference by one or more of the following measures:

- Reorient or relocate the receiving antenna.
- Increase the separation between the equipment and receiver.

- Connect the equipment into an outlet on a circuit different from that to which the receiver is connected.
- Consult the dealer or an experienced radio/TV technician for help.

Note: The Grantee is not responsible for any changes or modifications not expressly approved by the party responsible for compliance. Such modifications could void the user's authority to operate the equipment. The device has been evaluated to meet general RF exposure requirement. This equipment complies with FCC's RF radiation exposure limits set forth for an uncontrolled environment. This device and its antenna(s) must not be co-located or conjunction with any other antenna or transmitter.