

Playback Mode

File selecting screen

After the engine is turned on, the power will automatically turn on.

In video recording mode, long press [M] to switch to photo mode. (If recording is in progress, you need to stop recording)
Short press in photo mode to switch to playback mode.

<Still photo file>

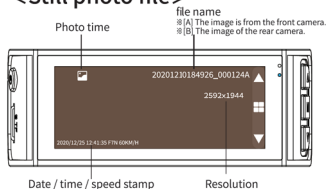

<Video file>

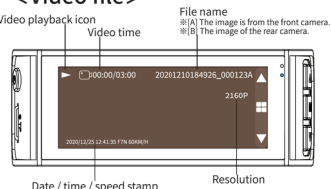

Playback menu

In the playback mode, short press the M button to enter the playback menu.

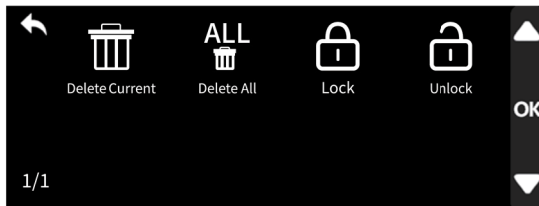

● [Delete Current]: Delete the displayed file

● [Delete All]: Delete all files







※Unable to delete locked file. You can manually unlock and then erase.

● [Lock]: Manually lock the display file







● [Unlock]: Manually unlock the displayed files

Playback Mode

Button function in playback mode(playback stopped / file selection screen)

Button	icon	Function
		Short press to start/pause the displayed file
		UP(forward): Return to the previous file
M		Short press to enter the setting menu Long press to switch to recording mode
		Next: Move to the next file

Button function in playback mode(On playback)

Button	icon	Function
		Short press to start/pause the displayed file
		Short press: Fast rewind (slow), double speed ※Rewind: Play back to the beginning
M		Short press to stop playback (Return to the beginning of the display file)
		Short press: Fast forward / double speed Long press to switch to recording mode

Play on Computer

How to output data on computer:

① Data can be output by connecting the main unit to a personal computer using a USB cable.

※Some USB cables only have a charging function, not a data transmission function. Please use a USB cable with a data transmission function.

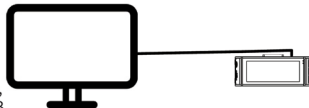

② Data can be output on computer by using a card reader.



The video recorded by this product can be displayed in conjunction with Google Maps by installing the dedicated viewer software on your computer.

※An internet connection is required.

Download URL: <http://www.gpsplayer.net/setup.html>

<About recorded files>

If you collide during recording, drive on bumpy roads or close the door tightly, the video will be locked automatically and the locked video will be automatically saved in the RO folder of TF card and will not be overwritten (When the recording is locked, a red lock icon in the center of the screen will be displayed). Press the "Up" button to manually lock the recorded video.

"XXXXXX_XXXXXXA": Front camera video

"XXXXXX_XXXXXXB": Rear camera video

About WIFI & APP

The app "Ucam" is a free app that allows you to operate this WLAN built-in drive recorder from your smartphone

About WIFI connection

① Download the "Ucam" app

Select [APP] from the main menu and press the [M] switch to display the QR code on the screen. Scan the QR code on your smartphone and download the "Ucam" app.

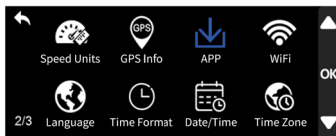

② WIFI function on

Select [APP] in the menu, and turn on the WIFI function, or press and hold the [▲] button in recording mode to activate the WiFi function.

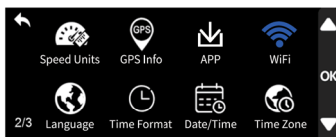

※ The WiFi name (F7N-XXXXXX) and password (initial password: 12345678) will be displayed on the screen after startup. You can check it with the power button.

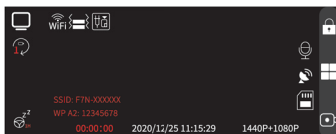

About WIFI & APP

③ Connect your smartphone to WiFi
Select the WIFI name in the WLAN list on your smartphone and enter the password.

④ Launch the app "Ucam"
When the connection is completed, the running video screen will be displayed automatically on the phone.

Note:

- When connected to WIFI, the dash cam can only operate by phone.
- Press and hold the **▲** button to turn off WiFi.

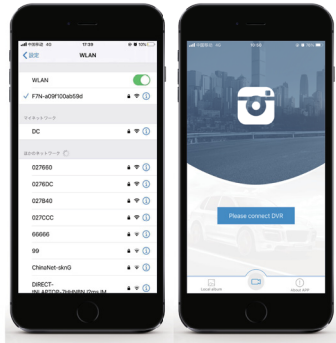

Recording screen of the APP (e.g.IOS)

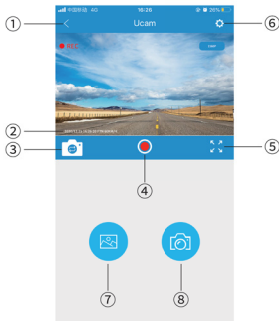

- ① Return to the front
- ② Video stamp
- ③ Switch the display view
- ④ Record button
(recording on / off)
- ⑤ Full screen display
- ⑥ Enter the setting menu
- ⑦ Data file
- ⑧ Take a photo

Check / play data with APP

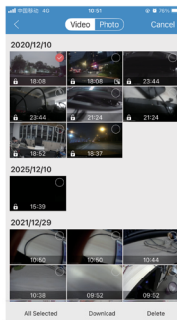

Note: You cannot delete the lock file unless unlocked the file manually.

About WIFI & APP

Edit and share with the APP

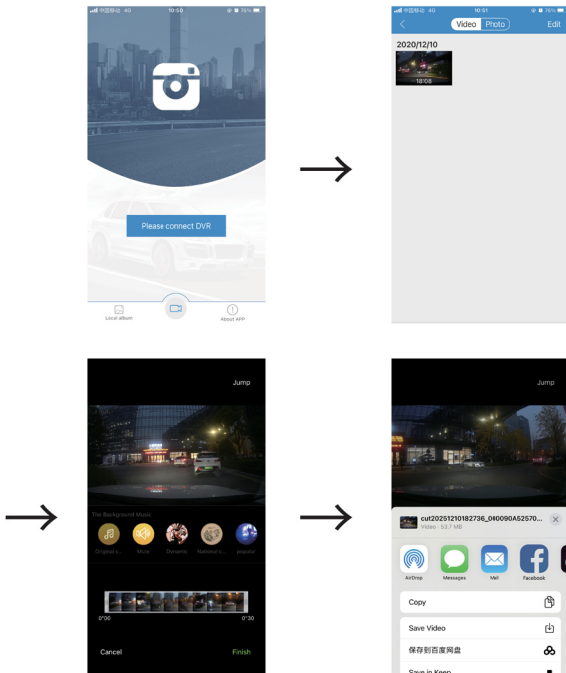

You can enter local albums, edit downloaded files and share them in the APP interface.

About the Setting Menu

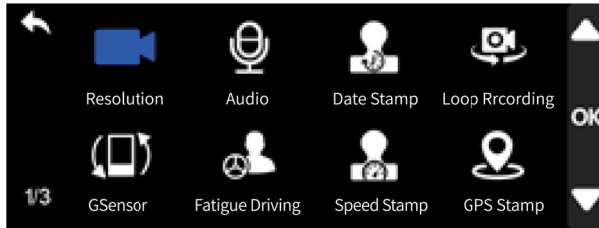

- [Resolution]: 4 modes resolution setting
2160P, 1440P, front 2160P + rear 1080P, front 1440P + rear 1080P
- [Audio]: Sound recording on / off
- [Date Stamp]: Date stamp on / off
- [Loop Recording]: 1 / 3 / 5 min
- [GSensor]: Off / low / medium / high
- [Fatigue Driving]: Off / 1H / 2H / 3H / 4H
A reminder will be made when drive for 1H / 2H / 3H / 4H continuously.
- [Speed Stamp]: Speed stamp on / off
- [GPS Stamp]: GPS stamp on / off

About the Setting Menu

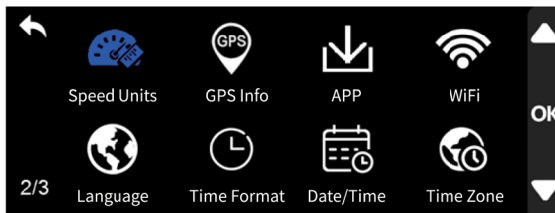

- [Speed Units]: KMH / MPH
- [GPS Info]: Check GPS status
- [APP]: QR code to download the APP
- [WiFi]: WiFi on / off
- [Language]: Languages Setting
- [Time Format]: 12H / 24H
- [Date/Time]: Date / time
- [Time Zone]: The world time standard

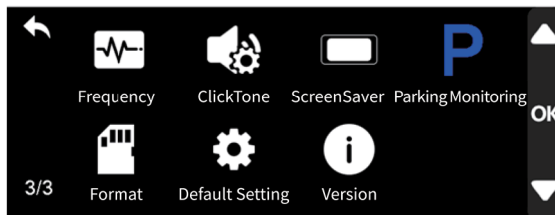

- [Frequency]: 50HZ/60HZ
- [ClickTone]: ON/OFF
- [ScreenSaver]: OFF/10S/30S/2Min
- [Parking Monitoring]: Requires hardwire kit (sold separately)
- ※Does not work without hardwire kit
- [Format]: Delete the data on the memory card and initialize the memory card
- [Default Setting]: Restore to factory default
- [Version]: Displays the version

Parking Monitoring Mode (Optional)

After installation of dedicated hardwire kit (Separately sold) and connected, you can set the parking monitoring functions.

● [OFF]:

The default setting is OFF.

● [G Sensor]:

When select the G-sensor mode, set the G-sensor on menu among high, middle or low, the dash cam will start recording automatically when there's collision or vibration in parking mode.

● [Time-lapse recording 12H / Time-lapse recording 24H / Time-lapse recording 48H]:

When select the Time-lapse mode, and set lapse time between 12hour, 24hour or 48hour. The dash cam will record 1 fps per second, it's extremely saving power and capacity. With battery drain protection, you don't need worry about drain out car battery.

※When playing a time-lapse video, you can [slow] it to achieve the normal playback effect.

FAQ

Please check out contents below. If the problem persists after confirmation, please contact your dealer or customer support.

Problem	Reason	Solution
Dash cam can not turn on	● There is a possibility that the cigar adapter is not connected properly.	● Remove the cigar adapter and then reconnect it. Also, make sure that it is securely inserted into the cigar socket.
	● Are you using a branched socket?	● Connecting the cigar adapter to a branched socket may cause fire, or malfunction.
	● Are you using the included cigar adapter?	● Do not use any power source other than the included cigar adapter. It may cause fire, electric shock or malfunction.
	● The temperature environment in which this machine can be used may not be available.	● This dash cam can be used with "-20°C to +70°C".
Malfunction	● The system of this machine may be malfunctioning.	● Press the reset button.
There is no file that should have been recorded	● When the storage area of the microSD card reaches the upper limit, the continuous recording file is overwritten from the oldest file.	● If you want to keep the files, we recommend that you back them up regularly.
May restart	● If you connect or disconnect each cable while the power is on, the main body may restart or turn off.	● Do not connect or disconnect the cable while the power is on. It may cause unexpected operation or malfunction.
Can't record	● Is the microSD card inserted in the main body?	● Make sure that the microSD card is inserted in the main body.
	● Is there a microSD card read error?	● Format the microSD card. If formatting does not help, try another microSD card. Alternatively, insert or remove the microSD card again.
Frequent emergency recordings	● The G sensor sensitivity setting may not be correct.	● Change the setting from "G sensor" in the setting menu.
GPS cannot be received	● Are you driving in a place where GPS signals are difficult to receive?	● It may be difficult to receive GPS signals in tunnels or in valleys of buildings.
	● Isn't this dash cam just started?	● It may be difficult to receive GPS signal immediately after starting this unit. Check again after a while.
	● Isn't it an in-vehicle environment where the built-in GPS cannot be received?	● Depending on the model, GPS may be difficult to receive. ● Purchase an optional GPS unit.

FAQ

Problem	Reason	Solution
SD card error occurs	<ul style="list-style-type: none"> ● Do you format the SD card regularly? ● Is the SD card inserted correctly? ● The SD card may be damaged. ● There may be a problem with the SD card. 	<ul style="list-style-type: none"> ● Format the SD card. ● Insert the SD card correctly. ● Replace the SD card. ● Format the SD card on your computer. ● Restart dash cam. <p>※ Please note that formatting the card will erase the saved data.</p>
Cannot format	<ul style="list-style-type: none"> ● There may be a problem with the SD card. 	<ul style="list-style-type: none"> ● Format the SD card on your computer. ● Replace the SD card. <p>※ Please note that formatting the card will erase the saved data.</p>
Screen flickers	<ul style="list-style-type: none"> ● Power supply may be unstable. 	<ul style="list-style-type: none"> ● Use the included cigar power adapter. ● If you are using a branched cigar socket, insert it directly into the vehicle's cigar socket.
	<ul style="list-style-type: none"> ● The connection of each cable may not be connected correctly. 	<ul style="list-style-type: none"> ● Review the connection of each cable.
Rear camera does not display	<ul style="list-style-type: none"> ● The connection of each cable may not be connected correctly. 	<ul style="list-style-type: none"> ● Is the rear camera connected? ● Review the connection of each cable.

Safety Instructions

Please read this manual carefully before operation and keep it for future reference. It will be helpful and avoid safety issues.

WARNING	Do not disassemble or modify this product. Otherwise, it may cause a fire, electric shock or malfunction.
	Keep small accessories out of the reach of children.
	Be sure to use accessories and designated parts. Using non-designated parts may damage the equipment or cause fire, electric shock, or malfunction.
	If this product is damaged or malfunctions, stop using it immediately and consult your dealer. Continued use may cause fire, electric shock or vehicle failure.
	If it interferes with driving, please do not install it. This may cause an accident.
	Be sure to use a fuse of the specified capacity. Using a fuse exceeding the specified capacity may cause fire, smoke, fire or malfunction. Ask the store where you purchased the product to replace or repair the fuse. (Fuse: 2A)
CAUTION	Do not install in places exposed to water, humidity or dust. Otherwise, it may cause a fire, electric shock or malfunction.
	Do not allow water or other objects to enter the inside of the device. Otherwise, it may cause a fire, electric shock or malfunction.
	Regularly check loose screws and loose double-sided tape. Driving obstacles may causes of accidents.

DO NOT ATTEMPT TO SERVICE THE UNIT BY YOURSELF! THE DEVICE WILL BECOME HOT DURING OPERATION. PLEASE AVOID TOUCHING THE LENS DIRECTLY DURING OR AFTER USE.

Product Specifications

Model	F7N
Display	3.16 inch IPS
Power	12V/24V
Aperture	1.5
Battery	Super capacitor
Video Format	Video:MP4 Still image:JPG
Loop recording	1/3/5mins
Recording method	Nomal recording / Emergency recording
Screen View	Front + Rear view / Front view / Rear view
Resolution	Front 3840*2160P, Front 2560*1440P, Front 2160P+Rear 1080P, Front 1440 P+Rear1080P
GPS	Yes
G-sensor	3 Axis G-sensor
Audio	Support sound recording and playback
Micro SD card	MicroSD 8GB-256GB
Record photo reproduction method	Main body display / Computer / Smartphone
Temperature	-20°C~70°C
Warranty period	1 Year

Warranty&Support:

12 months warranty period

If you have any questions about the product, please feel free to contact us. Inquiries will be answered within 6-24 hours of the working day.



LINE



WhatsApp

E-mail: redtiger.cam@gmail.com



Made in China

FCC Warning Statement

Changes or modifications not expressly approved by the party responsible for compliance could void the user's authority to operate the equipment. This equipment has been tested and found to comply with the limits for a Class B digital device, pursuant to Part 15 of the FCC Rules. These limits are designed to provide reasonable protection against harmful interference in a residential installation. This equipment generates uses and can radiate radio frequency energy and, if not installed and used in accordance with the instructions, may cause harmful interference to radio communications. However, there is no guarantee that interference will not occur in a particular installation. If this equipment does cause harmful interference to radio or television reception, which can be determined by turning the equipment off and on, the user is encouraged to try to correct the interference by one or more of the following measures:

- - Reorient or relocate the receiving antenna.
- - Increase the separation between the equipment and receiver.
- - Connect the equipment into an outlet on a circuit different from that to which the receiver is connected.
- - Consult the dealer or an experienced radio/TV technician for help.

This device complies with part 15 of the FCC Rules. Operation is subject to the following two conditions: (1) This device may not cause harmful interference, and (2) this device must accept any interference received, including interference that may cause undesired operation.

RF Exposure Statement

To maintain compliance with FCC's RF Exposure guidelines, This equipment should be installed and operated with minimum distance of 20cm the radiator your body. This device and its antenna(s) must not be co-located or operation in conjunction with any other antenna or transmitter.