

Mella Pro Bluetooth USB Wireless Charger

Input and Output parameters

Input: DC 5V 1A

Output: 3.5W

Instructions for use:

1. Download the Mella desktop app from [Mella.ai/setup](https://mella.ai/setup), and click install after the download is complete.



Available on the
App Store

ANDROID APP ON
Google play

Download from
Windows Store

2. Insert the charging base into the USB port of the computer and open the Mella desktop application.



3. Register and log in to the Mella desktop application account, turn on the Bluetooth switch button in the desktop app

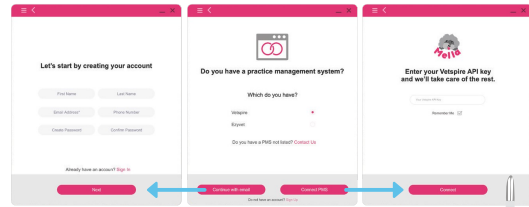

4. Turn on the Mella Pro device. The wireless charging base will automatically search for Mella Pro to establish a connection.

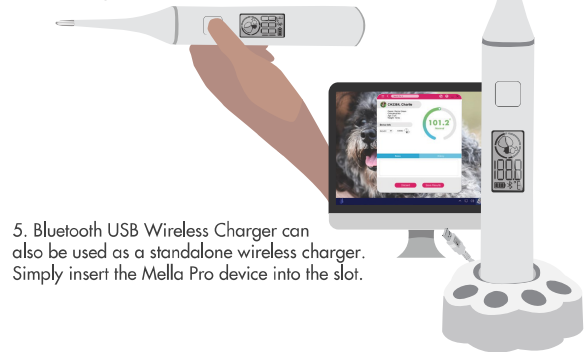

5. Bluetooth USB Wireless Charger can also be used as a standalone wireless charger. Simply insert the Mella Pro device into the slot.

Mella Pro Bluetooth USB Wireless Charger

FCC RF exposure statement: This device complies with Part 15 of the FCC Rules. Operation is subject to the following two conditions: (1) this device may not cause harmful interference, and (2) this device must accept any interference received, including interference that may cause undesired operation. Changes or modifications not expressly approved by the party responsible for compliance could void the user's authority to operate the equipment. This equipment has been tested and found to comply with the limits for a Class B digital device, pursuant to Part 15 of the FCC Rules. These limits are designed to provide reasonable protection against harmful interference in a residential installation. This equipment generates, uses and can radiate radio frequency energy and, if not installed and used in accordance with the instructions, may cause harmful interference to radio communications. However, there is no guarantee that interference will not occur in a particular installation. If this equipment does cause harmful interference to radio or television reception, which can be determined by turning the equipment off and on, the user is encouraged to try to correct the interference by one or more of the following measures:-- Reorient or relocate the receiving antenna.-- Increase the separation between the equipment and receiver.-- Connect the equipment into an outlet on a circuit different from that to which the receiver is connected.-- Consult the dealer or an experienced radio/TV technician for help. To maintain compliance with FCC's RF Exposure guidelines, This equipment should be installed and operated with minimum distance between 20cm the radiator your body.

