

# Smart Electronic Lock

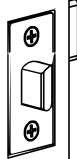

Before Installing the Lock, Please Check Door Jamb and Door Preparation.

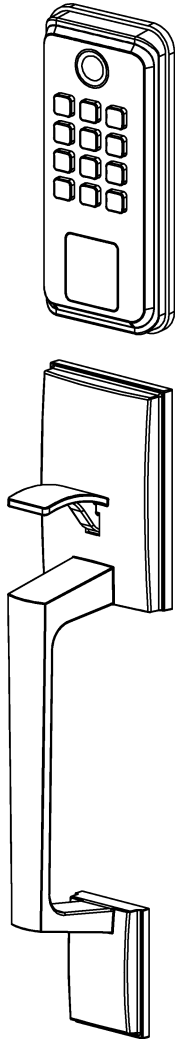
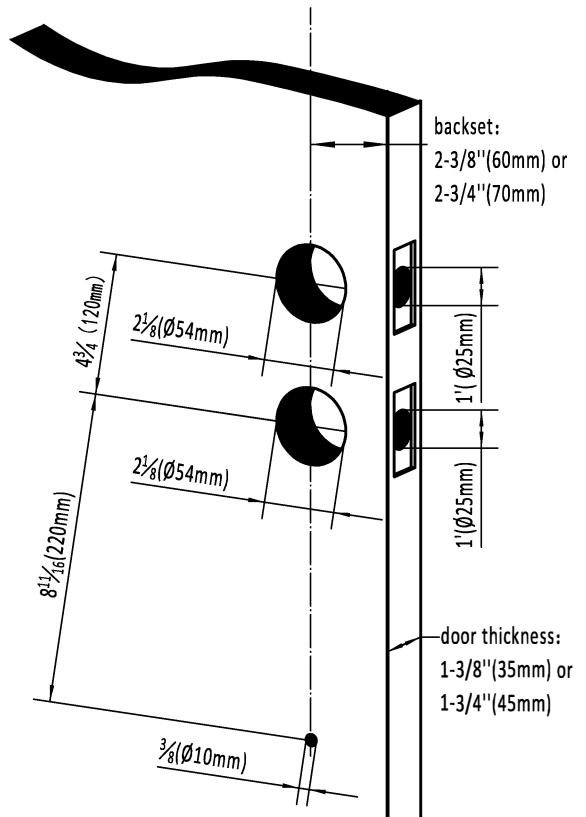

# INSTALLATION INSTRUCTIONS OF KEYPAD DIGITAL DEADBOLT

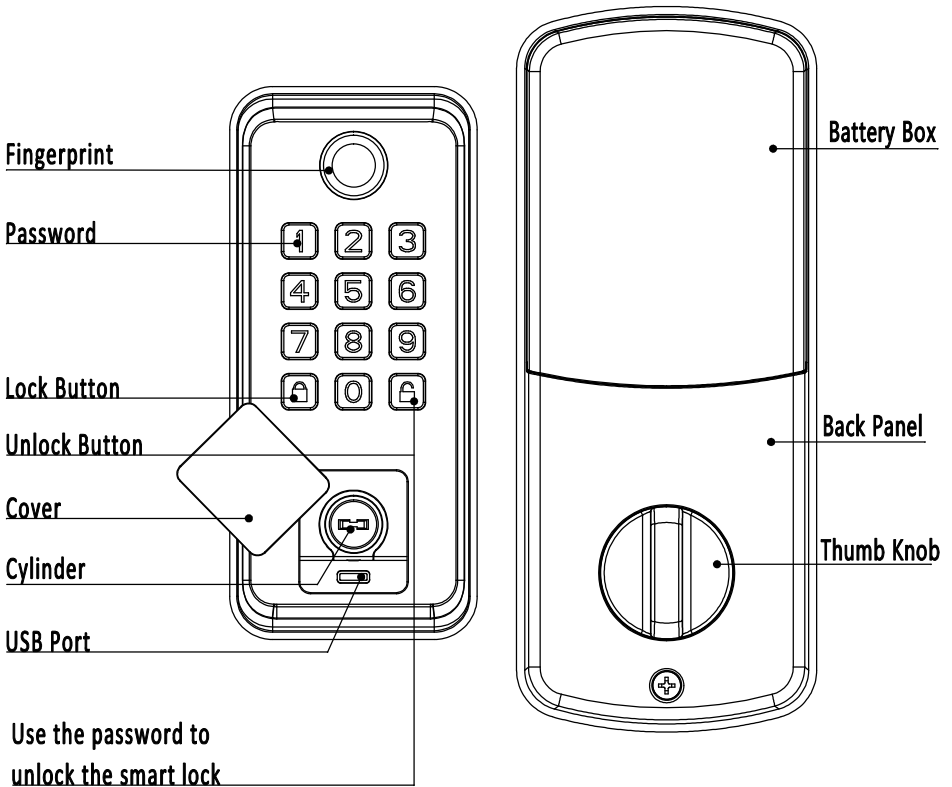

## Tool Required:

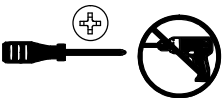

Do not use an electric screwdriver during installation.

## Important:



Do not load batteries until lock is completely installed.

Thank you for purchasing our products. Please review this manual thoroughly before operating your device. All pictures in this manual are for illustration purpose only.

Actual product may vary due to product upgrade.

INCLUDED IN THE BOX

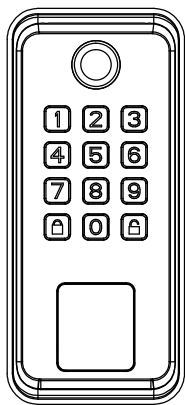

1 Pcs  
Front Panel

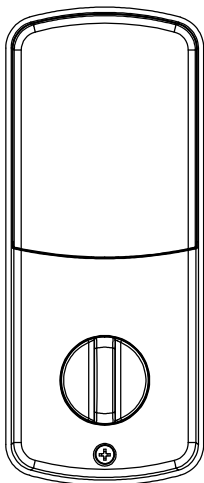

1 Pcs  
Back Panel

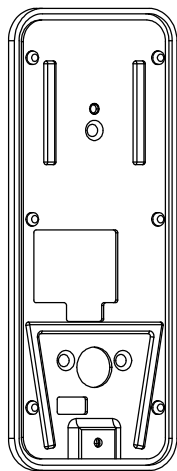

1 Pcs  
Mounting Plate

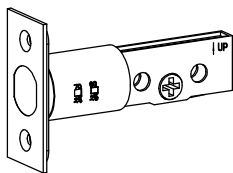

1 Pcs  
Latch

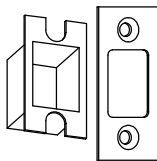

1 Pcs  
Strike Plate

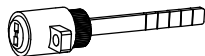

1 Pcs  
Cylinder



2 Pcs  
Backup Keys



20mm

5 Pcs  
Screw A



20mm

1 Pcs  
Screw B



6mm

1 Pcs  
Screw C



10mm

1 Pcs  
Screw D



45mm

3 Pcs  
Screw E



3 Pcs  
Solenoid F

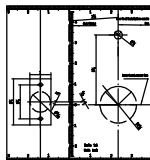

1 Pcs  
Opening Hole Drawing



1 Pcs  
Lock Manual

# PREPARING TO INSTALL

Open to Left

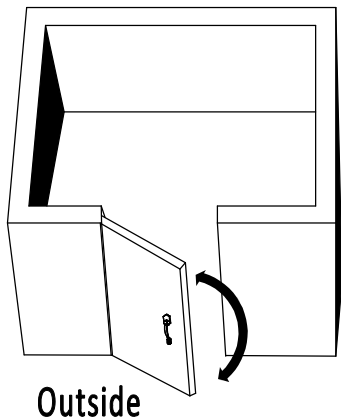

Open to Right

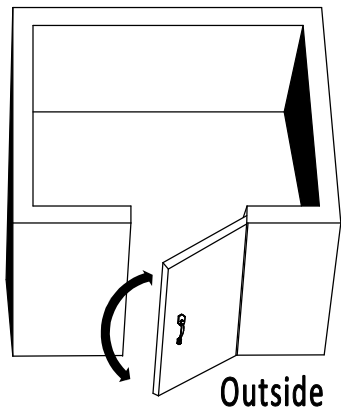

Disassemble your existing deadbolt from the door.

## STEP1 PREPARATION

Check the door's dimensions

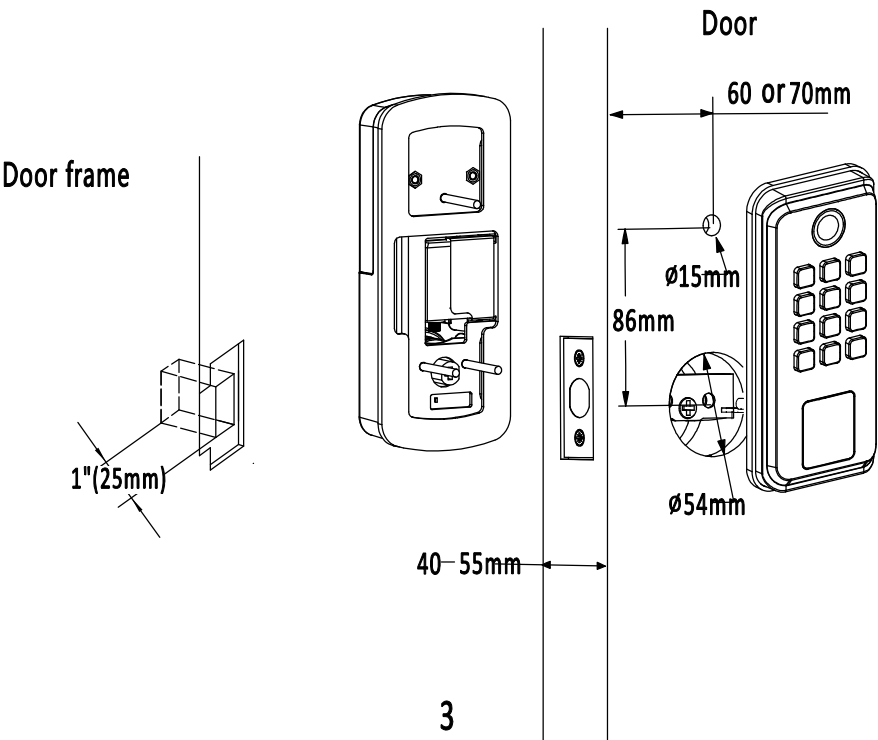

STEP2 INSTALLING LATCH AND STRIKE PLATE

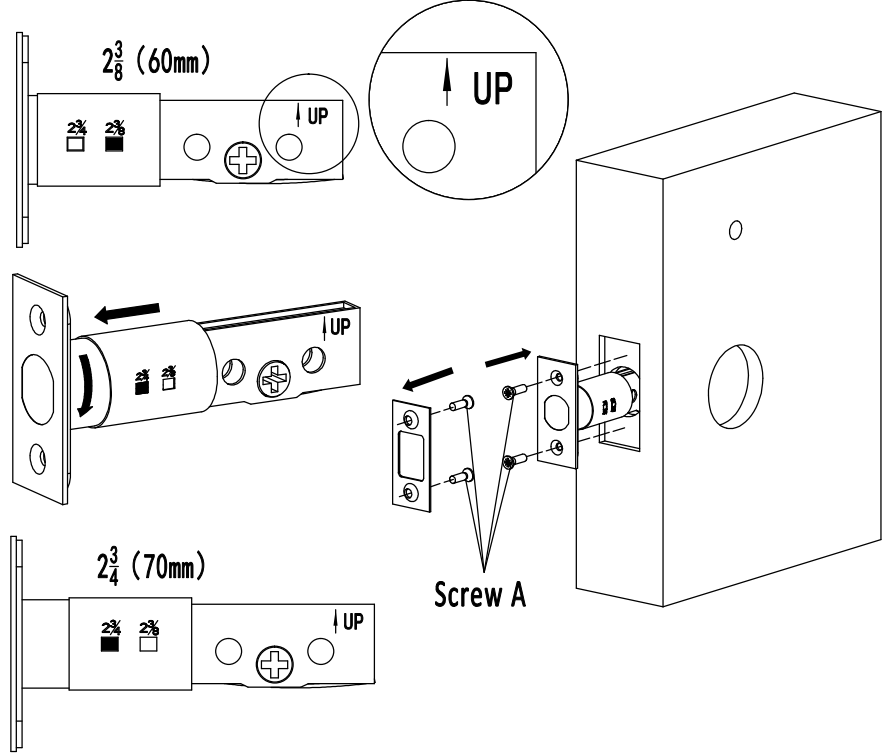

STEP3 PREPARING KEYPAD

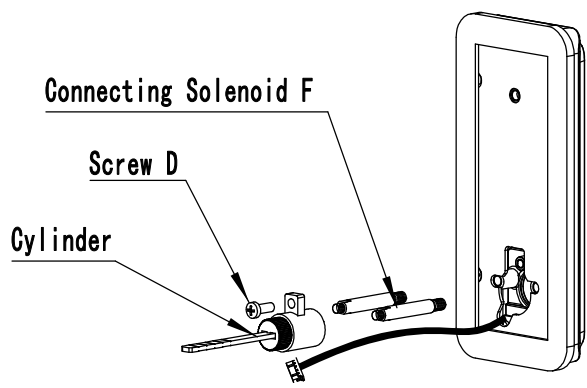

# Remark: There are 3 ways to install keypad

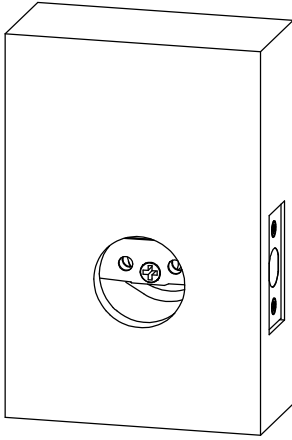

1.No need to drill holes, just install keypad directly.

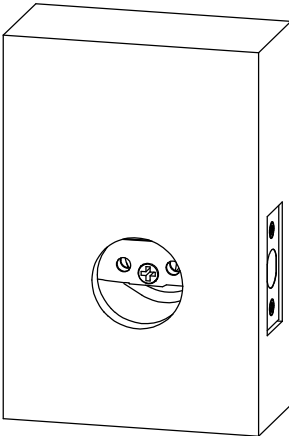
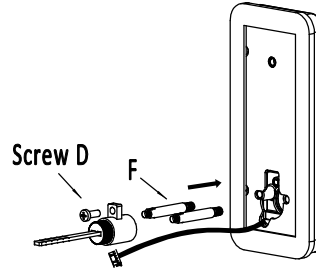

2.No need to drill holes, reinforced with 3M double-sided sticker.(Warm Notice: double-sided sticker is difficult to tear down and clean up after the paste, so please confirm the installation without problems before stick it on.)

3M double-sided sticker

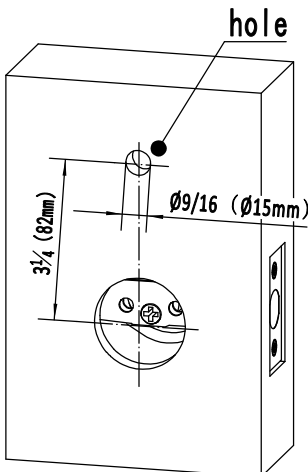
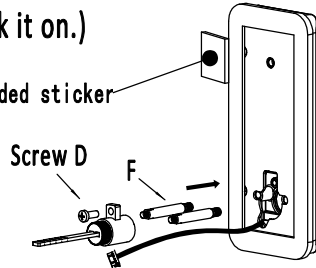

3.Need to drill hole on the door, reinforced with F Screw.

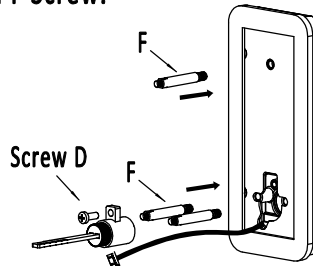

STEP4 INSTALLING KEYPAD

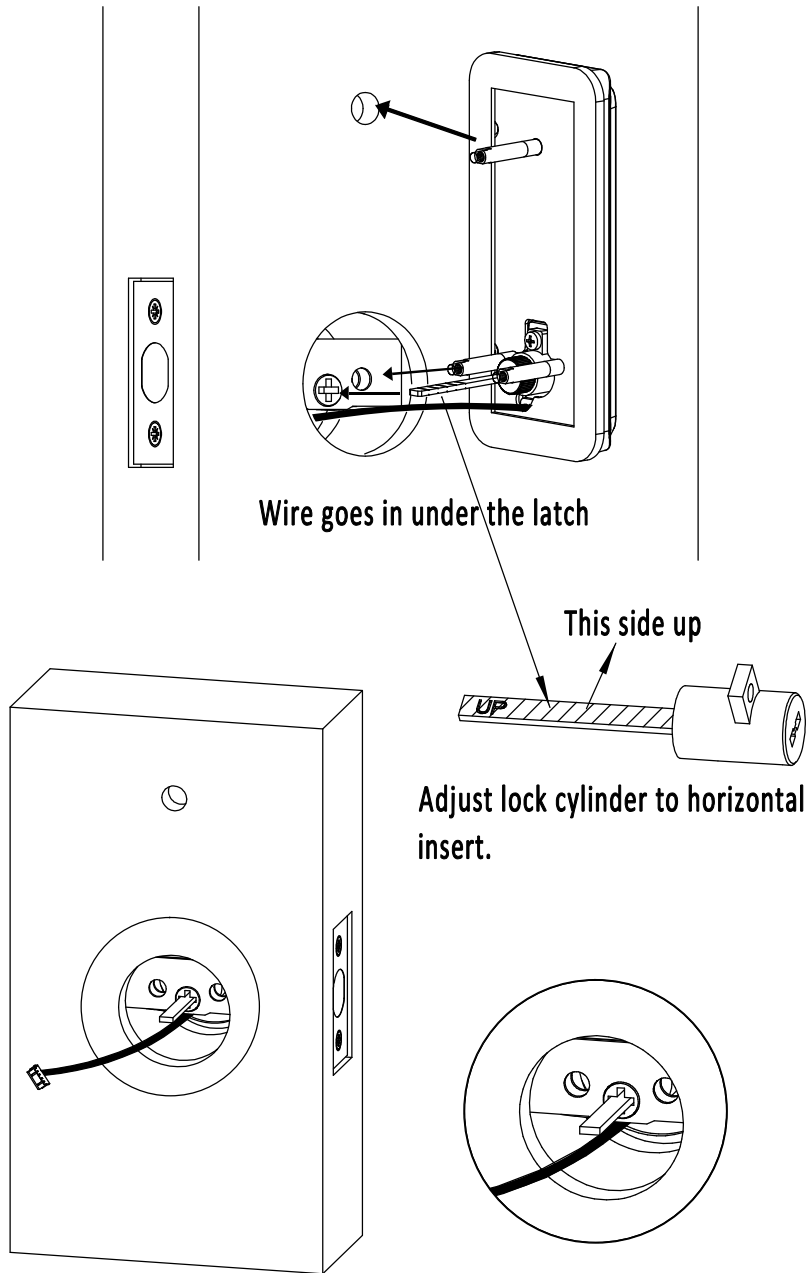

## STEP5 INSTALLING MOUNTING PLATE

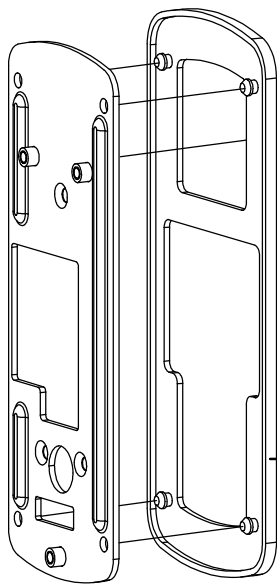

3M double-sided sticker

No drill holes, you can reinforced with 3M double-sided sticker. (Warm Notice: double-sided sticker is difficult to tear down and clean up after the paste, so please confirm the installation without problems before stick it on.)

Silicone Seal

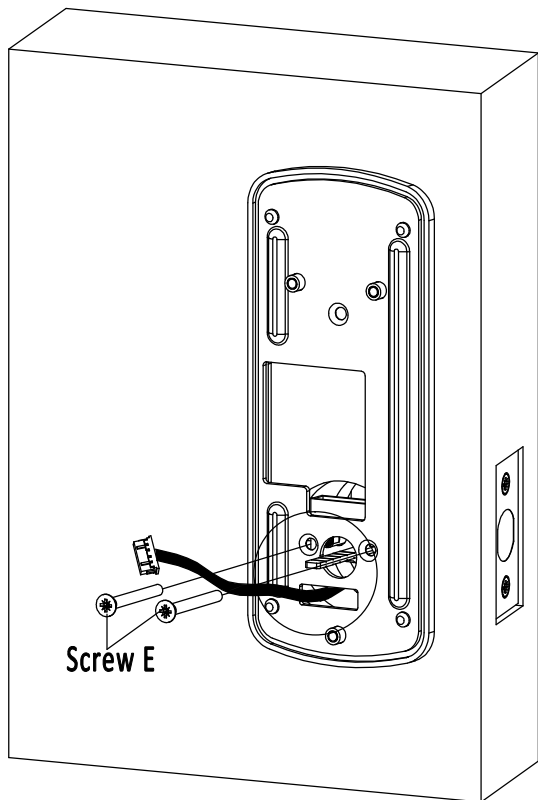

Route the wire through the hole

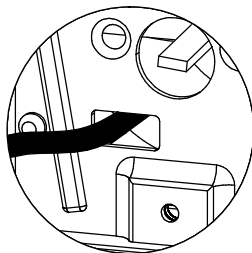

Turn the knob to test lock & unlock functions before fully tighten the screws  
Make sure the bolt extends and retracts smoothly.  
Do not over tighten the screws



# STEP6 PREPARING INTERIOR ASSEMBLY

Make sure the switch and the knob are set to correct door handing

## Open to Left

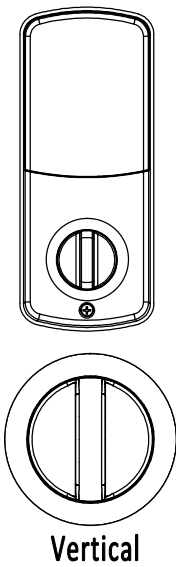
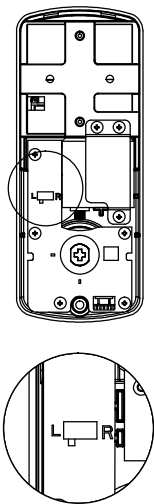
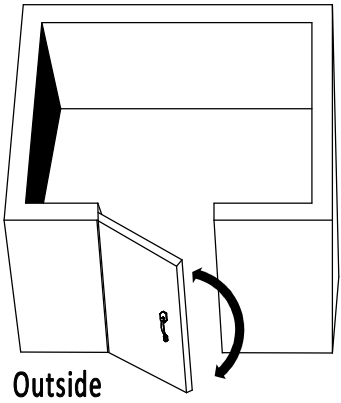

Vertical

## Open to Right

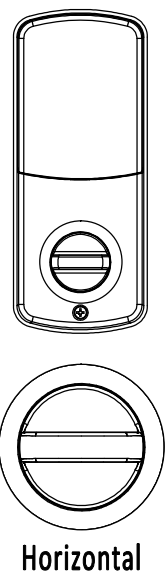
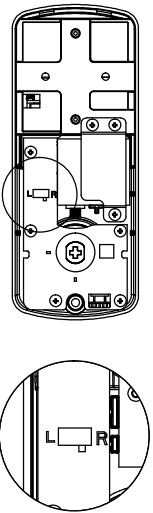
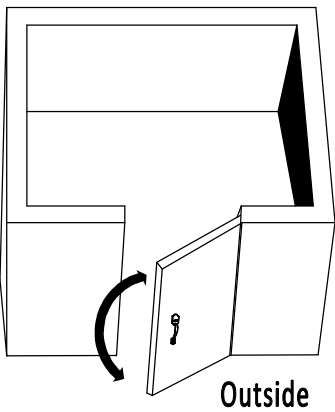

Horizontal

STEP7 CONNECT THE CABLE

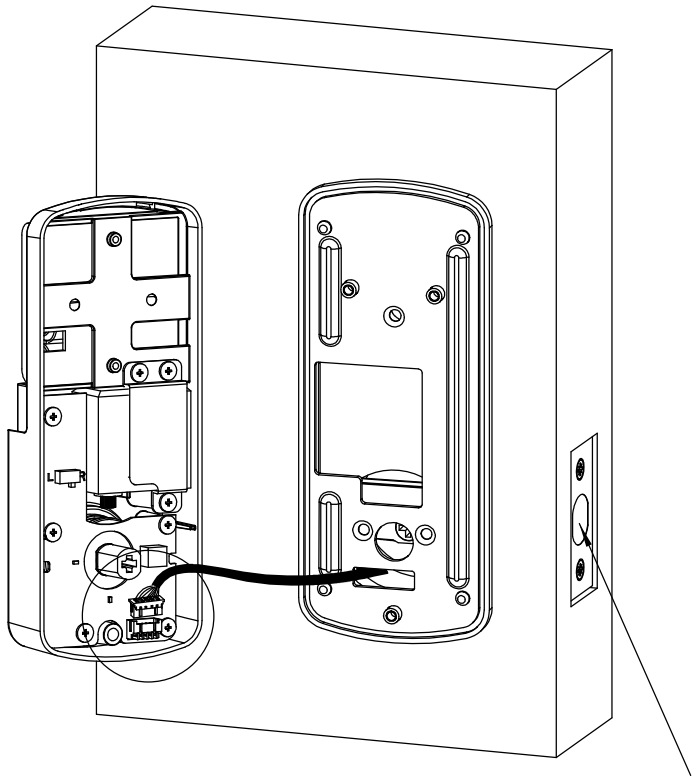

Bolt is retracted

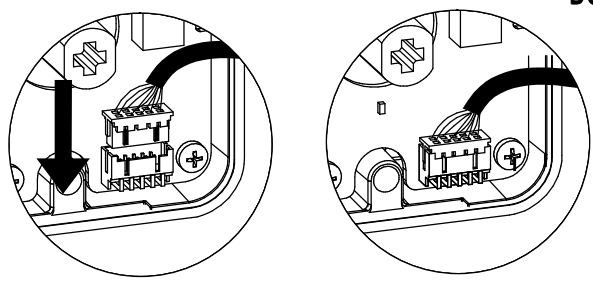

# STEP8 INSTALLING INTERIOR ASSEMBLY AND TESTING

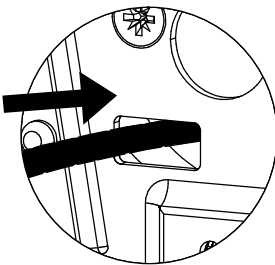
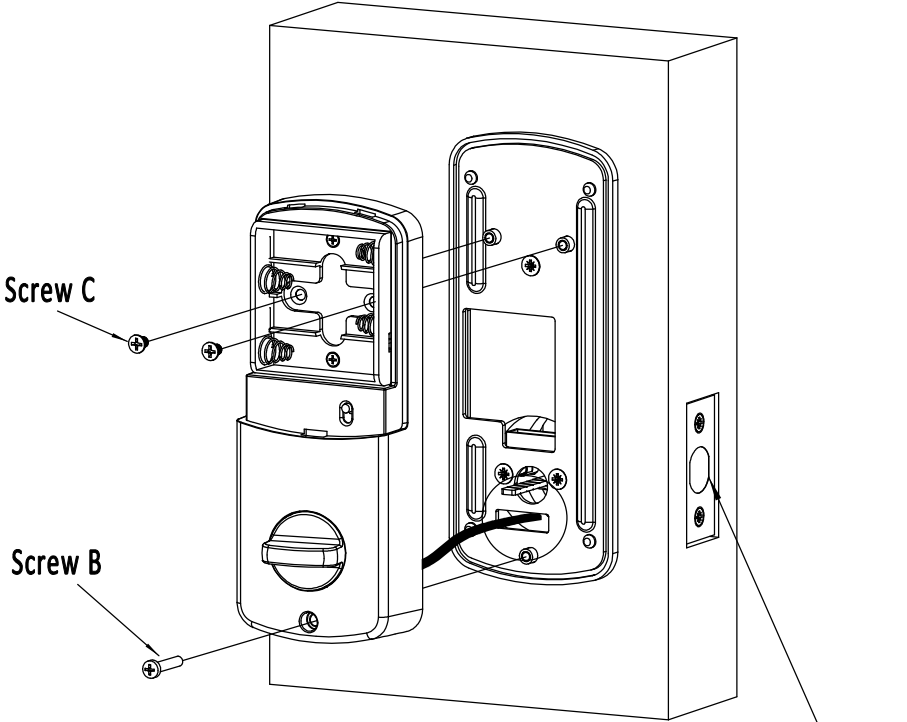

Push extra wire back into door hole thru this hole

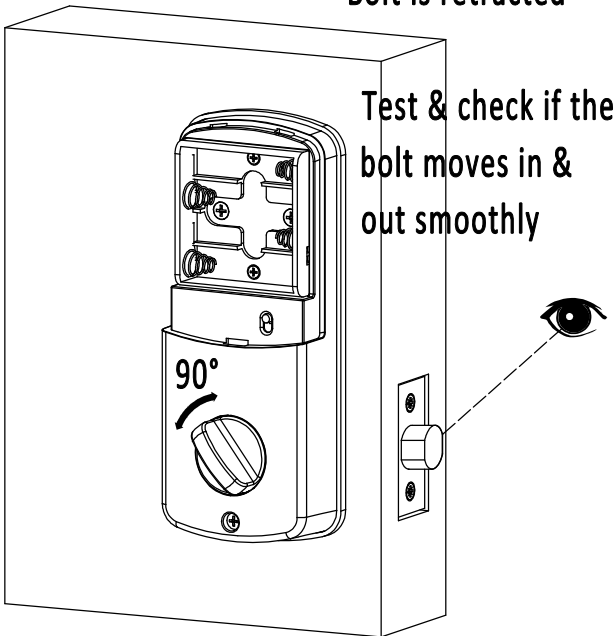

# STEP9 BACK UP KEY TESTING

Press the bottom side of the cover

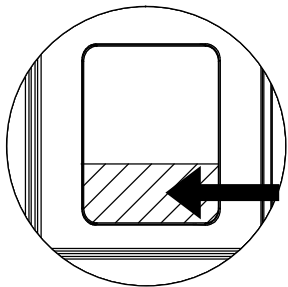
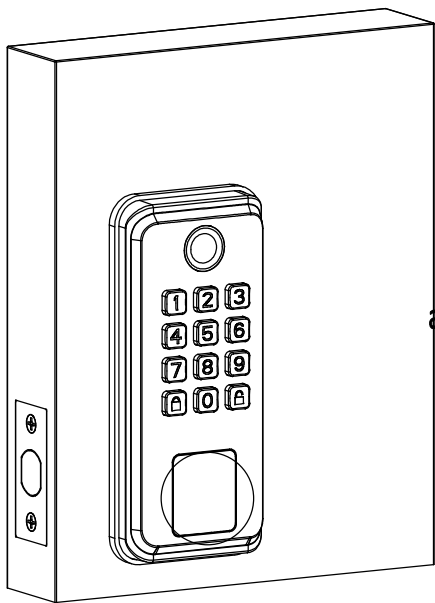

anti-clockwise rotate 120 degree

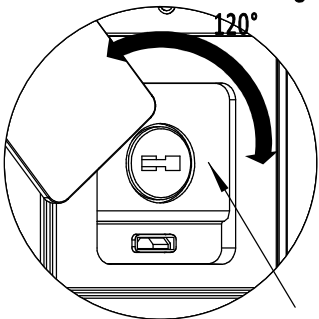

Emergency power

Test & check if the bolt moves in & out smoothly

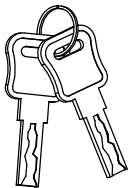
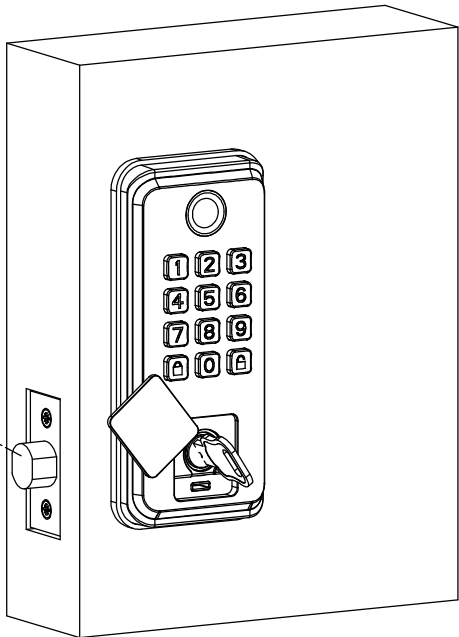

STEP10 INSTALLING BATTERIES & COVER

AA alkaline batteries

RESET button

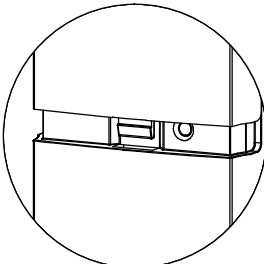
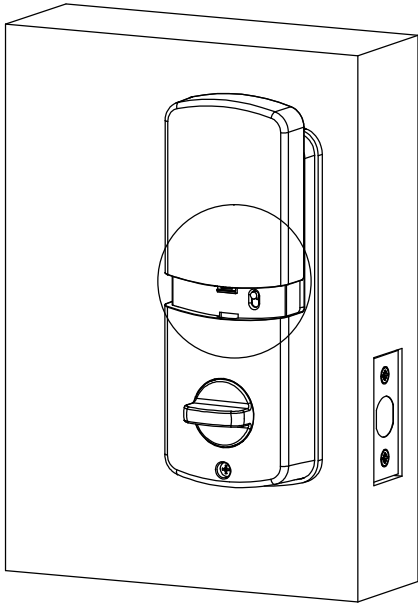
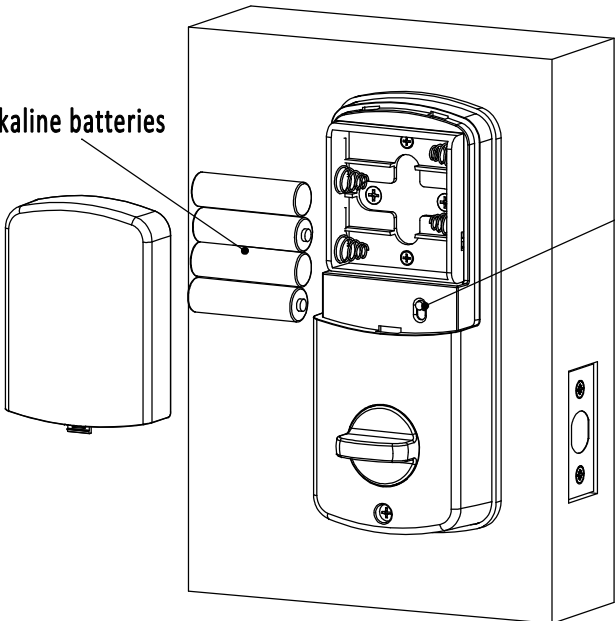

Slide the cover on

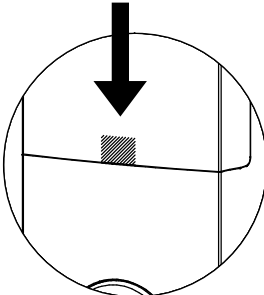

# INSTALLATION INSTRUCTIONS OF HANDLESET

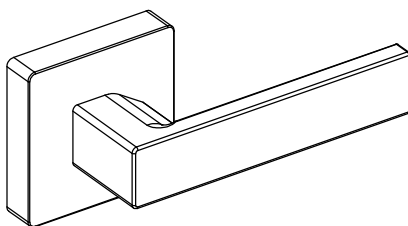
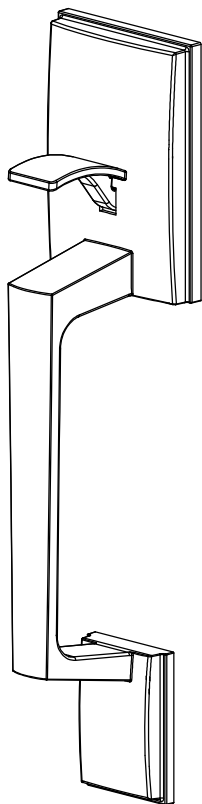

## You Will Need

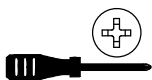

**Screwdriver**

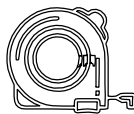

**Tape measure**

Thank you for purchasing our products. Please review this manual thoroughly before operating your device. All pictures in this manual are for illustration purpose only. Actual product may vary due to product upgrade.

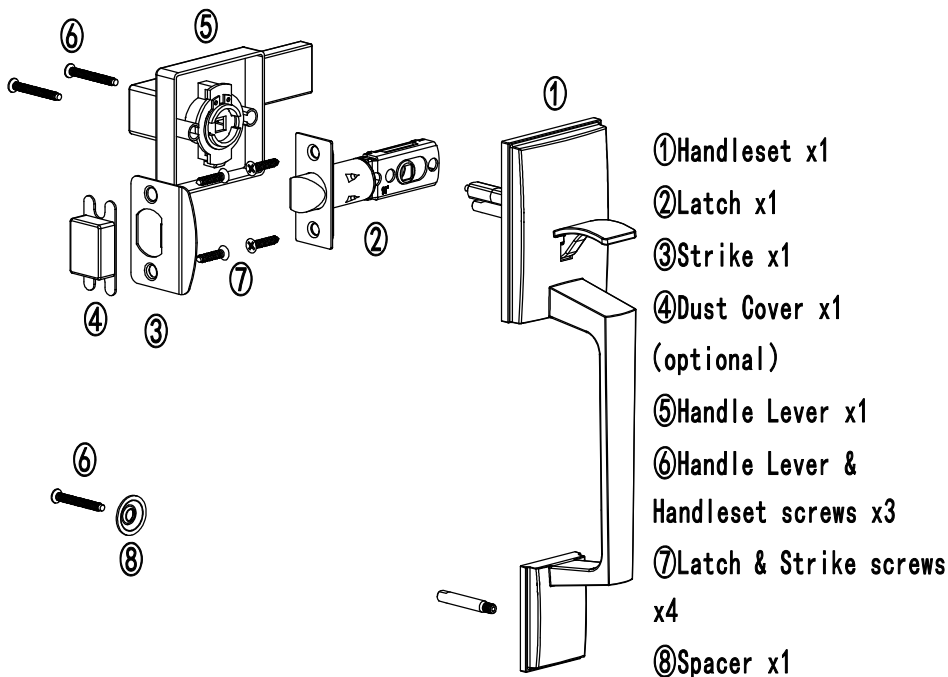

1. Prepare the door and check dimensions

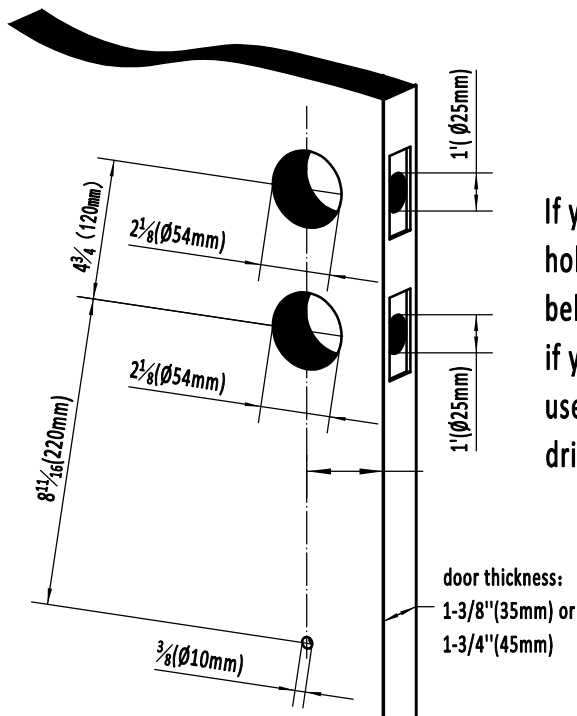

If your door already has the holes shown in the picture below, proceed to the next step, if your door does not have holes, use the mounting template to drill a new hole.

## 2.Latch backset adjustment

A. If the backset of your door is 2-3/8"(60mm),  
no need to adjust the latch

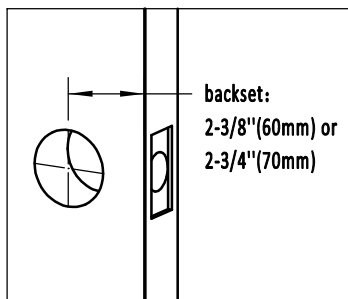
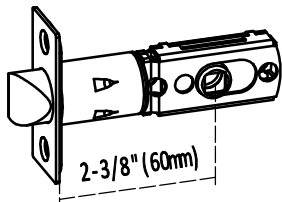

B.If the backset of your door is  
2-3/4"(70mm), please adjust the latch.

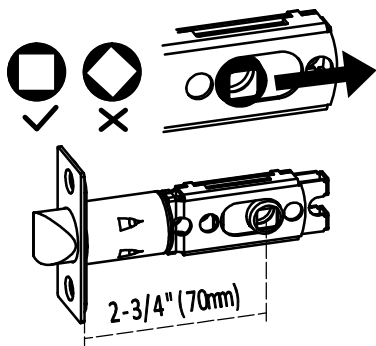

Backset is the distance from the door edge to the center of the hole in the door. The latch is provided with adjustable design which can fit either 2-3/8"(60mm) or 2-3/4"(70mm) backset.

## 3.Install latch and strike

**Door frame**  
Note: Make sure the  
hole in door frame is  
drilled a minimum of  
1" (25mm) deep.

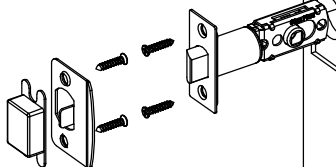
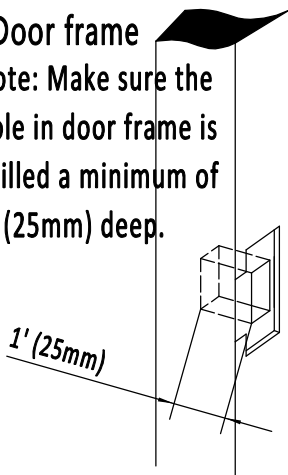

**Door**  
Note:The latch should  
be aligned with the  
chiseled properly.

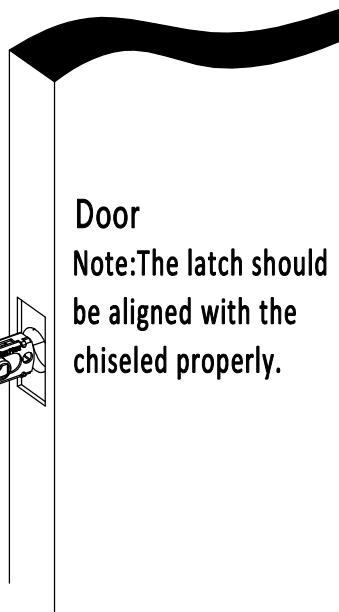



## 4 .Install Handleset

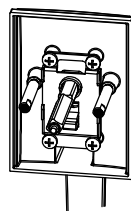
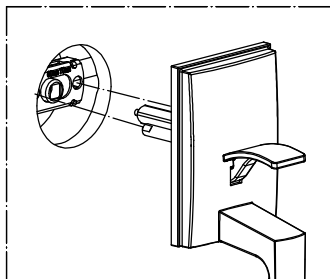
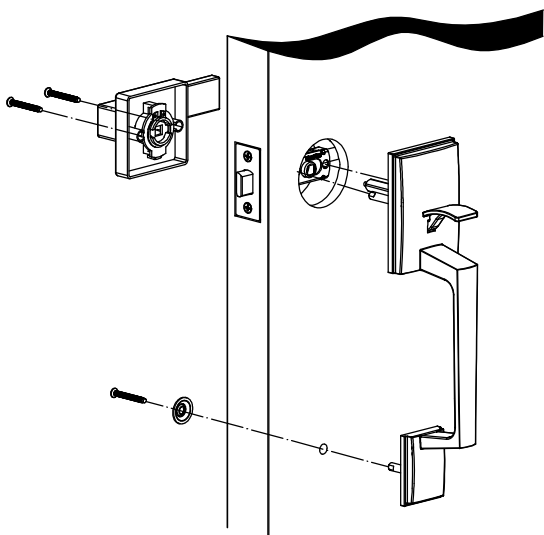

The base of spindle must be rotated aligning to the hole.

## 5.Install Handle Lever

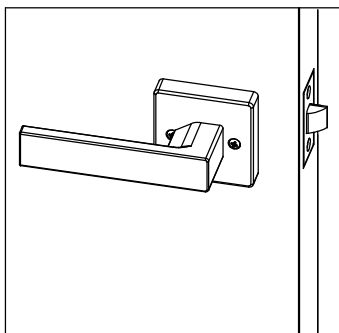
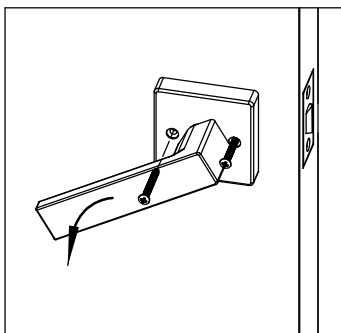

Test the Handleset after installation. Keep the door open, retract the latch by pressing knob from outside and pushing the lever from inside of the door to test if the Handleset works smoothly.

# Operation by APP via Bluetooth

## Part 1 Add lock

©Download and install **TTLock** from Google Play or APP Store



Google Play



APP Store

©Register account with phone number or e-mail and login

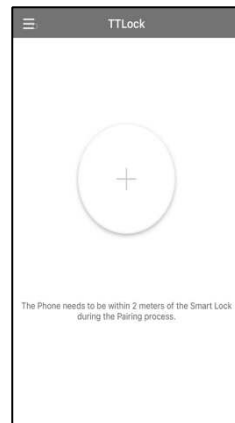
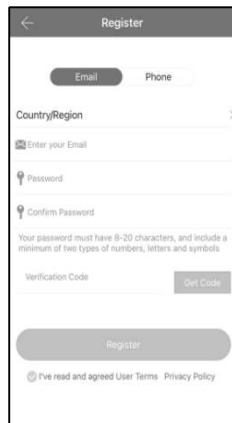
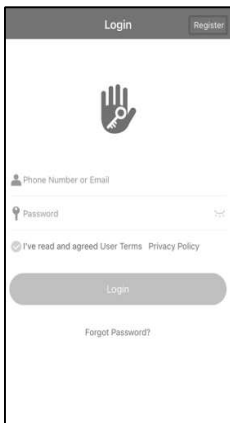

©Add your lock on APP

Ensure Bluetooth is enabled on your smartphone and stay 2 meters within the lock, touch the keypad screen to activate the lock when watching.

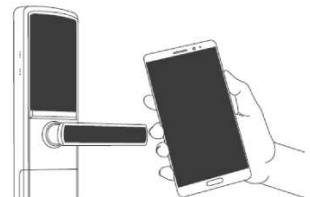

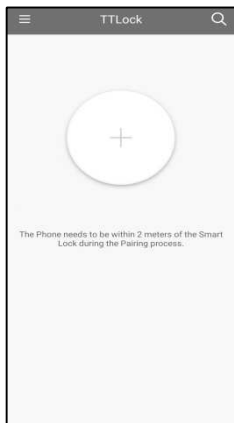

Click '+' in the center

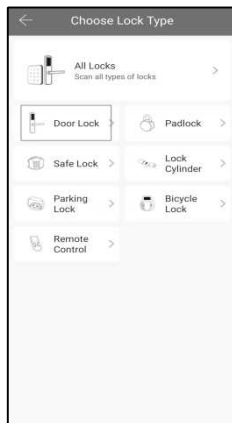

Select 'Door Lock'

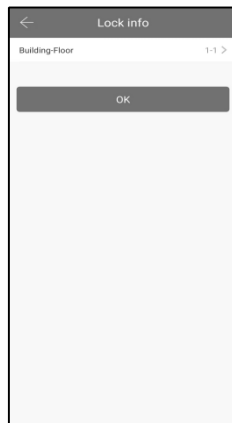

Click 'OK'



Touch keypad and click 'Next'



Click '+'



Name your lock, and click 'OK'

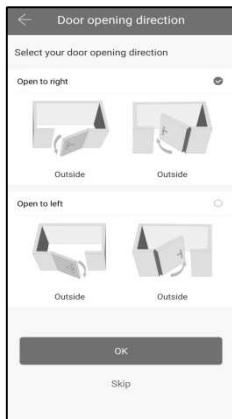

Choose door open directio

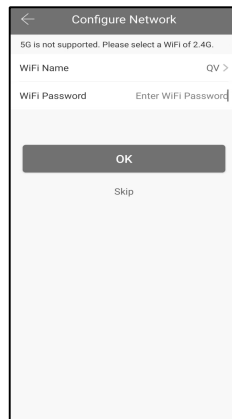

Configure Network, and click 'OK'

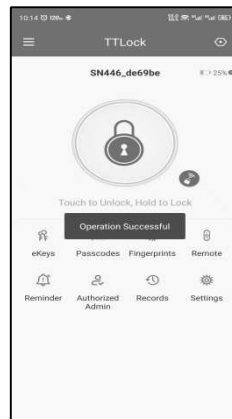

Add completed

**Remarks:** Once the lock is non-addable state or can't connect to your Bluetooth, please reset your smart lock and re-add it as follow.

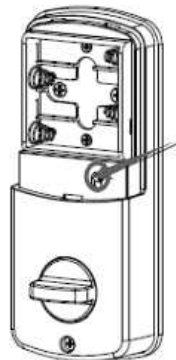

- ① Remove battery cover out
- ② Hold the reset button for 5 seconds

## Part 2    Unlock/lock by APP via Bluetooth

◎ Unlock by touching the lock button, it will pop up 'unlocked'

◎ Lock by long-pressing the lock button, it will pop up 'locked'

If you want remote control, you need to connect to the gateway.

Remarks: Once the lock/unlock direction shows reversed when operating, please switch the toggle button to correct direction and re-install it.

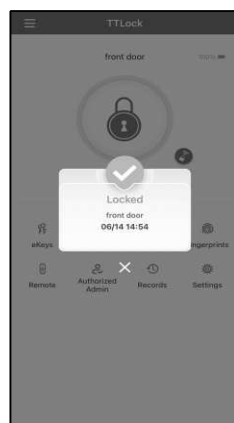
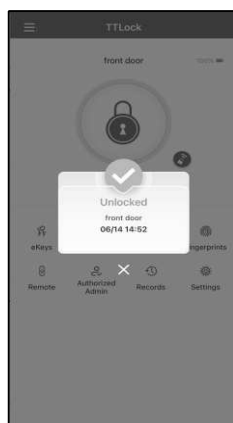

Part 3     Auto-lock setting

**Remarks:** Auto-lock is setting up only by the program, but couldn't be used to determine if your door is locked. And please stay your phone connection to your lock via Bluetooth during setting process.

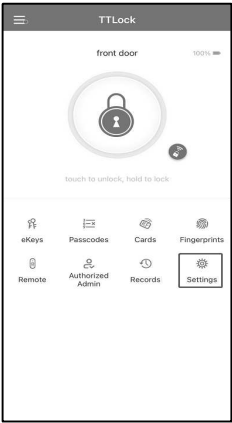

Click 'Settings'



Click 'Auto Lock'

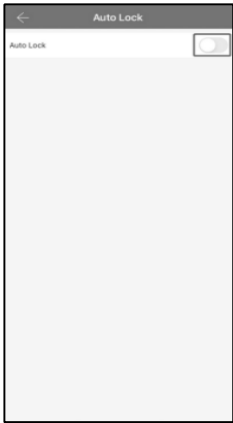

Activate Auto Lock



Set period you need to set



Or enter your time period



1-900s are available



Click 'Save'

## Part 4    Share APP operation to your family/guests(ekey)

eKey is a function for you to authorize the rights to your family members and guests to unlock/lock your door by the same APP.

eKey can be authorized to MAX. 20 smart phone users.

©Download TTLock app and register a new account on new smart phone of family or guests.

©Click 'eKeys' on the APP screen with admin account(The first account to add lock).

©Select Time, Permanent, One-time, Recurring eKey by

yourself, then input Recipient account and name it.

©Select time period if necessary, then click 'send'.

©Refresh by pulling down on the APP screen with new smart phone APP, the smart lock will show up on the APP screen.

**Remarks:** Admin account can manage all guest accounts by clicking 'eKeys' on APP screen.

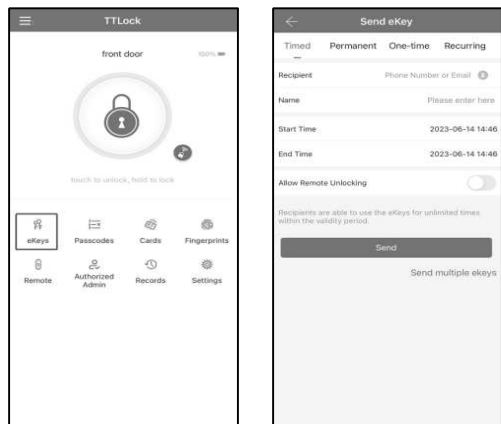

## Part 5     Records

It records all the time and manner of the smart lock and you can check the 24/7 history anytime and anywhere.

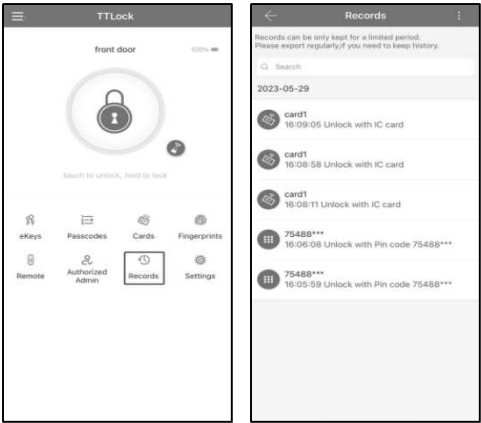

Click 'Records'

View 'Records'

## Part 6     Lock Sound

The original setting for this smart lock is Lock Sound On, you can close it if you want.

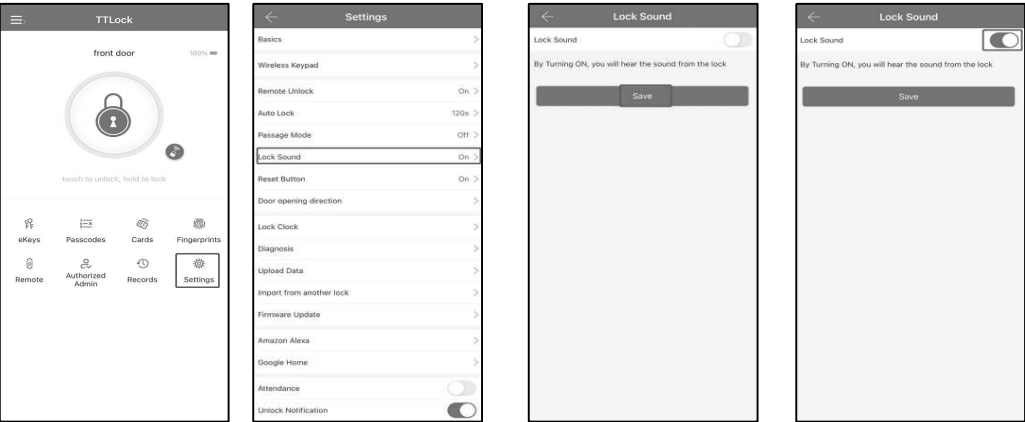

Click 'Settings'

Click 'Lock Sound'

Click button turns gray

Click 'Save'

**Remark:** Please stay your phone connection to your lock via Bluetooth during setting process.

# Operation by keypad

## Part 1 Generate Passcode

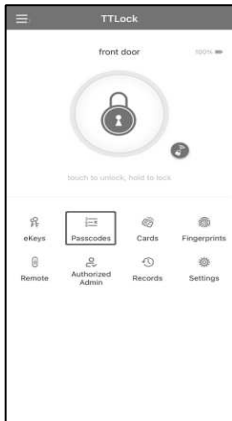

Click 'Passcode' on APP

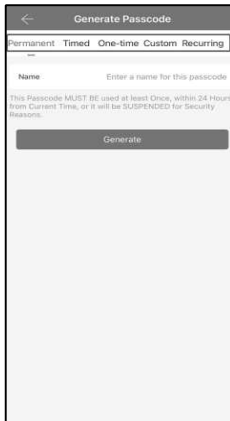

Select Passcode type



Passcode generated

## Part 2 unlock/lock by keypad

©Unlock by inputting Passcode, then press unlock button

©Lock by long-pressing lock button

**Remark:** For security, this smart lock supports Virtual Passcode

Add any digit in front of or back of Passcode. e.g. Your Passcode is 12345678, you can unlock by 512345678 or 1234567802.

## Part 3 Manage Passcode

Admin account can manage all Passcodes by clicking 'Passcodes' on APP.



# Operation by Fingerprint

Please make sure whether your lock has fingerprint function or not before operation. Fingerprint can be used to unlock your door, but can not be used to lock your door.

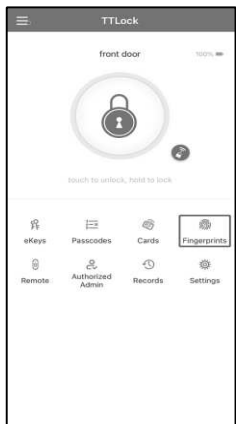

Click 'Fingerprints' on APP



Click 'Add Fingerprint'

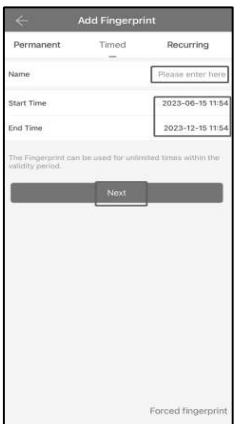

Name it and select time period

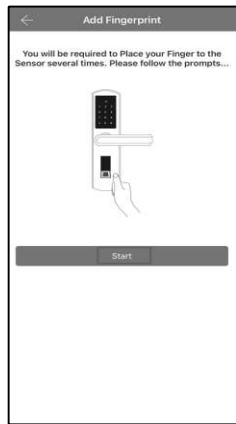

Click 'start'



Press your fingerprint 4 times



add completed

**Remark:** Please stay your phone close to your lock via Bluetooth during setting process.

# Warranty

## Warranty

You will enjoy 100% satisfaction service with your smart lock. We provide 30days full refund and 60 days replacement with any product issue. E-mail to us with your order information, you will get more.

Customer Service:

E-Mail: [sevekolock@outlook.com](mailto:sevekolock@outlook.com)

Powered by Seveko Smart

This device complies with part 15 of the FCC Rules. Operation is subject to the following two conditions: (1) This device may not cause harmful interference, and (2) this device must accept any interference received, including interference that may cause undesired operation.

Any Changes or modifications not expressly approved by the party responsible for compliance could void the user's authority to operate the equipment.

**Note:** This equipment has been tested and found to comply with the limits for a Class B digital device, pursuant to part 15 of the FCC Rules. These limits are designed to provide reasonable protection against harmful interference in a residential installation. This equipment generates uses and can radiate radio frequency energy and, if not installed and used in accordance with the instructions, may cause harmful interference to radio communications. However, there is no guarantee that interference will not occur in a particular installation. If this equipment does cause harmful interference to radio or television reception, which can be determined by turning the equipment off and on, the user is encouraged to try to correct the interference by one or more of the following measures:

- Reorient or relocate the receiving antenna.
- Increase the separation between the equipment and receiver.
- Connect the equipment into an outlet on a circuit different from that to which the receiver is connected.
- Consult the dealer or an experienced radio/TV technician for help.

#### FCC Radiation Exposure statement

The device has been evaluatec to meel general RF exposure requirement. The device can be used in portable exposure condition without restriction.