

LINK EVERYTHING FOR CAT'S LIFE

智 联 万 物 为 猫 而 生



Website : www.catlinks.cn

Brand owner : Shanghai Lianchong Intelligent Co.,Ltd

Add : No. 800, Naxian Road, Pudong New District, Shanghai



CATLINK ONE

USER MANUAL FOR PET AI FEEDER

*Please read the Manual carefully
before use and keep it properly.

*This version is the original version, and the
latest version is subject to the electronic version
sent by the customer service.

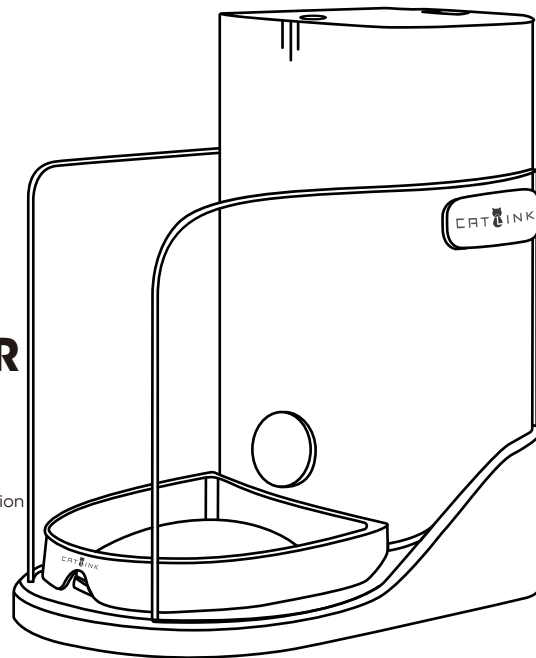

Note: Please handle with care.

Weighing sensor is installed at the bottom
of the tray of bowl to ensure data accuracy and extend the service life.

v2-20200924

User Manual

Contents

Packing List & Product Structure 03

Indicator Status 04

Unpacking Operation..... 05

Wi-Fi Connection 06

Zeroing the Weight 07

Button Operation & Use of Backup Power..... 08

Use of Pendant & Desiccant 09

Cleaning and Other Notices..... 10

Product Specification..... 11

Warranty Card..... 13

Packing List & Product Structure

Packing List

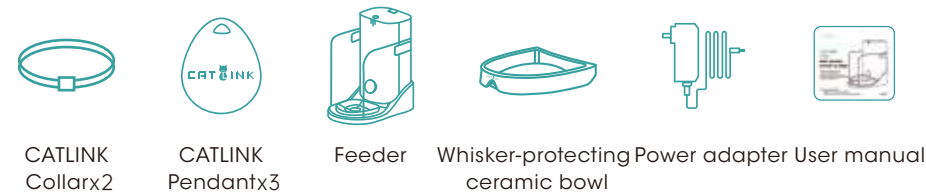

Product structure

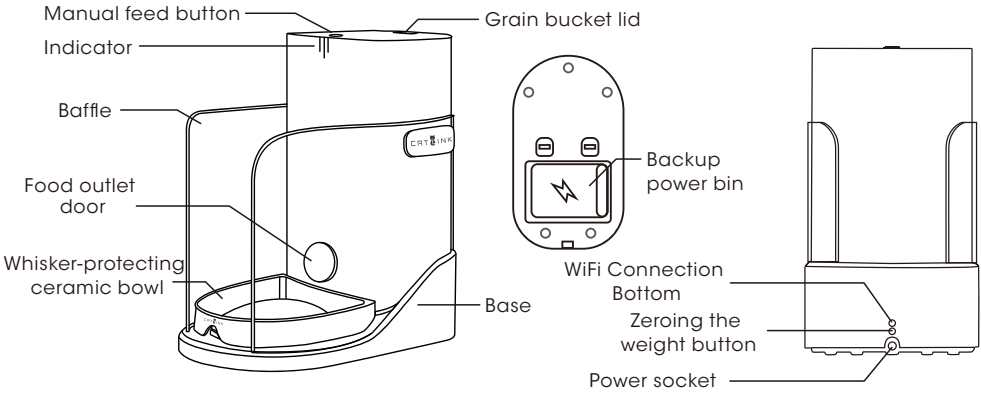

Indicator Status

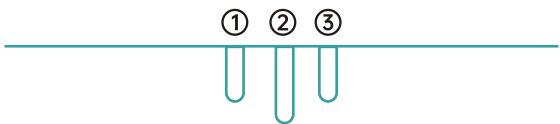

Indicator	Status
Three lights flashing blue slowly	Standby
Three lights flashing white slowly	Standby (Manual feeding button is locked)
Three lights are always blue	Feeding
Three lights are always white	Feeding (Manual feeding button is locked)
Three lights flashing green quickly	WiFi Connecting
Three lights flashing blue quickly	Zeroing/calibration the weight
Three lights flashing red slowly	Insufficient food
Three lights are always yellow	Disconnected from WIFI
Light 1 flashing red quickly	Weighing error
Light 2 flashing red quickly	Feeding error
Light 3 flashing red quickly	Food outlet door error

Unpacking Operation

1. Check if parts are complete as per the [Packing List].
2. Put the product properly as per [Product Structure].
3. Make sure to use the power adapter attached. Automatically turn on after power on.
4. Refer to [Wi-Fi Connection] for network configuration.
5. Ensure that there are no objects in the food bowl and carry out [Zeroing the Weight].
6. Add sufficient foods into the food bucket and make sure it is below the Max scale.
7. The Product is available for use after finishing the steps above.

Wi-Fi Connection



1. Search "CATLINK" in mobile phone application market, download and install CATLINK APP, or scan the right QR code for download:
2. Connect the 2.4GHz WiFi. The 5GHz frequency range, as well as the WiFi requiring special authentication in hotel and airport, is not supported yet.
* WiFi name should not contain Chinese, space or other special characters to avoid affecting the Wi-Fi connection.
3. Open CATLINK APP to register and login. Find and click "Add device" -> "Catlink Feeder" and follow the tips.
* Please authorize the location information. GPS should be enabled for Android mobile phone.
4. Long press the WiFi connection button of feeder, release it when hearing the "Beep" sound and indicator is flickering in green.
* Keep the product close to router as much as possible and make sure it is powered on.



5. Click "Next" on CATLINK APP, enter WiFi password, click "Next" and wait for success of Wi-Fi connection.
* For any connection failure, please repeat the operation and check if WiFi password is entered correctly.
For any unsmooth connection of some Android mobile phone, please use other mobile phones for Wi-Fi connection if possible and when it succeeds, switch to your mobile phone for normal use. If connection fails after correct operation for multiple times, please contact the after-sales service.
6. When CATLINK APP prompts success connection, scan the QR code on the side of the Feeder for binding.
7. After completing the above steps, APP related functions can be used normally.

Zeroing the Weight

1. Empty bowl and make sure there is no object.

2. Put the bowl properly.

*Weighing sensor is installed at the bottom of the tray of bowl. Please handle it gently to keep data correct and prolong the service life.

3. Long press the zeroing the weight button and release it when hearing the "Beep" sound and indicator is flickering in blue.

*It is recommended to use the CATLINK APP to do zeroing the weight. The weight data is available on the app. When the weighing data is displayed as 0, on the APP the weight reset is done.

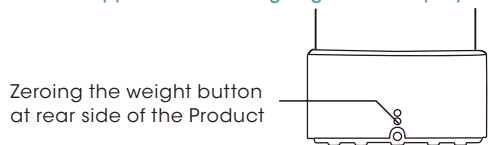

4. When steps above are finished, zeroing the weight is done.

Button Operation

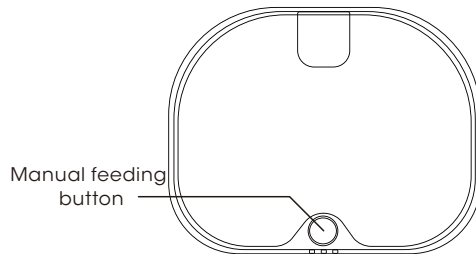

• **1-grid feeding:** Short press the manual feeding button and release it.

• **Continuous feeding:** Long press manual feeding button to feed continuously and stop feeding after release.

• **Lock:** Press manual feeding button for 3 times in succession to lock the manual feeding button, and then press it for 3 times again to unlock.

Use of backup power

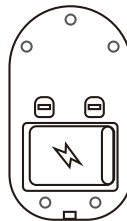

1. Open the backup power bin at bottom of the Feeder.

2. Connect a suitable size power bank to the USB port of the feeder, put it in the bin and close the cover.

*It is recommended to use the power bank without [power-on confirmation button] with capacity of 10,000 mA or higher, in order to ensure normal use of backup power.

3. It will automatically switch to backup power when main power supply is cut off.

Use of Pendant



Pendant contains a pet-ID-chip.

*Please follow the instructions of CATLINK APP.

*The collar can be changed according to the cat's condition.

Use of Desiccant

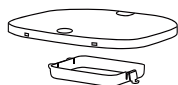

干燥剂盒

1. Desiccant bin is installed at the upper cover of food bucket.

2. It is recommended to replace the desiccant regularly.

* It is recommended to refer to the CATLINK APP desiccant replacement prompt function.

Cleaning and Other Notices

Notice

1. Power off and shut down (including main and backup power)
2. Washable parts: Baffle, upper cover of food bucket, desiccant bin, liner of food bucket and ceramic bowl
 - * Make sure to wipe the parts with dry tissue after washing with water
3. Parts that can only be wiped with wet wipes: Exterior and interior of base (including food feeding channel)
 - * Contains electronic components, do not wash directly

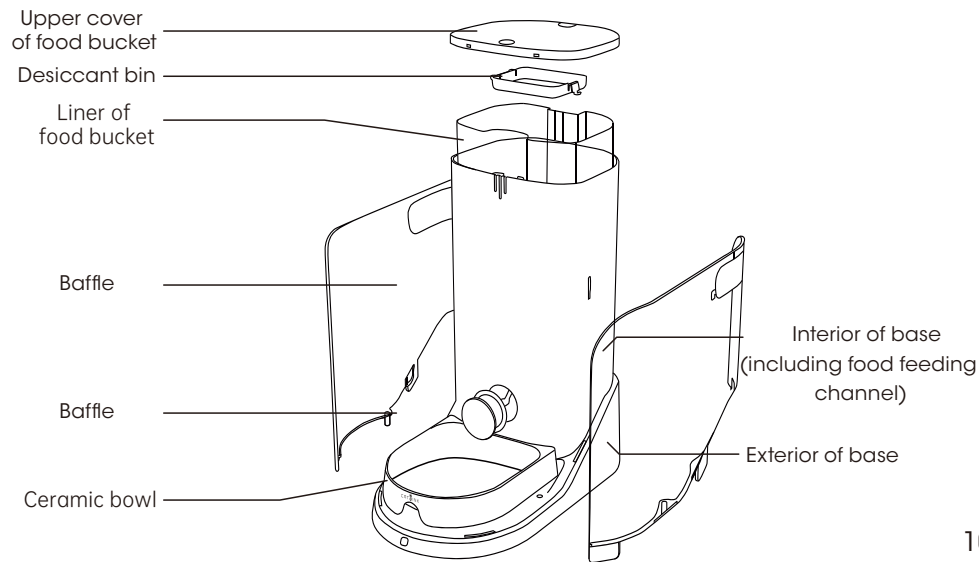

Product Specification

Product Name	CATLINK ONE - PET AI FEEDER
Package dimensions	450x290x470(h)mm
Product Dimensions	390x226x397(h)mm
Machine material	HIPS/ABS
Weight	6kg
Capacity of food bucket	3.5L
Dimensions of backup power bin	110x169x24(h)mm
Input power	DC 5V/1A

*The parameters of products may vary along with the model or batch without sending a prior notice.

Warranty Card

Dear CATLINK's users, thank you for choosing CATLINK series product! Please read the warranty clauses below carefully before use.

- 1.Warranty period: Within one year from the date shown on the valid purchase voucher.
- 2.During the one-year warranty period, when the user uses the product normally, the fault caused by the quality of the product will be given free warranty service.
- 3.Warranty does not apply if the Product:
 - (1) is installed or used wrongly and destructed on purpose;
 - (2) is dismantled and maintained without permission;
 - (3) has a fault due to the part of the third party;
 - (4) is used in severe environment;
 - (5) is beyond the warranty period;
 - (6) has no valid purchase voucher;
 - (7) has a fault due to Force Majeure.
- 4.Please contact the after-sales service in time to see if the Product enjoys free warranty service.
- 5.Please fill the sheet on Page 13 and post it along with the Product when returning the Product for receiving warranty service.

CE Maintenance

- 1.The product shall only be connected to a USB interface of version USB2.0.
- 2.Adapter shall be installed near the equipment and shall be easily accessible.
- 3.EUT Operating temperature range: -40° C to 85° C .

FCC Warning

This device complies with part 15 of the FCC Rules. Operation is subject to the following two conditions: (1) This device may not cause harmful interference, and (2) this device must accept any interference received, including interference that may cause undesired operation.

Any Changes or modifications not expressly approved by the party responsible for compliance could void the user's authority to operate the equipment.

Note: This equipment has been tested and found to comply with the limits for a Class B digital device, pursuant to part 15 of the FCC Rules. These limits are designed to provide reasonable protection against harmful interference in a residential installation. This equipment generates uses and can radiate radio frequency energy and, if not installed and used in accordance with the instructions, may cause harmful interference to radio communications. However, there is no guarantee that interference will not occur in a particular installation. If this equipment does cause harmful interference to radio or television reception, which can be determined by turning the equipment off and on, the user is encouraged to try to correct the interference by one or more of the following measures:

- Reorient or relocate the receiving antenna.
- Increase the separation between the equipment and receiver.
- Connect the equipment into an outlet on a circuit different from that to which the receiver is connected.
- Consult the dealer or an experienced radio/TV technician for help.

This equipment complies with FCC radiation exposure limits set forth for an uncontrolled environment.