

**CAIVUN**

**8+**  
AGES

# PRODUCT MANUAL

**4x4**  
FOUR-WHEEL DRIVE

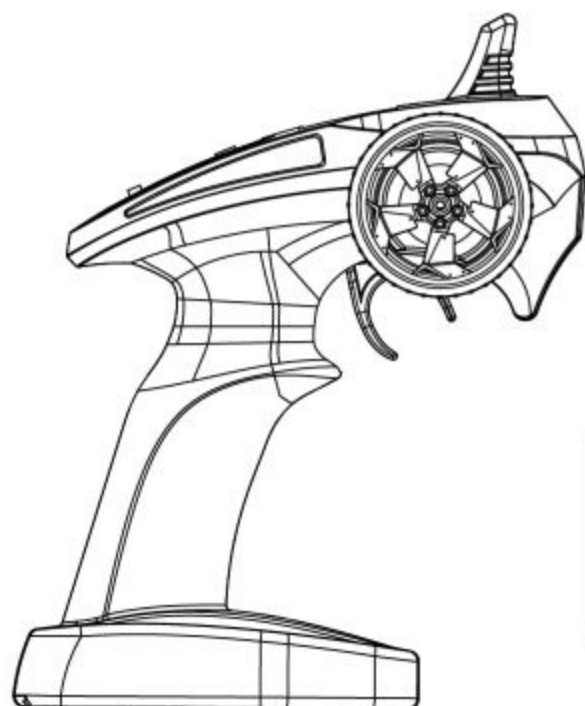
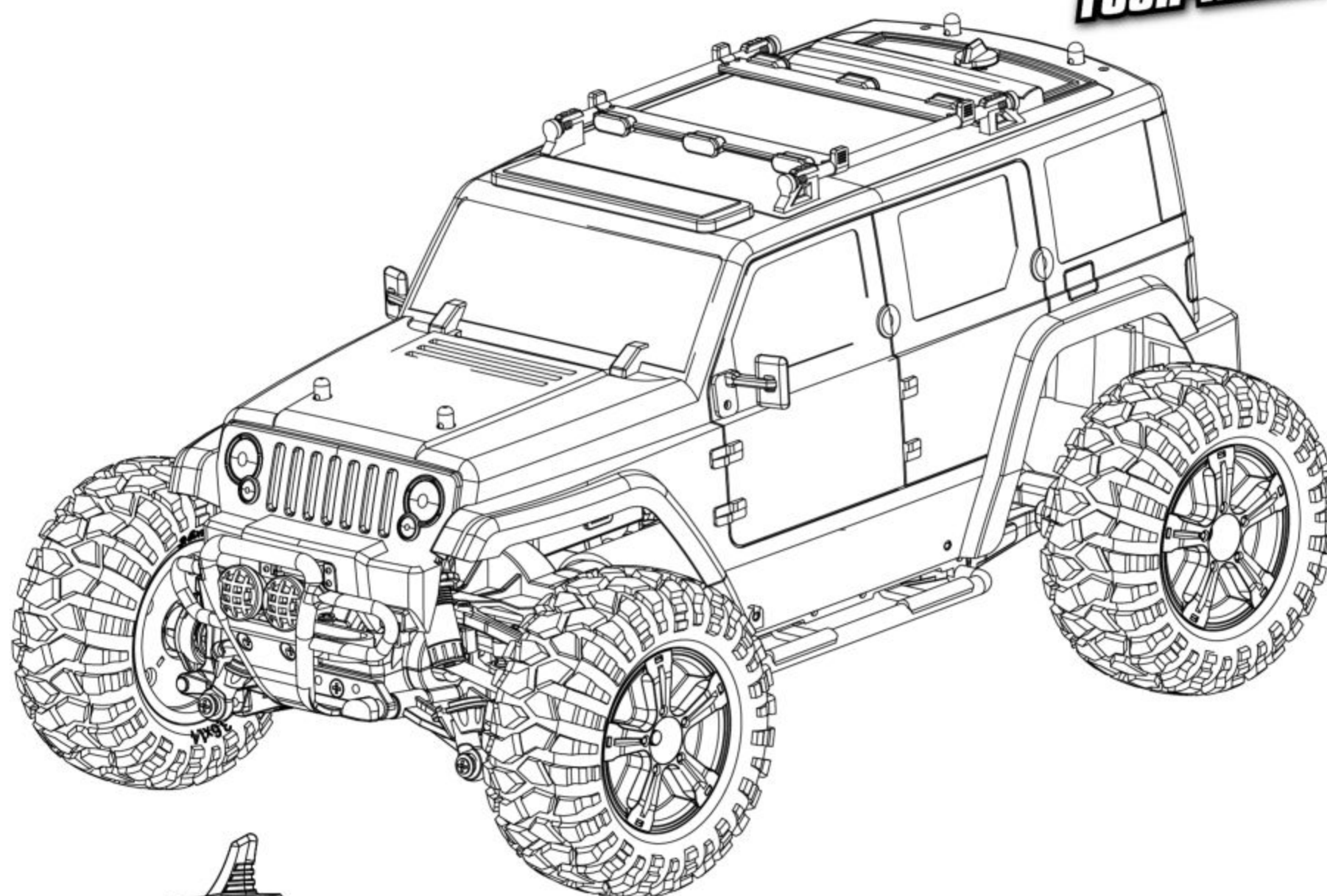

Product Name : Remote Control Car  
Model Number : WJ001A / WJ001B / WJ001C

**1:14**  
1:14 SCALE  
CRAWLER

**2.4**  
GHz  
DIGITAL  
PROPORTIONAL

**4x4**  
4 WHEEL  
DRIVE

**RTR**  
READY  
TO RUN

**7.4V**  
1500mAh  
BATTERY

**SHOCK**

**RUDDER**  
MACHINE

Full Function: Forward / Reverse / Turn Left / Turn Right



# Questions or Answers?

Caivun Official Support provides timely and friendly services in 24 hours for any problems.

 [support@caivunshop.com](mailto:support@caivunshop.com)

## PROTECT YOUR WARRANTY

Caivun comes with 365 days replacement warranty and 60 days more back guarantee, which starts from the purchase date of the order.

## Additional 6-Month Warranty

To register your new truck and extend 6 months more warranty, please email directly to [support@caivunshop.com](mailto:support@caivunshop.com) with following information.

Your Name: \_\_\_\_\_

Amazon Order ID: \_\_\_\_\_

Please complete your registration warranty as above. We will get back with a confirmation email in 24 hours.

Please Take A Moment Now  
Register  
[support@caivunshop.com](mailto:support@caivunshop.com)



## Warning:

Choking hazard! This product contains small parts. NOT suitable for children under 8 years. Contains electrical components and should be kept dry at all times. Regularly check the battery charger wires, plugs and shell and other components for damage. DO NOT use if any part is damaged.

## Caution proceeding

1. Detachable small parts should be stored safely and out of reach of children.
  2. If interference is experienced, turn the model off and try it again in a different area
  3. Remote control will not function correctly if the batteries are low. Please replace the batteries.
  4. Please discard old/used batteries in a safe manner. Consider your environment!
  5. Please store the remote control in cool, dry place.
  6. DO NOT expose to fire or high temperatures, moist storage.
  7. Should the battery get wet, wipe immediately with a soft dry cloth.
- If transformed, please stop usage.

### Battery use caution proceeding

1. Bodywork uses a set of Li-Ion 7.4V rechargeable batteries.
2. Remote control uses 3 x 1.5V AA batteries.
3. Please pay attention to correct polarity when replacing batteries.
4. Rechargeable batteries should be charged under adult supervision.
5. DO NOT use a mix of old and new or different types of battery.
6. After the battery is exhausted, the model should be removed.
7. DO NOT short circuit any terminals.
8. DO NOT attempt to recharge non rechargeable batteries.
9. Remove batteries from the model when recharging.
10. DO NOT put batteries into a fire or into water.
11. The rated input voltage battery charger MUST be suitable for your mains power voltage.
12. During charging it is quite normal for the charger and batteries to heat up.



## <SAFETY PRECAUTIONS>

- It is a radio control model, not a toy!
- In order to enjoy running the car, you need to finish assembly before operation. Do routine maintenance work after operation. Replacement parts and option parts are available separately.
- Improper usage with Alkaline cells or rechargeable batteries may damage the electronics for the car or the radio.

### <IN ORDER TO OPERATE THE CAR SAFELY, BE SURE THAT YOU HAVE OBSERVED THE FOLLOWING POINTS>



#### WARNING!

Please follow the points as below in order to prevent accident from happening to the car and people.



- Be sure to read thoroughly the manual before you begin. If you have any question about assemble the car, please don't hesitate to contact us, we will reply you within 24 hours!

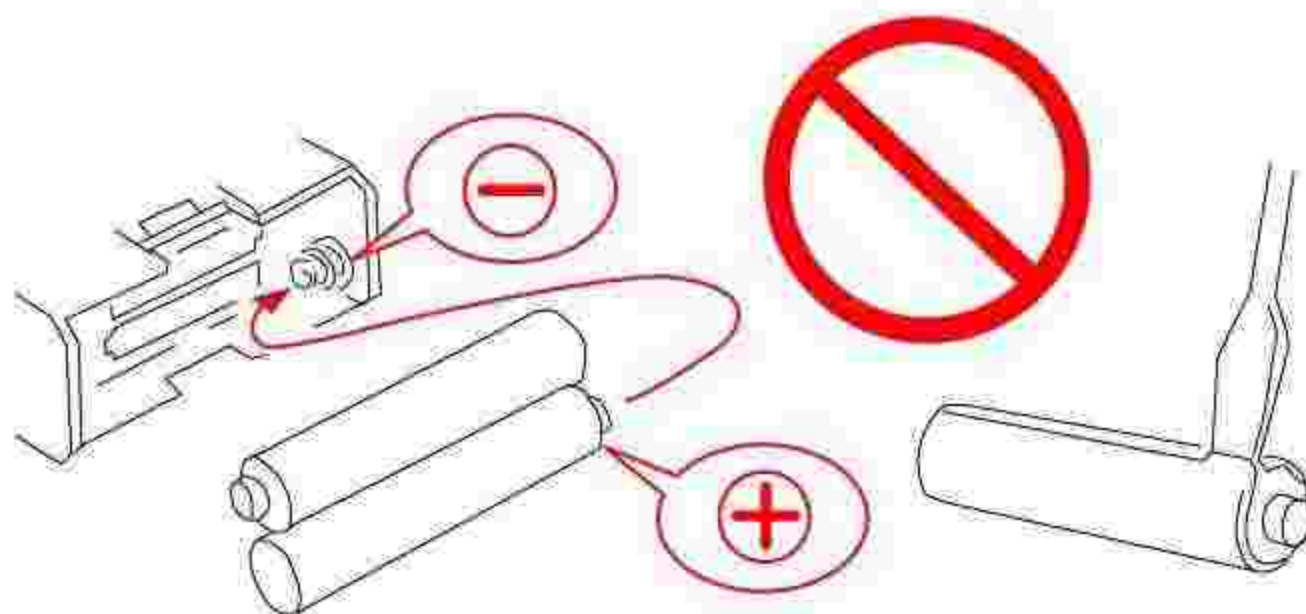

- Never reverse connection / disassemble the battery. This may lead to damage and leakage.



- As the product contains small and sharp parts, assemble and store this product only in places out of the reach of children.

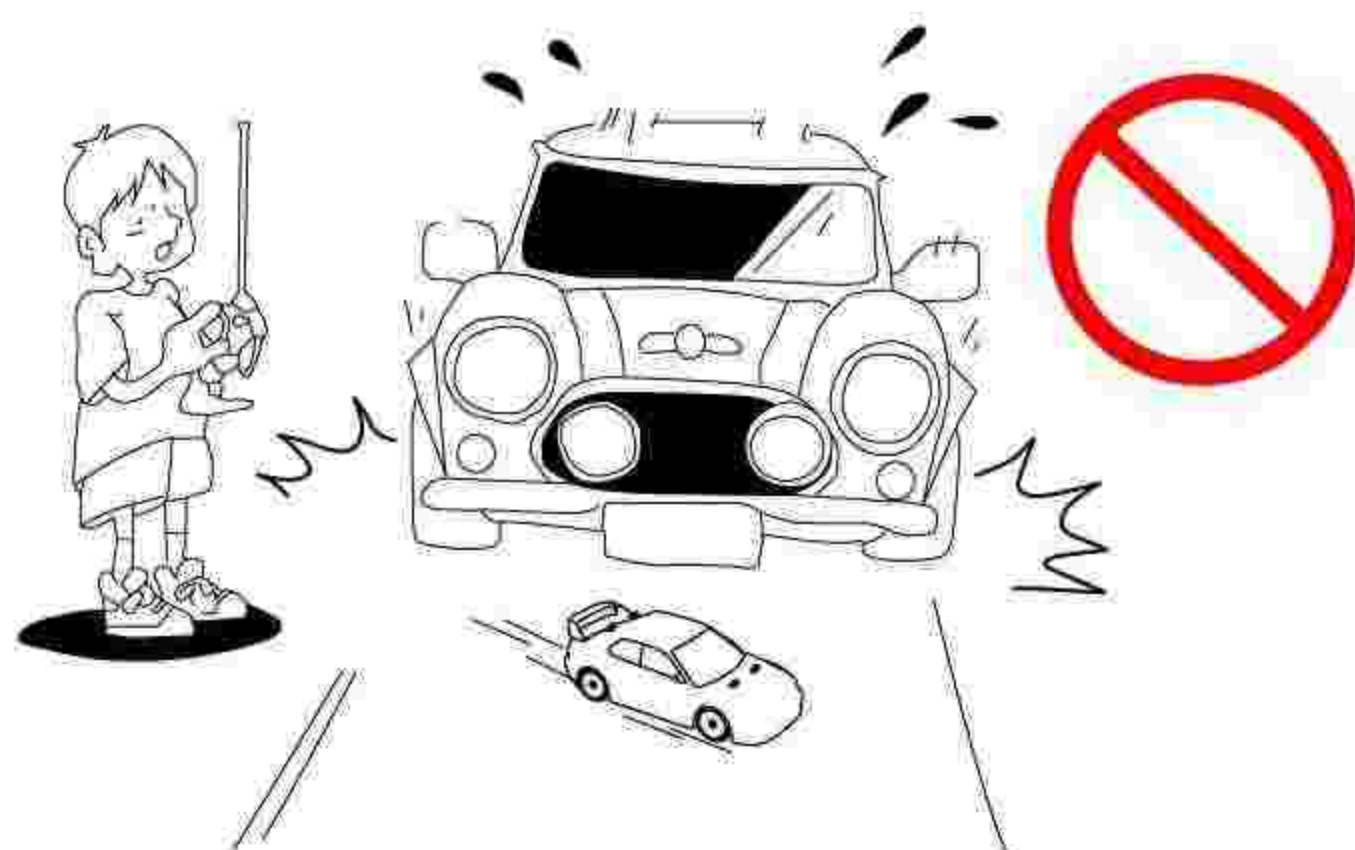

- Do not operate the model on public roads, in crowded places and near infant as it may cause accidents.





# WARNING!

Please follow the following steps to operate, in order to prevent hurt to your body or damage of material property.



- Cutters, nippers and screwdrivers need careful handling.



- Painting must be done only in a well-ventilated area.

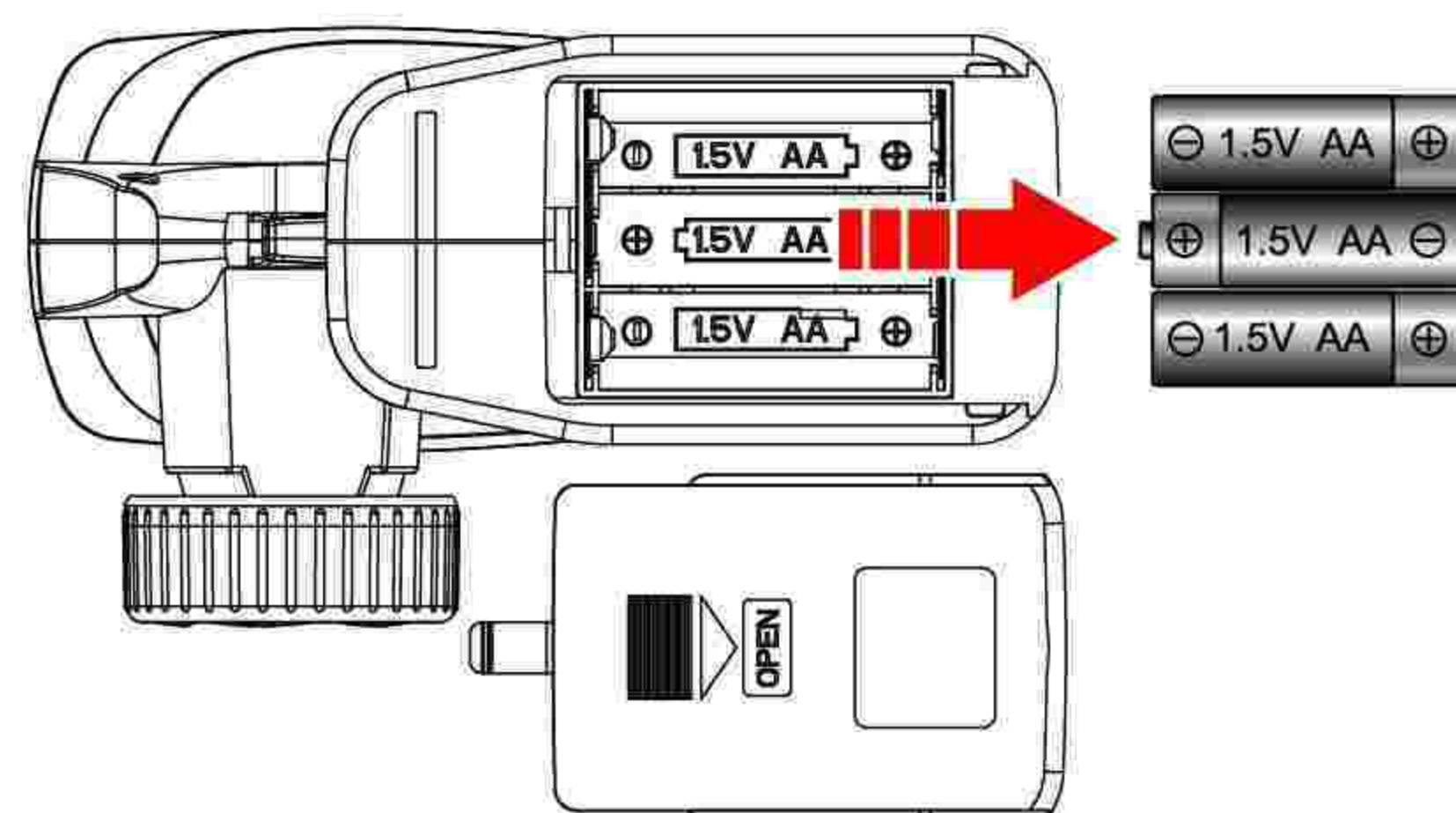
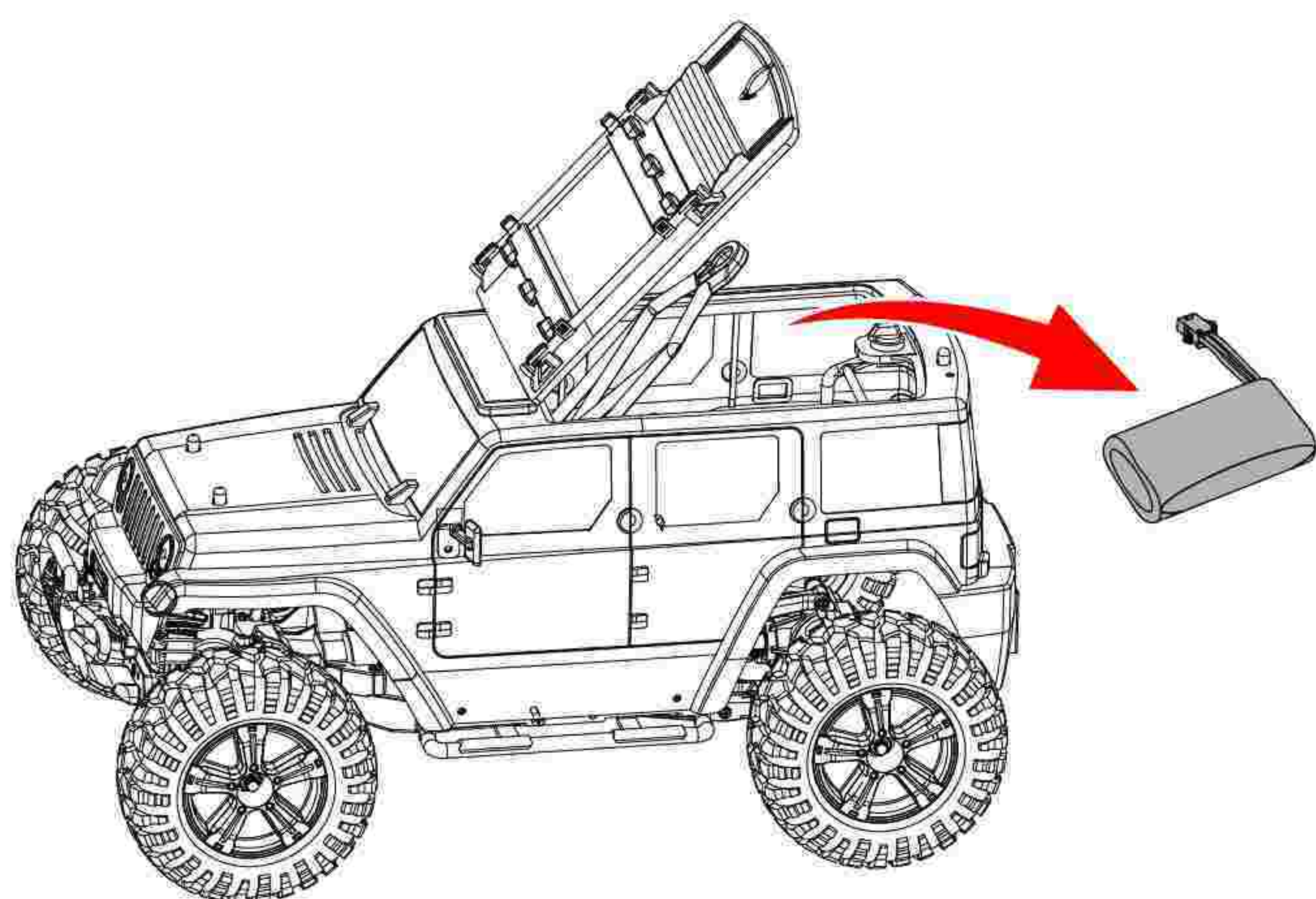

- When the model is not in use, always turn off the receiver and transmitter. Furthermore, disconnect the batteries and remove them from the model and the transmitter. This may be dangerous such as overheat and leakage.



- Do not expose this model to high temperature, humidity or direct sunlight.



## OPERATING YOUR MODEL SAFELY



### WARNING!

Do NOT operate the model in the following places and situations. (Non-observance may lead to accident!)

- Operate your model in spacious areas ONLY with few people around! Do not operate it:

1. On road!
2. In places where children and many people gather!
3. In residential districts and parks!
4. Indoors and in limited space! Non-observance may result in personal injury and property damage!

- Always check the radio batteries!

With weak dry batteries, transmission and reception of the radio would fall off. You may lose control of your model in such condition. This may also cause serious accidents!!

- Keep in mind that people around you may also operate a radio control model!

NEVER share the same frequency with somebody else at the same time! Otherwise, Radio signals will be mixed up and you will lose control to your model. This may lead to accidents.

- The car must stop immediately and check for the reasons when it is operating abnormal.

As long as the problem is not cleared, do NOT operate it! This may lead to further trouble and unforeseen accidents!

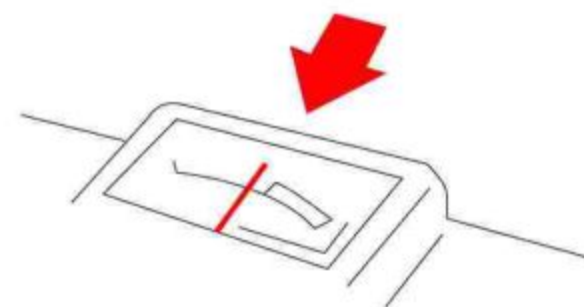

## OPERATING YOUR MODEL SAFELY



### WARNING!

In order to avoid accidents and personal injury, be sure that you have observe the following points:

- The safety of battery:

1. Exhaust battery should be safely dispose!
2. Non rechargeable batteries are not to be recharged, there is danger of explosion!
3. Do not throw the of battery into a fire! There is danger of explosion!
4. Do not swallow battery!
5. Store only in cool, dry and dark places and should be keep out of the children!
6. When the battery leaks the liquid and let it into you eyes, please right away rinse them and consult an ophthalmologist.

- Do NOT put fingers or any objects inside rotating and moving parts!

- Right after use, do NOT touch the motor! Danger of burning yourself!

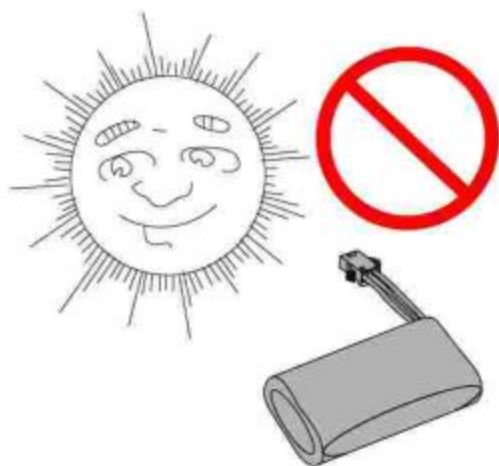

PROHIBITED

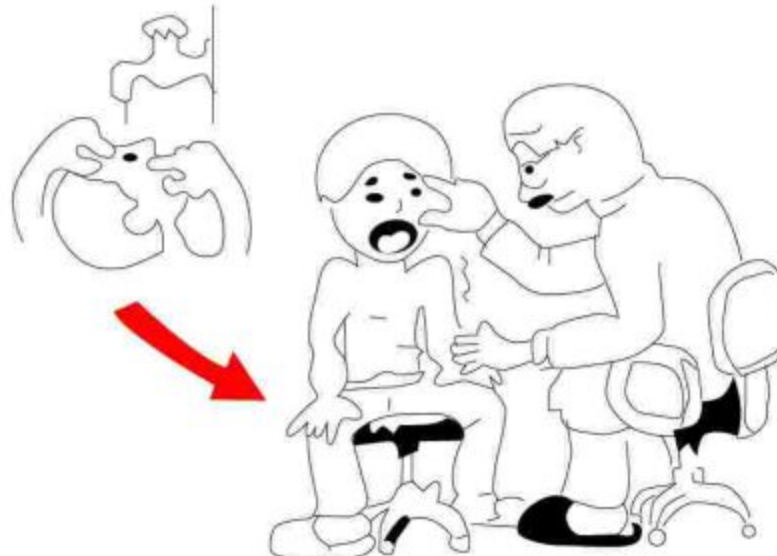

## Contents

### Included the following parts

- Remote Control Car  
(To the actual product)

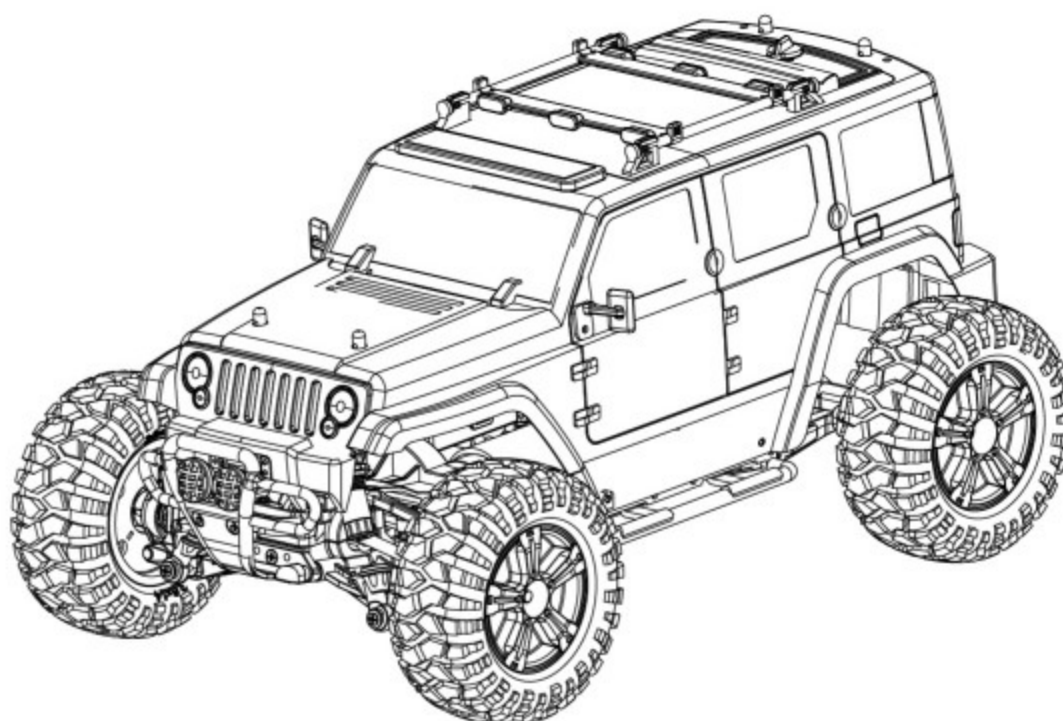

- Transmitter

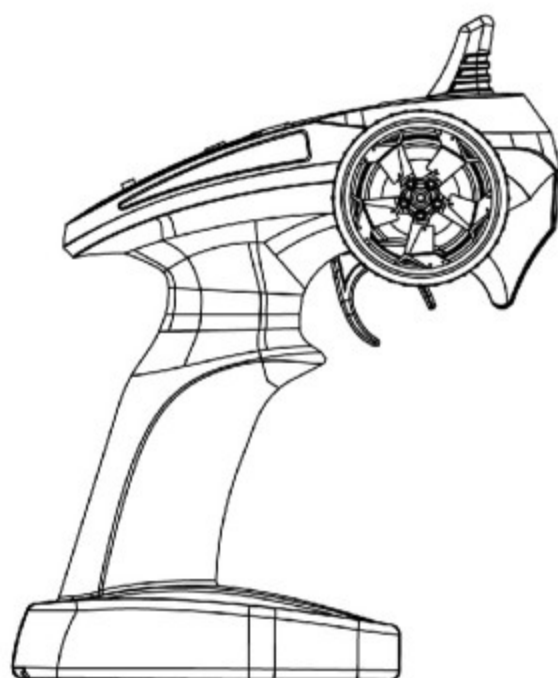

- Cross Wrench(small)

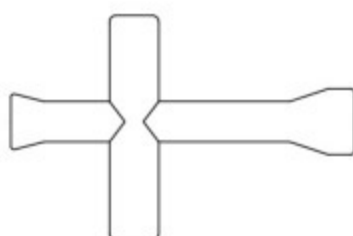

- Screwdriver

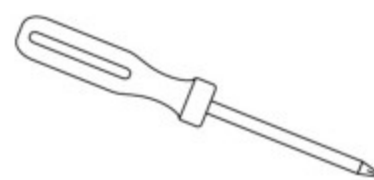

- Inner hexagonal wrench



- USB Charger

**Note:** Please use the offered charging cable to charge the battery.



- 7.4V 1500mAh Large power Li-Ion battery

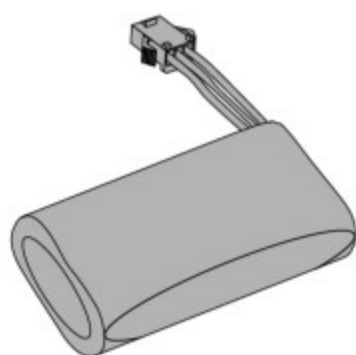

- Instruction manual





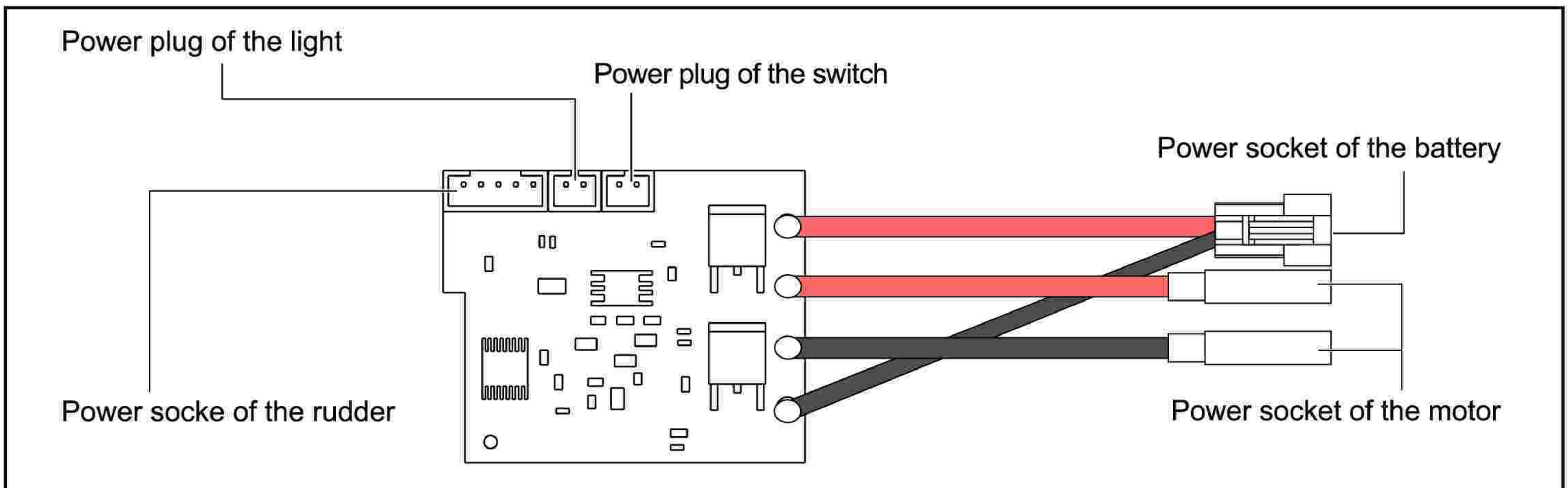

## Transmitter function introduce

Our company has been configured a new-style transmitter for model car. Please read the instruction manual carefully. The following is the transmitter's description of all functions.

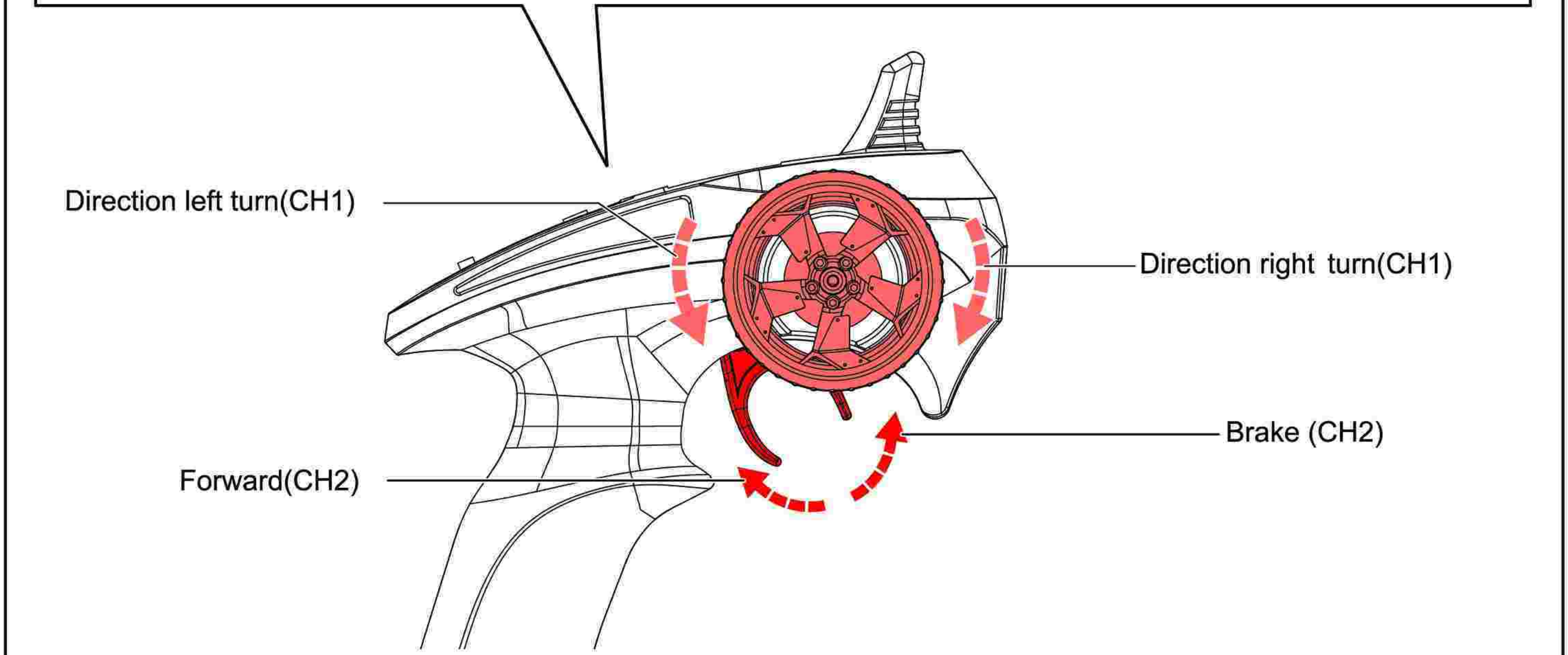
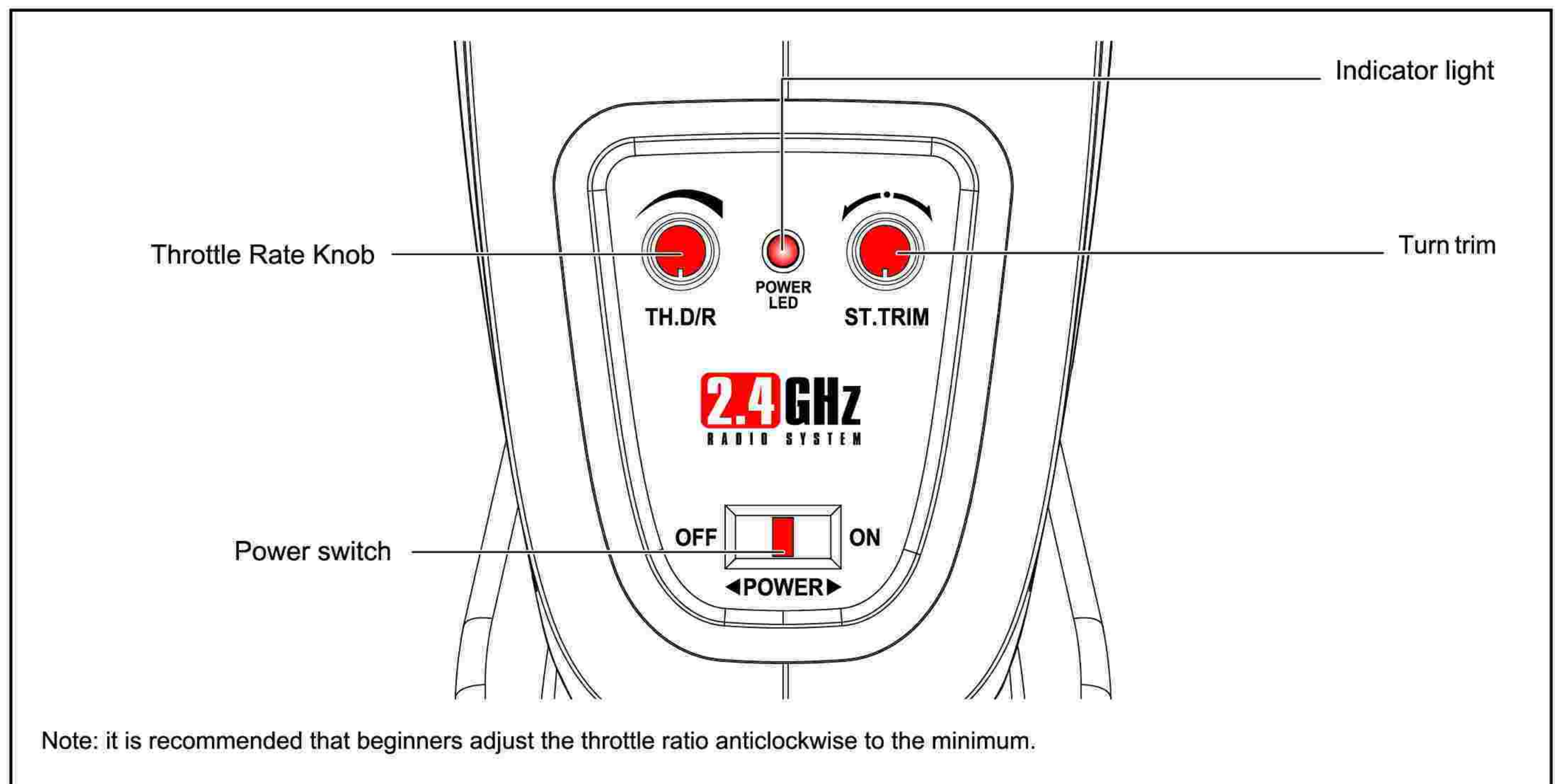



## Assembly of the transmitter battery

1. Remove the battery lid.

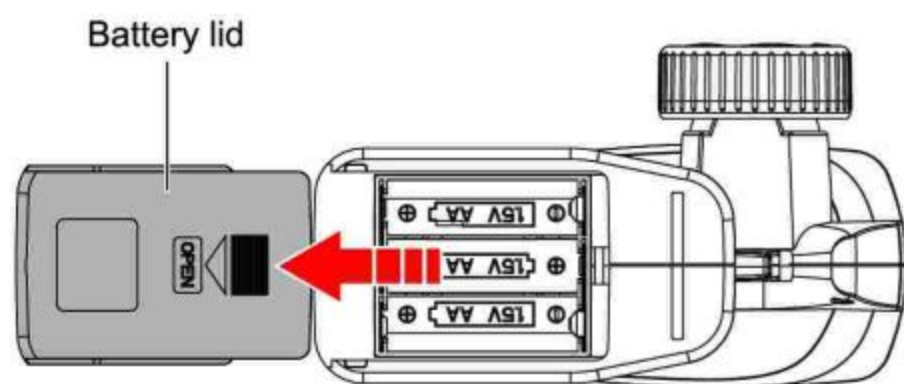

2. Load 3 AA-size alkaline batteries as shown in the illustration.  
Caution: install batteries with correct polarity.

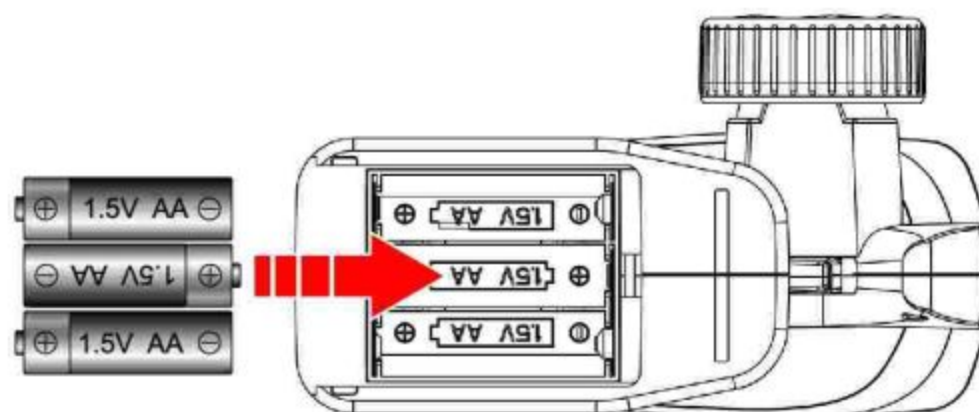

3. Replace the lid as shown.

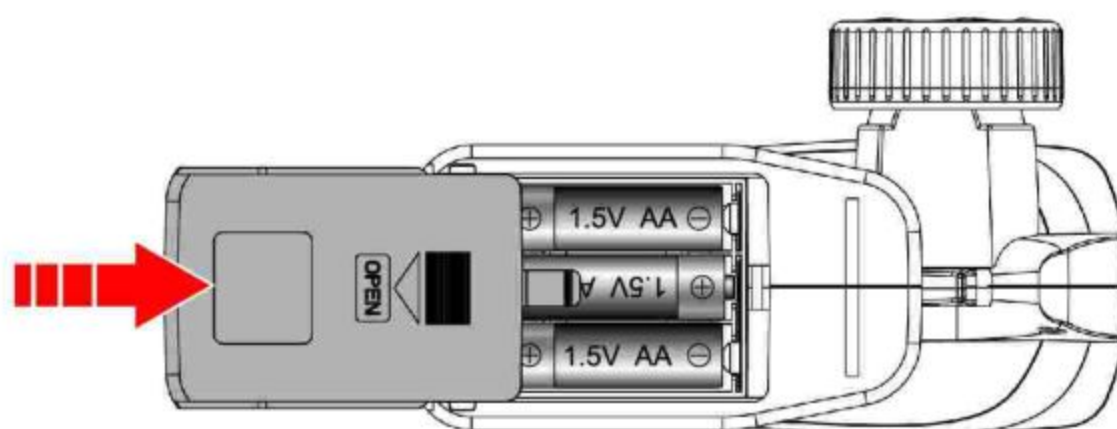

## Model battery's charging and assembly

1. Charge

Insert the USB charging line into the computer's USB interface (as shown in the figure) or charger's USB interface (5V, 1A-2A, as shown in the figure). At this time, the USB charging line indicator is flashing in red, and then insert the battery charging interface into the the USB charging line(as shown in the figure). At this time, the USB charging line indicator is always red and enter the charging status. After about 210 minutes, the indicator lights out and charging is completed. Then press the buckle on the charging cable (as shown in the picture) and pull out the battery, you can successfully disconnect the battery from the charger.

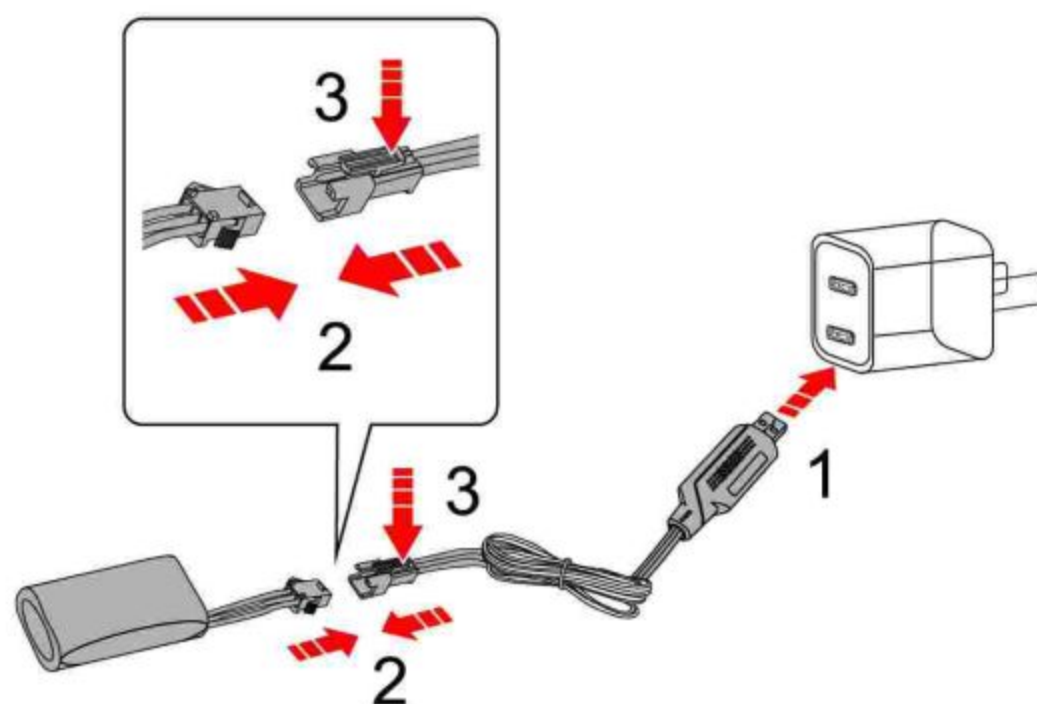
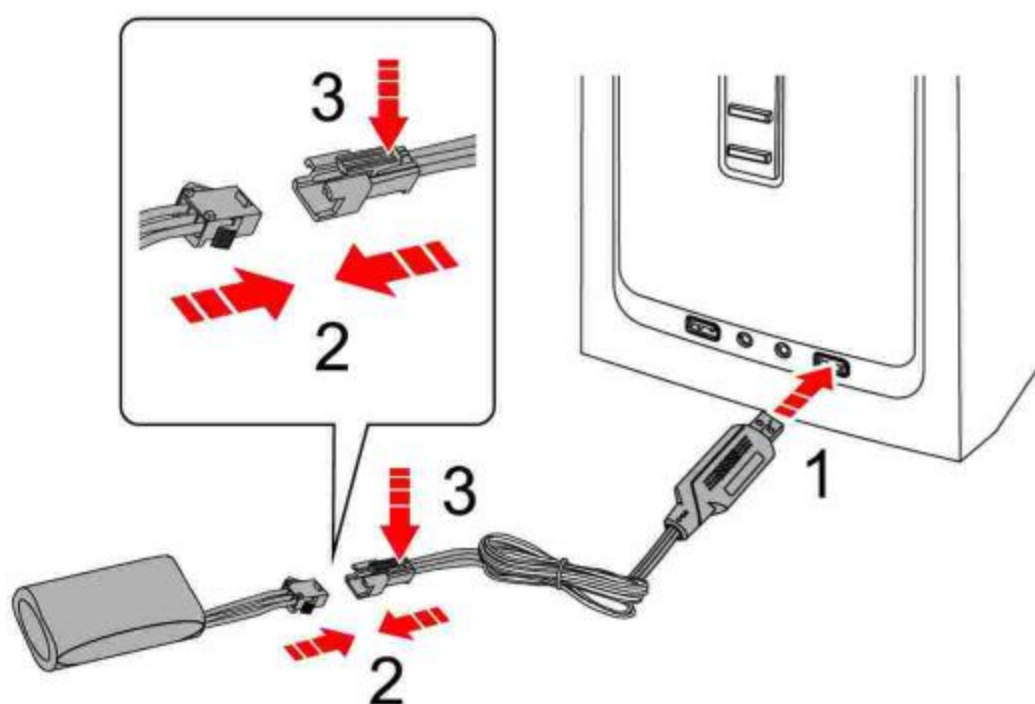



**2. Open the battery cover lid or remove the car shell.**

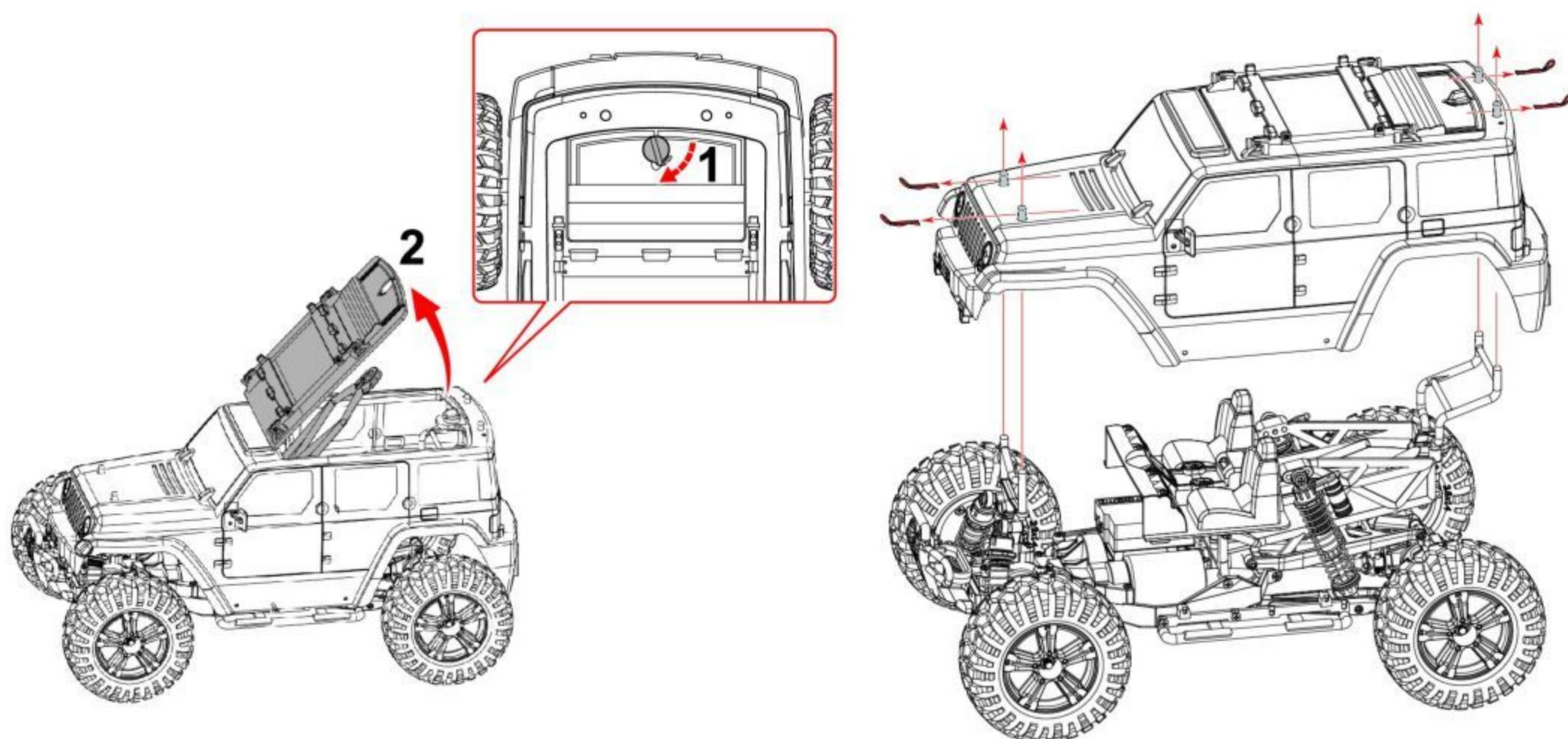

**3. Installing battery**

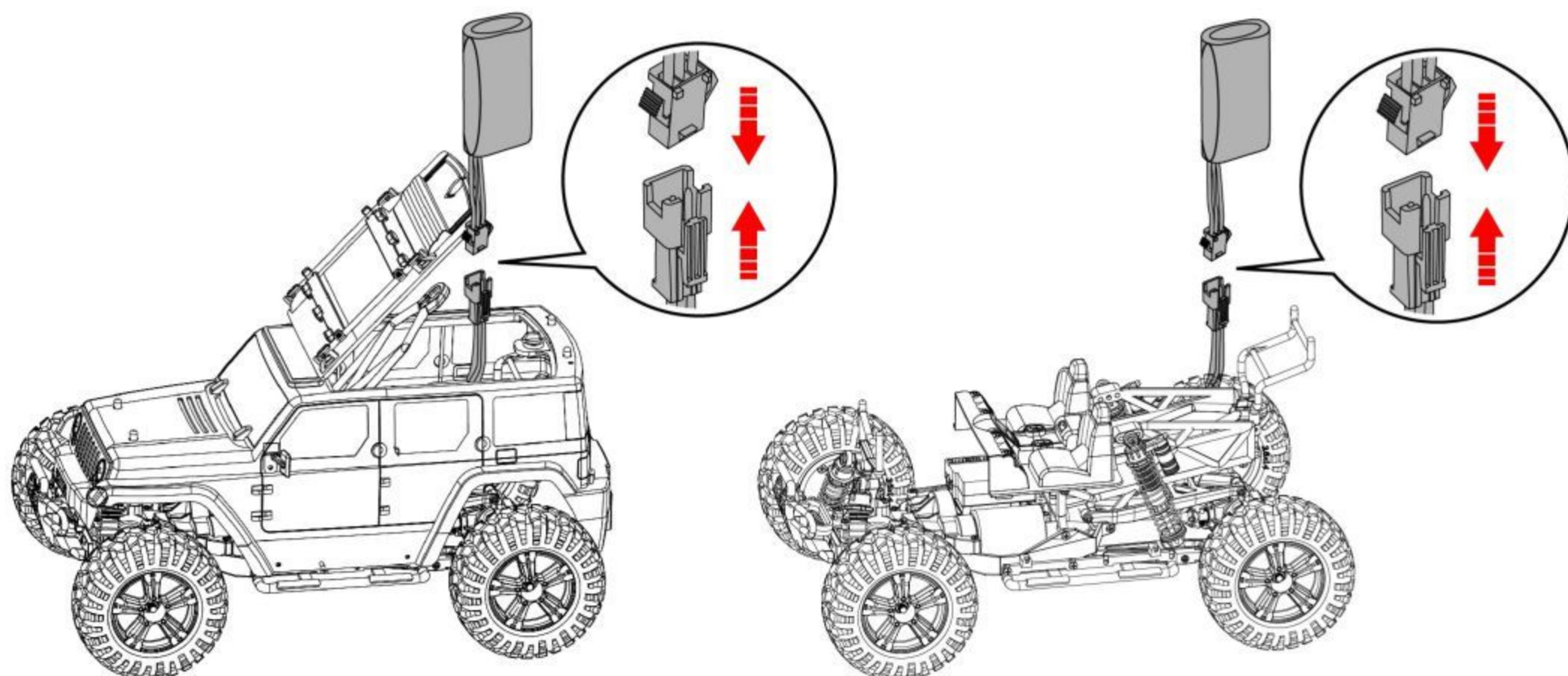



# 4WD Remote Control Car Assembly Diagram

WLS019 3X9PB Sidestep Screw 2

WLS071 4.5x11 Ball head screw 3

WLS063 2.5x10PM Non self-tapping screw 2

WLS070 3x3 Inner hexagon socket shot screw 1

WLS046 2.5X8PM Non self-tapping screw 2

WLS054 2.5X16PM Non self-tapping screw 9

WLS064 2.5X12PM Non self-tapping screw 1

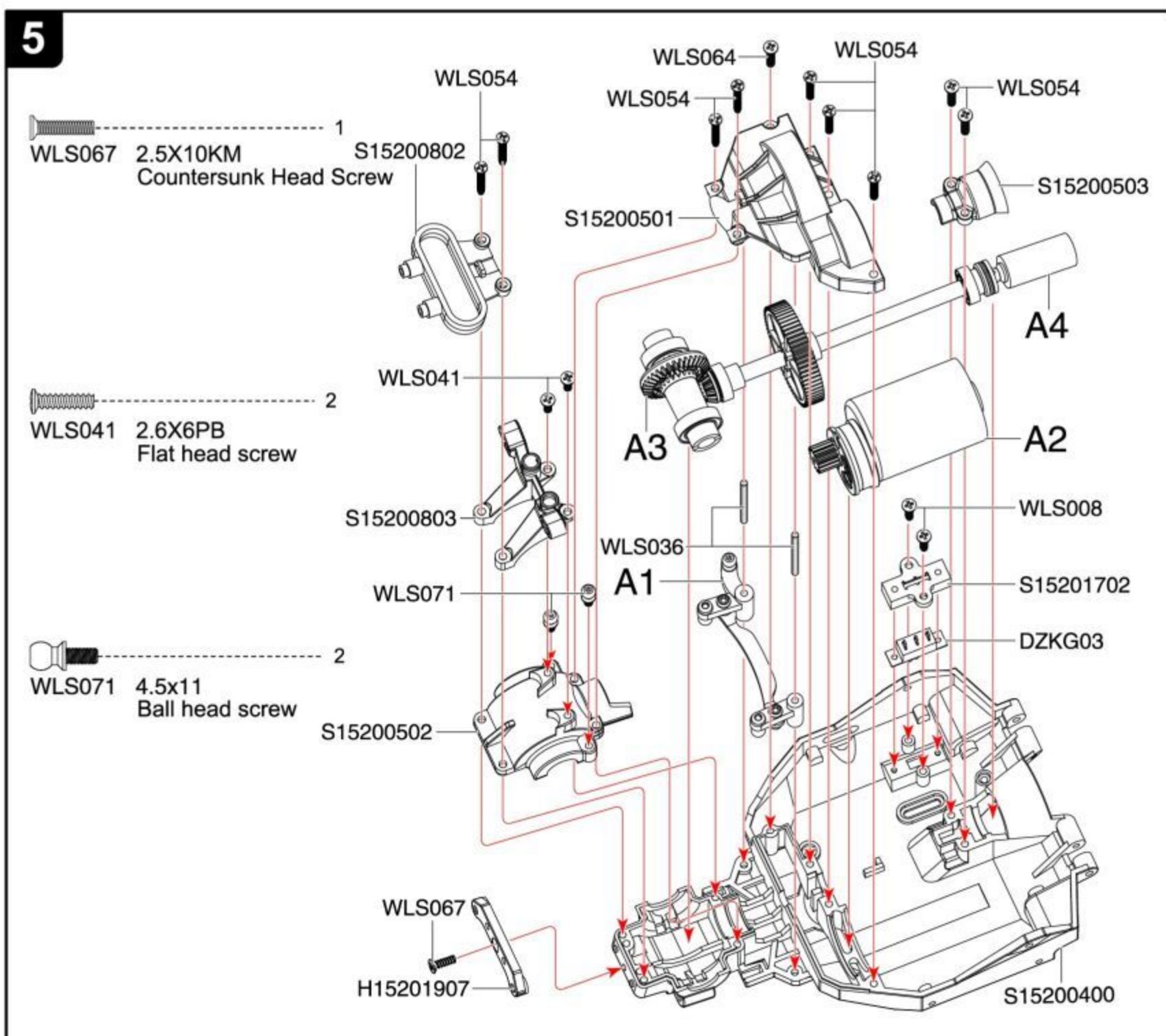
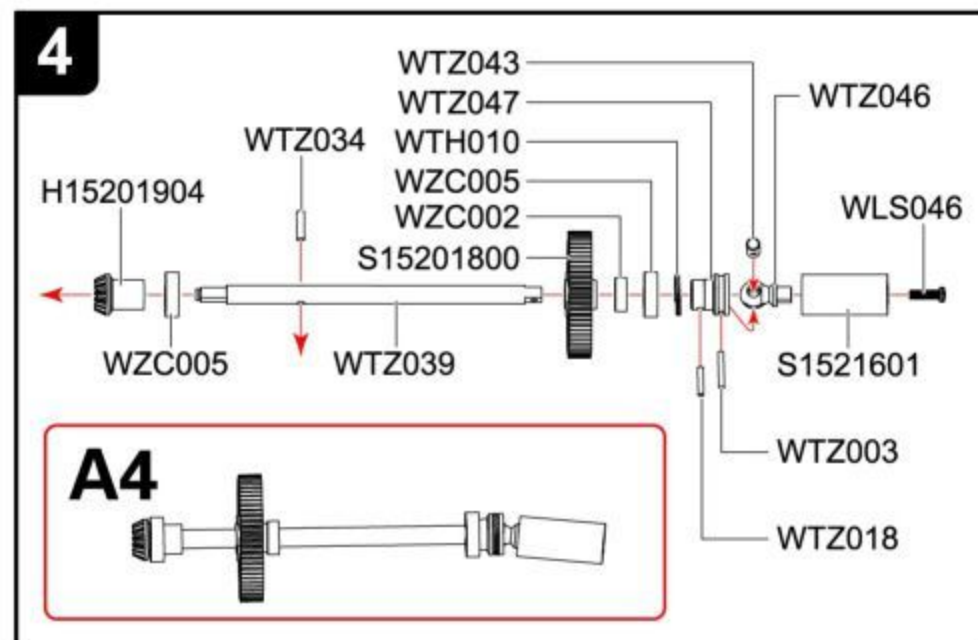
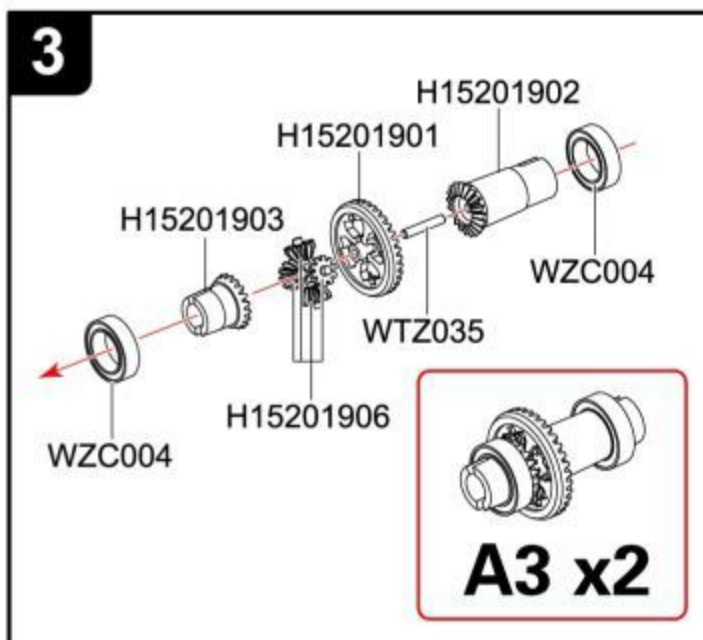
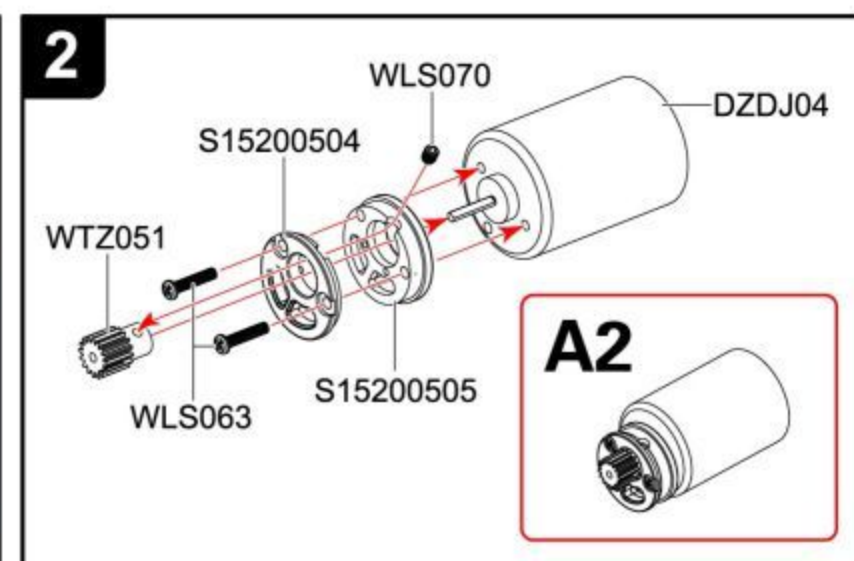
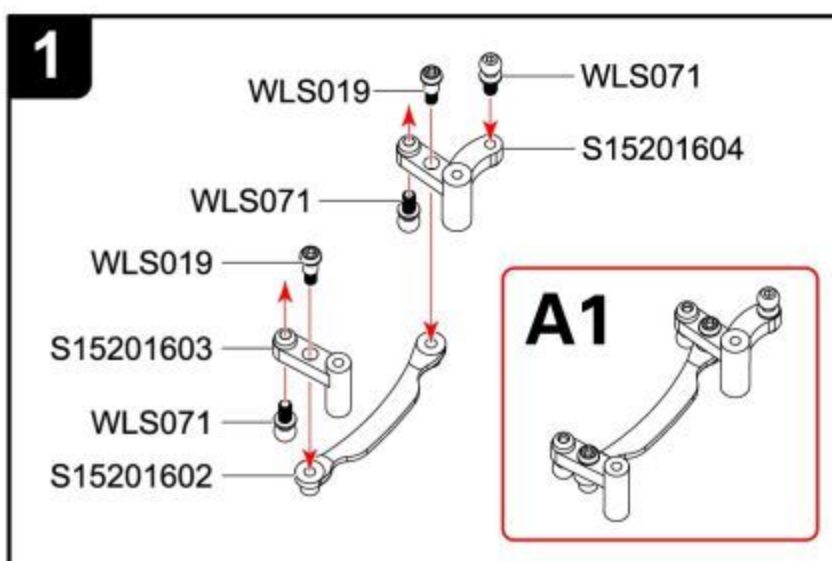



WLS066 2.5X14KM  
Countersunk Head Screw

WLS069 2.6X6X6PWB  
Screw

WLS071 4.5x11  
Ball head screw

WLS059 2.5X8KM  
Countersunk Head Screw

6

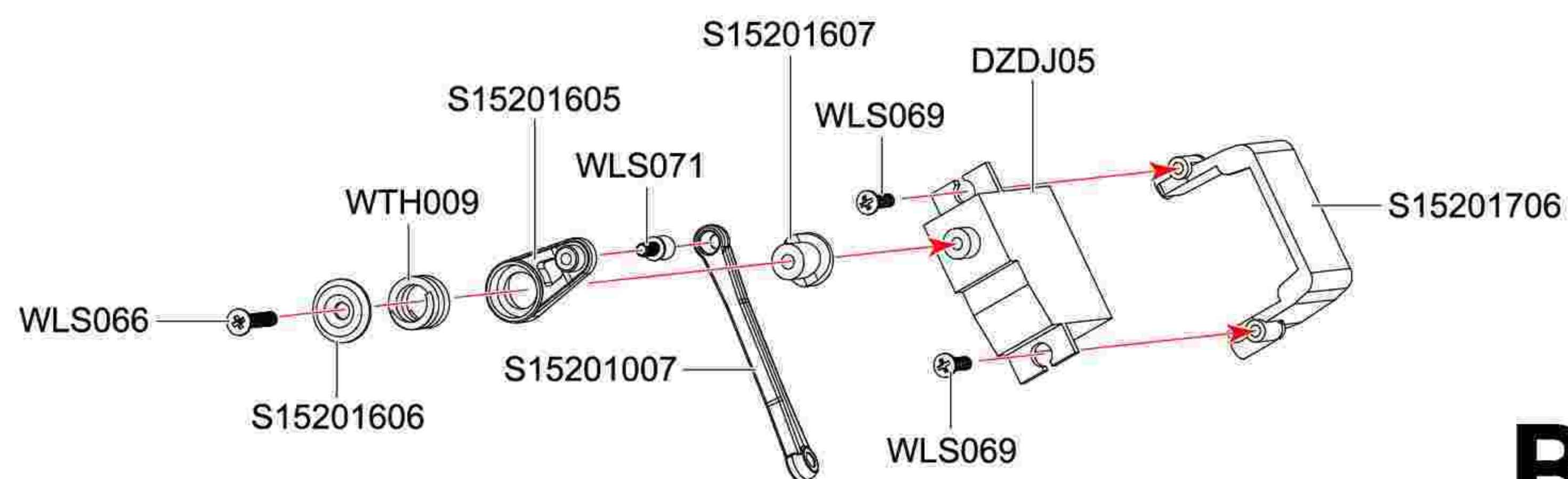

B1

7

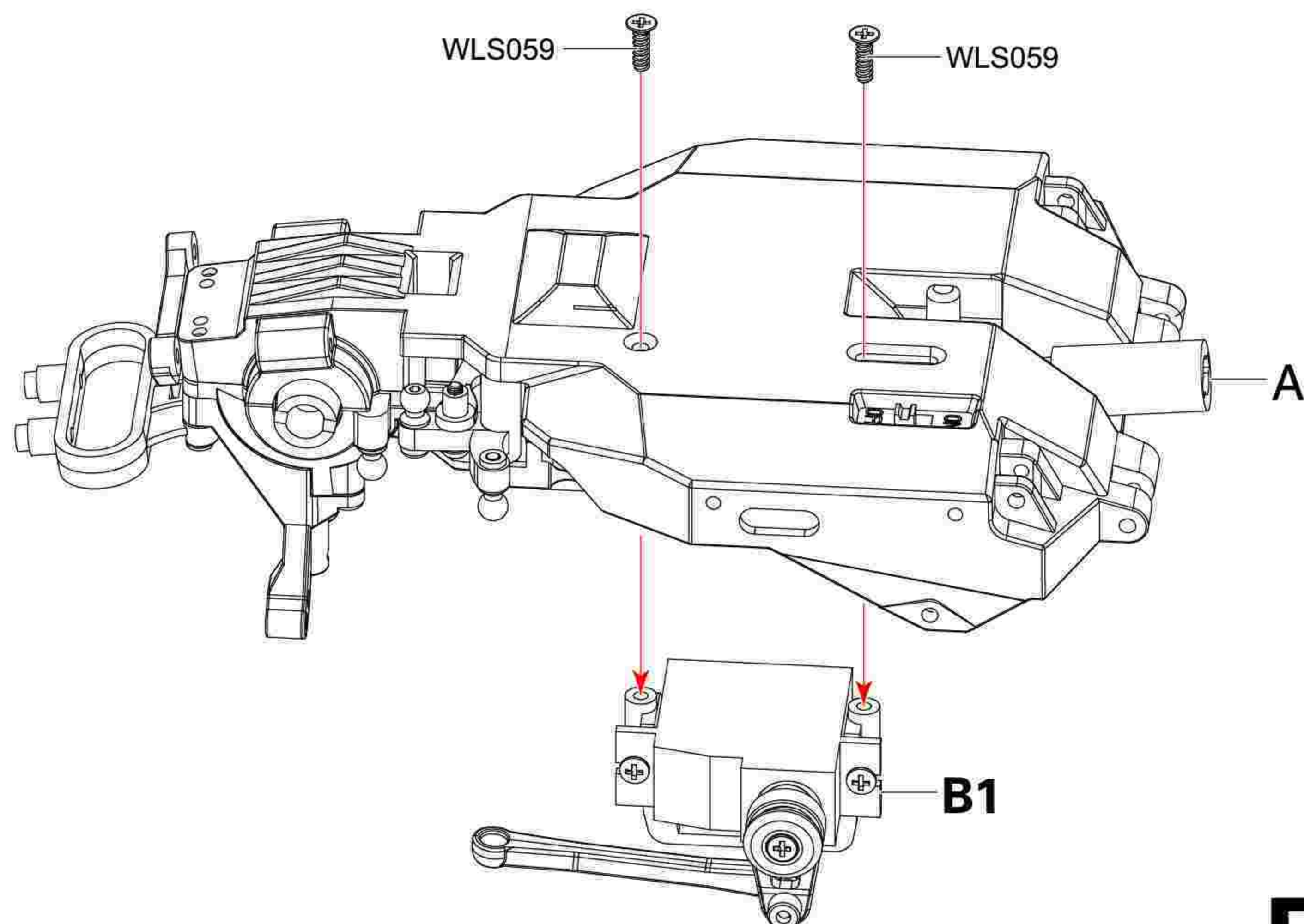

B2

8

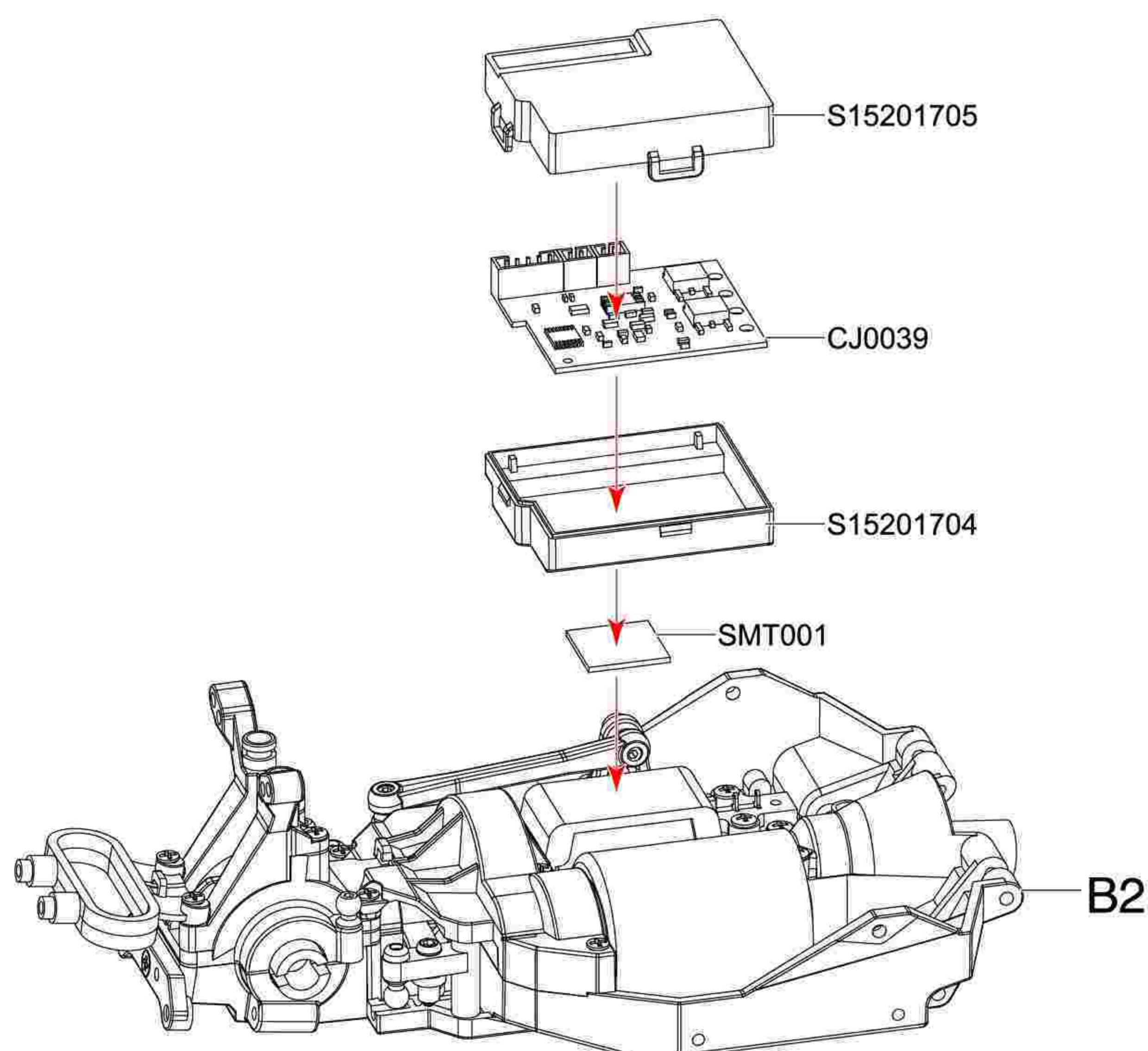

C



WLS072 3.0X13  
Sidestep Screw

WLS054 2.5X16PM  
Non self-tapping screw

WLS045 2.5X18PM  
Non self-tapping screw

WLS050 2.3X8PB  
Flat head screw

9

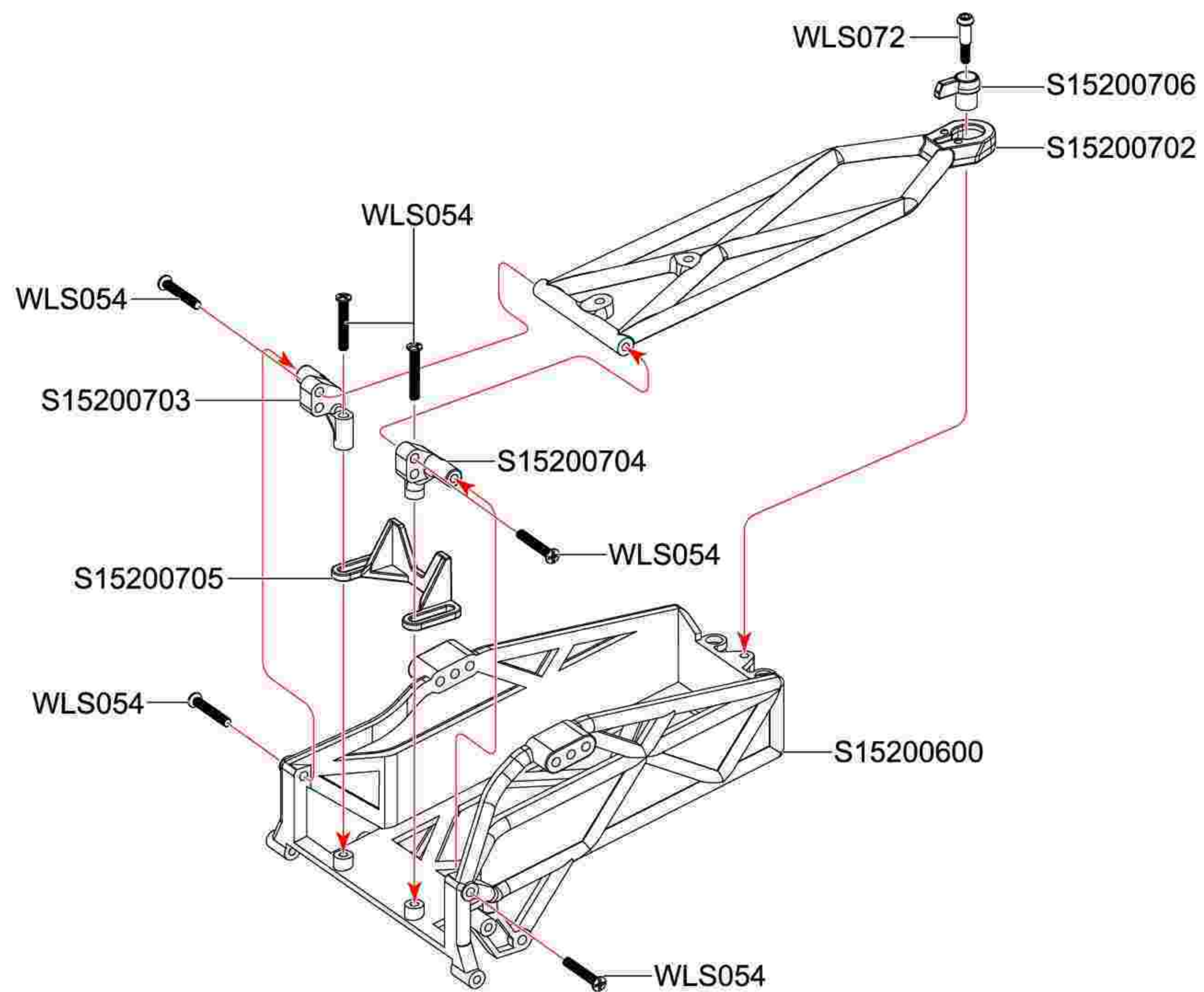

D1

10

WLS063 2.5X10PM  
Non self-tapping screw

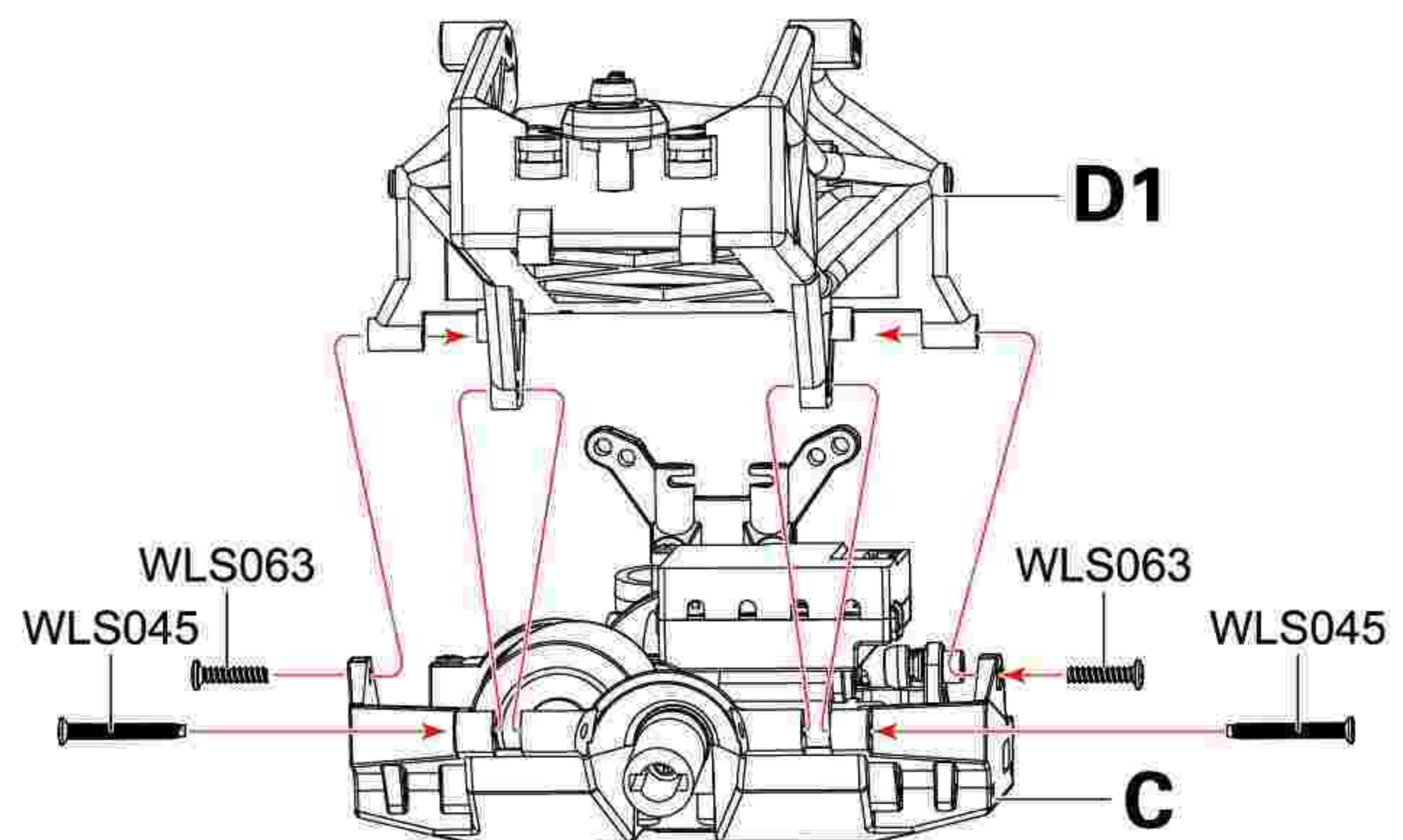

D2

11

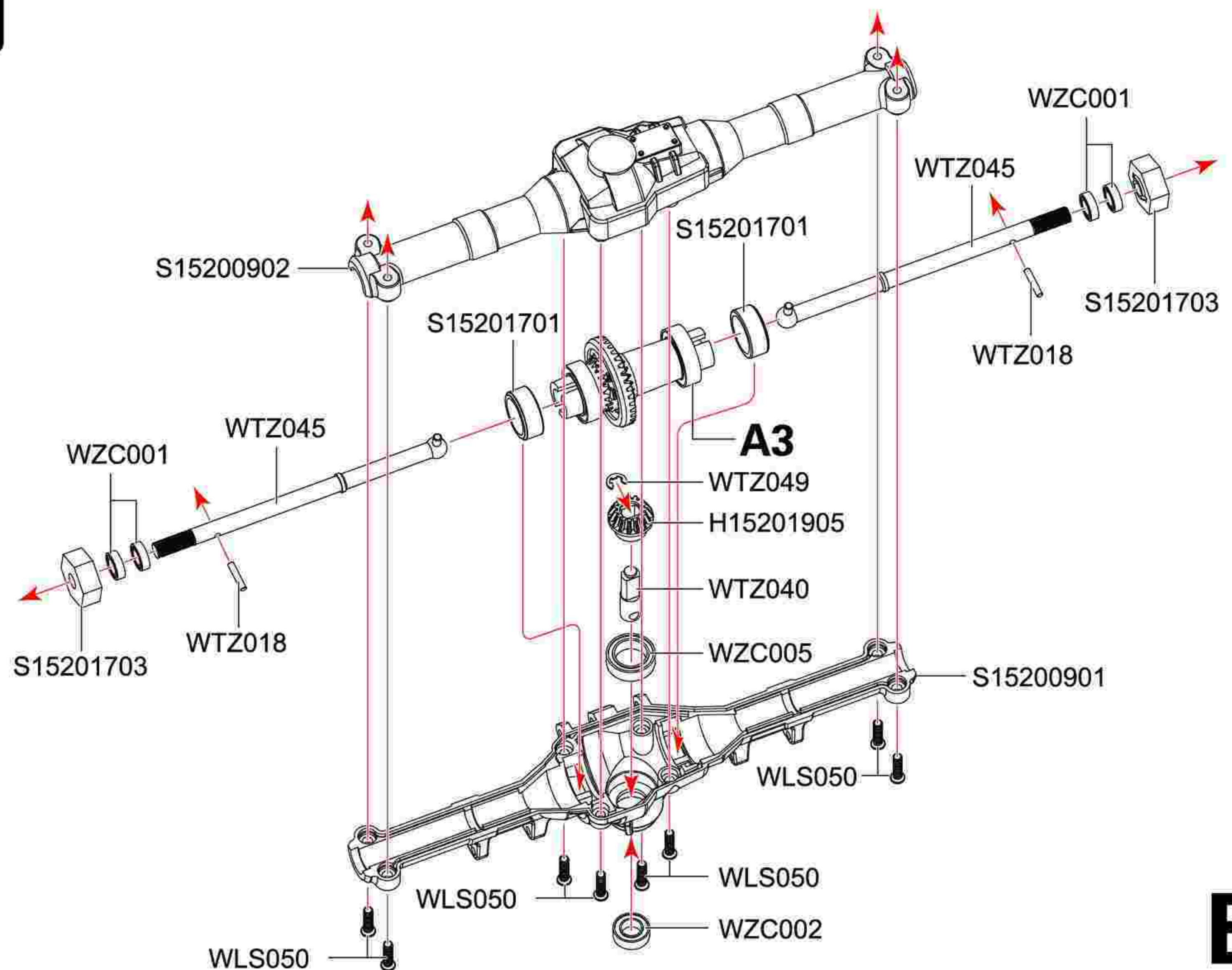

E1



WLS070 3x3  
Inner hexagon socket  
shot screw

12

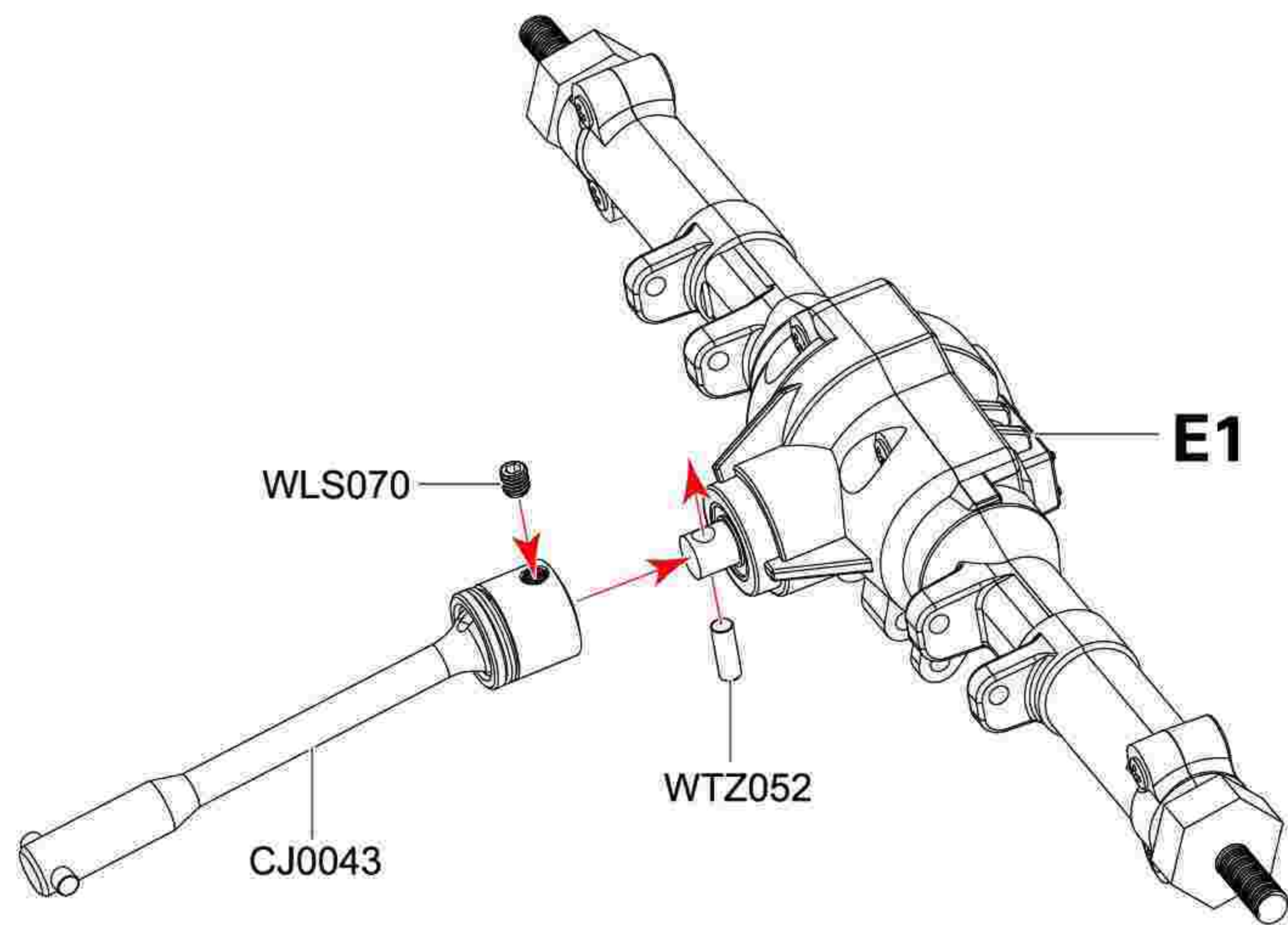

E2

WLS044 2.5X24PM  
Non self-tapping screw

WLS045 2.5X18PM  
Non self-tapping screw

13

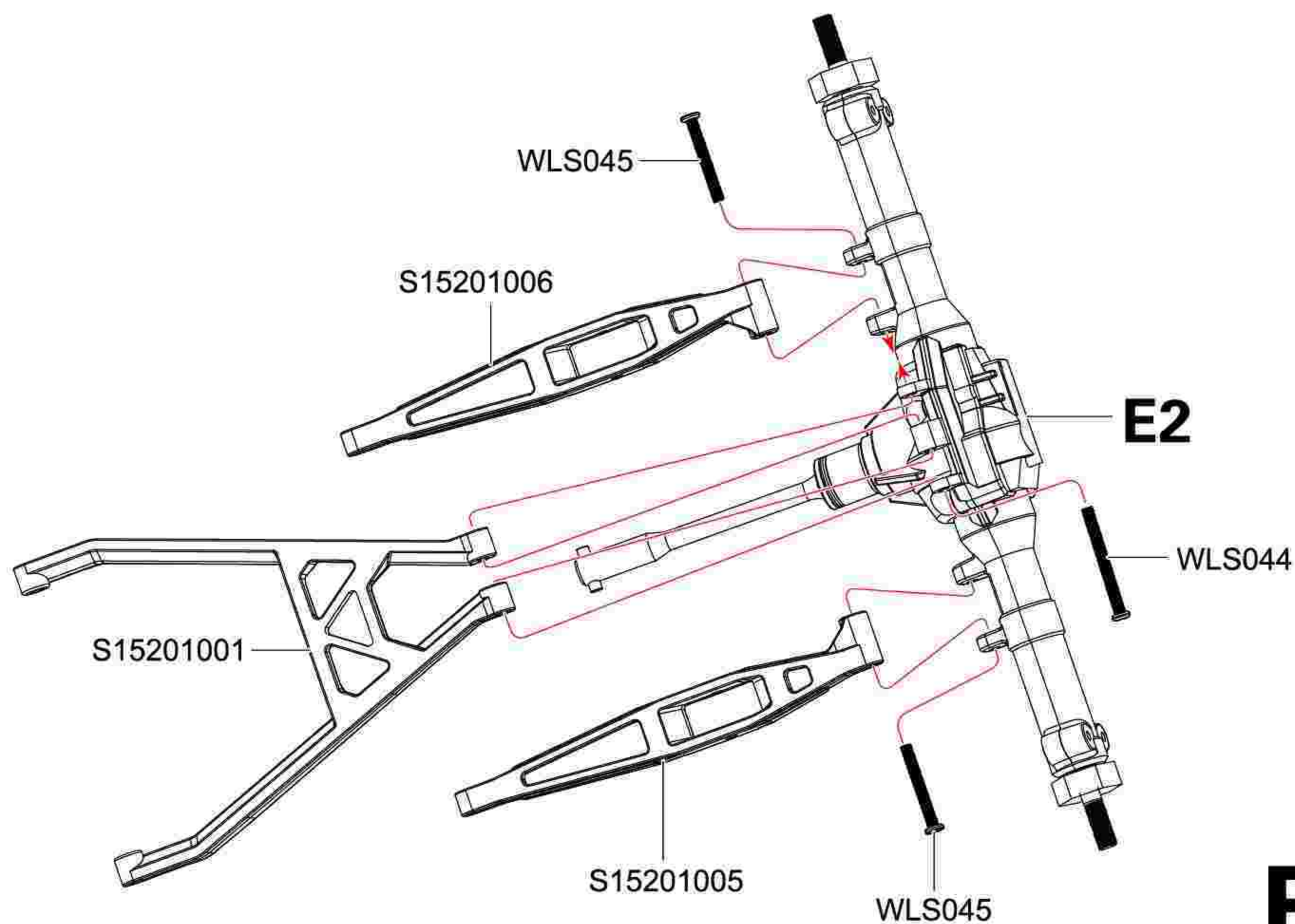

E3

WLS072 3.0X13  
Sidestep Screw

WLS054 2.5X16PM  
Non self-tapping screw

14

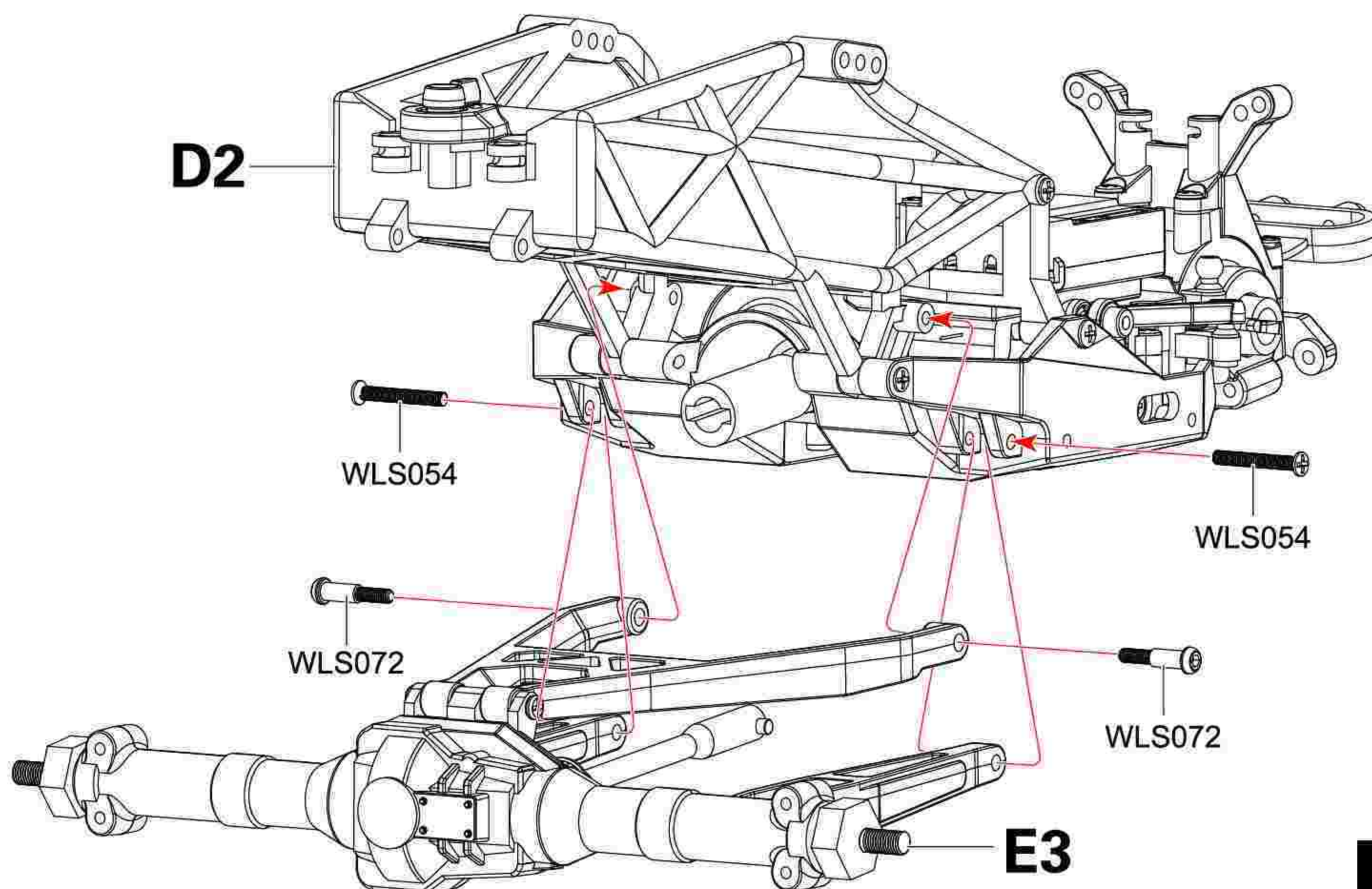

E4



WLS062 2.0X6PB  
Flat head screw

15

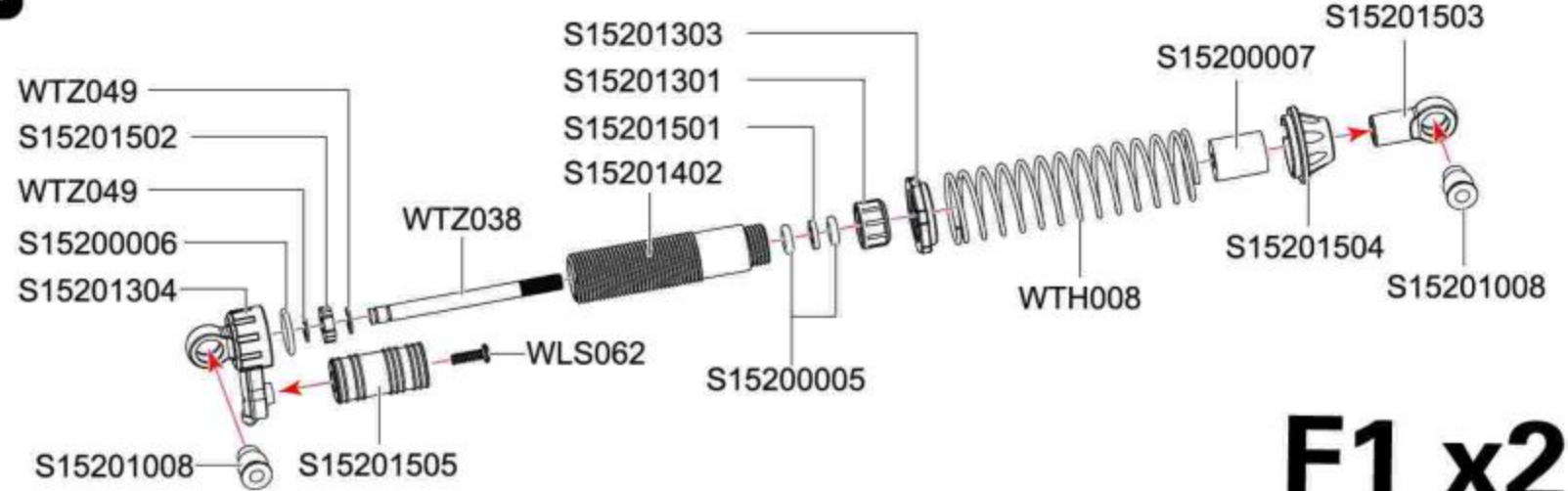

**F1 x2**

WLS054 2.5X16PM  
Non self-tapping screw

WLS064 2.5X12PM  
Non self-tapping screw

16

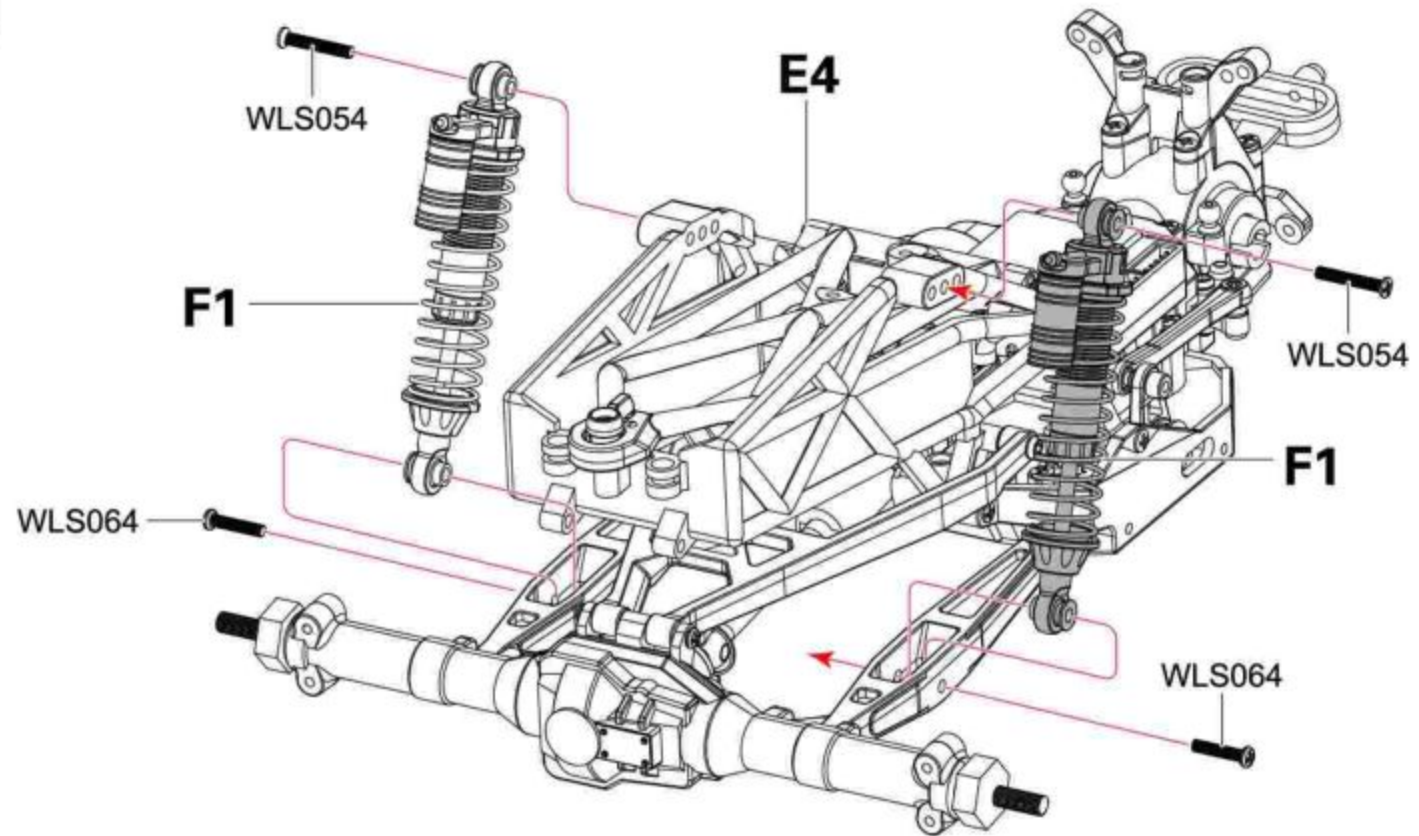

**F2**

17

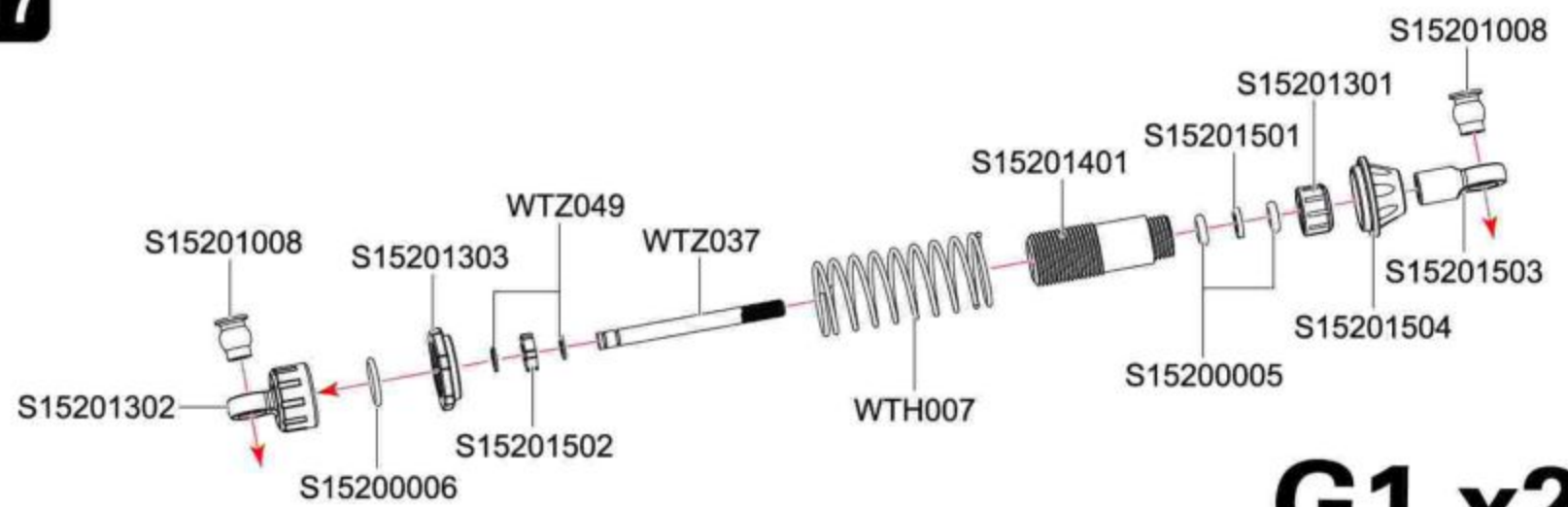

**G1 x2**

WLS019 3.0X9PB  
Sidestep Screw

WLS031 2.3X13.5  
Screw

18

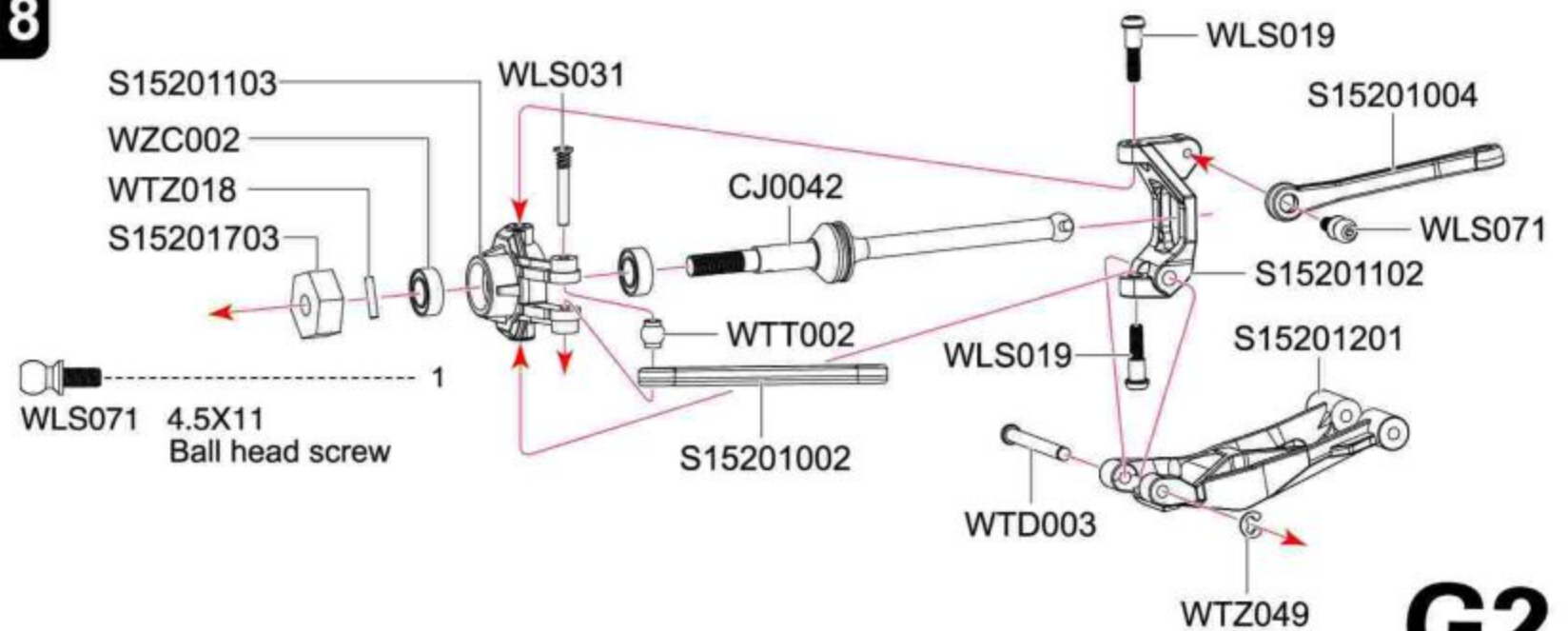

**G2**