

## TYPICAL INSTALLATION

## WARRANTY

one year replacement warranty

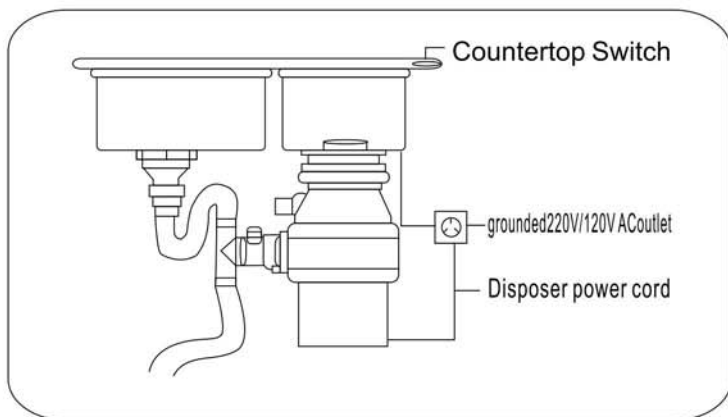

### STEP1: Mount Push Button

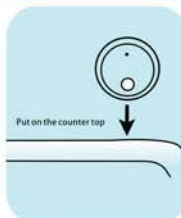

Peel off the paper on back of the wireless switch, then stick the wireless switch on where you need it or where it is convenient.  
-OR-

Put the wireless switch on where you need it or where it is convenient without stick.  
-OR-

Carry the wireless switch directly as you need.

### STEP2: Plug in Power Module

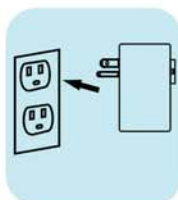

Plug power module into a dedicated, grounded 220V/120V AC outlet that is continuously energized.

### STEP3: Connect Power Module and Disposer



Plug disposer cord into power module.

Check all parts have been connected well before using.

Press and release the wireless switch button to turn the disposer on. Press and release again to turn the disposer off.

### CAUTION

Don't plug into metal box.  
Don't plug close to the ground or metal.

**DISCLAIMER:**  
Installation instructions and specifications are provided for general information purposes only. It is subject to change at any time without prior notice to the user. The information in this document should not be construed as a commitment by Hangzhou Keli Xun Electrical Co., Ltd.

## PARAMETERS

Rated Voltage	AC85-265V, 50/60Hz
Incandescent Light Load	1000W
Fluorescent/LED Light Load	500W
Low Power Consumption	<1W
Operating Frequency	2.4GHz
Control Distance	Open space -- 260ft, Indoor -- 100ft
Ambient Temperature	-40°C--60°C
Ambient Humidity	0--75%RH
Material	Fireproof PC
Weight	5.6oz/160g

## Power Button

Action	Status
Short Press	Control the power output open/close
Long Press for 3 secs	Enter encoding mode
Long Press for 10 secs	Cleaning code

## ATTENTION

Every plug has been pre-programmed. DO NOT Long Press Power Button casually, if you have any problem, please contact us by e-mail: easyishome@hotmail.com

## CLEESINK Wireless Switch Kit

Design for American Standard outlet.

Adopt newest RFID system, easy to control electrical device.

2.4GHz signal works through doors and walls, operates up to 100 feet away indoor.

No batteries required, adopt newest energy harvesting technology.

Compatible with Garbage Disposals Unit rated power under 1.5 HP.

## Power Light

Color	Status
Off	Power off with no electricity
On	Power on
Flashing	Enter encoding mode

**FCC Radiation Exposure Statement:**

This equipment complies with FCC radiation exposure limits set forth for an uncontrolled environment. This equipment should be installed and operated with minimum distance 20cm between the radiator & your body.

**FCC Warning**

This device complies with Part 15 of the FCC Rules. Operation is subject to the following two conditions:  
(1) This device may not cause harmful interference, and (2) this device must accept any interference received, including interference that may cause undesired operation.

NOTE 1: This equipment has been tested and found to comply with the limits for a Class B digital device, pursuant to part 15 of the FCC Rules. These limits are designed to provide reasonable protection against harmful interference in a residential installation. This equipment generates uses and can radiate radio frequency energy and, if not installed and used in accordance with the instructions, may cause harmful interference to radio communications. However, there is no guarantee that interference will not occur in a particular installation. If this equipment does cause harmful interference to radio or television reception, which can be determined by turning the equipment off and on, the user is encouraged to try to correct the interference by one or more of the following measures:

- Reorient or relocate the receiving antenna.
- Increase the separation between the equipment and receiver.
- Connect the equipment into an outlet on a circuit different from that to which the receiver is connected.
- Consult the dealer or an experienced radio/TV technician for help.

NOTE 2: Any changes or modifications to this unit not expressly approved by the party responsible for compliance could void the user’s authority to operate the equipment.