

# Nano

# User Manual

Product model: Speedfox Nano/Speedfox Nano Pro

Thank you for choosing the Speedfox Nano. Our team warmly welcomes you to the Speedfox family.

Follow us on social media to get the latest updates and promotions.



@hispeedfox



@SpeedfoxO



@hispeedfox



@speedfox official



Download the App



# Contents

**Brand Introduction** 03-04

**Package Contents** 05-06

**Start Using** 07-18

01. Product Parts

02. Button Functions

03. LCD Display Screen

04. App Instructions

05. Product Disassembly

06. Operating Manual

07. Safety Instructions

**Maintenance** 19-22

**Trouble Shooting** 23-25

Frequently Asked Questions

Error Code Prompt

**Product Specifications** 26-28

Specifications

Hazardous Material Disclaimer

**Warranty** 29-30

# Brand Introduction

## About Speedfox

We're people, just like you -- who need a better and faster way to clean. We are a team of passionate builders dreaming about making the world a better place, product by product.

Among us, there are world-class AI scientists, industry veteran engineers, and award-winning designers. We're united by our shared mission to bring the best quality to every home with intelligent technology.

Thank you for being a part of this exciting goal: clean less, live more.

# Package Contents

Main body

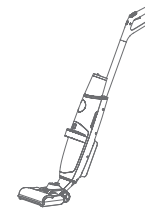

Main body

Accessory



Handle



Clean water tank

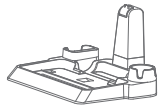

Charging station



Power adapter



Multi-purpose roller brush



Long cleaning brush



Filter cleaning brush



HEPA

Note: Due to the continuous improvement of the Nano, the product in this manual is subject to the actual product, and SpeedFox reserves all rights to update the product without notice.

# Start Using

- 01. Product Parts
- 02. Button Functions
- 03. LCD Panel
- 04. App Function
- 05. Product Disassembly
- 06. Operating Manual
- 07. Safety Instructions

## 01. Product Parts

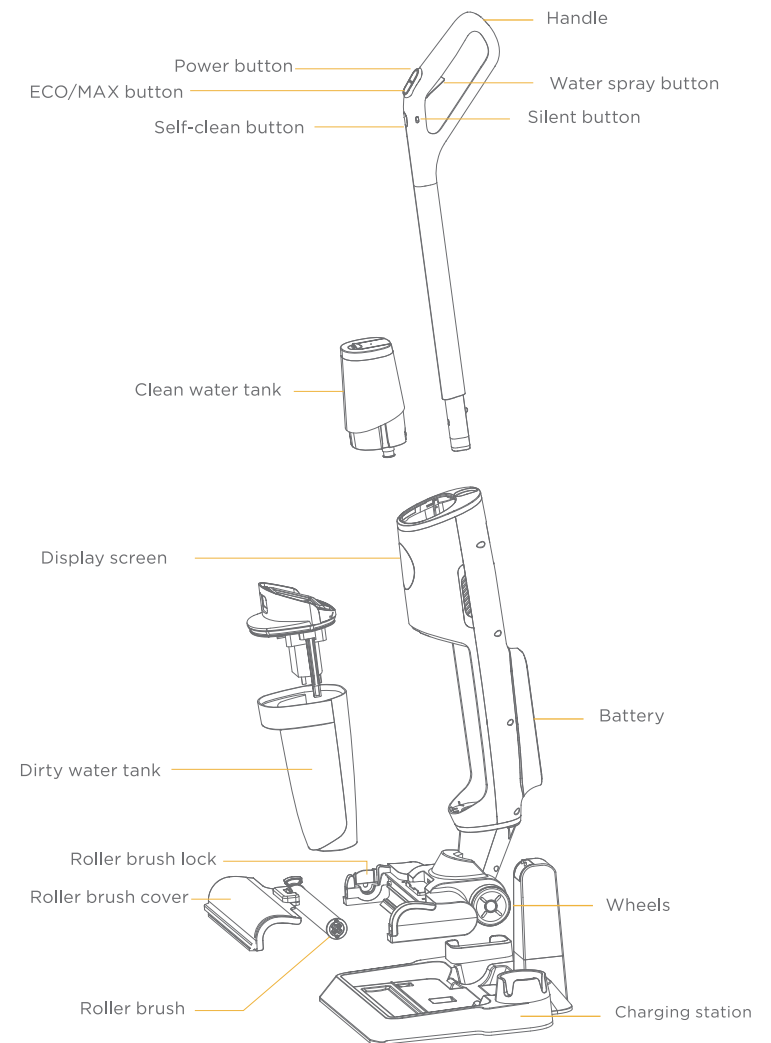

## 02. Button Functions

### ① Power button

Press lightly to turn on/off.

### ② ECO/ MAX button

Default mode is ECO mode, press to switch to MAX mode.

### ③ Water spray button

Default mode is "dry" mode, press water spray button once for "Water Level 1", and twice for "Water Level 2" for tougher areas.

### ④ Self-cleaning button

The vacuum must be docked in the charging station when using this function. Lightly touch the self-clean button and the product will automatically enter self-cleaning mode for 60 seconds.

### ⑤ Silent button

Voice remind switch on/off.

## 03. LCD Panel Instructions

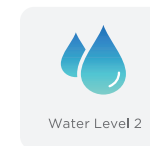
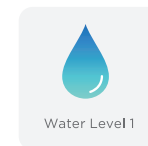
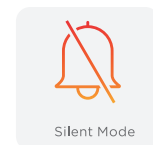
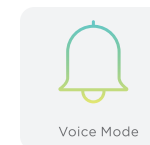
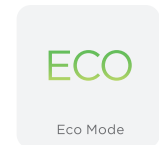
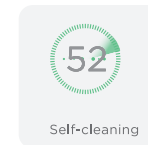
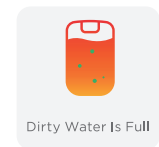
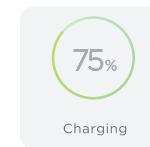

## 04. App Function

### 1. Register and login

You can enter your cell phone number/email address, get the verification code, enter the verification code and set the account login password to login the App, and use the account password to login again.

### 2. Personal information modification

Click on the avatar to enter user information title bar, click on each of the corresponding title bars, and you can modify your avatar, nickname, and time zone

### 3. Contact us - Help and Feedback

"Me" page at the bottom navigation bar, click on FAQ and Feedback, then click on Feedback/Suggestions, enter the title in the page, describe the problem, upload relevant pictures or videos then submit. One of the customer service agents will reply within the specified time to solve the problem.

### 4. Add device - Network Connection

Turn on the Bluetooth and WiFi on your phone, place the device on the dock to turn on charging, long press the self-cleaning button on the handle for more than 3 seconds, the WiFi icon will flash on the device screen and start to enter the pairing mode; click Add Device on the App home page, select the model, fill in WiFi name and password for the phone to connect and then turn on pairing, after successful connection you can view the device status online and control the device, if the connection fails, follow the list of reasons for network failure to check one by one and then add the device again.

### 5. Machine control - Cleaning

Mode: Select the device you wish to view or control in the home page device list. When the device is online, click to enter the control page.

- a. Cleaning mode: select one of the preset cleaning modes to meet the different cleaning scenarios.
- b. Ambient lighting: in addition to the preset colors, you can also customize a variety of ambient colors to meet the needs of a variety of ambient scenes.
- c. Consumables maintenance: you can view the service life of a number of supplies, and can directly jump to buy.
- d. Cleaning records: you can view a number of cleaning data and statistics of the device.



### 1. Handle assembly & disassembly

- Assembly: align handle and main body, lightly push down to complete the installation, you will hear "CLICK" when installed correctly.
- Handle removal: use a screwdriver or other tool to insert into the small hole located on the back of the handle to release the safety lock; pull away to remove the handle.

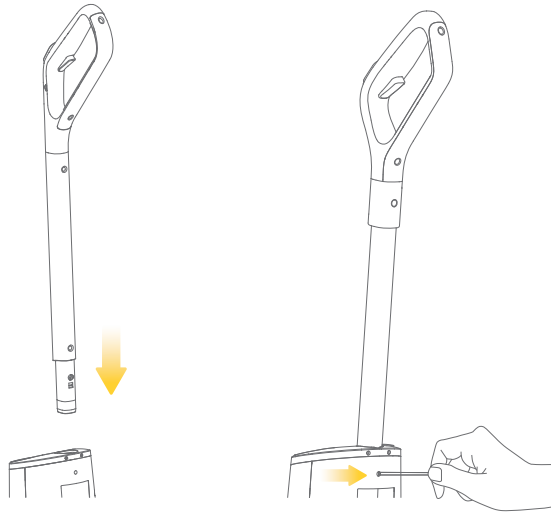

### 2. Clean water tank assembly & disassembly

- Assembly: align the clean water tank with the opening slot on the main body, then push down to complete the installation.
- Disassembly: pull the tank slightly up and away from the vacuum body to remove the clean water tank.

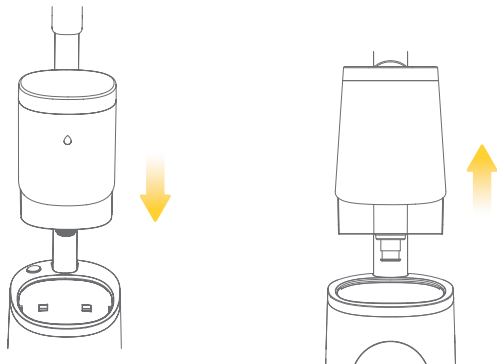

### 3. Dirty water tank assembly & disassembly

- Assembly: align the dirty water tank with the opening on the main body; push it inwards to complete the installation.
- Disassembly: hold the main body, press the lock and gently pull the dirty water tank away from the main body.

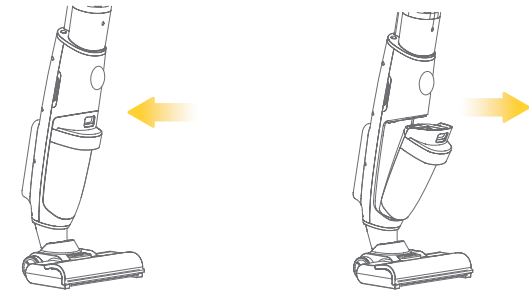

### 4. Roller Brush assembly & disassembly

- Assembly: open the roller brush cover and align the roller brush to the buckle to complete the installation.
- Disassembly: open the roller brush cover and pull up on the roller brush lock to release and remove the roller brush.

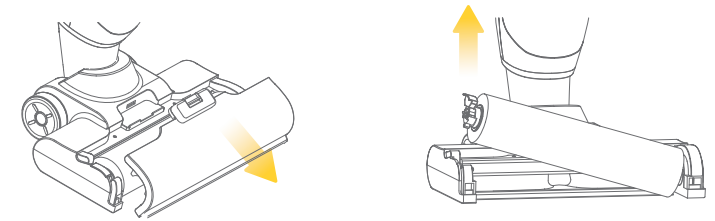

### 5. Charging station

- Make sure the charging base is connected to the power adapter.
- Place the device on the charging station to charge.
- Please use the original power adapter to charge the vacuum. The device will automatically power off after charging is completed and will enter charge-protection mode.

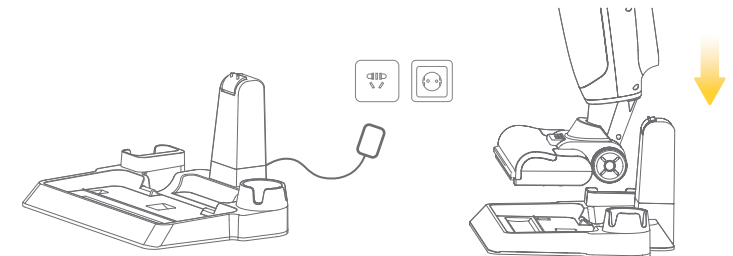

## 05. Operating manual

### 1. Main body

Make sure that the handle, clean water tank, dirty water tank, and roller brush are properly installed before use.

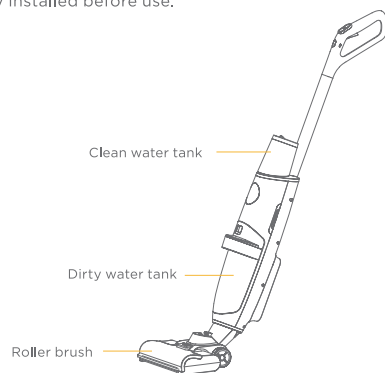

### 2. Roller brush

Install different roller brushes to match different floor types (floor brushes are suitable for hard floors; carpet brushes are suitable for carpets).

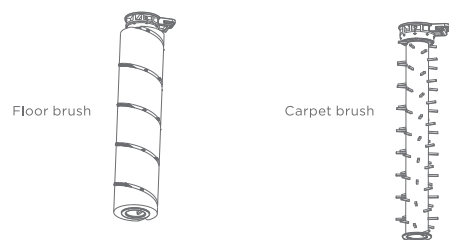

### 3. Clean water tank

Fill the water tank or approved cleaning solution before use.

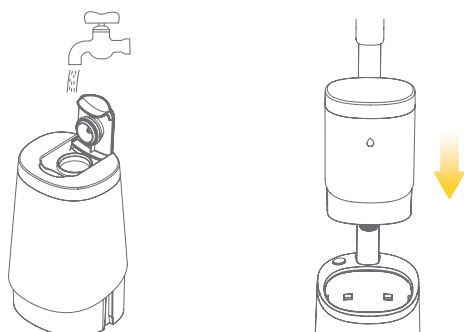

### 4. Power on

Press the power button, tilt the body to a suitable angle, and start cleaning.

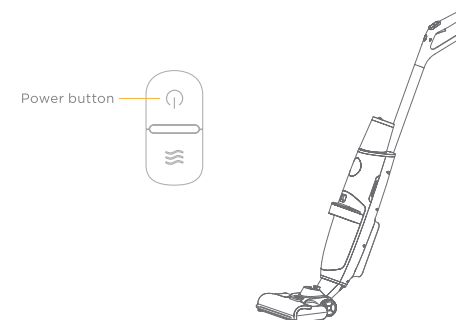

### 5. Cleaning mode

Default ECO mode is used for daily cleaning. Larger messes or stubborn stains may require the use of the MAX setting. Press the ECO/MAX button to switch to a more powerful cleaning mode.

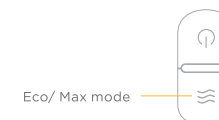

### 6. Water volume mode

Default dry suction mode is used for cleaning dust and dry surfaces. In case of large, stubborn stains, wet surface, etc., switch to the "Water level 1" or "Water level 2" mode for cleaning.

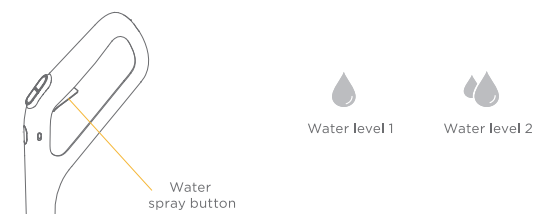

### 7. Self-cleaning

Simply put the device back onto the charging station and press the self-clean button to start self-cleaning mode.

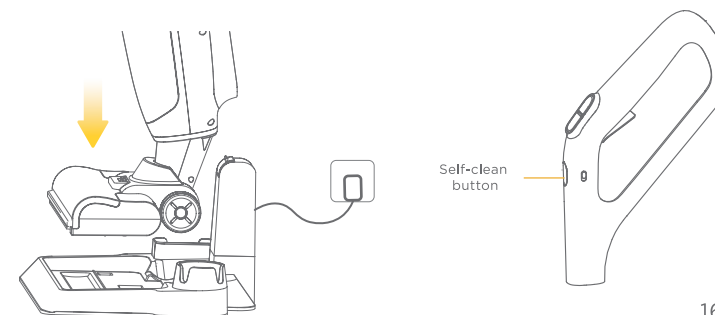

## 8. Charging

Place the device on the charging station and it will enter the charging mode. After charging is complete, the device will automatically switch to charge-protection mode.

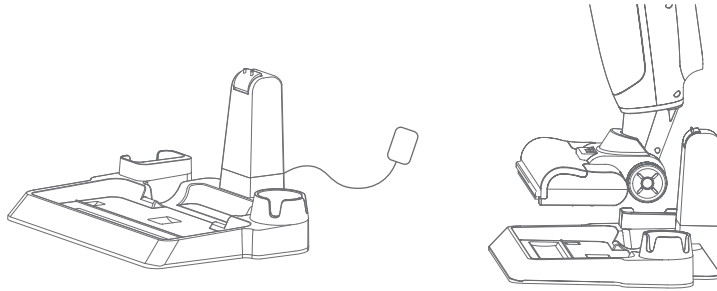

## 9. Clean the dirty water tank

Please take out and clean the dirty water tank after each use.

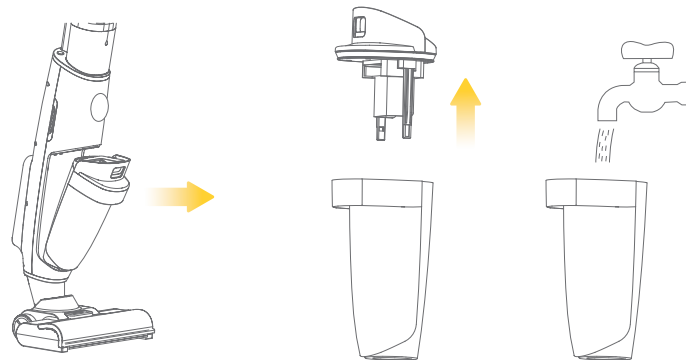

### Note:

1. The use of cleaning agents or solutions that create foam will result in foam forming in the collection tank. This may result in a blockage of water inflow and create an inaccurate water level reading of the collection tank. This "false alarm" will cause the vacuum to cease suction.
2. Monitor the collection tank to avoid blockage; the sensor may cause "false alarm".
3. Do not push forward and backward too quickly during the cleaning process, to avoid water entering the main fan.
4. Before using, please make sure that there are no debris in the filter. Debris in the filter can create blockages and affect performance.
5. Please power off the machine before charging.

## 07. Precautions



### Safety warning

1. Tampering or disassembling the machine is prohibited.
2. Be sure the power is off before conducting maintenance on the machine.
3. Do not touch the socket, power adapter, or display screen while your hands are wet to avoid the risk of electric shock.
4. Please use the power adapter specifically equipped with this product for charging.
5. If the power adapter is damaged, please stop using it immediately and contact [support@hispeedfox.com](mailto:support@hispeedfox.com) for replacement parts.
7. Please stop using the device immediately if you find the device is leaking water, motor temperature is strangely high and abnormal noise, odor, suction, etc. Please contact [support@hispeedfox.com](mailto:support@hispeedfox.com) for assistance.
8. Do not wet the vacuum's body, as it may cause fire and/or electric shock due to short circuit of the device.
9. Do not block the air inlet and outlet to prevent the device from overheating.
10. Do not soak the base in water.
11. Do not shake or bump the machine violently against obstacles.
12. When moving the machine, keep the machine upright to prevent drainage/debris from flowing into the motor.
13. If the clean water tank and dirty water tank are not installed, please refrain from using the water function.
14. Do not use in environment lower than 14°F and or higher than 113°F.
15. This product is best suited for indoor use, in a home environment—it is not suited for commercial use.
16. This product is suitable for short-haired carpets and hard floors in the home environment. Hard floor surfaces include marble floors, wooden floors, tile floors, solid wood floors, and composite floors.
17. Do not use this product to remove unextinguished heat sources such as cigarette butts and matches.
18. Do not use this product to remove flammable, explosive or highly volatile liquids, such as gasoline, kerosene, paint, perfume, etc. These liquids may cause the product to short-circuit or create an explosion.
19. Do not use this product to clean the toner or toner used in laser printers and copiers to avoid fire or explosion.
20. Do not use this product to remove sharp objects, such as glass shards, pushpins, nails, paper clips, rocks, etc., to avoid damage.
21. Do not use this machine to remove stains such as paint, shoe polish, etc.
22. Do not use this product to absorb foam liquid, as this can damage the motor.
23. Cleaning solutions should be placed out of the reach of children at all times.
24. Please configure the concentration of the cleaning solution according to the suitable floor types, and do not use foaming products.

# Product Maintenance

## 1. Body maintenance

It is recommended to wipe the dust with a dry cloth for routine maintenance. Do not wash the main vacuum body with water.

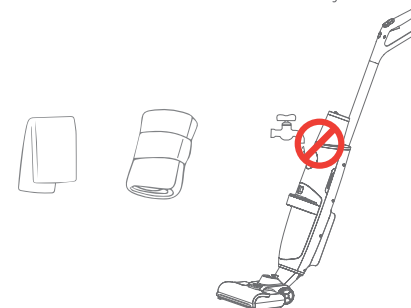

Note: Before maintenance, power off the device, and remove the clean water tank and the dirty water tank.

## 2. Tractor maintenance

Regularly clean the residual stains of the roller brush vacuum cover, rollers, and scrapers to keep the vacuum in proper working order.

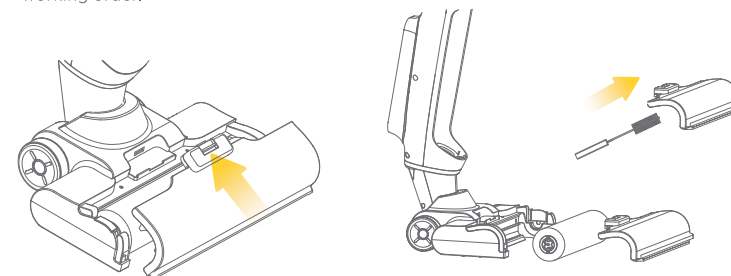

## 3. Clean the dirty water tank

Take out the upper cover of the dirty water tank (including the filter element assembly) and clean the inside of the recovery tank with clean water.



#### 4. Clean the HEPA filter

Regularly remove the HEPA filter from the upper cover of the dirty water tank, rinse the dirt off with clean water, and air dry to keep the filter dry and clean.

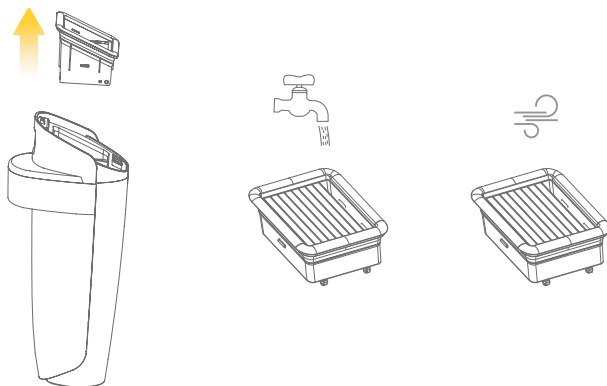

#### 5. Clean the roller brush

Remove the roller brush. Use the roller brush cleaning tool that comes with the device to clean hairs or debris entangled in the brush head. Rinse with clean water and place it in the vent to dry.

#### 6. Clean the brush cover and pipe

Use the cleaning tools provided with the device to clean the dirt left by the brush cover or pipe and keep the air duct and water channel open.

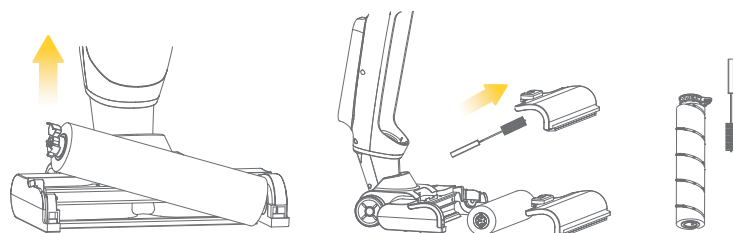

#### 7. Clean the charging station

Clean the charging station regularly; do not let the charging port get wet, make sure it is dry before use.

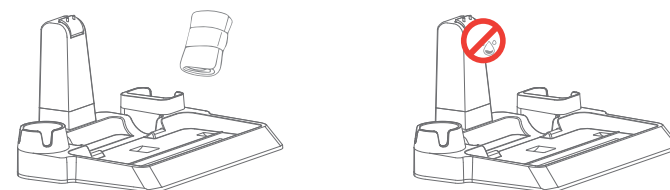

#### 8. Battery maintenance

The device should be fully charged at least once every three months to keep the battery in a healthy state.

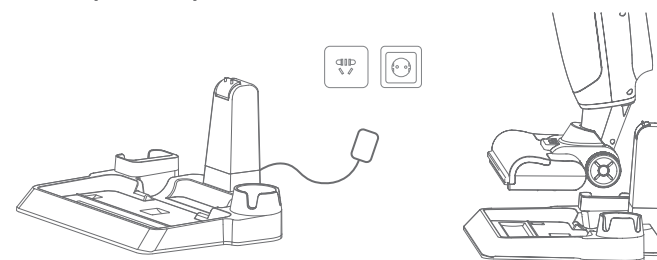

#### 9. Product storage

Please clean the clean water tank, dirty water tank, and roller brush, before storing them separately. The storage location should be kept dry, ventilated, and away from sunlight.

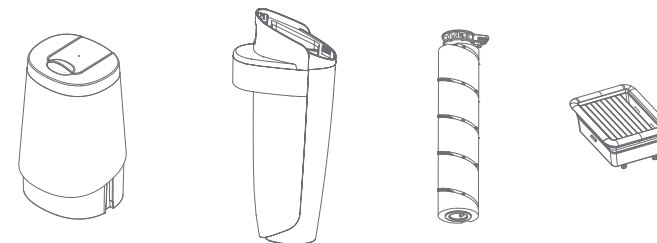

# Trouble Shooting











Frequently Asked Questions

Error Code Prompt

## Frequently Asked Questions

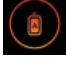
Common Issues	Possible Cause	Solution
<b>Machine not turning on</b>	<ul style="list-style-type: none"><li>• Dirty water tank at maximum capacity</li><li>• Roller brush is entangled</li><li>• Roller brush not installed</li></ul>	<ul style="list-style-type: none"><li>• Clean the dirty water tank</li><li>• Clean the roller brush</li><li>• Follow instructions on how to properly install the roller brush</li></ul>
<b>Machine cannot be charged</b>	<ul style="list-style-type: none"><li>• The main unit and charger are not in contact</li></ul>	<ul style="list-style-type: none"><li>• Check the main unit and charger sockets</li></ul>
<b>Water Spray not working</b>	<ul style="list-style-type: none"><li>• Clean water tank not properly installed</li><li>• No water in water tank</li></ul>	<ul style="list-style-type: none"><li>• Reinstall the clean water tank</li><li>• Fill the clean water tank with water</li></ul>
<b>Water at the air duct</b>	<ul style="list-style-type: none"><li>• No filter installed in the dirty water tank</li><li>• Filter is not dry</li></ul>	<ul style="list-style-type: none"><li>• Refer to user's manual on how to properly maintain and clean the filter</li><li>• Follow instructions on how to properly install</li></ul>
<b>The indicator of the water tank is inaccurate</b>	<ul style="list-style-type: none"><li>• Water tank is not properly calibrated</li></ul>	<ul style="list-style-type: none"><li>• Take out the water tank, turn on the machine to spray water, drain water in the pipe, and turn off the machine. Then, press and hold the power button and shift button for 5 seconds to reset the machine</li></ul>
<b>"Dirty tank full" signal is prompted, but tank is not full</b>	<ul style="list-style-type: none"><li>• Filter/HEPA filter blocked</li><li>• Filter is too wet</li></ul>	<ul style="list-style-type: none"><li>• Clean the filter/HEPA to rid of any debris</li><li>• Make sure filter is dry before use</li></ul>
<b>Machine shakes during use</b>	<ul style="list-style-type: none"><li>• Roller brush not properly in place</li></ul>	<ul style="list-style-type: none"><li>• Reinstall the roller brush, please refer to user's manual for instructions</li></ul>
<b>Machine leaking, weak suction power</b>	<ul style="list-style-type: none"><li>• Filter is too wet</li></ul>	<ul style="list-style-type: none"><li>• Clean and dry the filter</li></ul>

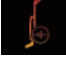
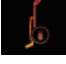
# Error Code Prompt

Error Codes	Possible Reasons
	NTC open/short circuit
	Low charging temperature
	High charging temperature High discharging temperature
	Rechargeable battery voltage difference is too large
	Rechargeable battery voltage is too low
	Battery short circuit protection
	Charging current is too large
	Discharge overcurrent protection
	Brush motor short circuit protection
	Brush motor overcurrent protection
	Dirty water tank missing
	Short circuit protection

# Product Specifications

Specifications

Hazardous Material Disclaimer

# Product Specifications

## Speedfox Nano

Power	Voltage	21.6V
	Wattage	150W
	Motor Speed	25000 RPM
	AW	38aW
	Suction	5 Kpa (ECO) /5.5 Kpa (MAX)
Battery & Adapter	Power Adapter	100-240V-50/60Hz Input DC 27V-1.2A Output
	Battery	2600 mAh
	Usage time	Max mode approximately 25 minutes Eco mode approximately 30 minutes
Smart Function	Voice Prompts	On/off
	Screen Display	LCD Display
	Wi-Fi	Press and hold the Self-Clean button for 3 seconds
	App Function	Real-time display of cleaning status
	Ambient Lighting	RGB Multi-Color Lighting
Product Description	Standard Clean Water Capacity	600ML
	Dirty Water Tank Capacity	550ML
	Noise Level (dB)	Approximately 75dB
	Filter	Removable and washable HEPA Filter
	Body Dimensions	45.67*9.45*11.02 in
	Net Weight	7.9 lb
	Gross Weight	15.43 lb

\*The above data comes from our company's laboratory. The actual usage varies according to the usage environment. Please refer to the actual usage.  
\*Due to continuous improvement of the product, Lightchaser/Speedfox reserves all rights to make any technical and design changes to the product, and the right of interpretation belongs to the company.

## Speedfox Nano Pro

Power	Voltage	21.6V
	Wattage	186W
	Motor Speed	83000RPM
	AW	57aw
	Suction	9.5Kpa(ECO) /12Kpa (MAX)
Battery & Adapter	Power Adapter	100-240V-50/60Hz Input DC 27V-1.2A Output
	Battery	5000 mAh
	Usage time	Max mode approximately 30 minutes Eco mode approximately 45 minutes
Smart Function	Voice Prompts	On/off
	Screen Display	LCD Display
	Wi-Fi	Press and hold the Self-Clean button for 3 seconds
	App Function	Real-time display of cleaning status
	Ambient Lighting	RGB Multi-Color Lighting
Product Description	Standard Clean Water Capacity	600ML/900ML (Built-in two clean tank)
	Dirty Water Tank Capacity	550ML
	Noise Level (dB)	Approximately 75dB
	Filter	Removable and washable HEPA Filter
	Body Dimensions	45.67*9.45*11.02 in
	Net Weight	8.3 lb
	Gross Weight	15.43 lb

\*The above data comes from our company's laboratory. The actual usage varies according to the usage environment. Please refer to the actual usage.  
\*Due to continuous improvement of the product, Lightchaser/Speedfox reserves all rights to make any technical and design changes to the product, and the right of interpretation belongs to the company.



# Hazardous Material Declaration

Component	Content of Hazardous Substances						
	Plastic Shell	PCB	Cables	Metal Parts	Adapter	Electronic Components	Rubber Components
Cadmium(Cd)	○	○	○	○	○	○	○
Lead(Pb)	○	○	○	X	○	○	○
Mercury(Hg)	○	○	○	○	○	○	○
Hexavalent Chromium (CrVI)	○	○	○	○	○	○	○
Polybrominated Biphenyls(PBB)	○	○	○	○	○	○	○
Polybrominated Diphenyl Ethers (PBDE)	○	○	○	○	○	○	○
Bis(2-ethylhexyl) Phthalate(DEHP)	○	○	○	○	○	○	○
Butyl Benzyl Phthalate (BBP)	○	○	○	○	○	○	○
Dibutyl Phthalate (DBP)	○	○	○	○	○	○	○
Diisobutyl Phthalate (DIBP)	○	○	○	○	○	○	○
<p>The time of the components for environment protection concern is 10 years. The time is valid under the use conditions of this manual.</p> <p>○: It indicates that the content of the hazardous substances in all homogeneous materials of the compoents is in compliance with the council RoHS 2 Directive (EU) 2015/863 and (EU) 2017/2102 amending Annex II to Directive 2011/65/EU.</p> <p>X: It indicates that the content of the hazardous substances in all homogeneous materials of the compoents is the exempt item according to the council RoHS 2 Directive (EU) 2015/863 and (EU) 2017/2102 amending Annex II to Directive 2011/65/EU due to the exsiting level of technology.</p>							

# Recycling



The symbol on the product or on its packaging indicates that this product may not be treated as household waste. Instead it should be taken to the appropriate collection point for the recycling of electrical and electronic equipment. By ensuring this product is disposed of correctly, you will help prevent potential negative consequences for the environment and human health, which could otherwise be caused by inappropriate waste handling of this product. For more detailed information about recycling of this product, please contact your local council, your household waste disposal service or the shop where you purchased the product.



The product meets all the necessary requirements of the EU directives applicable to the specific product.



The product meets all the requirements of the FCC

We reserve the right to changes in text, design, and technical specifications which are subject to change without prior notice.

## Warranty

### FCC Statement

This equipment has been tested and found to comply with the limits for a Class B digital device, pursuant to part 15 of the FCC Rules. These limits are designed to provide reasonable protection against harmful interference in a residential installation. This equipment generates, uses and can radiate radio frequency energy and, if not installed and used in accordance with the instructions, may cause harmful interference to radio communications. However, there is no guarantee that interference will not occur in a particular installation. If this equipment does cause harmful interference to radio or television reception, which can be determined by turning the equipment off and on, the user is encouraged to try to correct the interference by one or more of the following measures:

- Reorient or relocate the receiving antenna.
- Increase the separation between the equipment and receiver.
- Connect the equipment into an outlet on a circuit different from that to which the receiver is connected.
- Consult the dealer or an experienced radio/TV technician for help.

Caution: Any changes or modifications to this device not explicitly approved by manufacturer could void your authority to operate this equipment.

This device complies with part 15 of the FCC Rules. Operation is subject to the following two conditions: (1) This device may not cause harmful interference, and (2) this device must accept any interference received, including interference that may cause undesired operation.

### RF Exposure Information

This equipment complies with FCC radiation exposure limits set forth for an uncontrolled environment. This equipment should be installed and operated with minimum distance 20cm between the radiator and your body.