

What's that sound?

A peek inside your speaker driver

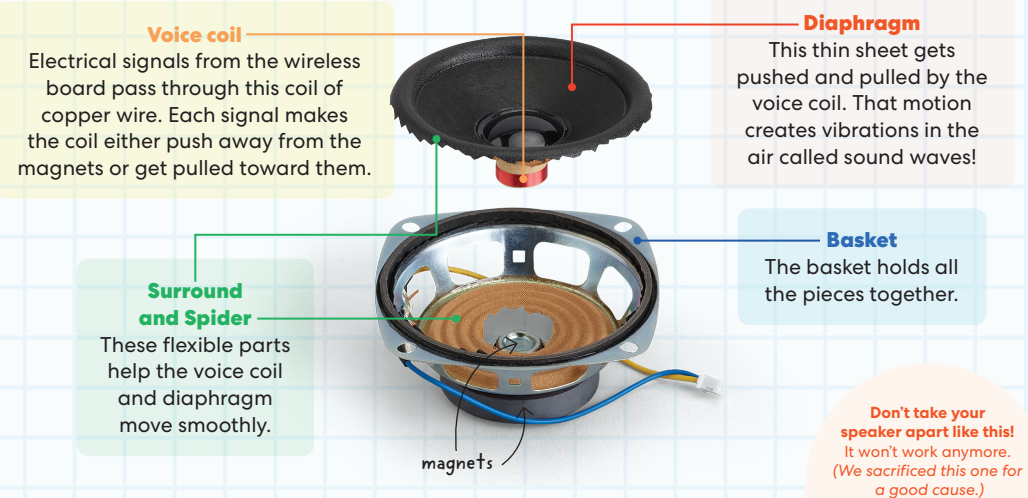

Want more?
Check out **KiwiCo.com**

© 2025 KiwiCo, Inc. KIWICO and the Bird Design are trademarks of KiwiCo, Inc. registered in the USA and other countries. All rights reserved. SSKR.

Keep the instruction sheet since it contains important information.

Connect
with us!



#KiwiCo

⚠ WARNING

CHOKING HAZARD — Small parts.
Not for children under 3 years. Only
for use by children aged 7 years and
older. Keep the instruction sheet since
it contains important information.

Silly Speaker



Welcome, Builder!

Build your speaker	2
Speaker setup	20
Face it!	21
Troubleshooting	24
The science of sound	25



The science of sound

How does music go from a device to your ear?

When you pick your favorite song on a smartphone or music player, it sends a signal to the wireless board in the speaker.

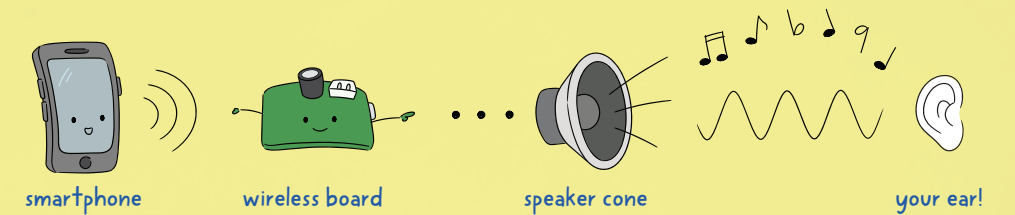

The wireless board turns the signals into an electrical pattern, then sends it to the speaker driver. The electrical pattern makes the speaker cone flex in and out.

As the speaker cone moves back and forth, it makes waves in the air nearby. The waves travel to your ear, and you hear your favorite song!



Troubleshooting

If the blue light doesn't blink or turn on . . .

make sure the cable is securely plugged in at both ends.

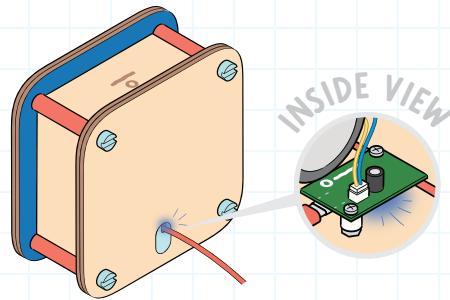

If you can't find the speaker on your device . . .

make sure the blue light on the speaker is blinking. If the light is on but not blinking, the speaker is connected to a different device. Turn off Bluetooth settings on that device for the speaker to enter pairing mode again.

If your device can see KiwiCo Speaker but can't connect . . .

restart your device.

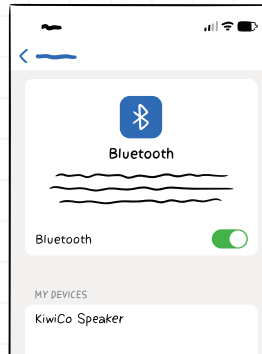

If the speaker beeps over and over . . .

try a different USB-C power source.

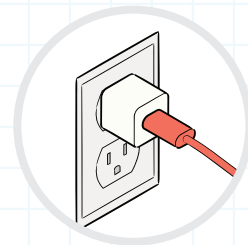

What you get

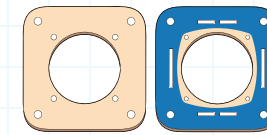

front panels

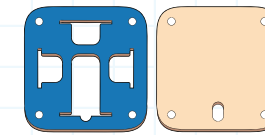

back panels

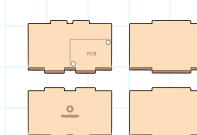

side panels

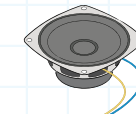

speaker driver

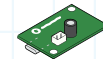

wireless board



spacers



bolts



screws



washers



nuts



cable anchor

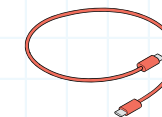

cable

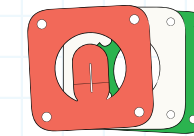

face pieces



wiggle eyes



wrench



screwdriver

Build your speaker

Engineer your own cool sound box.

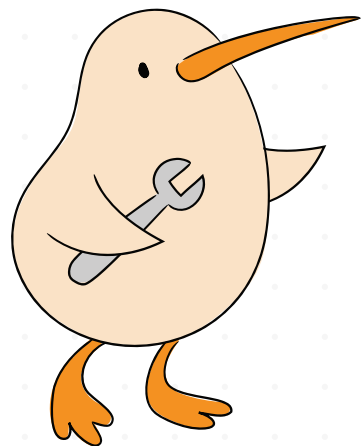

2 Build your speaker

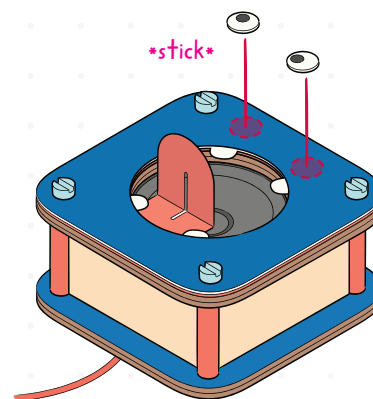
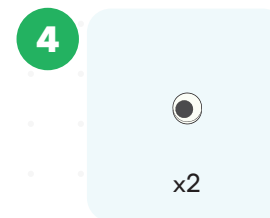
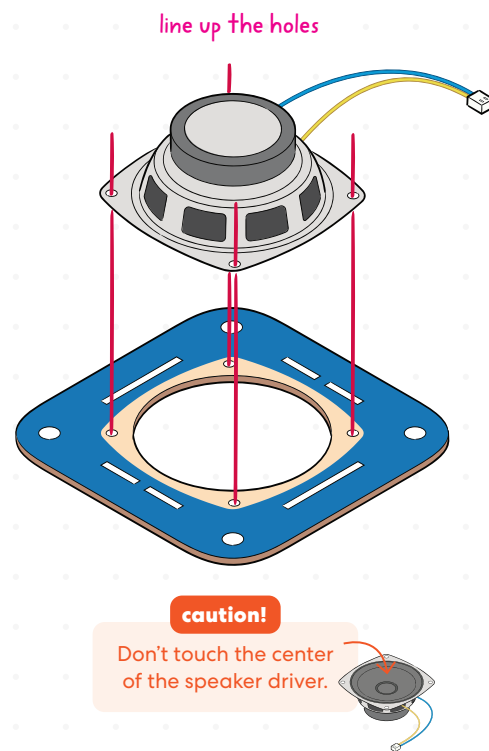
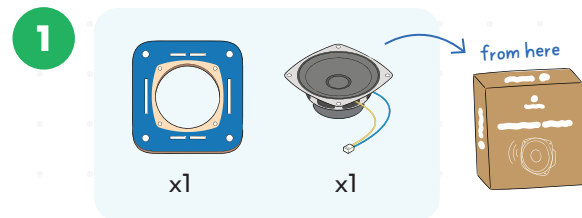

Mood music

Change the face to fit your vibe.

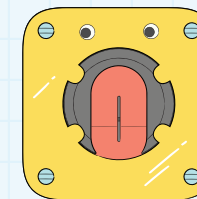
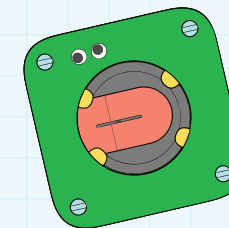

Mix and match the pieces any way you like!

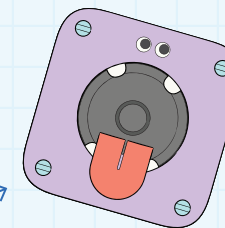

2

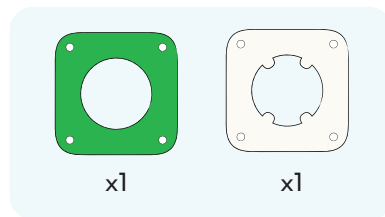

pick whatever order and color you want!

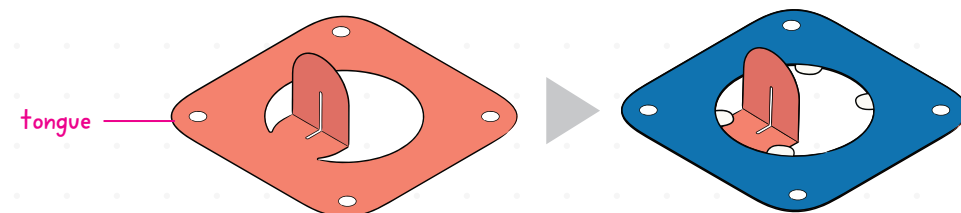
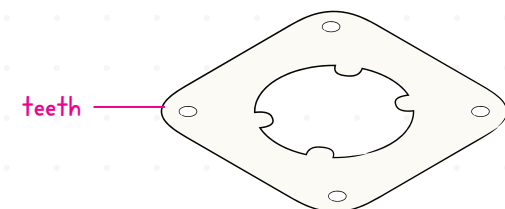
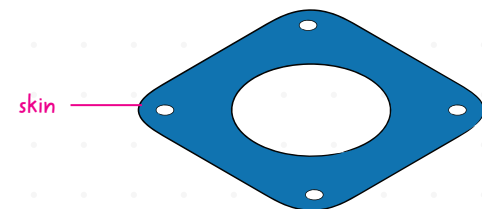

3

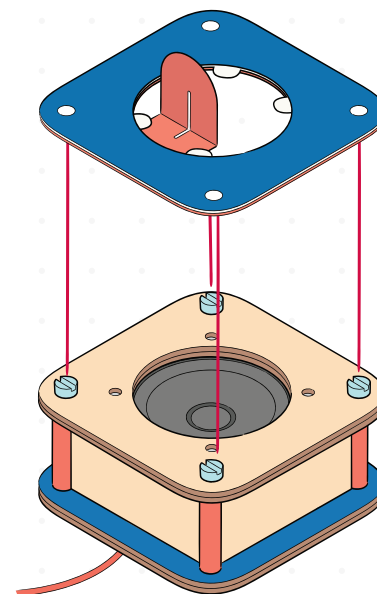

lay your speaker down

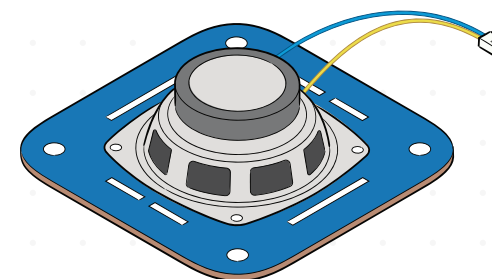

Stop & Check

Make sure the wires face a side with 2 slots.

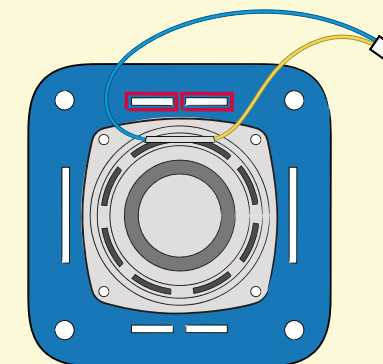

Face it!

You get three face pieces with different colors on each side. Layer them any way you want to give your speaker some personality!

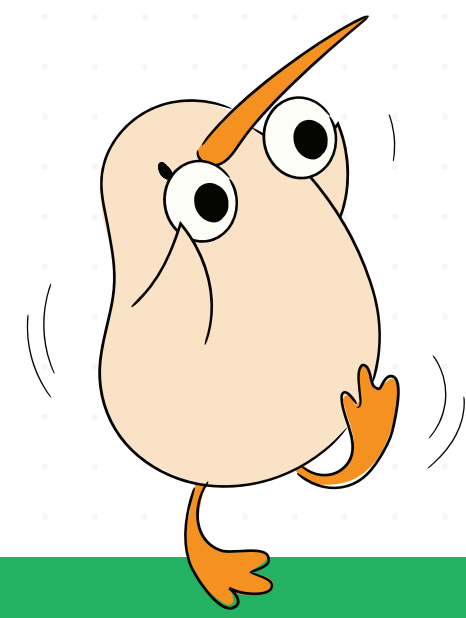

2

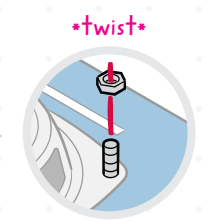
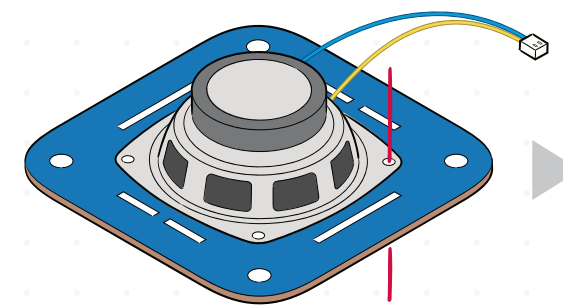
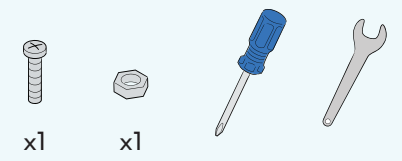

poke

tip!

Use the screwdriver and wrench to tighten.

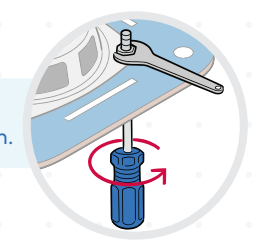

1

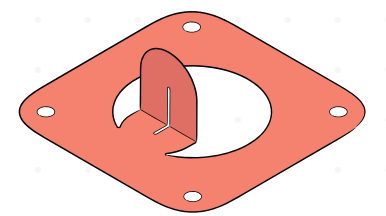
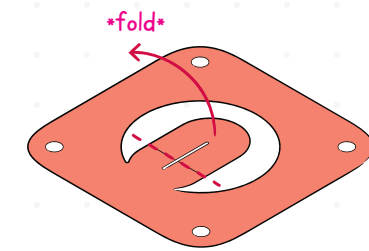
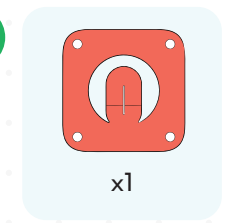

Speaker setup ^{M3}

- 1** Plug the cable into a USB-C power source. The speaker will beep and the blue light will flash.

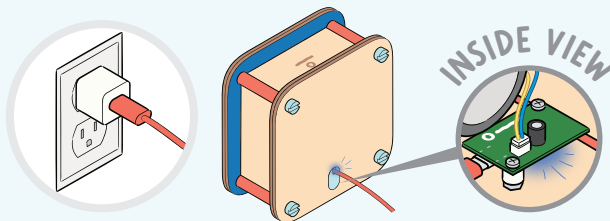

- 2** On your device with Bluetooth technology, go to the Bluetooth settings and enter pairing mode. Select KiwiCo Speaker to connect.

When paired, the speaker will beep again and the blue light will stay on.

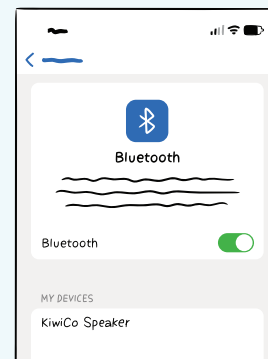

- 3** Play some music!

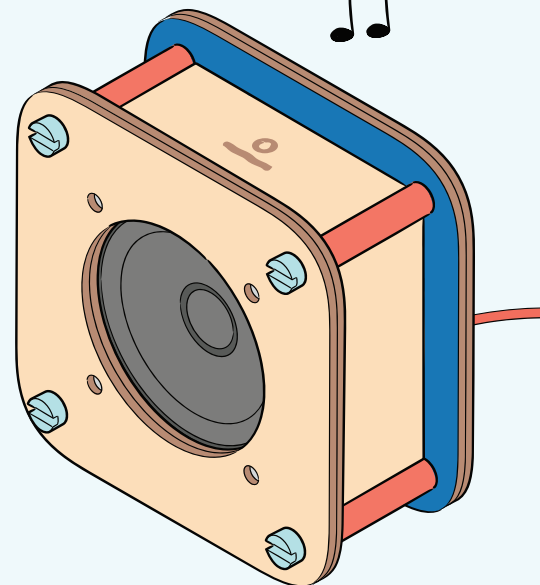

3

