

·English

Quick Installation Guide

·English

1. Product Overview

The Urant Wireless Router is connected to your router wirelessly, strengthening its signal and expanding its coverage into areas that could not otherwise be reached. The device also reduces signal interference to ensure reliable Wi-Fi coverage throughout your home or office. Easy Installation & Quick Position. The extender works with any standard wireless router. Follow the Quick Setup instructions on the extender's web management page. Once the extender is connected to a router, you can relocate it to your preferred location with no further configuration required. The intelligent signal light can help to find the best location.

2. Appearance



Antennas

Used for wireless operation and data transmit. Upright them for the best Wi-Fi performance.

- Tips:
1. If this is not the first time setting, please press and hold the RESET button inside the tiny hole for 8 seconds and wait for the WiFi signal function to recover before reset.
 2. Successfully set the repeater mode next to the router, and then try to move the repeater to another reasonable position, and the model behind the repeater is stronger.
 3. If you need to reset the 1200M Wireless Repeater, you need to press and hold the reset button inside the tiny hole for 8 seconds.

Reset button

4. Port and Button Description

Name	
WPS	WPS connection
RESET Button	With the wireless router powered on, use a pin to press the RESET button for 8 seconds. The wireless router will reboot.
WAN Port	For connecting to a DSL/Cable modem, or an Ethernet jack.
LAN Port	For connecting your PC or other wired devices to the router.

3. LED Explanation

You can check the Wireless Router's working status by following the LED Explanation table.

Name	Status	Indication
Power	On/Off	The Wireless Router is on or off
2.4G	Blinking	The Wireless Router's 2.4G wireless function is enabled
5G	Blinking	The Wireless Router's 5G wireless function is enabled
WAN	Blinking/Off	The WAN port is connected or not connected to a powered-on device.
LAN	Blinking/Off	The LAN port is connected or not connected to a powered-on device.
WPS	Blinking	WPS connection in progress
	ON	WPS connection is established
	OFF	WPS connection has been established for more than 5 minutes or WPS connection failed
Signal (Signal strength)	Bright	Indicates the Wi-Fi connection between the Wireless Router and the router. More lit LEDs indicate a better signal strength (only valid in WPS mode)
	Blinking/Off	The Wireless Router is connected or not connected to the Internet.

Repeater Mode

1. Power On

Plug the Repeater into an electrical outlet next to your host router, and then wait until the 2.4G wireless and 5G wireless LED is on.



Host Router



Solid on

2. Set Up

Method 1: Via the WPS Button

1. Press the WPS button on your router

The WPS button might look like one of these:



2. Within 2 minutes, press the WPS button on the extender for 1 second. The WPS/LED should change from blinking to solid and the repeater should restart, indicating successful.

Note: If the LED does not Blink try again or use Method 2



Note: If you cannot find the network names with EXT in your Wi-Fi network list, try again or use Method 2

3. Select your host router's 2.4GHz SSID or 5GHz SSID (network name)

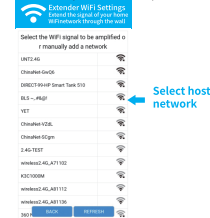

Select host network

Method 2: Via a Web Browser Connect to the repeater For Phone Users

1) Find the SSID (Network Name) and Wireless Password printed on the label at the bottom of the router.

2) Connect your smartphone to the extender's network

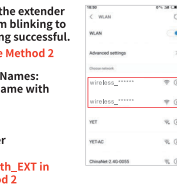

Click [Next] and follow the prompts on the page to complete the Router mode configuration

2: launch a web browser, and enter http://192.168.168.1 in the address bar.

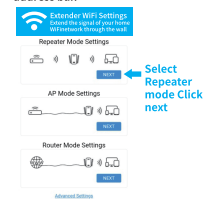

Select Repeater mode Click next

Note down your extended network information and finish the step

6: Connect to the extended network and enjoy the internet. The extended network shares the same wireless password as that of your host network but may have a different network name if you have customized the SSID during the configuration.

Note: Since the performance of the extended network will be affected by the distance between the extender and the host router, we highly recommend you relocate your extender by referring to Position Your Extender.

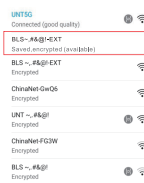

8: Position Your Extender

Please follow the instructions below to achieve optimal performance of the extender.

1. Plug the extender into an electrical outlet between your host router and the Wi-Fi "dead-zone". The location you choose must be within the range of your existing host network.
2. Wait until the LEDs are lit. Make sure the extender is in allocation with 2 or more LEDs lit. If not, relocate it closer to the router to achieve better signal quality.



Tips: To minimize signal interference, please choose a location that is far away from Bluetooth devices and other household electronic devices, such as cordless phones, microwave ovens, and baby monitors

Repeater Mode

1. Connect the Hardware

If your Internet connection is through a DSL/Cable modem, follow steps 1, 2 and 4 to complete the hardware connections. If your Internet connection is through an Ethernet cable from the wall, follow steps 3 and 4 to complete the hardware connection.

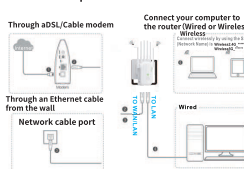

2. Connect to the repeater For phone Users

1: 1) Find the SSID (Network Name) and Wireless Password printed on the label at the bottom of the router. 2) Connect your smartphone to the extender's network.

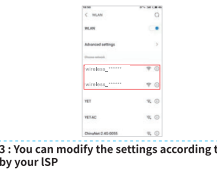

2: launch a web browser, and enter http://192.168.168.1 in the address bar. Select Router Mode

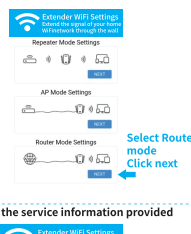

Select Router mode Click next

3: You can modify the settings according to the service information provided by your ISP

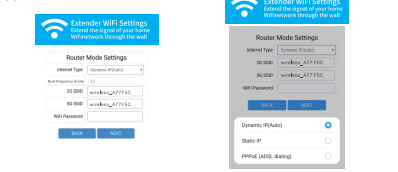

Select your internet connection type from the drop-down list

If you choose Dynamic IP, Dynamic IP users are usually equipped with a cable TV or fiber cable.

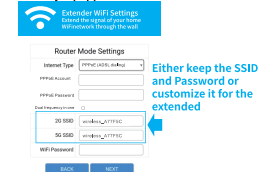

Either keep the SSID and Password or customize it for the extended

Click [Next] and follow the prompts on the page to complete the Router mode configuration

If you choose PPPoE, enter the username and password provided by your ISP. PPPoE users usually have DSL cable modems.

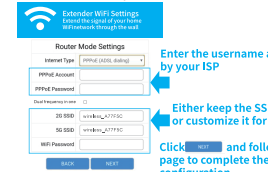

Enter the username and password by your ISP

Either keep the SSID and Password or customize it for the extended

Click [Next] and follow the prompts on the page to complete the Router mode configuration

If you choose Static IP, enter the information provided by your ISP in the corresponding fields.

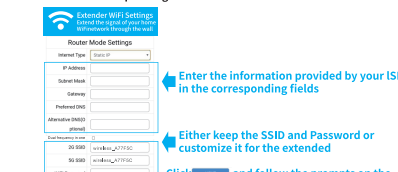

Enter the information provided by your ISP, in the corresponding fields

Either keep the SSID and Password or customize it for the extended

Click [Next] and follow the prompts on the page to complete the Router mode configuration

Enjoy! Connect to the Extended networks (default SSID and password) and enjoy internet, but may have different network name and password, if you have customized them during the configuration.

AP Mode

1. Connect the Hardware

Connect your computer to the router (Wired or Wireless)

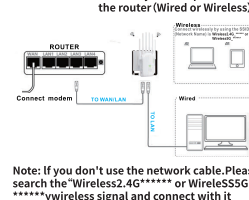

Note: If you don't use the network cable, please search the "Wireless2.4G*****" or "Wireless5G*****" wireless signal and connect with it



Either keep the SSID and Password or customize it for the extended

Click [Next] and follow the prompts on the page to complete the Router mode configuration

Connect to the Extended networks (default SSID and password) and enjoy internet, but may have different network name and password, if you have customized them during the configuration.

2. Connect to the repeater For phone Users

1: 1) Find the SSID (Network Name) and Wireless Password printed on the label at the bottom of the router. 2) Connect your smartphone to the extender's network.



2: launch a web browser, and enter http://192.168.168.1 in the address bar. Select AP Mode

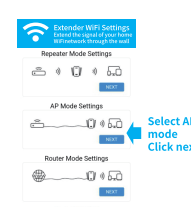

Select AP mode Click next

Frequently Asked Questions (FAQ)

Q1. What can I do if the login window does not appear? If the computer is set to a static or fixed IP address, change the setting to obtain an address automatically. Verify if http://192.168.168.1 is correctly entered in the web browser. Make sure your computer is connected to the Mini Router's network. Use another web browser and try again. Reboot your router and try again. Disable the network adapter used currently and then enable it again.

Q2. What can you do? Can you not access the Internet? Check if the internet is working properly by connecting a computer directly to the modem via an Ethernet cable. If not connect to your internet provider.

Reboot your router and try again. Q3. How do you restore the router to its factory default setting? While the router is powered on, press and hold the reset button on the rear panel of the router for approximately 10 seconds.

Q4. Why is the repeater mode unsuccessful? You may have typed in the router's wireless password incorrectly, please log in and check the wireless password. The Mini router may be out of range, please move it closer to the router. Please reset the Mini Router and go through the configuration again.

A. If you need to reset the extender, you need to press and hold the reset button inside the tiny hole for 10 seconds.

FCC Warning:

This equipment has been tested and found to comply with the limits for a Class B digital device, pursuant to part 15 of the FCC Rules. These limits are designed to provide reasonable protection against harmful interference in a residential installation. This equipment generates, uses and can radiate radio frequency energy and, if not installed and used in accordance with the instructions, may cause harmful interference to radio communications. However, there is no guarantee that interference will not occur in a particular installation. If this equipment does cause harmful interference to radio or television reception, which can be determined by turning the equipment off and on, the user is encouraged to try to correct the interference by one or more of the following measures:

- Reorient or relocate the receiving antenna.
- Increase the separation between the equipment and receiver.
- Connect the equipment into an outlet on a circuit different from that to which the receiver is connected.
- Consult the dealer or an experienced radio/TV technician for help.

Caution: Any changes or modifications to this device not explicitly approved by manufacturer could void your authority to operate this equipment.

This device complies with part 15 of the FCC Rules. Operation is subject to the following two conditions:

(1) This device may not cause harmful interference, and (2) this device must accept any interference received, including interference that may cause undesired operation.

This equipment complies with FCC radiation exposure limits set forth for an uncontrolled environment. This equipment should be installed and operated with minimum distance 20cm between the radiator and your body.