



## USER MANUAL

# Contents

<b>Getting Started .....</b>	<b>3</b>
Inserting SIM card .....	3
Inserting Micro SD card .....	4
Charging the battery and connecting to PC .....	5
<b>Key Parts .....</b>	<b>6</b>
<b>Locking and Unlocking .....</b>	<b>7</b>
<b>Personalizing the Home Screen .....</b>	<b>8</b>
Adding Widgets and More to the Home Screen .....	9
Rearranging and Removing Widgets or Icons from the Home Screen .....	9
Adding folders to the Home Screen .....	10
<b>Adjusting Brightness .....</b>	<b>11</b>
<b>Managing Phone Calls .....</b>	<b>12</b>
Making a Call .....	12
Viewing the Call Log .....	13
Rejecting Incoming Calls .....	14
Adding a Contact .....	14

<b>Messaging.....</b>	<b>15</b>
Receiving a New Message.....	16
Editing SMS and MMS .....	16
Viewing Conversations.....	16
<b>Browsing the Web with Google Chrome .....</b>	<b>17</b>
<b>Playing Music with YouTube Music .....</b>	<b>18</b>
<b>Downloading Apps from Google Play .....</b>	<b>19</b>
<b>Managing Applications .....</b>	<b>20</b>
<b>System Updates .....</b>	<b>21</b>
<b>System Settings .....</b>	<b>22</b>
<b>Maintenance and Safety.....</b>	<b>30</b>

## Getting Started

### Inserting SIM card

The Vortex V20 is a Dual SIM mobile phone allowing you to use the facility of two networks.

1. Switch off the mobile phone.

2. Insert the SIM card correctly in the card slot(s) (See figure below)

SIM1

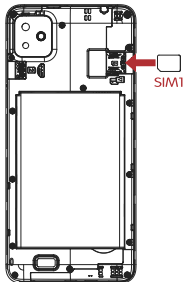

SIM2

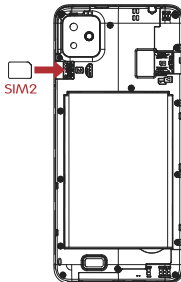

## Getting Started

### Inserting Micro SD card

The Vortex V20 supports a Micro SD card which is a multimedia memory card used to increase available memory. The Micro SD Card can be inserted by following the instructions from Page 3.

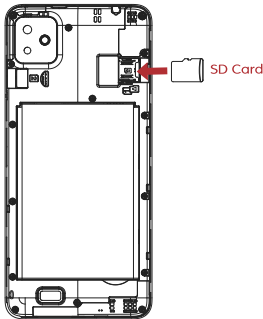

## Getting Started

### Charging the battery and connecting to PC

You can charge your battery using the charger or connect the USB cable (supplied with this phone) to the computer.

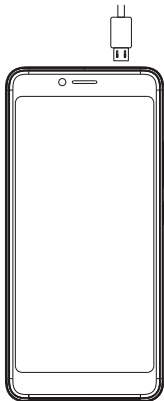

## Key Parts



## Locking and Unlocking

Press the power button to put your phone to sleep. Press the power button again to wake your phone up, then swipe upwards to unlock the screen.

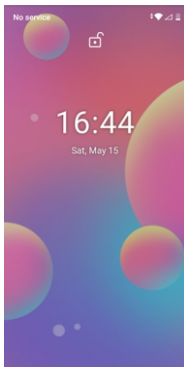



## Personalizing the Home Screen

The home screen is your starting point to access all of the features on your phone. It displays application icons, widgets, shortcuts, and more. At the top of the screen is the status bar that displays the time and notifications. If messages or calls are received, you can drag the status bar down to open the notification panel and select new notifications. When finished, simply drag the panel up or press “Back” to hide the notification panel again.

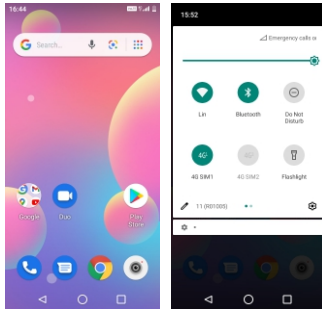

## Personalizing the Home Screen

### Adding Widgets and More to the Home Screen

Press and hold an icon or widget that you want to move. Drag the icon or widget on top of another icon or widget to add a folder. Remove all applications from a folder to automatically delete the folder.

### Rearranging and Removing Widgets or Icons from the Home Screen

Long press/hold the widget or icon you want to move, then drag the widget or icon to a new location.

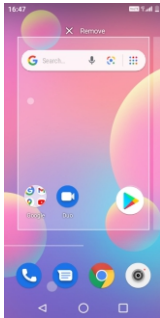

# Personalizing the Home Screen

## Adding folders to the Home Screen

Long press/hold the widget or icon you want to move, then drag the widget or icon to a new location or icon you want to move. Once “Remove” appears, don't release your hold on the icon and drag the widget or icon to a new location on the screen.

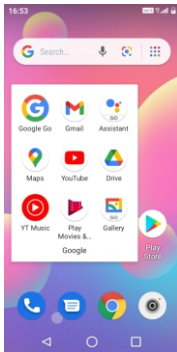

## Adjusting Brightness

Drag the notification panel down and adjust brightness. Or enter Settings->Display->Brightness level, and adjust the brightness level here (by dragging the brightness slider to the left to decrease or to the right to increase the screen Brightness).

Note: Lower the brightness of the screen to prolong the battery life.

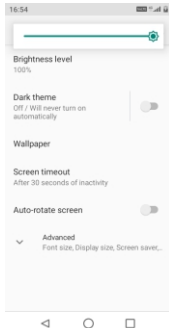

# Managing Phone Calls

## Making a Call

Open the dial pad by selecting the phone icon from the home screen, then enter a complete phone number to make a call.

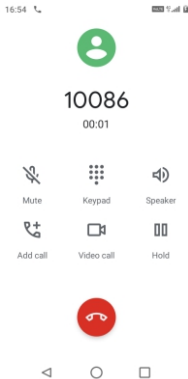

# Managing Phone Calls

## Viewing the Call Log

You can check detailed call logs in Recent. In call log options you can make calls, create a new contact, send messages, etc.

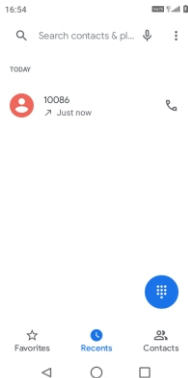



# Managing Phone Calls

## Rejecting Incoming Calls

When unable to accept an incoming call, you can send a busy message to reject the call. Tap the message icon and select a message to reply with.

## Adding a Contact

Tap  and enter Contacts and then add a contact (see figure below). Tap  to add a new contact to Phone.

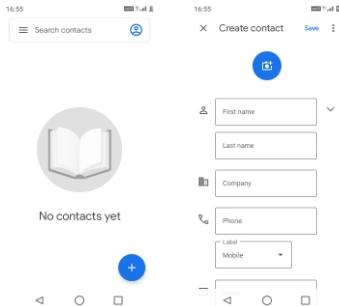

## Messaging

Enter Messaging, and then compose new message. Touching any text field will open your keyboard.

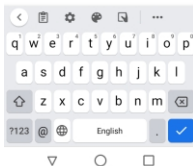



## **Messaging**

### **Receiving a New Message**

When you receive a new message, an icon will appear in the notification area of the status bar. To open the message, press and hold the status bar, and then slide the status bar down to open the Notifications panel. Alternatively, you can open Messaging to read the message directly.

### **Editing SMS and MMS**

When you are composing a new text message, you can select text for cutting or copying. Touch the text field or portion that contains text. You can select all contexts, copy, cut and share. The selected text is highlighted in Blue. A multimedia message may contain video, pictures, audio, etc. You can add videos, pictures and more to SMS to change to MMS.

### **Viewing Conversations**

Text and multimedia messages that are sent to and received from a contact (or a number) are grouped into conversations or message threads in the All messages screen. Threaded SMS or MMS let you see exchanged messages (similar to a chat program) with a contact on the screen.

## Browsing the Web with Google Chrome

Open Google Chrome and either enter a website address or search by using the text field at the top. The browser is fully optimized and comes with advanced features that make browsing the web easy. You must have an active data or Wi-Fi connection to access the internet.

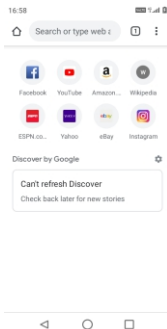

## Playing Music with YouTube Music

When you copy music to your device, you can access them via YouTube Music. You sort all music files by albums, songs, artists, or even create a playlist.

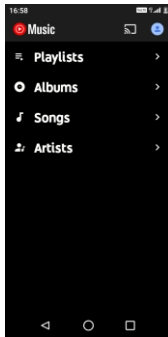

# Downloading Apps from Google Play

Add a Google™ account and then Enter Google Play Store and download apps.

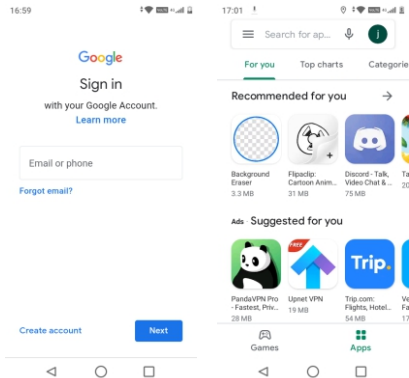

## Managing Applications

Enter Settings > Apps & notifications, then manage the applications. Tap any app to view the information of the applications, and you can force stop or uninstall any applications here. You will need to give Files by Google access to your device in order to install Apps. or uninstall the apps. To install Apps, you need switch on “Allow from this source” in device.

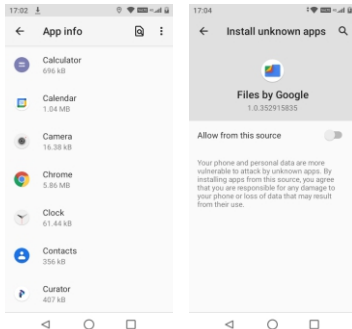

## System Updates

The device will automatically find and install the newest version of software. Your device will enter Recovery mode and restart to update the new software. Once the reboot is complete, you will be notified that the update was successful.

Note: Ensure you are connected to Wifi before downloading update.

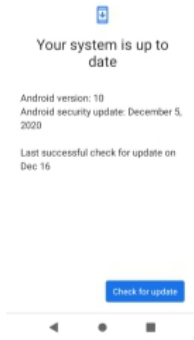

# System Settings



## Network and Internet

### WiFi

Using Wi-Fi you can now surf the Internet without using your SIM card whenever you are in the range of a wireless network. Simply enter the Wi-Fi settings and connect your phone to a wireless network.

### Mobile network

#### Data roaming

If you don't need to transmit data on other provider's mobile networks, unmark the checkbox to avoid incurring significant roaming charges.

#### Enhanced 4G LTE mode

Tap to enable 4G functionality and improve voice and data communications.

#### Access Point Names

You can select your preferred network with this menu.

#### Network carriers

You can select a network carrier.

## System Settings

### **Data saver**

By enabling Data saver, you can reduce data usage by preventing some apps from sending or receiving data in the background.

### **Tethering & portable hotspot**

This function allows you to share your phone's mobile data connection via USB or as a portable Wi-Fi access point.

### **VPN**

A Virtual Private Network (VPN) allows you to connect to a private secured network from your device. You will need the connection information from your VPN administrator.

### **Airplane mode**

Airplane mode disconnects your device from all networks and turns off connectivity features.



## System Settings



### Connected devices

Touch to set the connected devices for your phone, such as Bluetooth, Cast, Printing, USB, etc.



### APPs & notifications

#### APPs

You use the Apps settings to view details about the applications installed on your phone, to manage their data and force them to stop, and to set whether you want to permit installation of applications that you obtain from websites and emails.

#### Notifications

Touch to manage apps notification. You can set permission of apps notification, the authority to show the notifications on locked screen, etc.

## System Settings



### Battery

In the Battery screen you can select whether to display battery percentage in the status bar or to enable intelligent power saving.



### Display

In this menu, you can adjust your screen brightness, wallpaper, sleep time, font size, etc. To rotate screen contents when device is rotated, touch Advanced > Auto-rotate screen.



### Sound

Touch to adjust call and notification ringtones, music, and other audio settings.



### Storage

This menu displays the amount of internal phone storage. It shows the amount of internal phone storage used by applications (including those you downloaded), images, videos, etc. Touch the items to view details.

## System Settings



### Security

#### Screen lock

Select one method such as Swipe, Pattern, PIN, Password, or Fingerprint to unlock the screen.

#### Face unlock

Face unlock allows you to unlock your device with your facial data. Set it according to the on-screen steps. Ensure that you are facing the phone screen when using face recognition.

**NOTE:** you need to set a pattern, PIN, or password before using face key.

#### Smart Lock

Smart Lock keeps your device unlocked when it's safe with you and locked when it detects that it's been put down.

**NOTE:** you need to set a pattern, PIN, or password before using Smart lock.



### Location

Tap to set whether to allow an app to access your device's location. You can set allowing continual access, or only while the app is in use.

## System Settings



### Accounts

Touch to add, remove, and manage your email and other supported accounts. You can also use these settings to control how and whether all applications send, receive, and synchronise data on their own schedules, and whether all applications can synchronise user data automatically. Touch Add account to add an account for the selected app.



### Accessibility

Use the Accessibility settings to configure any accessibility plug-ins you have installed on your phone.



### Google

Touch to configure your Google account and services settings.