

尺寸:70 x 100 mm



FC01  
headphones



Instruction Manual

Thank you for purchasing our product. Hope you will have fun using it!  
Please read this user manual thoroughly before using, and keep it properly.

#### Connectingand pairing

Open the phone settings and connect the Bluetoothdevice. Select "FC01" in the phone Bluetooth connectionto complete the connection.

After turning on the phone (within about 15 seconds), the headset will automatically enter the pairing state (the white light flashes once).

After successfully connecting to the phone, the headset light goes out (prompts "Connected").

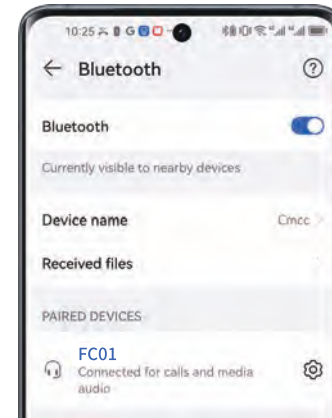

#### Clear pairing history

##### 1、 Operation steps:

Ake sure the headset is powered on (not connected to any device).

Press and hold the volume "+" and "-" buttons for 5 seconds at the same time until you hear a prompt tone.

The headset light flashes slowly 3 times, indicating that all historical pairing records have been successfully cleared and the headset automatically enters pairing mode.

##### 2、 Notes:

After the operation, the headset name will be restored to the factory default and you need to search and connect again in the Bluetooth list of your mobile phone.

Do not release the button during the long press until the white light finishes flashing.



#### Mode Switching

Click the ANC button, the mode can be changed from the current Transparency mode - ANC mode - Normal mode

Transparency mode: You can clearly perceive the ambient sound without taking off the headphones. The smart microphone picks up key sounds such as external human voices and traffic prompts in real time.

ANC noise reduction mode: Instantly isolate the outside noise, effectively filter up to 45dB of environmental noise (such as traffic, human voices, mechanical hum), and create a unique quiet space.

#### Gaming Mode

Default state:  
The low latency mode of the headset is turned off by default (Normal Mode), which can meet daily listening needs.

##### Turn on/off gaming mode:

Quickly double-click the ANC button on the headset, and the mode will switch after hearing the prompt tone.

When turned on: prompt "Gaming Mode", which significantly reduces latency and is suitable for gaming scenarios.

When turned off: prompt "Normal Mode", restore standard sound effects.

##### Notes:

When switching, make sure the button operation is fast and continuous (double-click interval is less than 0.5 seconds).

#### Main functions

##### Double-click the power button

Press and hold the volume + button (or next song button) for 2 seconds, and go directly to the next song after hearing the "beep" sound

Short press the power button once

Press and hold the power button for 2 seconds

When the phone is connected, triple-click the power button to wake up the voice assistant.

Long press the power button for 5 seconds and the white light will stay on for 2 seconds (you can also shut down the phone in standby mode after connecting it to the phone)

When there is no connection, it will automatically shut down after 5 minutes. And you can reconnect within 5 minutes.

#### Specifications

Wireless specification: wireless V5.4

Product net weight: 275g

Protocols supported: A2DP ,AVRCP,HSP,HFP

Transmission range: 10m

Transmission frequency: 2.4GHz

Charging voltage: DC 5V

Charging time: about 70min

Talk time /Music time: above 100h

Standby time: 200h

Battery capacity: 800mAh

#### Daily maintenance recommendations

##### Storage method

Avoid folding and squeezing. It is recommended to place it flat or hang it with a special bracket.

Keep away from high temperature and humid environments (such as bathrooms and balconies)

##### Precautions

##### Prohibited operations:

Do not soak or rinse the entire machine with water.

Do not scratch the leather/skin-like coating with hard objects.

After cleaning, make sure all parts are completely dry before assembling and using.

FCC ID : 2A2BYHE-T01  
Made in China



#### FCC STATEMENT :

This device complies with Part 15 of the FCC Rules. Operation is subject to the following two conditions:

(1) This device may not cause harmful interference, and  
(2) This device must accept any interference received, including interference that may cause undesired operation.  
Warning: Changes or modifications not expressly approved by the party responsible for compliance could void the user's authority to operate the equipment.

NOTE: This equipment has been tested and found to comply with the limits for a Class B digital device, pursuant to Part 15 of the FCC Rules. These limits are designed to provide reasonable protection against harmful interference in a residential installation. This equipment generates uses and can radiate radio frequency energy and, if not installed and used in accordance with the instructions, may cause harmful interference to radio communications. However, there is no guarantee that interference will not occur in a particular installation. If this equipment does cause harmful interference to radio or television reception, which can be determined by turning the equipment off and on, the user is encouraged to try to correct the interference by one or more of the following measures:

Reorient or relocate the receiving antenna.  
Increase the separation between the equipment and receiver.  
Connect the equipment into an outlet on a circuit different from that to which the receiver is connected.  
Consult the dealer or an experienced radio/TV technician for help.

RF warning statement:  
The device has been evaluated to meet general RF exposure requirement. The device can be used in portable exposure conditionwithout restriction.

##### IC WARNING:

-English:

This device contains licence-exempt transmitter(s)/receiver(s) that comply with Innovation, Science and Economic Development Canada's licence-exempt RSS(s).

Operation is subject to the following two conditions:

(1) This device may not cause interference.

(2) This device must accept any interference, including interference that may cause undesired operation of the device.

-French:

L'émetteur/récepteur exempt de licence contenu dans le présent appareil est conforme aux CNR d'Innovation, Sciences et Développement économique Canada applicables aux appareils radio exempts de licence. L'exploitation est autorisée aux deux conditions suivantes :

1) L' appareil ne doit pas produire de brouillage;

2) L' appareil doit accepter tout brouillage radioélectrique subi, même si le brouillage est susceptible d' en compromettre le fonctionnement.

The device has been evaluated to meet general RF exposure requirement. The device can be used in portable exposure condition without restriction.