

MATIV

INTERACTIVE WORKOUT MAT

- IN THE BOX
- SPECIFICATION
- INSTRUCTIONS
- WARNING & CAUTION
- WARRANTY
- COPYRIGHTS & TRADEMARKS

USER MANUAL

April 2021

IN THE BOX

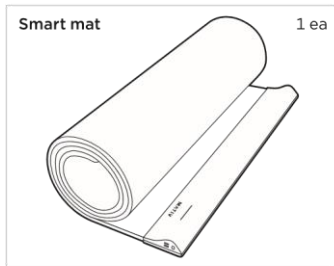

Dual-port USB charger	1 ea
USB type-C cables	2 ea
HDMI cable	1 ea

SPECIFICATION

SMART MAT

- Built-in rollable sensors
- Dimensions: 75(L) x 24(W) x 0.3(H) in
- Mat Material: TPE (nontoxic)
- Weight: 4.4lb
- Battery: 1300mAh
- Core: Arm Cortex M4
- Bluetooth: Bluetooth LE 5.0
- Compatibility: Android, iOS
- Charger Type: USB Type C

SMART BAND*

*ADD-ON PRODUCT

- Built-in motion sensors
- Dimensions: 2.4(L) x 1.2(W) x 0.6(H) in
- Weight: 0.8lb
- Battery: 200mAh
- Core: Arm Cortex M4
- Bluetooth: Bluetooth LE 5.0
- Compatibility: Android, iOS
- Charger Type: USB Type C

INSTRUCTIONS

HOW TO CHARGE THE BATTERY

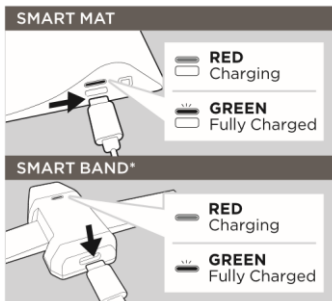

Plug the USB type C cable into the device.
When fully charged, the LED displays a green light (red indicates it is still charging)



Before the first use, charge MATIV mat for at least 5 hours. For the band, charge for 1 hour.



Leaving MATIV on 0% battery or charging for too long may reduce battery life.

INSTALLING THE APP



Scan the QR code to be redirected to the application store.



Or search MATIV in the App Store/Play Store.

If you experience difficulty installing the application, please contact to
<https://mativfitness.com/support>

CONNECTING MATIV

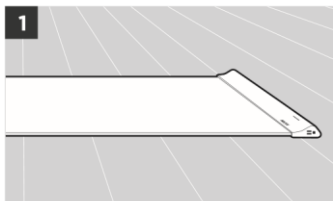

Lay open MATIV in an area that allows the mat to be rolled out completely.



At first, the mat may not be rolled out easily. Roll it up on facing the opposite side to help flatten it.



MATIV may not function properly on an uneven or cushiony plain.



Open the App and connect MATIV with the smart band*.



Select the MATIV device that is on the App.

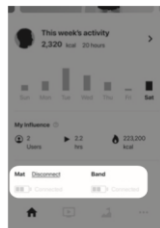
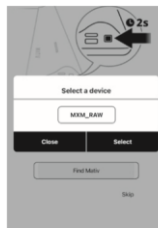

The mat will be connected automatically after connecting it for the first time.

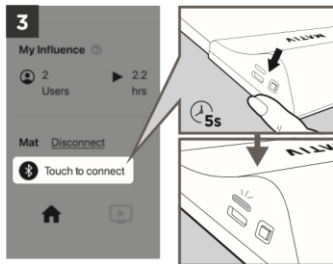

If MATIV is not detected in the App, press and hold the button on the side of the bar (on the mat) for 5 seconds and check that the LED is white. Then, try connecting again.

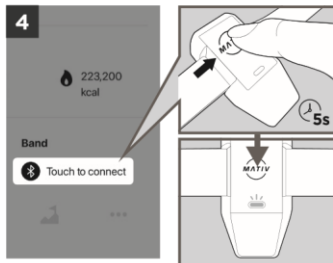

press and hold the circular button for 5 seconds and check that the LED is white. Then, try connecting again.

DEVICE STATUS

Status	LED Pattern
Fully charged	Green
Charging	Red (Blink)
Exercise	Blue (Blink)
Calibration	Purple (Blink)
Reset	White
Update	Yellow

If the smart band is not detected in the App,

WARNING & CAUTION

WARNING



Exercising on a wet mat may cause sliding and injury. Wipe with a dry cloth before use.



Tracking may not occur properly if the mat is not completely rolled out. Roll it up on the flip-side to make it as flat as possible.



Using the mat with shoes may reduce the life of the mat. Please exercise with bare feet or wearing socks.



Spilling liquid on the case or mat may cause damage.



Soaking the mat or putting it through a washing machine may cause damage.



Exercise on a flat surface.



If there isn't enough friction on the floor beneath the mat, it may cause the mat to slip. Please check that the mat is securely placed on the floor before exercising.

CAUTION



Children should always be accompanied by an adult when using MATIV.



Applying excess shock or pressure or may cause explosion of the built-in battery.



Store in a cool, dry place away from direct sunlight.



Extreme exercise can cause injury. Please exercise appropriately according to your level of fitness.



If you have cardiovascular or respiratory issues or are pregnant you should consult a doctor before using MATIV.



Please read the all of the instructions before use. You will be responsible for all issues that arise from misuse of the product.



For repairs, please contact customer services. You will be responsible for all issues caused by self-repair or disassembly of the product.

WARRANTY

The warranty period is 1 year from date of purchase. If a fault occurs during normal use in accordance with the manual guidelines, the product may be repaired or exchanged free of charge. The product will be exchanged for the same product by principle, and the customer will be liable for any shipping costs. After the warranty period expires, the product may be repaired or exchanged at a cost if a fault is detected.

COPYRIGHTS & TRADEMARKS

MATIV omolle

Copyright by Omolle Inc. All Rights Reserved

support@omolle.com

139 Centre St STE 304, New York,
NY 10013

The contents in this document are subject to change without notice.



1) FCC Compliance Statement

This device complies with part 15 of the FCC rules. Operation is subject to the following two conditions:

- (1) This device may not cause harmful interference, and (2) this device must accept any interference received, including interference that may cause undesired operation.
- 2) Any changes or modifications (including the antenna) made to this device that are not expressly approved by the manufacturer may void the user's authority to operate the equipment.
- 3) This transmitter must not be co-located or operating in conjunction with any other antenna or Transmitter To comply with FCC RF exposure compliance requirements, a separation distance of at least 5 mm must be maintained between the antenna of this device and all persons. This device must not be co-located or operation in conjunction with any other antenna or transmitter.
- 4) This equipment has been tested and found to comply with the limits for a Class B digital device, pursuant to part 15 of the FCC Rules. These limits are designed to provide reasonable protection against harmful interference in a residential installation. This equipment generates, uses and can radiate radio frequency energy and, if not installed and used in accordance with the instructions, may cause harmful interference to radio communications. However, there is no guarantee that interference will not occur in a particular installation. If this equipment does cause harmful interference to radio or television reception, which can be determined by turning the equipment off and on, the user is encouraged to correct the interference by one of the following measures:

- Reorient or relocate the receiving antenna.
- Increase the separation between the equipment and receiver.
- Connect the equipment into an outlet on a circuit different from which the receiver is connected.
- Consult the dealer or an experienced radio/TV technician for help.

<https://mativfitness.com>

Copyright © 2021 Omolle All rights reserved.