

印刷要求

尺寸：167x116mm，

材质：128g铜版纸，双面彩印

RENPHO
SMART HEALTHY LIVING

Calibra 1L

Model: R-T001

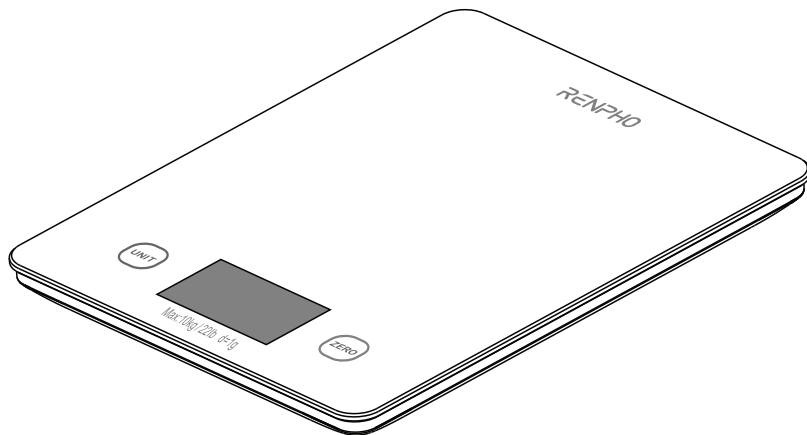



Digital Scale Specialist

RENPHO Calibra 1L User Manual

Thank you for choosing RENPHO! This scale is a great companion for healthy meal prep. It works with the Renpho Health App and helps accurately calculate the amount of calories in your food. You can easily keep an up-to-date nutrition log of all your meals, track your daily nutrition, and improve your diet for better health!

Important Notice

1. DO NOT exceed the 22lbs (10kg) weight capacity, otherwise, the sensor may be damaged. An overload indicator will appear on the display if the limit is exceeded.
2. Always use the scale on a solid, flat surface, keep the scale unmoved when weighing.
3. DO NOT immerse the scale in water or any liquid. If the liquid is spilled on the digital display, immediately wipe the scale clean with a soft cloth to avoid internal damage.
4. Clean the scale with a soft damp cloth; do not use chemicals or harsh abrasives.
5. This scale is a high-precision device, please handle with care; Do not strike, shake or drop the scale.
6. Do not put heavy things on the scale when not in use.
7. This scale is designed for household use only and is not intended for medical or commercial use.
8. If the scale failed to turn on, please check whether the batteries are installed properly or battery power is low.

About the Batteries

1. DO NOT mix new and used batteries.
2. To insert or replace the batteries, open the battery compartment located underneath the unit.
When inserting the batteries, always observe the correct polarity. Please put the 3xAAA batteries into the battery compartment with the correct anode and cathode.
3. If the low battery indicator appears on the display, replace the batteries.
4. If the scale is not in use for an extended period of time, remove the batteries to conserve battery life and extend the life of the scale.

About the Scale

1. Specifications

Product Name	Smart Nutrition Scale
Model	R-T001
Unit	oz / fl'oz / lb:oz / ml / g
Division	1g / 1ml / 0.05oz / 0.1fl'oz
Capacity	22lbs / 10kg / 10,000ml / 352fl'oz
LED Size	1.2 x 2.0 inch
Product Size	8.3 x 6.3 x 0.7 inch
Product Weight	0.68 lb
Material	T3 Tempered Glass + HIPS
Powered by	3 × AAA (1.5V) Batteries (Pre-installed)
Bluetooth Version	5.0 or above
Precision	1000g±3g; 3000±10g; 5000g±15g; 7000g±17g; 10000g±20g

2. Product Introduction

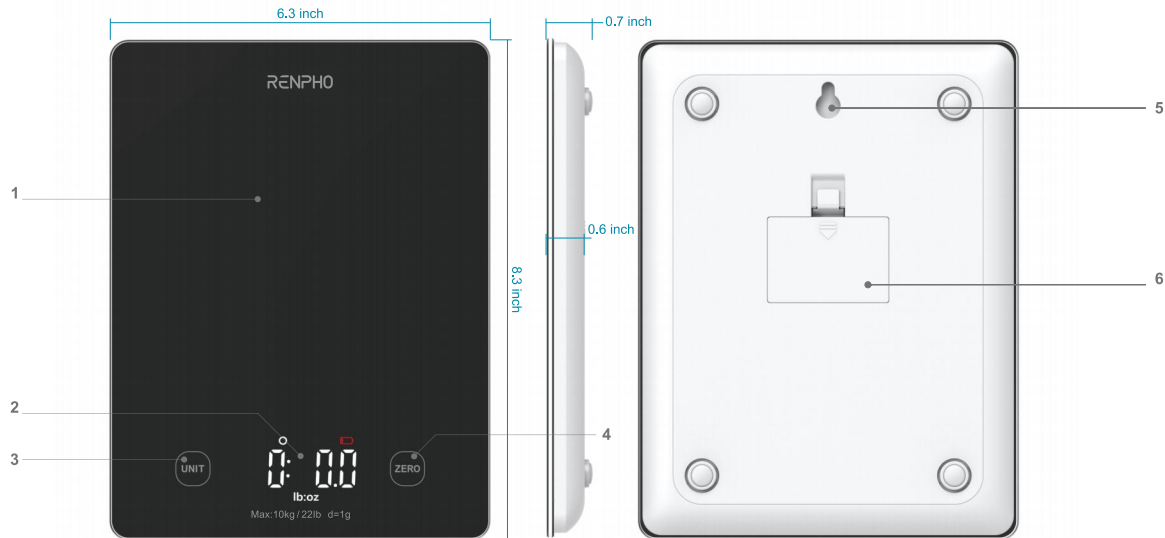

3. What's Included

- 1 x RENPHO Calibra 1L
- 3 x AAA (1.5V) Batteries (Pre-installed)
- 1 x User Manual

Icons indication



* Bluetooth Connection

O Calibrated

T Tare Weight

— Negative Value

Low Battery



"Err" symbol on the display indicates that the scale is overloaded (22lb/10kg).



If this symbol flashes, it indicates that the battery power is low.

Operation

1. Before use

Remove the isolation strip from the battery compartment before the first use.

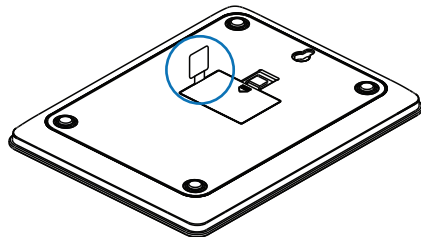

2. Weighting

There is no power button. (Auto on / Auto off)

1. Place the scale on a solid and flat surface, and press the scale platform for one second or place an object over 200 grams to turn on the scale.
2. The default measuring unit is "oz". Press **UNIT** to select your desired measuring unit, which will display at the bottom of the display.
 - a. **Weight weighting:** Choose between ounces ("oz"), both pounds and ounces ("lb: oz"), or grams ("g").
 - b. **Volume weighting:** Choose between milliliters ("ml") or fluid ounce("fl'oz")
3. **Optional:** If you're using a container to hold the items or liquid you're measuring, first place the empty container on the scale. Press **ZERO** to tare the container's weight.
4. Gently place your item on the scale. The screen will display the weight or volume.
5. Turn off the scale on the Renpho Health App or wait for the scale to turn off automatically after 90 seconds.

3. Calibration & Tare Function

Calibration: Press **ZERO** when weight under 200 grams.

Tare Function: This function only works for those weighing over 200 grams.

Whenever you measure liquid, powder or other items inside a container, you can use the tare function to remove the container's weight from the final measurement.

Note: The container plus the object's weight cannot exceed 10kg.

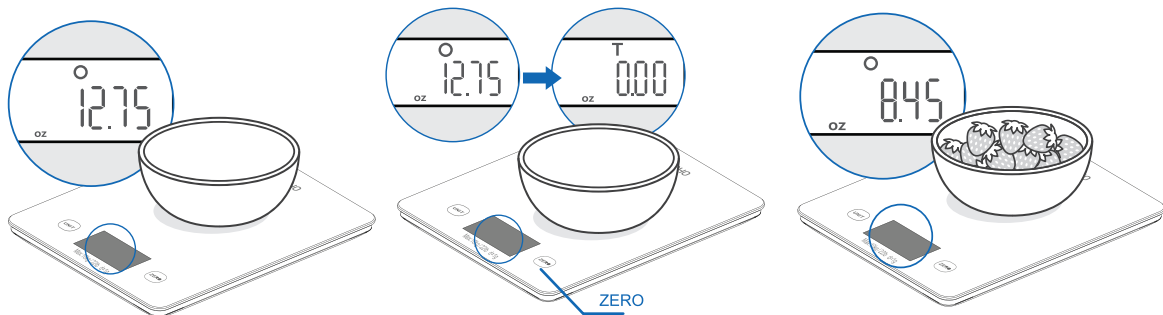

1. Place an empty container on the scale. The screen will display the container's weight.

3. Place liquid or items in the container. The scale will now measure the liquid or items, without the weight of the container.

2. Press **ZERO**, the screen will now display "0" again.

4. When you're done, reset the scale by removing all weights and pressing **ZERO**.

App Installation

Note: Due to continuing updates and improvements, the "Renpho Health" App may appear slightly different.

Download the App

1. Search and download "**Renpho Health**" App from Apple Store or Google Play.

Note: For iPad download, please choose filters-support-iPhone only.



2. Open the "Renpho Health" App. To create a new account, tap "Sign up" following the in-app instructions. If you already have an account, tap "Login In".

Note: With a "Renpho Health" account, you can also allow your family and friends to use your nutrition scale.

After setting up the app, turn on your scale. Make sure the screen lights up.

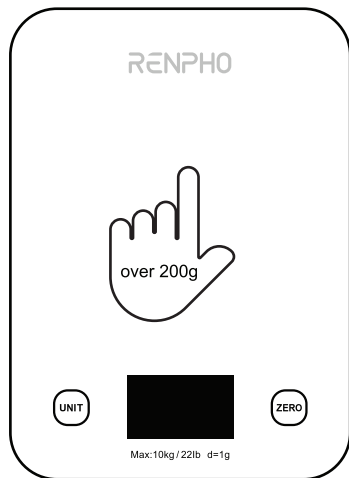

Add Device

Method 1

1) Open the App.

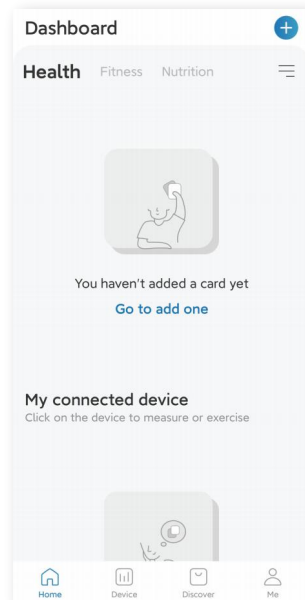

2) Enable Bluetooth via your phone's settings. Make sure your phone is connected to the mobile network / WLAN.

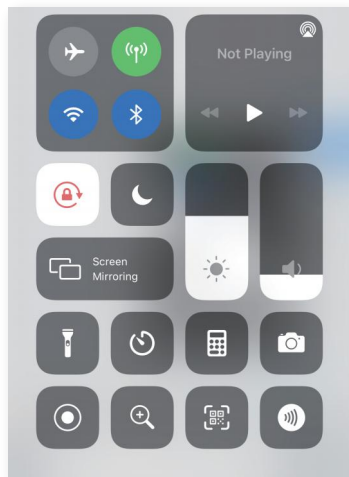

Note: For iOS 12.0 or later software version, please allow 'Renpho Health' to access Bluetooth in phone settings.

3) Keep the phone close to the scale and wait 3-5 seconds. When a window pops up, tap "Pair".

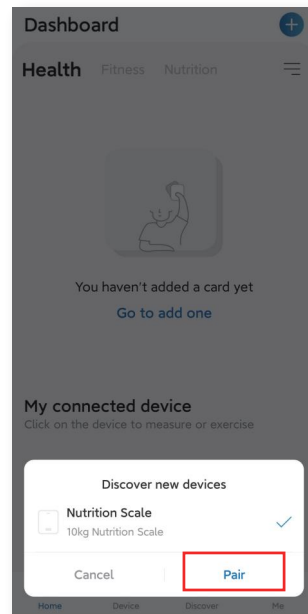

Method 2

1) Tap “+” on the top right corner of the Homepage.

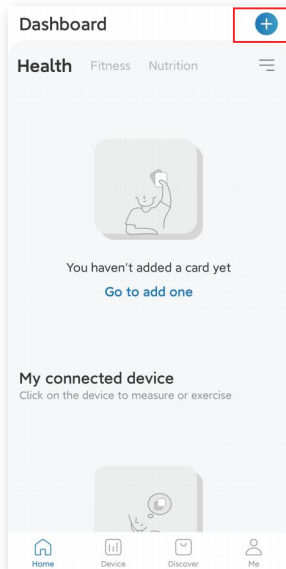

2) Tap “Nutrition Scale”.

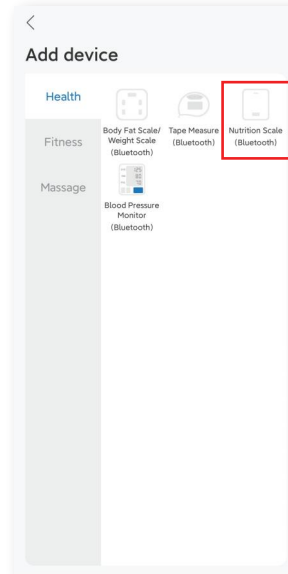

App Operation

Fill in your basic information and edit your nutrition goals.

The screenshot shows a form titled "Improve user information" with a back arrow. It contains three sections: "Weight unit" with options "kg" and "lb", "Height Unit" with options "cm" and "inch", and "Measurement unit" with options "oz" and ".". A blue "Next step" button is at the bottom.

Search Food and Weight Measurement

1) Tap "What's on the scale?" for food information or to add new food.

The screenshot shows the "Nutrition Scale" screen. At the top, there's a back arrow and the title "Nutrition Scale". Below it, a red box highlights the button "What's on the scale?". The main area features a large circular gauge with "0" in the center, labeled "Manual input". To the left of the gauge are icons for Bluetooth, a list, a power button, and a refresh button. To the right is a share icon. Below the gauge, it says "Unit: g" and "Add to plate" with a plate icon. At the bottom, there's a section titled "Nutrient content" with three columns: "Calories(Cal)" with "0", "Protein(g)" with "0", and "Total Fat(g)" with "0". Below these are "Total Carbohydrate(g)" and "Total Sugars(g)", both with "0". The bottom navigation bar has four icons: "Measure", "Plate", "Diary", and "Settings".

2) Enter the name of the food in the search. (for example: "banana").

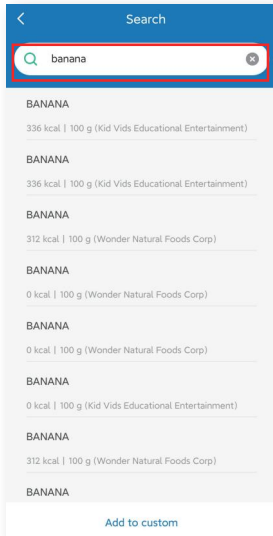

3) View the nutrition facts of the food selected and tap "✓".

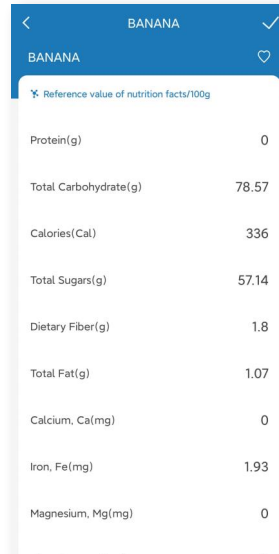

Note: The App also supports adding custom food.

4) Once you weigh your food, you can see the nutrition information of the corresponding weight. Tap "Add to plate" to confirm.

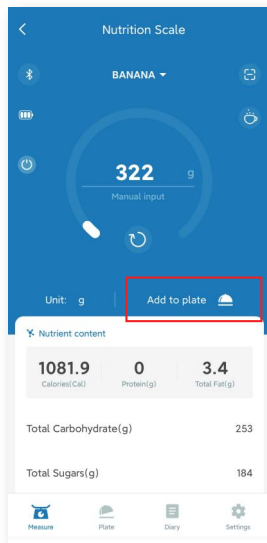
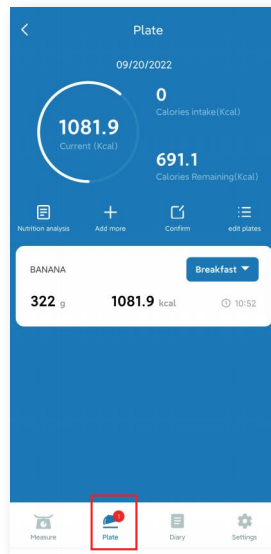
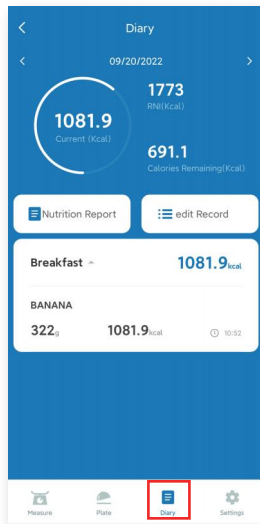

Plate and Diary

1) View today's calorie intake, nutrition analysis, add more food, record and confirm meals.



2) View your historical nutrition records and nutrition report and recommendations.



Device Settings

Customize your device settings. You can change your basic information, edit your goals and Recommended Nutrient Intake (RNI), change the Unit, Display-Off, etc.

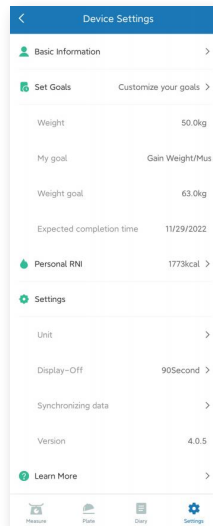

Coffee Maker

Tap the "coffee" symbol on Homepage for the coffee maker function including tracking the brewing time, the ratio of coffee beans to water, etc.

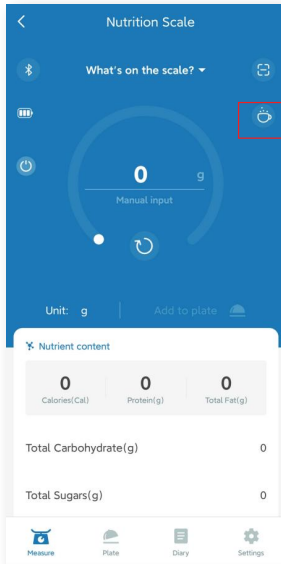

How to set the shutdown time?

Tap "Settings" to enter the Device settings interface and choose the display auto-off time you prefer.

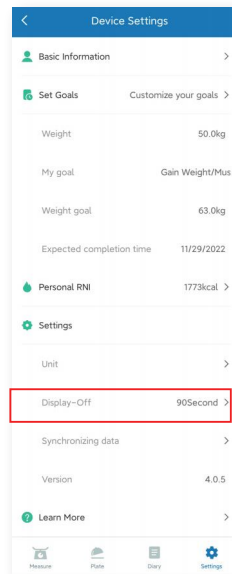
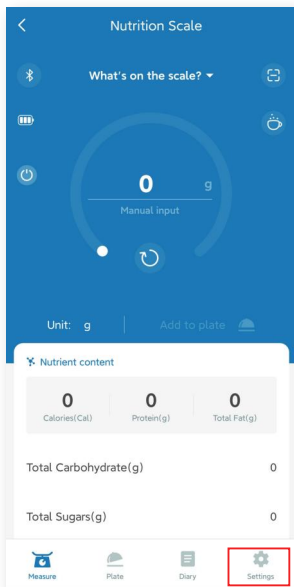

How to turn off the scale through App?

There is no power button on the scale, you can only turn off the scale through the app, as shown in the picture below:

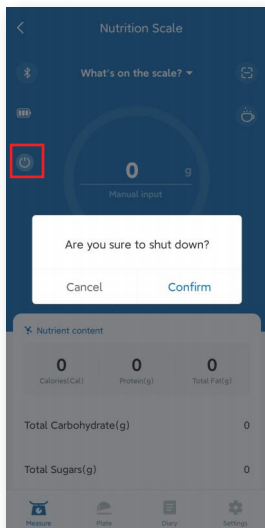

How to Sync with Apple Health?

Scan the QR code or check out our website for detailed instructions.

<https://renpho.com/pages/108>



Maintenance

- Use a slightly damp cloth to clean the surface of the scale and use a dry, soft cloth to wipe away the remaining moisture.
- DO NOT wash the scale or immerse it in water or any other liquid.
- Keep the scale in a cool, dry environment. Avoid exposing the scale to damp environments or extreme temperatures.
- All plastics parts should be cleaned immediately after contact with, spices, vinegar and strongly flavored / colored foods. (Avoid contact with acids citrus juice.)

Troubleshooting

Problem	Possible Cause	Solution
LED display is dim.	Batteries are low.	Re-install batteries or turn off the scale via the Renpho Health app.
Scale does not turn on.	Batteries are not properly installed.	Insert the batteries under the correct polarity as marked on the battery compartment.
Scale cannot connect to the Renpho Health App.	Your mobile device is too far away from the scale.	Make sure your mobile device is within 26ft (8m) of the scale.
Display shows "Err".	The item on the scale exceeds 10kg(22lb).	Promptly remove the item from scale to protect its weight sensors. Use a different scale with a higher weight range.

Warranty Policy

Your RENPHO product purchase is covered by a one-year limited manufacturer warranty from the date of delivery. For warranty terms and conditions, please visit:

<https://renpho.com/pages/warranty-terms-and-conditions>

Note: Product registration is not required for the warranty. If you choose not to register your product, it will not void the product warranty.

Customer Service

Please feel free to contact us if you have any questions or concerns. RENPHO Customer Service Team guarantees a quick response and hassle-free solutions to any issue you may have within business hours.

☎ TEL: +1(844) 417 0149 (US ONLY)

Monday-Friday 9:00AM-4:30PM

1800 MY RENPHO (1800 69 7367) (AU ONLY)

Monday-Friday 9:00AM-6:00PM (AEST)

✉ Email: support@renpho.com (US&CA)

support-au@renpho.com (AU)

*For defective products or the return of items, please contact us with your order number within the specified warranty period. DO NOT dispose of any product parts as they may be required for inspection/repair.

FCC Regulatory Compliance

This device complies with part 15 of the FCC Rules. Operation is subject to the following two conditions: (1) This device may not cause harmful interference, and (2) this device must accept any interference received, including interference that may cause undesired operation.

Warning: changes or modifications not expressly approved by the party responsible for compliance could void the user's authority to operate the equipment.

Note: This equipment has been tested and found to comply with the limits for a Class B digital device, pursuant to Part 15 of the FCC Rules. These limits are designed to provide reasonable protection against harmful interference in a residential installation. This equipment generates, uses and can radiate radio frequency energy and, if not installed and used in accordance with the instructions, may cause harmful interference to radio communications.

However, there is no guarantee that interference will not occur in a particular installation.

If this equipment does cause harmful interference to radio or television reception, which can be determined by turning the equipment off and on, the user is encouraged to try to correct the interference by one or more of the following measures:

- Reorient or relocate the receiving antenna.
- Increase the separation between the equipment and receiver.
- Connect the equipment into an outlet on a circuit different from that to which the receiver is connected.
- Consult the dealer or an experienced radio/TV technician for help.

RF Exposure Compliance

This equipment complies with FCC radiation exposure limits set forth for an uncontrolled environment. This transmitter must not be co-located or operating in conjunction with any other antenna or transmitter.

ISED Regulatory compliance

This device contains licence-exempt transmitters that comply with Innovation, Science and Economic

Development Canada's licence-exempt RSS(s).

Operation is subject to the following two conditions:

(1) This device may not cause interference.

(2) This device must accept any interference, including interference that may cause undesired operation of the device.

Le présent appareil est conforme aux CNR d'Industrie Canada applicables aux appareils radio exempts de licence. L'exploitation est autorisée aux deux conditions suivantes:

(1) l'appareil ne doit pas produire de brouillage, et

(2) l'utilisateur de l'appareil doit accepter tout brouillage radioélectrique subi, même si le brouillage est susceptible d'en compromettre le fonctionnement.

This equipment complies with IC RSS-102 radiation exposure limits set forth for an uncontrolled environment.

Cet équipement est conforme aux limites d'exposition aux radiations IC CNR-102 établies pour un environnement non contrôlé.



US Importer: JOICOM CORPORATION

14129 The Merge Street, Building 3 Unit A, Eastvale, CA 92880

Manufacturer: Shenzhen Ruiyi Business Technology Co., Ltd.

Qianhai Complex A201, Qianwan Road 1, Qianhai Shenzhen-Hong Kong
Cooperation Zone, Shenzhen, 518000 P.R.China

Made in China

NA6