

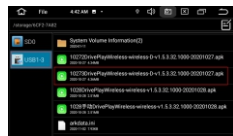

Wireless supplement

Installation instructions and methods

Insert the dongle into the USB port of the Android car machine, wait for about 20 seconds, and the dongle device indicator changes from normally on to flashing. Find Linux USB in the "file manager" of the car machine, click on it, find "APP", and click Install



Find u disk



Install APP

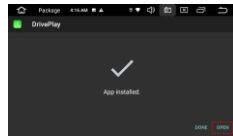

Open APP

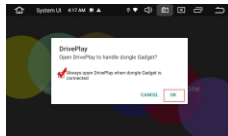

Check "Always sopen APP when dongle gadget isconnected" and Check "OK"

Connection mode

Insert the dongle into the USB port of the Android car machine, wait for about 20 seconds, and the dongle device indicator changes from normally on to flashing, click on it, App interface changes from "please insert the box and connect the mobile phone" to "insert the box, please connect the mobile phone". At this time, the car machine has recognized the dongle, Meanwhile, the Bluetooth name of the box will be displayed in app interface. iphone open and search, and connect the Bluetooth of the box.

The mobile terminal will automatically guide "pairing Bluetooth", "allow to synchronize contacts", "allow to use Carplay car"; When Carplay is connected, Bluetooth will be disconnected. This dongle also support wired USB connection, and support wired Android auto.

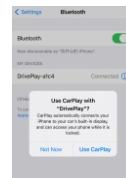
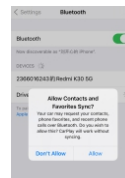
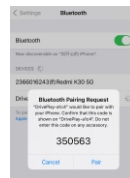

Notice

- 1: Before changing the iphone connection, please turn off the WiFi & Bluetooth of the iphone previously connected.
- 2: Restart the phone
- 3: If WiFi and Bluetooth are connecting other devices, please ignore the WiFi and Bluetooth of other devices, Only connect Bluetooth and WiFi of dongle devices
- 4: The device WiFi does not need to enter password. If WiFi is occupied by other devices, the app will always prompt "connection failure".

- 5: If the connection is not successful, please Pull and insert dongle
- 6: If you cannot solve your problem, please find "help and feedback" in app settings
- 7: High quality navigation USB cable is very important
- 8: If the box is plugged in and there is no response at the vehicle terminal, please ensure that the app is installed correctly, or please plug in another USB port, or restore the factory setting of the first vehicle
- 9: Please do not install the box in the central control of LCD. The appropriate installation position should be conducive to the plug-in of the box for after-sales
- 10: This product is suitable for Android car machine

Product Name: Carplay Accessory to Wireless

Product model: AF1313

Electrical parameters:

input voltage: 5V±0.3V Working current: 210mA Working temperature: -20---80°

App download address: 47.97.123.212/download/nonAuto
Connect the navigation to the hotspot, enter the URL in the browser, pay attention to case sensitivity, press enter, and install APK in the navigation.

FCC STATEMENT :

This device complies with Part 15 of the FCC Rules. Operation is subject to the following two conditions:

- (1) This device may not cause harmful interference, and
- (2) This device must accept any interference received, including interference that may cause undesired operation.

Warning: Changes or modifications not expressly approved by the party responsible for compliance could void the user's authority to operate the equipment.

NOTE: This equipment has been tested and found to comply with the limits for a Class B digital device, pursuant to Part 15 of the FCC Rules. These limits are designed to provide reasonable protection against harmful interference in a residential installation. This equipment generates uses and can radiate radio frequency energy and, if not installed and used in accordance with the instructions, may cause harmful interference to radio communications. However, there is no guarantee that interference will not occur in a particular installation. If this equipment does cause harmful interference to radio or television reception, which can be determined by turning the equipment off and on, the user is encouraged to try to correct the interference by one or more of the following measures:

- Reorient or relocate the receiving antenna.

- Increase the separation between the equipment and receiver.

- Connect the equipment into an outlet on a circuit different from that to which the receiver is connected.

- Consult the dealer or an experienced radio/TV technician for help.

FCC Radiation Exposure Statement:

This equipment complies with FCC radiation exposure limits set forth for an uncontrolled environment. This equipment should be installed and operated with minimum distance 20cm between the radiator & your body.