

This device complies with Part 15 of the FCC rules. Operation is subject to the following two conditions: (1) This device may not cause harmful interference, and (2) this device must accept any interference received, including interference that may cause undesired operation.

Notes: This equipment has been tested and found to comply with the limits for a Class B digital device, pursuant to part 15 of FCC rules. These limits are designed to provide reasonable protection against harmful interference in a residential installation. This equipment generates, uses, and can radiate radio frequency energy and, if not properly installed and used in accordance with the instructions, may cause harmful interference to radio communications. However, there is no guarantee that interference will not in fact occur.

If this equipment does cause harmful interference to radio or television reception, which can be determined by turning the equipment off and on, the user is encouraged to try to correct the interference by one or more of the following measures:

- Reorient or relocate the receiving antenna.
- Increase the separation between the equipment and receiver.
- Move the equipment into a different room or a circuit different from that to which the receiver is connected.

• Consult the dealer or an experienced radio/TV technician for help.

The FCC requires the user of this equipment to accept the responsibility for not causing interference to a licensed radio communication system.

The device can be used in portable mode without restriction.



For Customer Service please email:
Care@OdysseyToys.com

Please note the units model number and name in your email:
Model no. ODY-1029 • Bubble Blitz

www.OdysseyToys.com

CAUTIONS & WARNINGS

- Suitable for ages 6 and up. Adult supervision is always recommended.
- This product contains small parts which are a choking hazard. Keep away from small children.
- Manufacturers and dealers disclaim all responsibility for damage caused by misuse.
- Keep hair and loose clothing away from the vehicle when powered on.
- If vehicle will be stored and unused for an extended period of time, please remove the batteries.
- Check the batteries regularly for potential leakage or corrosion that may occur.
- When installing the batteries carefully follow the polarity marking +/-.
- Do not mix different battery types.
- Remove exhausted or drained batteries.
- Do not exceed charging volts and amps of 5v1a.
- Do not leave charger connected or charge for more than 1hr.

CARE & MAINTENANCE

- Do not submerge the unit in any liquids.
- Keep the unit dry.
- Do not place the unit near powerful, un-shielded magnets.
- Do not expose the unit to extreme hot or cold temperatures.
- Do not hit, drop, or smash the unit with extreme force.
- Do not disassemble the unit for any reason.

NOT FOLLOWING THESE PRECAUTIONS WILL VOID YOUR WARRANTY
60 DAY LIMITED WARRANTY

Odyssey Marketing/ Odyssey warrants to the original purchaser when used in USA only, that this product shall be free of defects in material and workmanship. This warranty applies within 60 days of the original purchase date with normal home use. This warranty does not apply for commercial use of this product. Use outside of USA is not covered by this warranty. During the warranty period, we will at our discretion, repair or replace this product without charge, as long as the product has not been abused or mishandled as by our determination. Our determination shall be final and be the consumer's sole remedy. ALL RETURNS must be accompanied by a Return Authorization Number which is issued by Odyssey Marketing's Customer Service Department.

Please contact Customer Service BEFORE returning any products or parts thereof. Once you have obtained a Return Authorization Number you will be provided a return address within the Customer Service email.

This warranty does not cover installation, adjustments in the home, nor damage due to accidents, misuse, abuse, fire, or any acts of God, incorrect line voltage, damage to other equipment caused by improper installation, unauthorized or improper modifications. This warranty gives you specific legal rights and you may also have other rights that vary from state to state.

**** THIS WARRANTY IS EXPRESSLY IN LIEU OF ALL OTHER WARRANTIES, EXPRESSED OR IMPLIED INCLUDING THE WARRANTIES OF MERCHANTABILITY AND FITNESS.** ©2017 Odyssey Marketing Corp.**

FCC STATEMENT: This product complies with Part 15 of the FCC Rules. Operation is subject to the following two conditions: (1) This device may not cause harmful interference and (2) this device must accept any interference receiver, including interference that may cause undesirable operation.

**INSTRUCTION MANUAL: BUBBLE BLITZ**

**FOR
AGES 6 +**



SETTING UP BUBBLE BLITZ

1. Turn off the power switch.
2. Use a phillips screwdriver to open the battery cover.
3. Connect the battery wire to the connector as shown on the diagram.
4. Close the battery compartment, reinstall the screw, and switch the power switch to On.

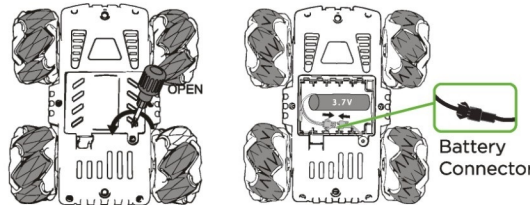

SETTING UP THE REMOTE CONTROL

1. Use a phillips screwdriver to open the battery cover.
2. Install 2x new AA batteries taking care to match the correct polarity (+/-).
3. Close the cover and reinstall the screw.

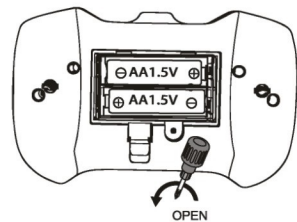

CHARGING THE BUBBLE BLITZ'S BATTERY

1. Remove the battery from the Bubble Blitz as shown in the Bubble Blitz setting up instructions.
 2. Connect the battery to the USB charging cord connector.
 3. Plug the USB cord into a 5v1a USB charger.
 4. The charger light will turn on to indicate charging. When the charger light goes out charging is complete and you can reinstall the battery.
- 
- ★ Tip. Full charge takes approx. 1hr

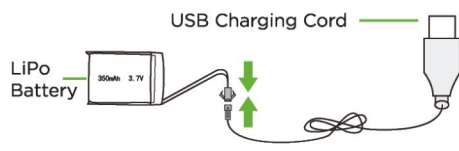

ADDING BUBBLES TO BUBBLE BLITZ

1. The Bubble Blitz comes with 4 packets of bubble solution. To fill the Bubble Blitz's reservoir pour one packet of solution into the provided container.
2. Fill the provided container with clean cold water.
3. Install the container's lid and carefully swirl the solution to mix.
4. Open the bubble reservoir door on the back of the Bubble Blitz, and insert the tube from the Bubble Blitz into the container.
5. Finally place the container inside the Bubble Blitz's reservoir door and close the door.

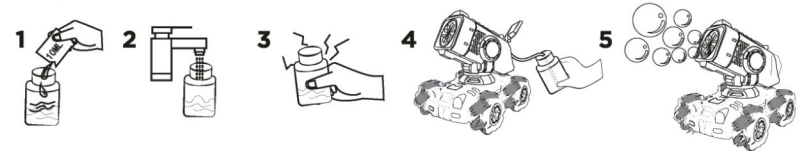

OPERATING BUBBLE BLITZ

- For best results the Bubble Blitz needs to be within a 15' foot range of the controller.

Controller Functions

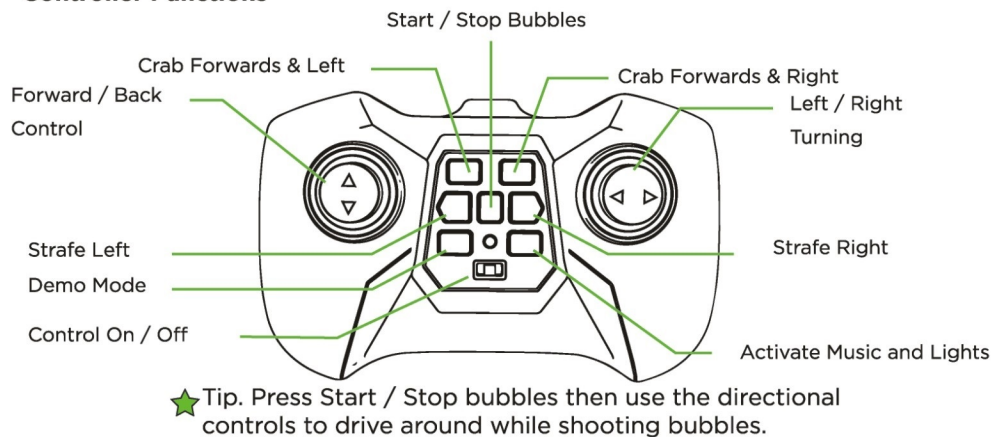

Bubble Blitz Movement

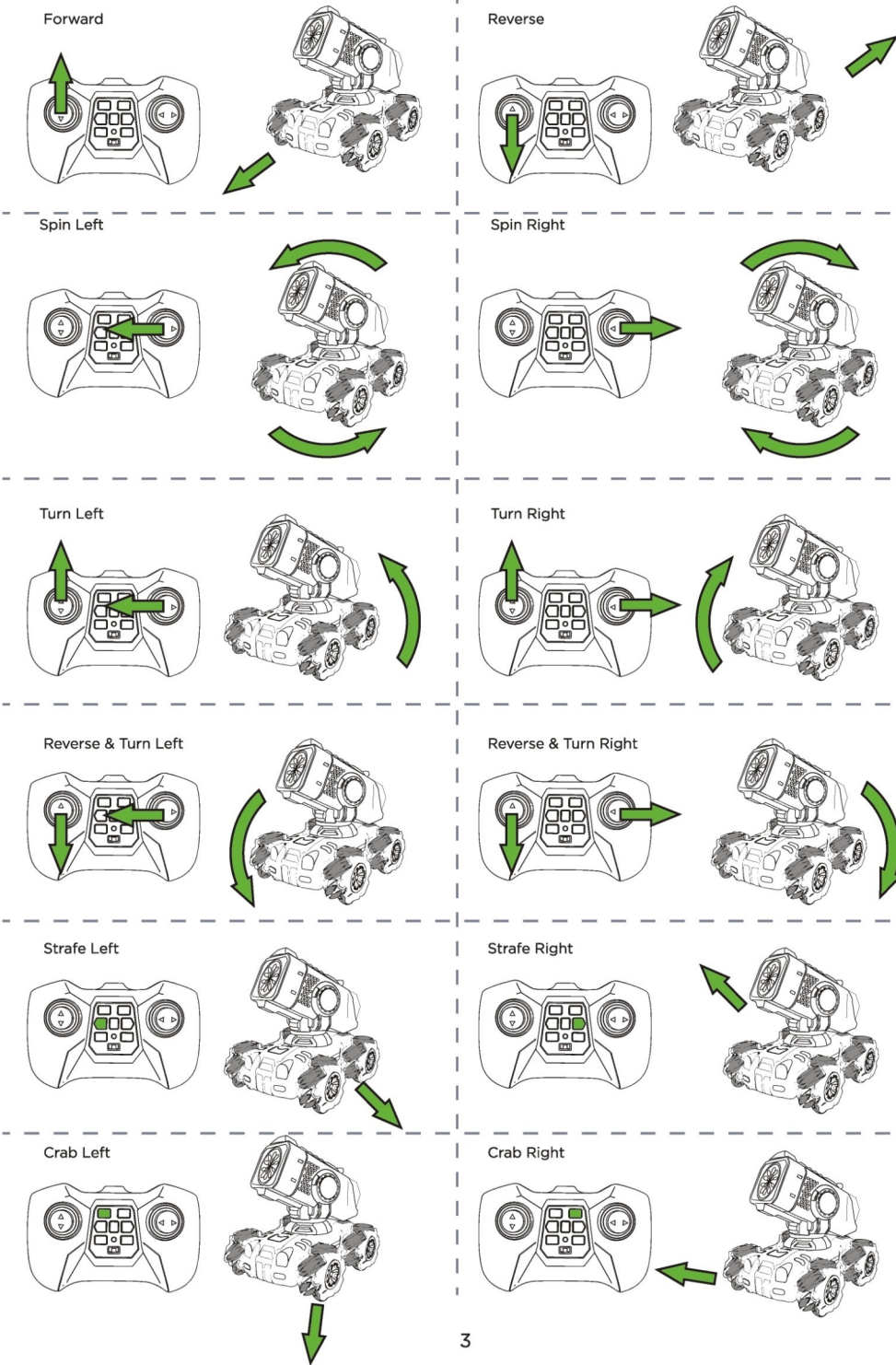

正面

21*285CM

背面

21*285CM