

Botslab ColorS AI Night Cam

Quick Start Guide

Packing list

Please check whether the main unit and all accessories are complete upon unpacking.

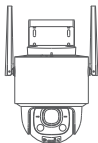

Main camera
unit x 1



Wall
bracket x 1



Positioning
sticker x 1



Power
adapter x 1



Waterproof
kit x 1



Screwdriver
x 1



Quick Start
Guide x 1

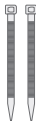

Cable
ties x 2



Screw pack for
installation x 1



Warning
stickers x 1

Product appearance

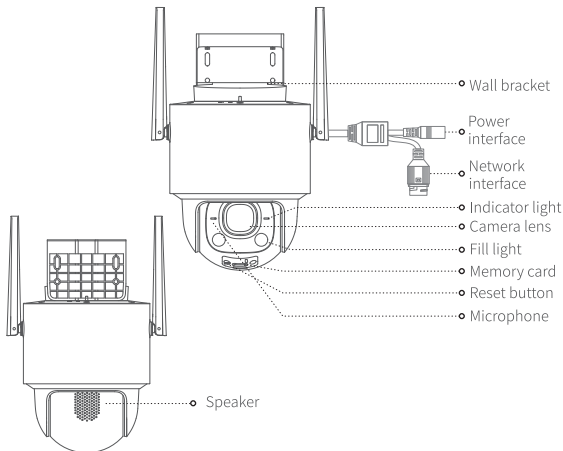

Reset hole: When the camera is powered on, press the reset hole with the eject pin for 5 seconds, and the "Di" sound indicates a successful reset.

Memory card: Maximum storage of 512GB.

Network configuration instructions

Download and install the APP

Method I : Scan the QR code below with your mobile phone to download and install the **Botslab** APP.

Method II : Search and download the **Botslab** APP from App Store or Google Play, and then install it.



Scan to download **Botslab**
APP



Connect to a power

1. Connect the camera to the power adapter. After the camera is turned on, the status indicator light is "flashing green", indicating that the device enters the network setup state and awaits being added.
i Note: If the status indicator light is not flashing green, please reset the device now.
Please use the original power adapter that comes with the camera.

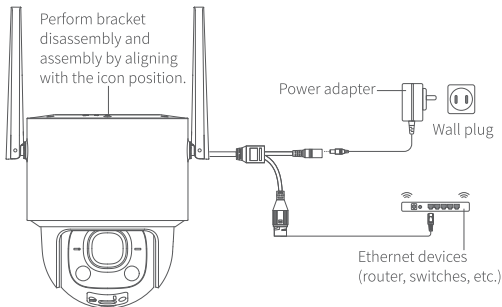

Add camera

Launch the Botslab APP, tap the "Sign up" button, and start creating your account. If you already have an account, please log in directly and add a camera.

Method I : After logging in, Bluetooth will automatically search for the camera by default. Once the camera is found, add the device according to the prompts.

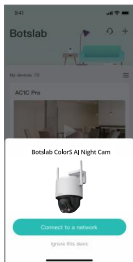

When connecting to the network, please make sure that Bluetooth is enabled on the mobile phone and that the WiFi is properly connected.

Method II : Tap the "+" button in the upper right corner of the APP homepage to "Scan" the code, then use your mobile phone to scan the QR code at the bottom of the camera to enter the distribution page, and add the camera as instructed.

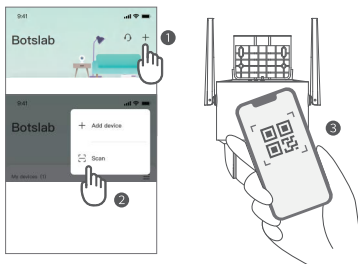

notice:

- Complete the sound wave pairing in a quiet environment.
- Support network cable connection.
- When using WiFi connection, please ensure that the camera is connected to a Wi-Fi network in the 2.4GHz frequency band.

Installation guide

Insert a Micro SD card (optional).

Open the waterproof card cover with a screwdriver, insert the Micro SD card, and log in to the Botslab app for initialization before using it.

Wall-mounted Installation

- The camera supports both ceiling and wall-mounted installation. After selecting an appropriate installation method and location, securely affix the installation sticker. Drill holes and install the expansion pipe, then fasten the wall bracket with screws.
- Camera also support bracket installation. Thread a strap through the bracket's slotted holes, wrap it around objects such as pipes or poles, insert each end of the strap into the self-locking hole on the opposite end, and tighten.
- First, align the top of the camera with the indicated position on the bracket, then snap it into the base of the bracket. Afterwards, rotate the main unit to the left until you hear a clicking sound, indicating that the installation is complete.

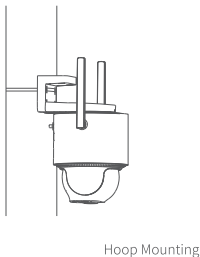
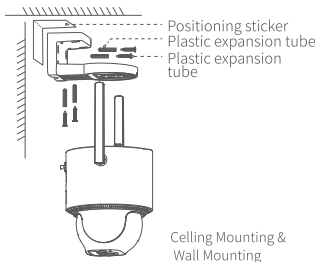

Precautions:

- Please ensure that the camera has been successfully added before proceeding with the wall installation.
- The wall surface where the camera is installed must be able to support at least three times the combined weight of the camera and wall bracket.

Use with Network Video Recorder (NVR)

First, bind the camera to the app, then follow the steps (shown in the picture below) to connect the camera to the NVR. Once added to the NVR interface, the camera will be ready to use.

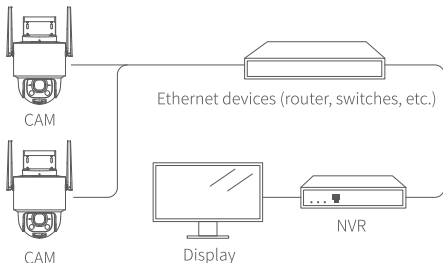

Onvif

Onvif	8899
Rtsp	554

- Compatible with mainstream NVRs

Install waterproof kit (optional)

- ① Before installation, inspect the waterproof kit items and place the waterproof rubber ring on the camera's network interface.

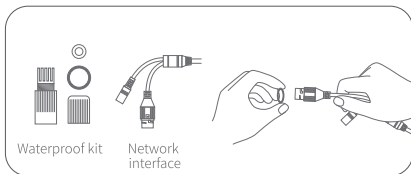

- ② Thread the waterproof kit through the network cable one by one, and connect the network cable to the network interface.

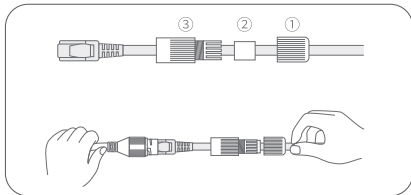

- ③ Tighten the waterproof kit at the camera's network interface first, and then screw the locking bolt.

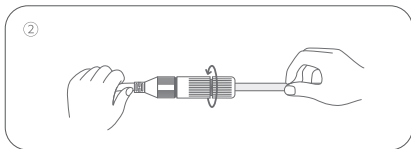
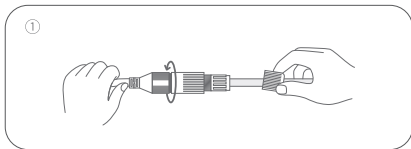

After the installation is completed, connect the camera to power source again. After startup, the camera will automatically connect to the pre-configured network.

Precautions:

- The camera's waterproof kit can effectively prevent rainwater from seeping into the network interface. Failure to install it properly may result in equipment damage, which is not covered by the after-sales warranty service.

Notes

1. For better night vision imaging, do not use the camera with the front or sides of the lens near reflective materials such as glass and white walls; otherwise, the images of things nearby will be rendered bright while those far away dark or even white.
2. Try to place the device in a place with good network signal reception. The distance between the device and metal objects (e.g., metal supports, metal doors, and windows) or other signal interference sources should not be too close.
3. Do not place the device near the heat source, e.g., electric heater, oven, or stove fire.
4. The applicable working temperature of this product is -20°C – $+45^{\circ}\text{C}$. Please do not use it in an environment where the temperature is too high or too low.
5. Please do not use this product in an environment that is excessively humid and may cause water ingress.

Operating mode description

Status indicator light	
Constant blue	Camera connected
Flashing blue	Someone viewing video
Constant green	Camera turned on/failure
Flashing green	Waiting for network configuration/Camera offline

- i** The manufacturer reserves the right to adjust the functional status of the product through firmware upgrades or software adjustments.

IMPORTANT

Personal information security

For the safety of you and your family, please make sure that the products you purchase are not bound to any unauthorized person. Botslab will take strict measures to protect the information security of you and your family.

Declaration of Conformity

Hereby, Botslab, Inc. declares that the radio equipment type W317 of Botslab ColorS AI Night Cam is compliance with Directive 2014/53/EU and this product is allowed to be used in all EU member states. The full text of the EU declaration of conformity is available at the following internet address: www.botslab.com

Operation frequency (Max. power)

Bluetooth: 2402-2480MHz (9.4dBm)

Wifi: 2412MHz-2472MHz (19.9dBm)

RF exposure statement

RF exposure information: The Maximum Permissible Exposure (MPE) level has been calculated based on a distance of $d=20$ cm between the device and the human body. To maintain compliance with RF exposure requirement, use product that maintain a 20cm distance between the device and human body.

UK Declaration of conformity

Hereby, Botslab, Inc declares that the product is in compliance with the essential requirements and other relevant provisions of Radio Equipment Regulations 2017(SI 2017 No.1206). You can find the Declaration of Conformity on www.botslab.com.

Operation frequency (Max. power)

Bluetooth: 2402-2480MHz (9.4dBm)

Wifi: 2412MHz-2472MHz (19.9dBm)





This symbol means the product must be discarded as household waste, and should be delivered to an appropriate collection facility for recycling. Proper disposal and recycling helps protect natural resources, human health and the environment. For more information on disposal and recycling of this product, contact your local municipality, disposal service, or the shop where you bought this product.

FCC Statement

This device complies with Part 15 of the FCC Rules. Operation is subject to the following two conditions: (1) This device may not cause harmful interference, and (2) this device must accept any interference received, including interference that may cause undesired operation.

Warning: Changes or modifications not expressly approved by the party responsible for compliance could void the user's authority to operate the equipment.

Note: This equipment has been tested and found to comply with the limits for a Class B digital device, pursuant to Part 15 of the FCC Rules. These limits are designed to provide reasonable protection against harmful interference in a residential installation.

This equipment generates, uses, and can radiate radio frequency energy and, if not installed and used in accordance with the instructions, may cause harmful interference to radio communications. However, there is no guarantee that interference will not occur in a particular installation. If this equipment does cause harmful interference to radio or television reception, which can be determined by turning the equipment off and on, the user is encouraged to try to correct the interference by one or more of the following measures: (1) Reorient or relocate the receiving antenna. (2) Increase the separation between the equipment and receiver. (3) Connect the equipment into an outlet on a circuit different from that to which the

receiver is connected. (4) Consult the dealer or an experienced radio / TV technician for help.

This equipment must be installed and operated in accordance with provided instructions and the antenna(s) used for this transmitter must be installed to provide a separation distance of at least 20cm from all persons and must not be collocated or operating in conjunction with any other antenna or transmitter.



Responsible party (contact for FCC matters only):

Botslab Inc.

919 North Market Street, Suite 950, Wilmington, New Castle, Delaware

www.botslab.com

IC regulatory conformance

This device complies with CAN ICES-003 (B)/NMB-003(B).

This device complies with Industry Canada licence-exempt RSS standard(s).

Operation is subject to the following two conditions:

- (1) this device may not cause harmful interference, and
- (2) this device must accept any interference received, including interference that may cause undesired operation.

Cet appareil est conforme à la norme CAN ICES-003 (B)/NMB-003 (B).

Le présent appareil est conforme aux CNR d'Industrie Canada applicables aux appareils radio exempts de licence. L'exploitation est autorisée aux deux conditions suivantes :

- (1) l'appareil ne doit pas produire de brouillage, et
- (2) l'utilisateur de l'appareil doit accepter tout brouillage radioélectrique subi, même si le brouillage est susceptible d'en compromettre le fonctionnement.

RF Exposure

This equipment complies with IC radiation exposure limits set forth for an uncontrolled environment. This equipment should be installed and operated with minimum distance of 20 cm between the radiator and your body. This transmitter must not be co-located or operating in conjunction with any other antenna or transmitter.

Cet équipement est conforme aux limites d'exposition aux rayonnements de la IC établies pour un environnement non contrôlé. Cet équipement doit être installé et fonctionner à au moins 20cm de distance d'un radiateur ou de votre corps.

After-Sales Service

1.Warranty policy

- This product comes with a One-year Local Warranty Service. For detail of warranty service, please kindly contact local Authorized Distributors in your country.

2.Non warranty policy

- Cannot present valid warranty certificate and purchase invoice.
- Damage caused by use, maintainance, or keeping of the product not in accordance with product description, damage caused by disassembly and repair unauthorized by Botslab, or artificial damage.
- Damages which result of force majeure.
- Normal decoloration and wastage during usage will not be included into warranty service.