

S8

Operating Manual

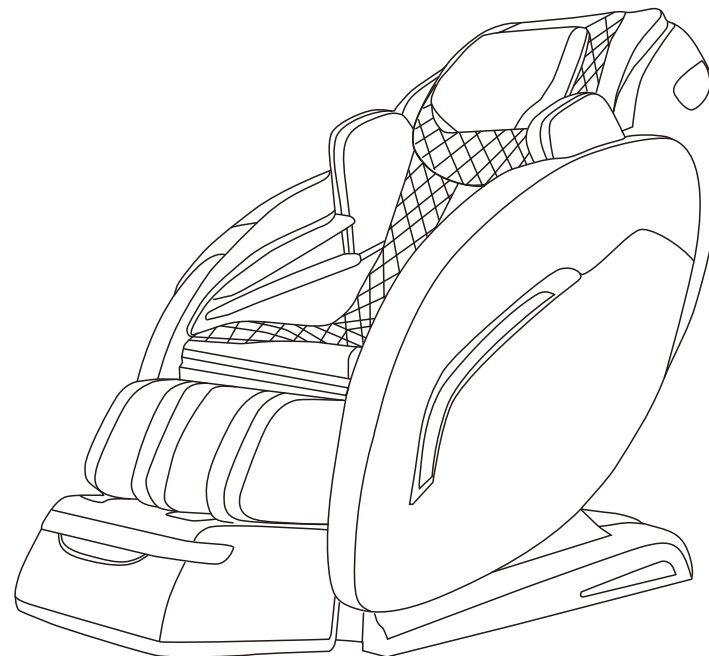

Due to continuous quality improvement, the specifications and part names in this manual may be different than the actual product.

Warranty

1-Year Limited Warranty for Manufacturing Defects

Please read all of the following Warranty information carefully. To ensure your Warranty remains in effect, please adhere to all of the conditions below.

This warranty is for manufacturing defects only and does not cover or include damages that result from misuse of the product.

1. Your product includes a 1-year Warranty covering all manufacturing defects. The Warranty is effective beginning on the date of purchase. It's important to keep your original sales receipt, as without this, we will not be able to process your Warranty. This warranty and all financial responsibility there of are limited to the product itself.
2. Manufacturing defects include circumstances where the product has broken under normal and proper use. Please use your unit safely and only for the purpose of which is intended. Improper use may result in injury or damage to other property. Donot allow children to play or climb on this product.
3. This Warranty is effective only when the product has been used as recommended, by a consumer who purchased the product from an authorized dealer, and only covers products that were purchased in New condition. Proper use means using this product on a level surface with an equal distribution of weight. In the event that the product was not properly used or was abused by the consumer, this warranty will be voided. This warranty does not constitute an agreement to replace other parts.
4. If the product fails due to manufacturing defects, the manufacturer will, at its discretion, repair or replace the product. The manufacturer reserves the right to substitute comparable materials or models and does not guarantee that the replacement
5. In the event that the product needs to be inspected by the manufacturer to determine warranty claims, all transportation or shipment cost will be assumed by the consumer.

Thank you for purchasing the S8 Massage Chair. Before using this chair for the first time, please read through all sections of this User Manual carefully, paying special attention to the Safety

PLEASE RETAIN THIS MANUAL FOR FUTURE REFERENCE.

Table of Contents

Important Usage Reminders, Safety Precautions	1-3
Product Parts Diagram	3
Massage Chair Setup Instructions	4
Moving Your Massage Chair	5
Product Features	6
Controller Instructions	7
Operating Instructions	8
Troubleshooting and Repairs	9
Product Specifications	10
Warranty	11

Important Usage Reminders

Basic precautions should always be followed when using an electrical unit, including all of the precautions in this instruction manual. Please ensure that you read all instructions before using the S8.

DANGER – To reduce the risk of electric shock:Always unplug this unit from the electrical outlet immediately after using and before cleaning.

WARNING– To reduce the risk of burns, fire, electric shock, or injury to persons:

Always insert the power plug all the way into the outlet to reduce the risk of short-circuit and fire.The unit should never be left unattended when plugged in. Always unplug the unit when not in use.The unit is not to be used by people who can not move or communicate on their own. Only use the unit for the purpose described in these instructions.

Do not stand on the unit.

Always return the seat to the upright position and make sure the leg rest is completely retracted. Be careful that nothing is obstructing the leg rest while retracting. Keep children away from the legrest.

Never operate the unit if it has a damaged power cord or plug. Return the unit to the nearest authorized service center if it is not working properly, if it has been dropped or damaged, or if it has been immersed in water.

Keep power cords away from heated surfaces. Do not drag the unit by the power cord. Never block the air openings during operation and make sure that all air openings are kept free of lint and hair, etc. Do not drop or insert anything into any of the openings of the unit.

Do not use the unit on top of heating appliances, such as electric carpets, etc. Do not operate the unit under a blanket or pillow. Excessive heating can occur and cause fire, electric shock, or injury to persons.Do not use the unit in bathrooms or other damp or humid places as this may cause electric shock or cause the unit to malfunction. Do not spill water, etc. onto the controller.

Do not use the unit outdoors.

Do not use or operate where aerosol spray products are being used or where oxygen is being administered.

When unplugging the unit, turn off all controls before removing the plug from power outlet. Do not use the unit with a transformer as this may lead to malfunction or electric shock.skin areas or in the presence of poor circulation. The unattended use of heat by children or incapacitated persons may be dangerous.

Product Specifications

Product Model	S8
Product Name	Massage Chair
Voltage	120V~
Hertz	60Hz
Power	120W
Rated time	15 minutes
Safety grade	I Class
GW.	110kg
NW.	90kg
Dimension	120x76x 120CM

Troubleshooting and Repairs

Problems	Causes/Solutions:
<p>The massage chair doesn't turn on.</p> <p>Remote control does not work and/or has a blank display.</p>	<p>Make sure the chair is plugged in and the power switch is in the "on" position.</p> <p>Check to see if the power cord has been damaged.</p> <p>Check the fuse and replace if necessary.</p>
<p>Massage chair stop working suddenly</p>	<p>The set time has been reached.</p> <p>The chair has overheated and has automatically shut down to protect the motor – Turn the power off for 30 minutes and then power on the chair and try again.</p> <p>The chair may have a damaged fuse, replace if necessary.</p>
<p>Odd, abnormal, or unusually loud sounds coming from the chair.</p>	<p>There is a mechanical malfunction.</p>

In the case of any other abnormalities, contact customer service immediately. Never attempt to repair the product yourself.

If any smoke or abnormal odors are noticed during use of the unit, immediately turn the power off and contact customer service.

Safety Precautions

- Not Suitable For: Persons with any of the conditions listed below or who are undergoing medical treatment or suffer from medical conditions should consult with their physicians before using the unit:
 - Pregnant women, people who are ill, or those in poor physical shape.
 - People suffering from back, neck, shoulder, or hip pain.
 - People who have a pacemaker, defibrillator, or other personal medical devices prone to electronic interference.
 - People suffering from heart disease.
 - People who are prohibited from receiving massage by a physician due to thrombosis or aneurism, acute varicose veins, or other circulatory disorders.
 - People with irregular curvatures of the spine.
 - People who have a loss of heat sensation.
- This unit should not be used by children.
- Sit down slowly after checking the position of the massage heads. Never put any part of your body between the massage heads as the squeezing action of the massage heads may cause injury. Never put your fingers or feet in the gap between the backrest and seat, the backrest and the armrest, the seat and cover under the armrest, or the gap beneath the legrest. Do not place your fingers or any part of your body in the mechanism below the legrest.
- Do not use the unit against bare skin. While thin clothing may increase effectiveness, exposing the skin directly to the massager may irritate the skin. Do not use the unit while wearing anything hard on your head like a hair accessory, etc. Do not use the unit for massaging the head, abdomen, front neck, elbows or knees. Do not use excessively strong massage action on the back of the neck.
- When using the body scanning function, always ensure that the shoulder position is correct. If the shoulder position is not correct, use the POSITION button to adjust it properly, or stop the massage function and re-try the body scanning function. You can adjust the shoulder position in this way in the auto program and manual operation. Failure to align the shoulder position correctly can lead to injury.
- While using the massager, if the pressure seems too strong, the movement of the massage heads can be stopped at any time by pressing the Stop button.
- Do not go to sleep while using the massage function.
- Do not use the unit after drinking alcohol.
- When the seat back is in a reclined position, do not sit on it or sit with your legs resting on the headrest. Do not sit on the legrest as the unit may fall over.
- Do not allow children or pets to play on or around the unit, especially during operation.
- Do not unplug the unit or turn it off during operation. Unplug the unit immediately if there is a power outage.

12. Do not allow children to play on this mechanized furniture or operate the mechanism. Legrest folds down on closing so that a child could possibly be injured.
13. Always leave in an upright and closed position, when not in use.
14. Keep hands and feet clear of mechanism. Only the occupant should operate it.
15. Remove hard objects, such as false fingernails, wristwatches or rings when massaging hands or arms. Empty pockets of hard objects when massaging the area of the seat or thighs.
16. When "Heat" massage heads are used, do not let the massage heads touch the same place for a long time. Low-temperature burn may occur.

Product Parts Diagram

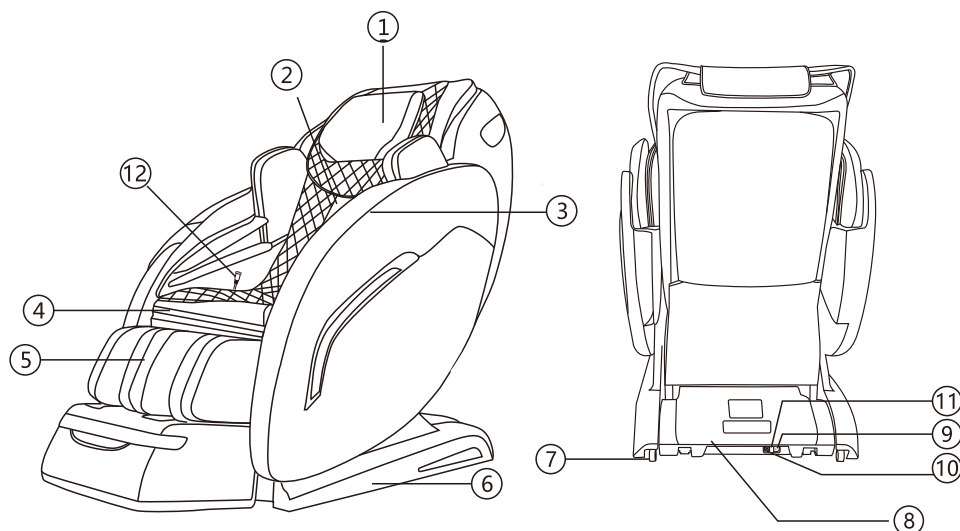

Schematic

- | | | |
|------------------|----------------------|--------------------------------|
| 1. Pillow | 2. Back Cushion | 3. Armrest |
| 4. Seat Cushion | 5. Calf Airbags | 6. Armrest Base |
| 7. Casters | 8. Power Control Box | 9. Power Cord Receptacle |
| 10. Power Switch | 11. Fuse | 12. Controller Cord Receptacle |

Operating Instructions



Power on/off
Press this button to turn the power on, press it again to turn the power off.



Auto Mode – Includes five Auto Modes A, B, C, D, E, F (A:Whole body model,B:Neck key mode,C:Stretch mode, D:Sleep pattern,E:Motion recovery model F:Elderly model)



Manual-press to cycle between the six manual modes : 1. Kneading; 2. Tapping 3. Kneading&Tapping;4.Knocking; 5.Kneading&Knocking; 6.Shiatsu.



Heating – Press to activate heating, press again to deactivate



Time – Set the massage timer for 5-30 minutes, adjustable in 5-minute increments



Rest – Press this button to pause all functions



Down button, manual mode the movement will move down



Up button,manual mode the movement will move up



Auto airbags - Press this button to activate shoulder, arm, and foot airbags



Width – Select from wide, middle, or narrow widths to customize the massage to your body type



Strength – Adjust the intensity of the massage, 3 levels available



Pressure – Adjust the intensity of the airbag massage, 3 levels available



Zero-G – Select from two Zero-G recline angles



Raise backrest – Press this button to raise the backrest, press again to stop



Lower backrest – Press this button to lower the backrest, press again to stop



Raise feet - Press this button to raise the legs and feet, press again to stop



Lower feet – Press this button to lower the legs and feet, press again to stop

Controller Instructions

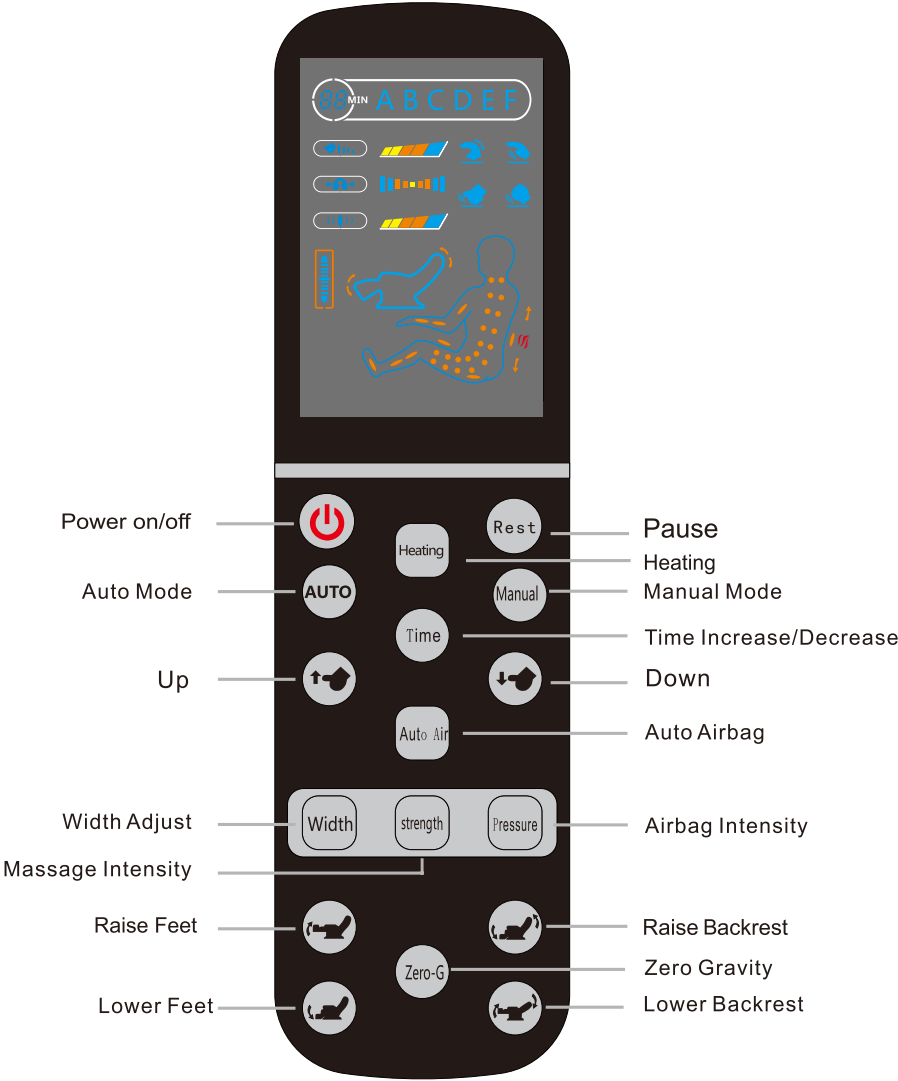

Massage Chair Setup Instructions

Step 1:

Carefully lift the chair out of the box and remove any protective wrapping.
(To avoid injury when lifting heavy objects, always err on the side of safety and find someone to assist with all heavy lifting).



Step 2:

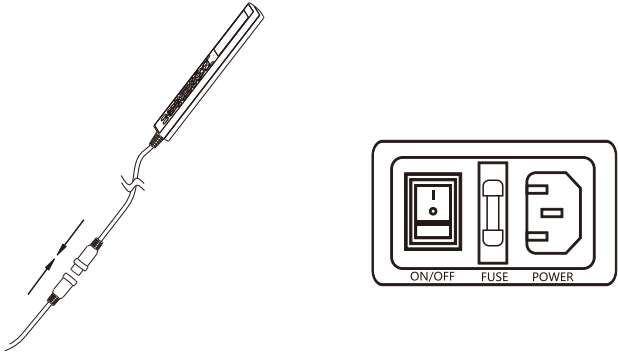

- A. Connect the controller plug into the receptacle on the power control box (located on the backside of your chair) , then tighten the threaded sleeve after inserting it into position.
- B. Next, connect the power cord to the receptacle on the power control box of the chair before plugging the other end into your electrical outlet.
- C. Locate the power switch on the power control box on the back side of the chair next to the fuse and controller cord receptacle. Turn the switch to the "On" position. At this time, the switch indicator light should be red, indicating that your chair has power.

⚠ Warning

1. When choosing a place for your massage chair, be sure to ensure at least 5cm of clearance behind and 20cm in front of massage chair to ensure a full range of movement during reclining.
2. To prevent possible electrical leakage, do not place the massage chair in or near a damp environment, such as a bathroom.
3. To prevent fire or damage to its leather material, keep the massage chair away from any sources of heat (such as a stove or furnace).

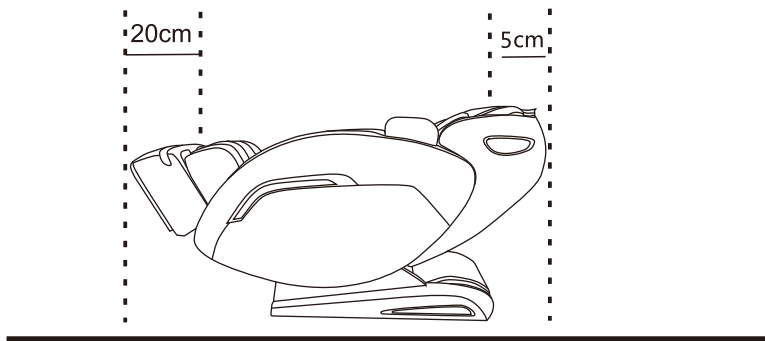

WHERE TO USE THE UNIT

Ensure adequate space to recline (at least 5 cm both in the front and rear). Do not expose the chair to direct sunlight or high temperatures, such as heating sources, because this can cause discoloration and/or damage to the synthetic leather. Place the unit on a mat or rug to prevent damage to your floor. Place your chair near a power socket.

Product Movement Instructions

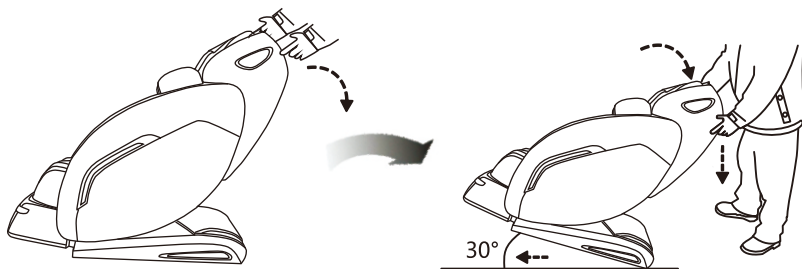

Moving Your Massage Chair

Your massage chair has been designed with casters for easy and quick relocation. Just follow these steps:

1. Stand behind the massage chair and push down on the backrest to tilt the chair back at an approximate 30° angle, lifting the front end off ground.
2. Ensuring that the foot rest is elevated off the floor at all times, roll the chair on the rear casters to move or relocate it to another spot.
3. It is recommended that you place a protective mat or rug under the massage chair during normal usage and movement to prevent damage to your flooring.

Product Features:

Designed to be an attractive furniture piece in your home or office

Ultra-quiet quad massage heads

Foot and back massage rollers

Choose from six Auto Modes for the perfect massage

Upper and lower back massage movements can be controlled manually with three different intensity settings Customize the location and intensity of the arm and leg airbag massage

Zero-G reclining feature automatically adjusts to the chair to the perfect angle, evenly distributing gravity along your spine to optimize circulation and help you to relax

Combine heating with massage to relieve your tightest, most stressed muscles

How to Use Bluetooth:

1. Bluetooth is automatically activated when you power up the massage chair
2. Turn on your phone's Bluetooth and connect to the chair
3. Play and enjoy music of your choice during your massage

FCC Statement:

Any Changes or modifications not expressly approved by the party responsible for compliance could void the user's authority to operate the equipment.

This device complies with part 15 of the FCC Rules. Operation is subject to the following two conditions:

- (1) This device may not cause harmful interference, and
- (2) This device must accept any interference received, including interference that may cause undesired operation.

Note: This equipment has been tested and found to comply with the limits for a Class B digital device, pursuant to part 15 of the FCC Rules. These limits are designed to provide reasonable protection against harmful interference in a residential installation. This equipment generates, uses and can radiate radio frequency energy and, if not installed and used in accordance with the instructions, may cause harmful interference to radio communications. However, there is no guarantee that interference will not occur in a particular installation. If this equipment does cause harmful interference to radio or television reception, which can be determined by turning the equipment off and on, the user is encouraged to try to correct the interference by one or more of the following measures:

- Reorient or relocate the receiving antenna.
- Increase the separation between the equipment and receiver.
- Connect the equipment into an outlet on a circuit different from that to which the receiver is connected.
- Consult the dealer or an experienced radio/TV technician for help.

FCC Radiation Exposure Statement:

This equipment complies with FCC radiation exposure limits set forth for an uncontrolled environment. This transmitter must not be co-located or operating in conjunction with any other antenna or transmitter.